

PHASE 0
WHAT IS CLOSED: I-44 EB AND WB INSIDE LANE (OVERNIGHT CLOSURES)

TRAFFIC CONTROL FOR
I-44 WIDENING PROJECTS

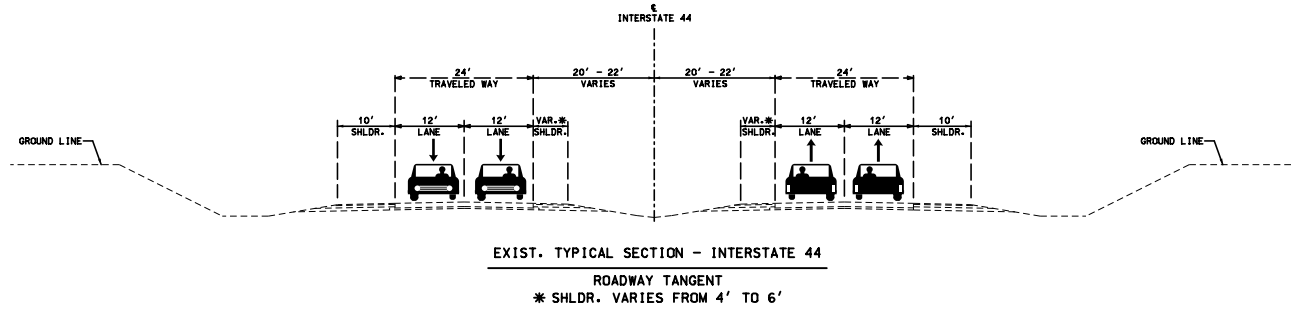

EXISTING TYPICAL SECTION

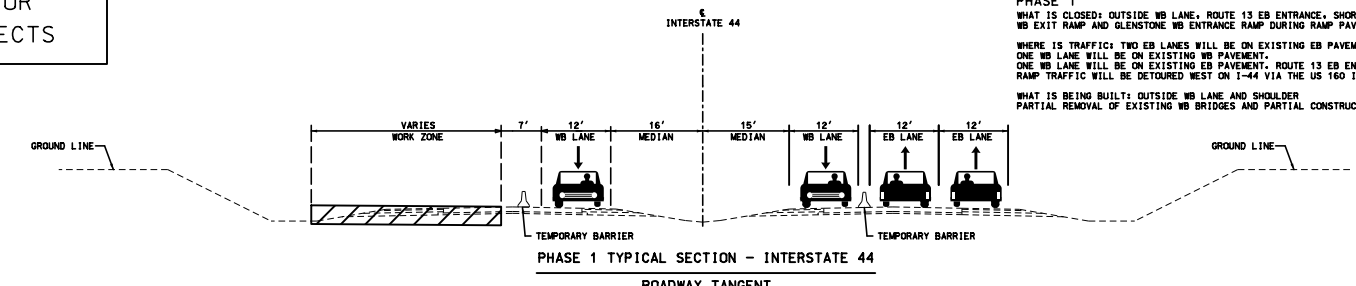

NOTE:
2 CONSTRUCTION SEASONS.

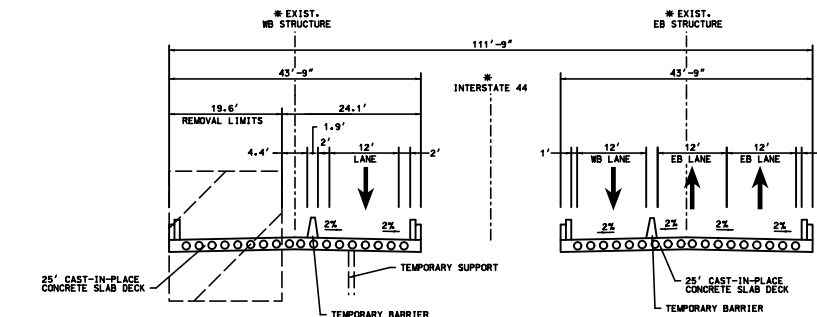

PHASE 1

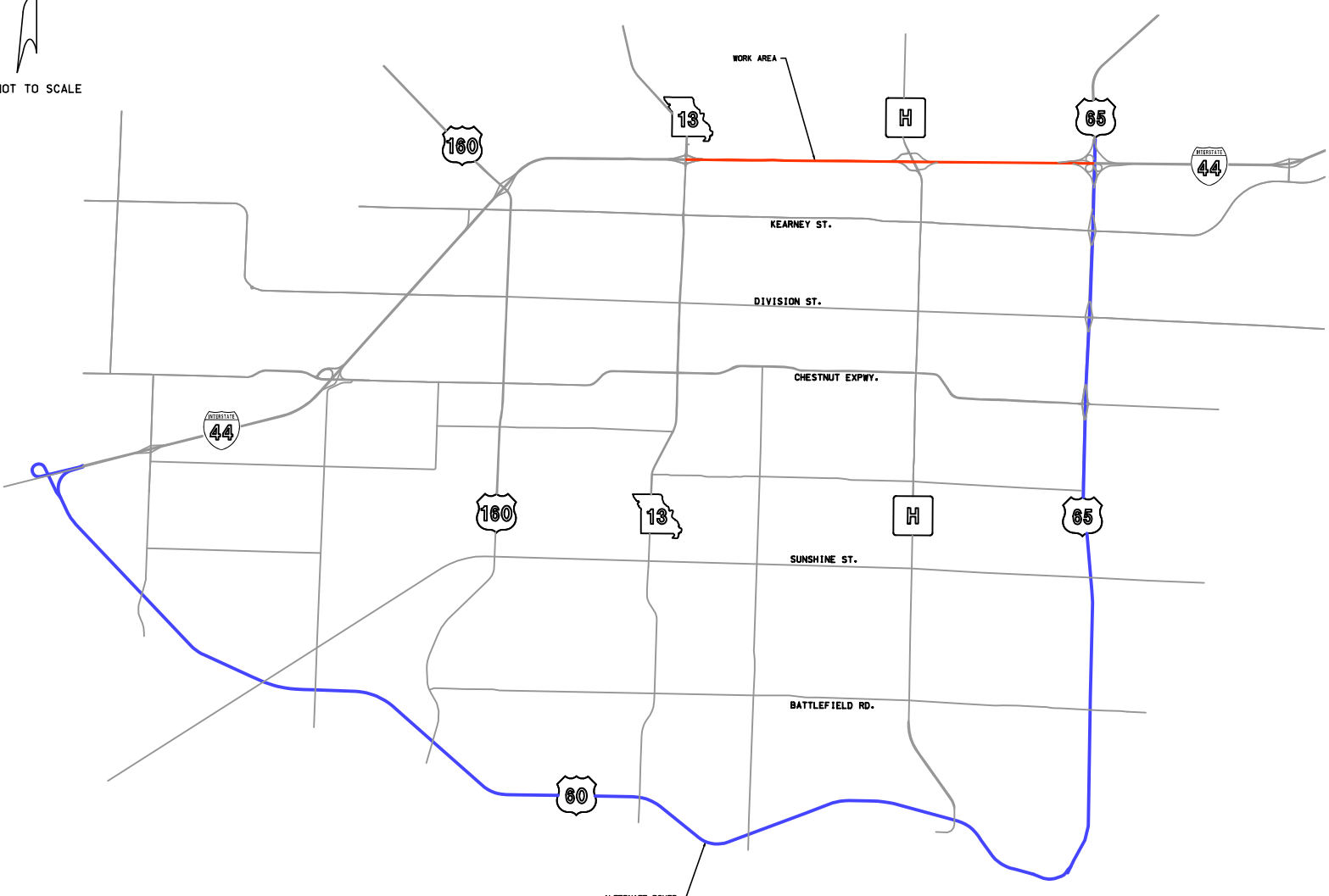

ALTERNATE ROUTES

PHASE 2
WHAT IS CLOSED: INSIDE WB LANE, ROUTE 13 EB ENTRANCE RAMP.
WHERE IS TRAFFIC: TWO EB LANES WILL BE ON EXISTING EB PAVEMENT. ONE WB LANE WILL BE ON NEW WB PAVEMENT. ONE WB LANE WILL BE ON EXISTING EB PAVEMENT. ROUTE 13 EB ENTRANCE RAMP TRAFFIC WILL BE DETOURED WEST ON I-44 VIA THE US 160 INTERCHANGE.
WHAT IS BEING BUILT: TWO INSIDE WB LANES AND SHOULDER. REMOVAL OF REMAINING WB BRIDGES AND FINISH CONSTRUCTION OF NEW WB BRIDGES.

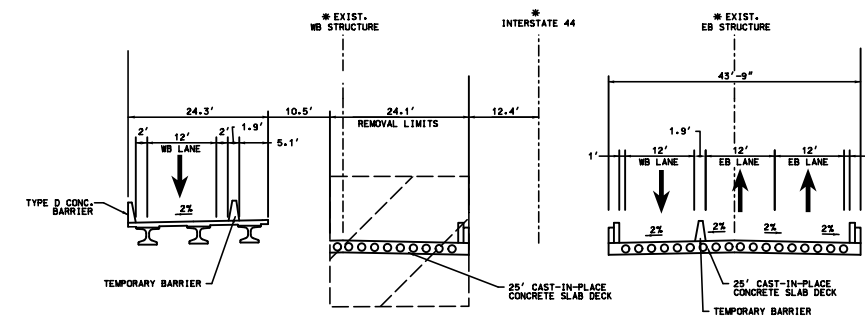
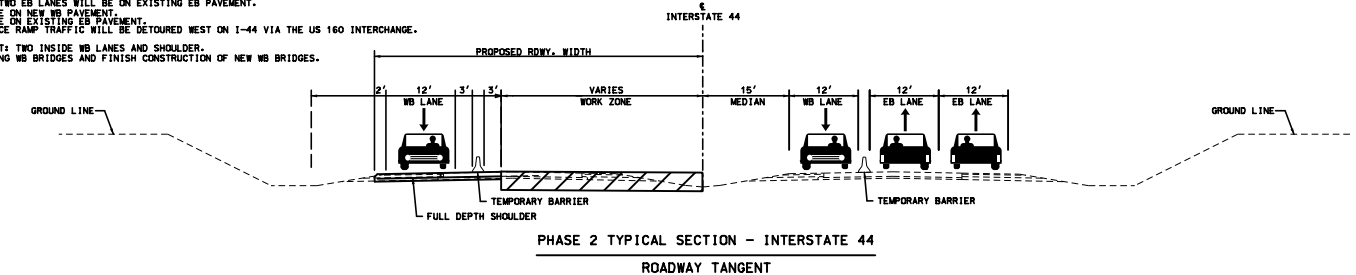

PHASE 2

PHASE 3
WHAT IS CLOSED: EB I-44, ROUTE 13 EB ENTRANCE RAMP, GLENSTONE EB EXIT RAMP.
WHERE IS TRAFFIC: ALL I-44 TRAFFIC WILL BE ON NEW WB PAVEMENT. TWO LANES IN EACH DIRECTION. ROUTE 13 EB ENTRANCE RAMP TRAFFIC WILL BE DETOURED WEST ON I-44 VIA THE US 160 INTERCHANGE. GLENSTONE EB EXIT RAMP WILL BE DETOURED VIA 'MELROY RD' INTERCHANGE.
WHAT IS BEING BUILT: EB I-44 NEW PAVEMENT AND BRIDGES.

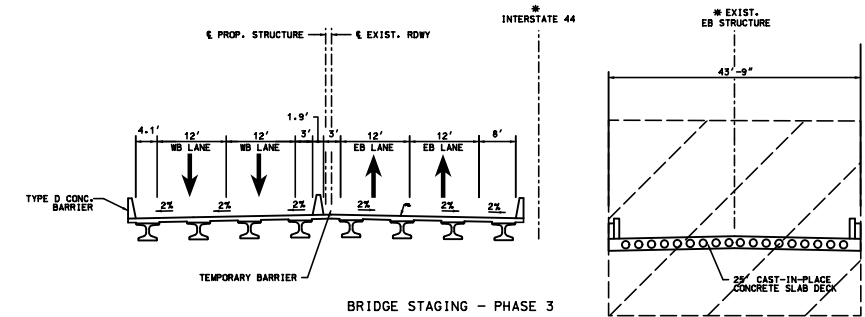
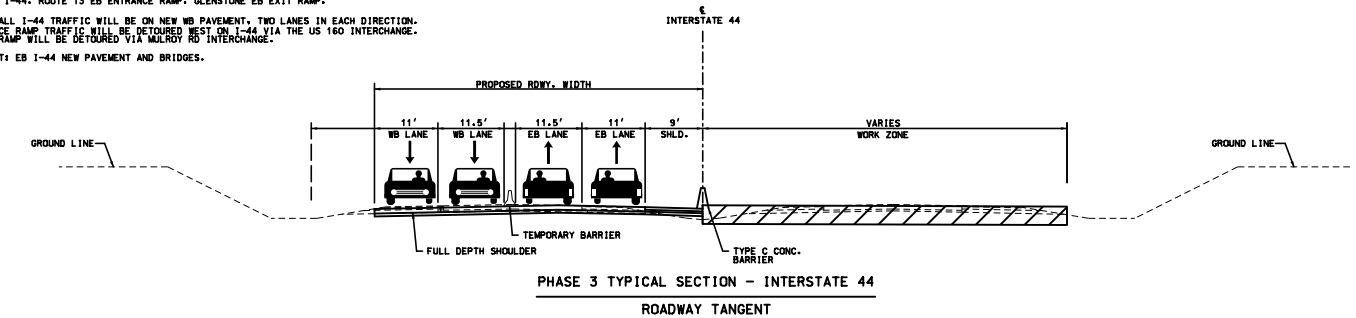

PHASE 3