

DAVIS BLVD. PROFILE

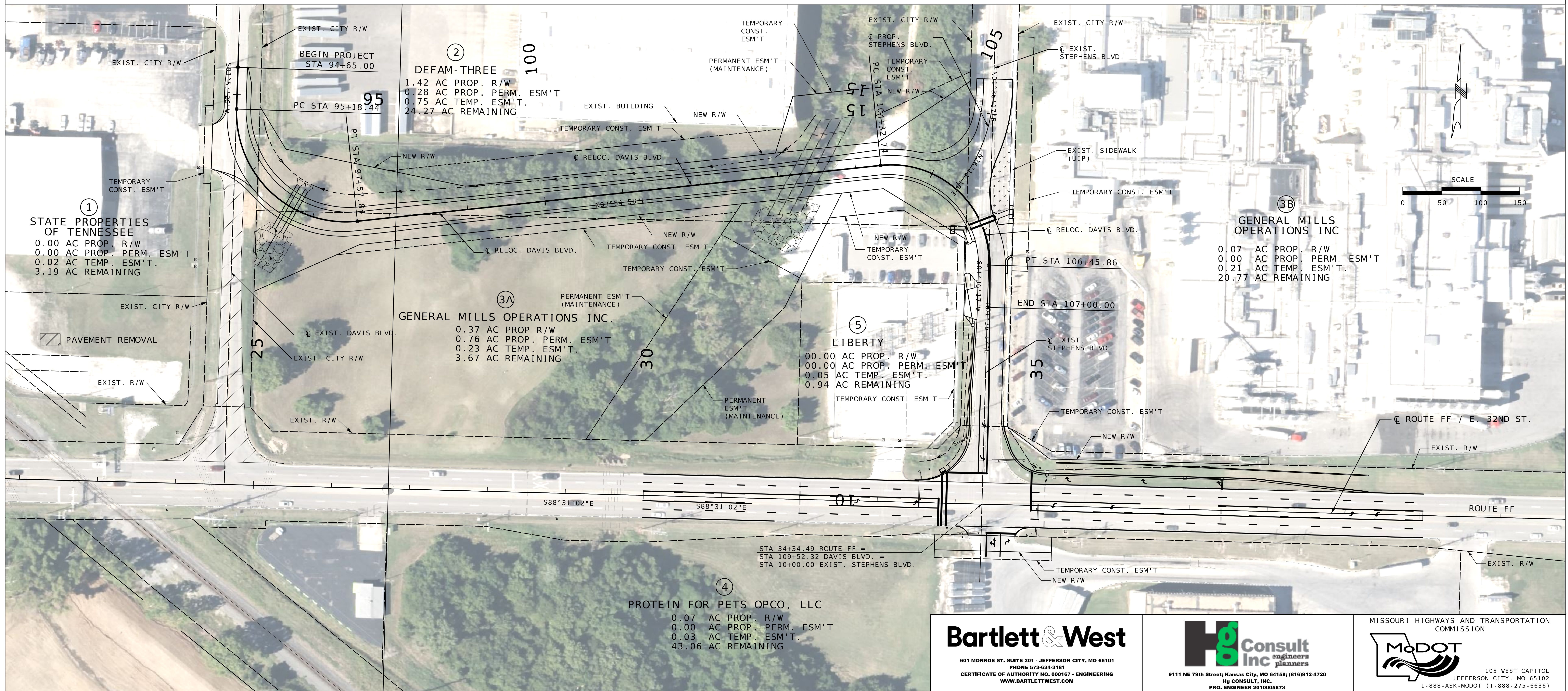

① STATE PROPERTIES OF TENNESSEE
 0.00 AC PROP. R/W
 0.00 AC PROP. PERM. ESM'T
 0.02 AC TEMP. ESM'T
 3.19 AC REMAINING

② DEFAM-THREE
 1.42 AC PROP. R/W
 0.28 AC PROP. PERM. ESM'T
 0.75 AC TEMP. ESM'T
 24.27 AC REMAINING

③A GENERAL MILLS OPERATIONS INC.
 0.37 AC PROP. R/W
 0.76 AC PROP. PERM. ESM'T
 0.23 AC TEMP. ESM'T
 3.67 AC REMAINING

⑤ LIBERTY
 00.00 AC PROP. R/W
 00.00 AC PROP. PERM. ESM'T
 0.05 AC TEMP. ESM'T
 0.94 AC REMAINING

③B GENERAL MILLS OPERATIONS INC.
 0.07 AC PROP. R/W
 0.00 AC PROP. PERM. ESM'T
 0.21 AC TEMP. ESM'T
 20.77 AC REMAINING

④ PROTEIN FOR PETS OPCO, LLC
 0.07 AC PROP. R/W
 0.00 AC PROP. PERM. ESM'T
 0.03 AC TEMP. ESM'T
 43.06 AC REMAINING

Bartlett & West
 601 MONROE ST. SUITE 201 - JEFFERSON CITY, MO 65101
 PHONE 573-634-3181
 CERTIFICATE OF AUTHORITY NO. 000167 - ENGINEERING
 WWW.BARTLETTWEST.COM

Hg Consult Inc
 engineers planners
 9111 NE 79th Street, Kansas City, MO 64158; (816)912-4720
 Hg CONSULT, INC.
 PRO. ENGINEER 2010005873

MISSOURI HIGHWAYS AND TRANSPORTATION COMMISSION

 105 WEST CAPITOL
 JEFFERSON CITY, MO 65102
 1-888-ASK-MODOT (1-888-275-6636)