

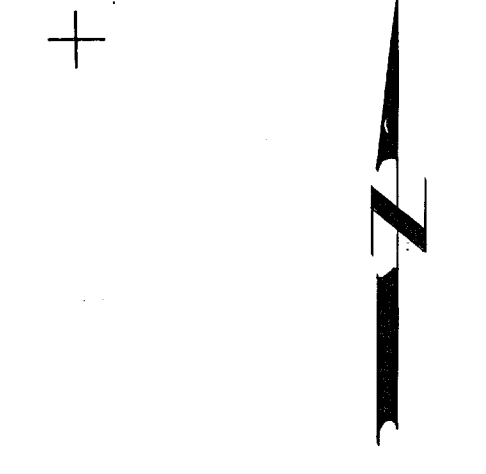

→ TO RTE 111



ROUTES
63 (NORTH PART)
763 (PART)
22

OIO
BOONE

SHEET 2 OF 14

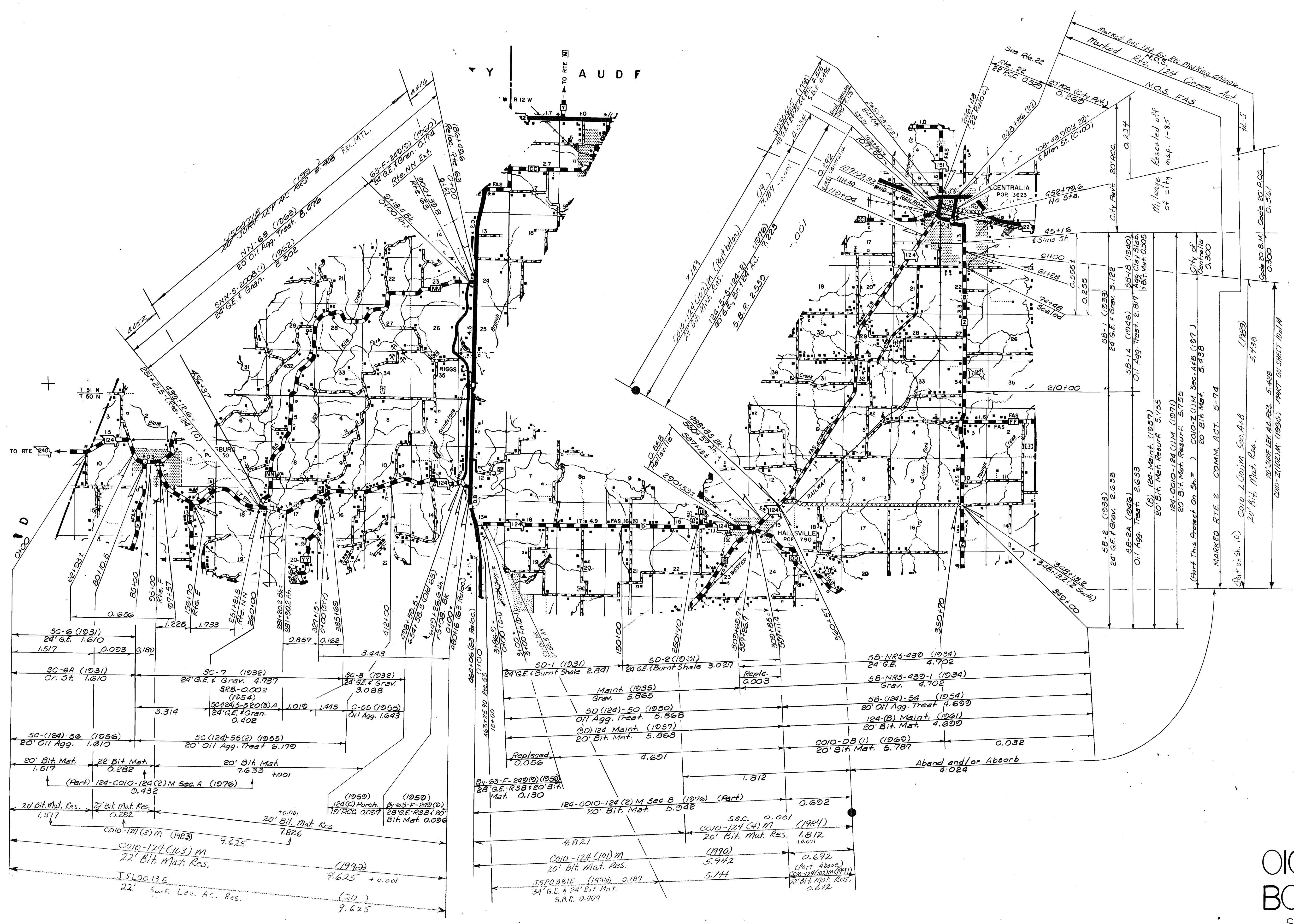

SC-6 (1931) 24' G.E. 1.610	SC-7 (1932) 24' G.E. & Grav. 4.737 SR8-0.002 (1954)	SC-8 (1932) 24' G.E. & Grav. 3.088	SD-1 (1931) 24' G.E. & Burnt Shale 2.841	SD-2 (1931) 24' G.E. & Burnt Shale 3.027	SD-NRS-430 (1934) 24' G.E. 4.702
SC-6A (1931) Cr. St. 1.610	SC-124S-520(3)A (1954) 24' G.E. & Grav. 0.402	C-55 (1955) Oil Agg. 1.643	Maint. (1935) Grav. 5.865	Replc. 0.003	SD-NRS-430-1 (1934) Grav. 4.702
SC-(124)-50 (1956) 20' Oil Agg. 1.610	SC(124)-55(2) (1955) 20' Oil Agg. Treat. 6.170		SD(124)-50 (1950) Oil Agg. Treat. 5.865		SD-(124)-54 (1954) 20' Oil Agg. Treat. 4.699
20' Bit. Mat. 1.517	22' Bit. Mat. 0.282	20' Bit. Mat. 7.633 +0.001	(60)ed Maint. (1957) 20' Bit. Mat. 5.863		124(B) Maint. (1961) 20' Bit. Mat. 4.699
(Part) 124-CO10-124(2)M Sec. A (1976) 9.432			Replaced 0.056		CO10-08(1) (1960) 20' Bit. Mat. 5.787
20' Bit. Mat. Res. 1.517	22' Bit. Mat. Res. 0.282	20' Bit. Mat. Res. 7.826	By 63-F-240(2) (1959) 28' G.E. & RSB 120' Bit. Mat. 0.130		Aband and/or Absorb 4.024
	CO10-124(3)M (1983) 9.625		124-CO10-124(2)M Sec. B (1976) (Part) 20' Bit. Mat. 5.942		
	CO10-124(103)M 22' Bit. Mat. Res. (1993) 9.625 +0.001		4.821	S.B.C. 0.001 (1984) CO10-124(4)M 20' Bit. Mat. Res. 1.812	
	J510013E 22' Surf. Lev. AC. Res. (20) 9.625		CO10-124(101)M 20' Bit. Mat. Res. (1990) 5.942		0.692 (Part Above) CO10-124(102)M (1991) 22' Bit. Mat. Res. 0.612
			J5100381E (1990) 0.189 34' G.E. & 24' Bit. Mat. S.B.R. 0.009		

- ROUTES
 124 (C-D) (Part)
 NN
 Z (PART)
 BUS. 124 (Part)

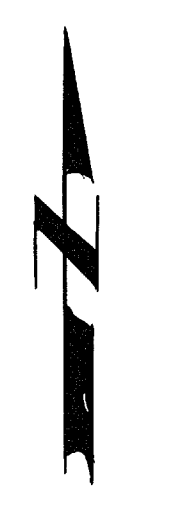

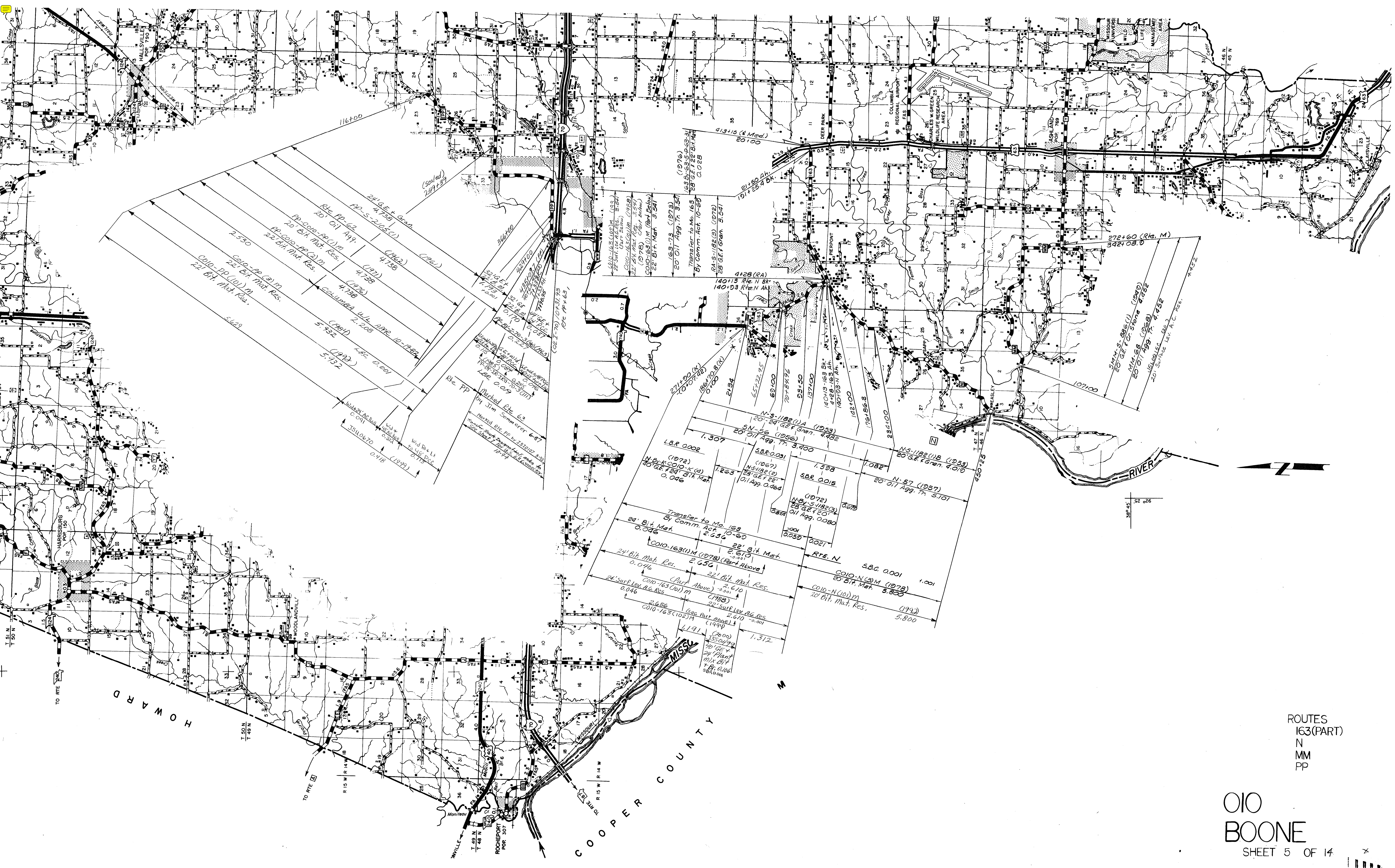

ROUTES
 163(PART)
 N
 MM
 PP

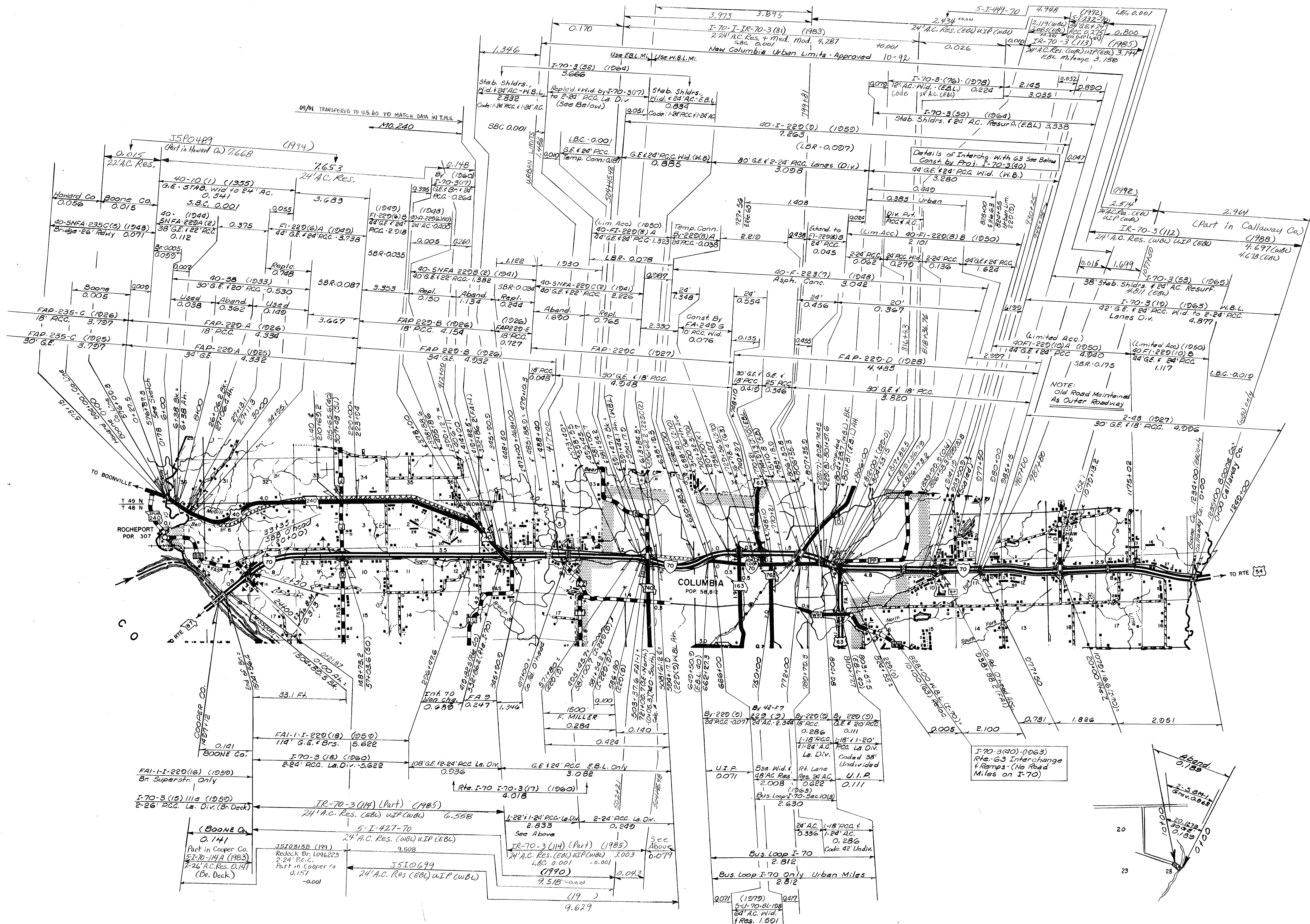

OIO
BOONE
SHEET 6 OF 14

ROUTES
240
70 (Part)
70 BUS LOOP

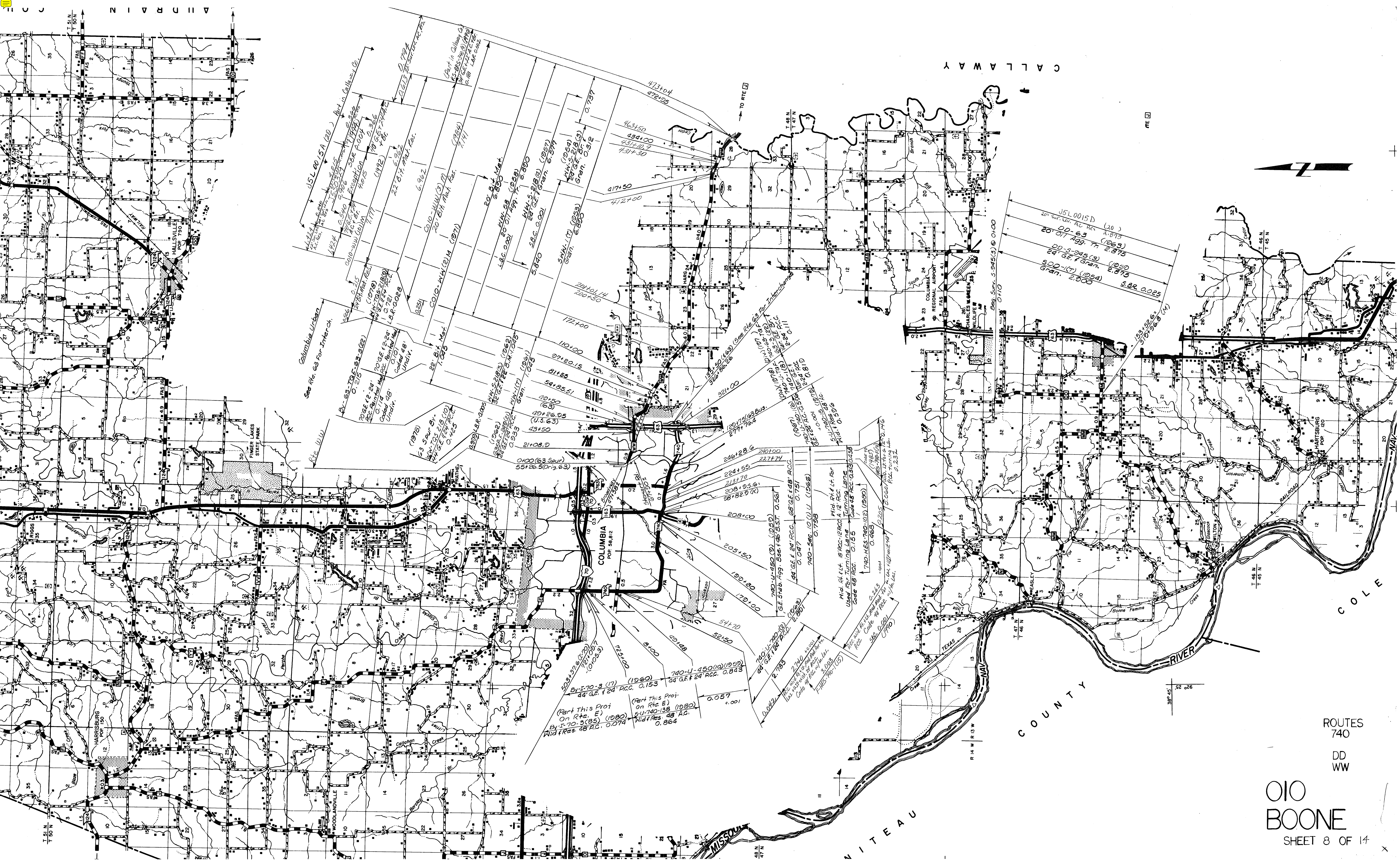

CALLAWAY



J5L 00 15A (20)
 20' SURV. LEV. AC. RES. A-1873
 DD-63 (1963)
 20' DIT. Agg. Th. 2.875
 DD-5-945 (3) (1950)
 24' GE. F. Gran. 2.875
 500-(17) (1954)
 Gran. 2.900
 5.82 0.025

Columbia Urban
 See Rte. 63 For Interch.
 Rte. 10 (W)

By I-70-3 (17) (1960)
 24' GE. F. 24' PCC. 0.153
 (Part This Proj. On Rte. E)
 By I-70-3 (85) (1980)
 Mid Res 48' AC. 0.074

740-U-450 (1953)
 24' GE. F. 24' PCC. 0.843
 740-U-450 (1953)
 24' GE. F. 24' PCC. 0.561
 GE. 5' x 6' Agg. 55¢-1.46 51.37' 0.561
 740-U-450 (1953)
 24' GE. F. 24' PCC. 0.561
 740-U-450 (1953)
 24' GE. F. 24' PCC. 0.561
 740-U-450 (1953)
 24' GE. F. 24' PCC. 0.561

ROUTES
 740
 DD
 WW

OIO
 BOONE
 SHEET 8 OF 14

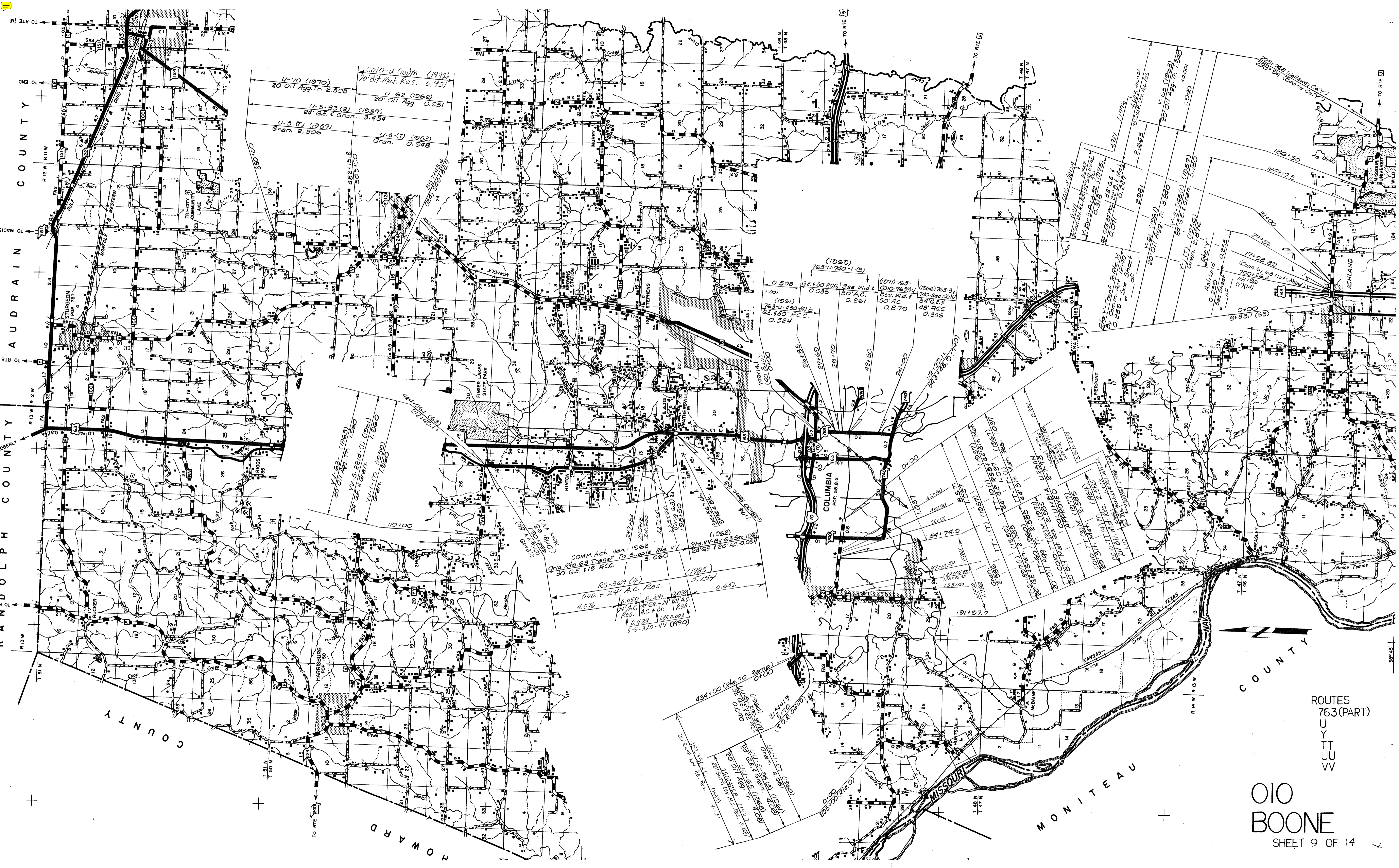

ROUTES
 763(PART)
 U
 Y
 T
 T
 U
 U
 V
 V

OIO
 BOONE
 SHEET 9 OF 14

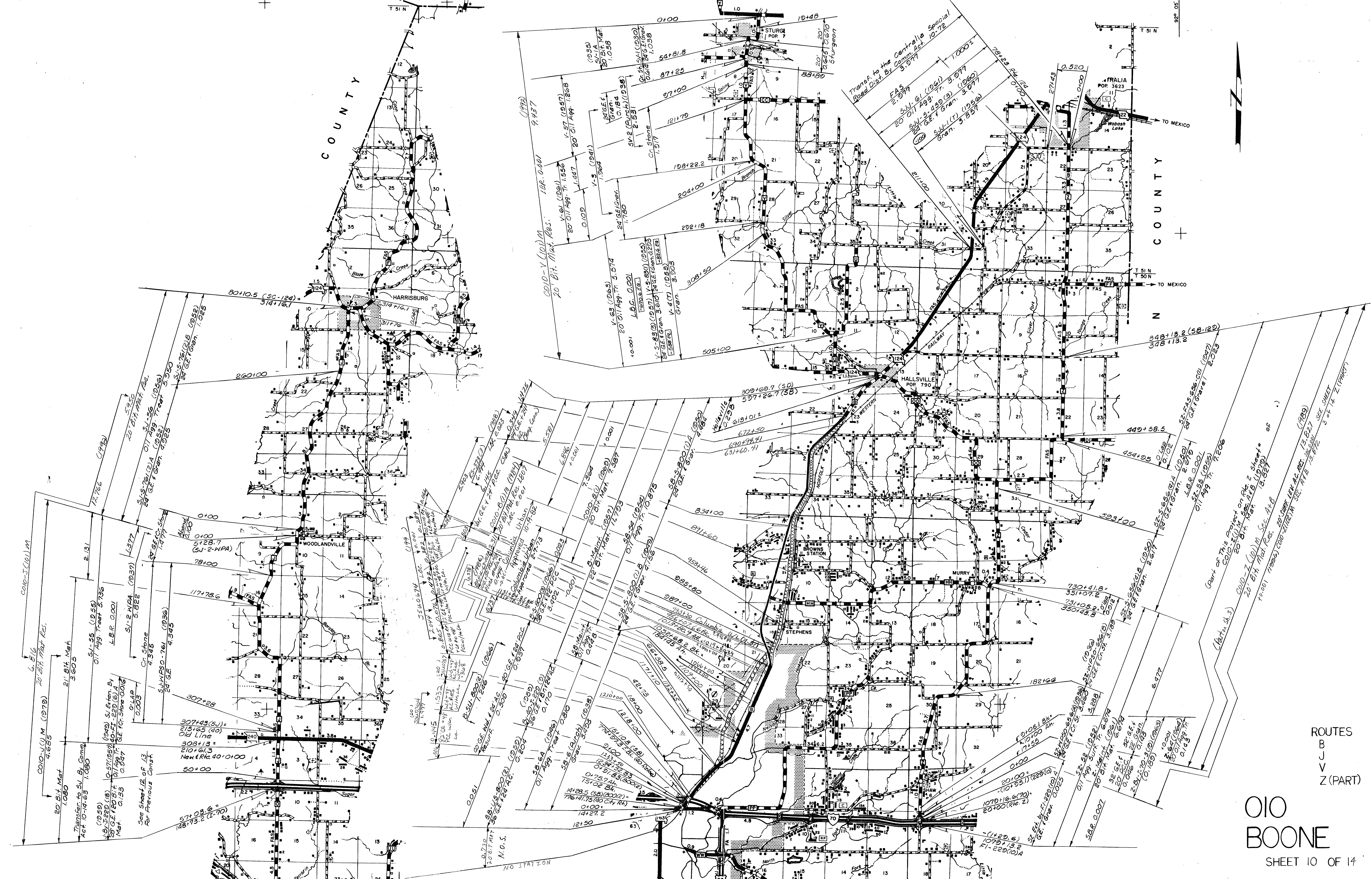

COUNTY

COUNTY



ROUTES
B
J
V
Z (PART)

OIO
BOONE

SHEET 10 OF 14

(Part of This Project on P.C. 2 Sheet # of
OIO-2 (10) M. Sec. 11 B
20' Bk. Mat. Res. 10-17-79
10001 1955) COO 2110 M. Sec. 11 B 10-17-79

See Sheet 12 of 13
For Previous Const.

NO STATION

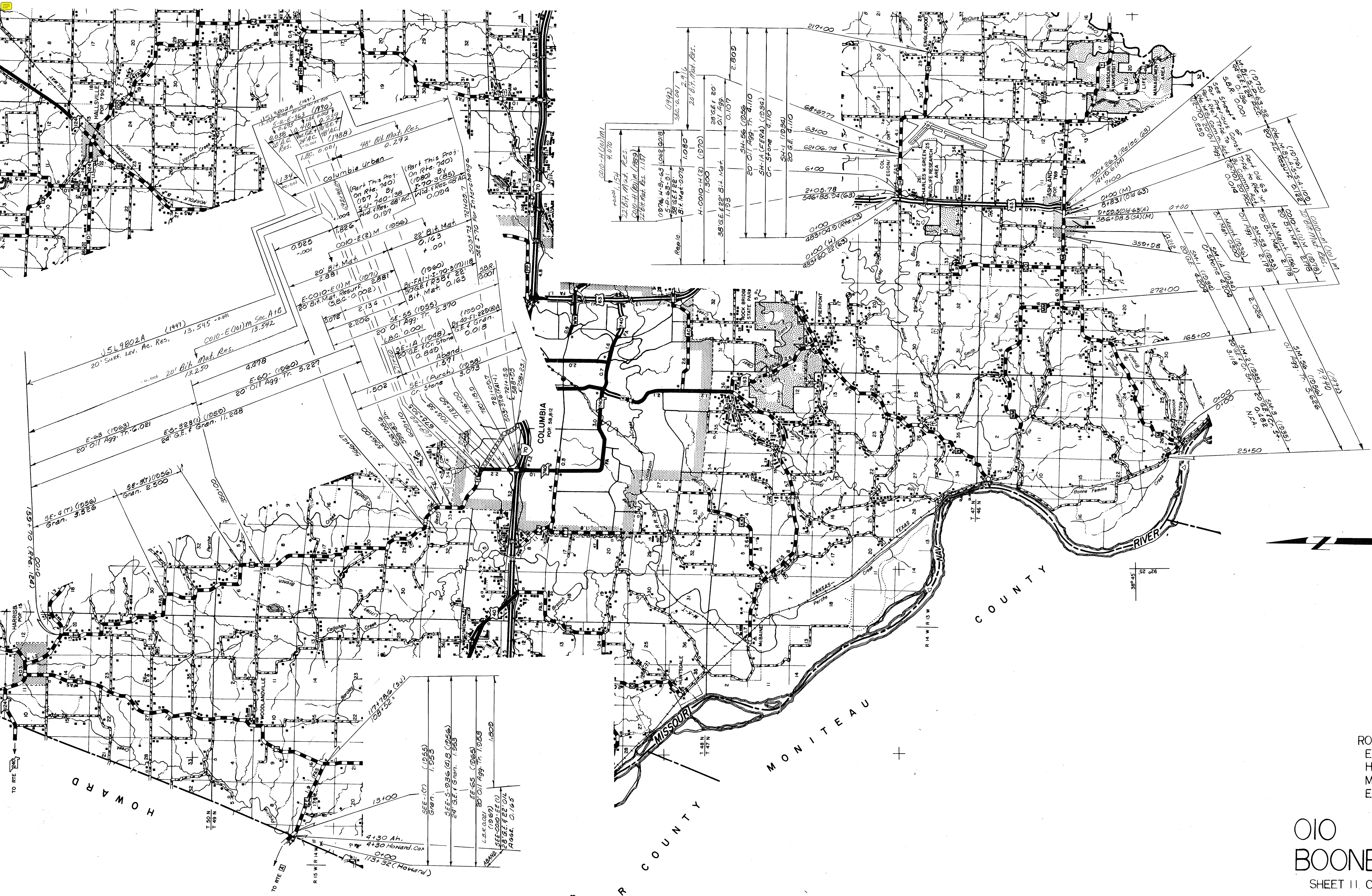

ROUTES
E
H
M
EE

OIO
BOONE

SHEET 11 OF 14

RANDOLPH COUNTY AUDRAIN COUNTY

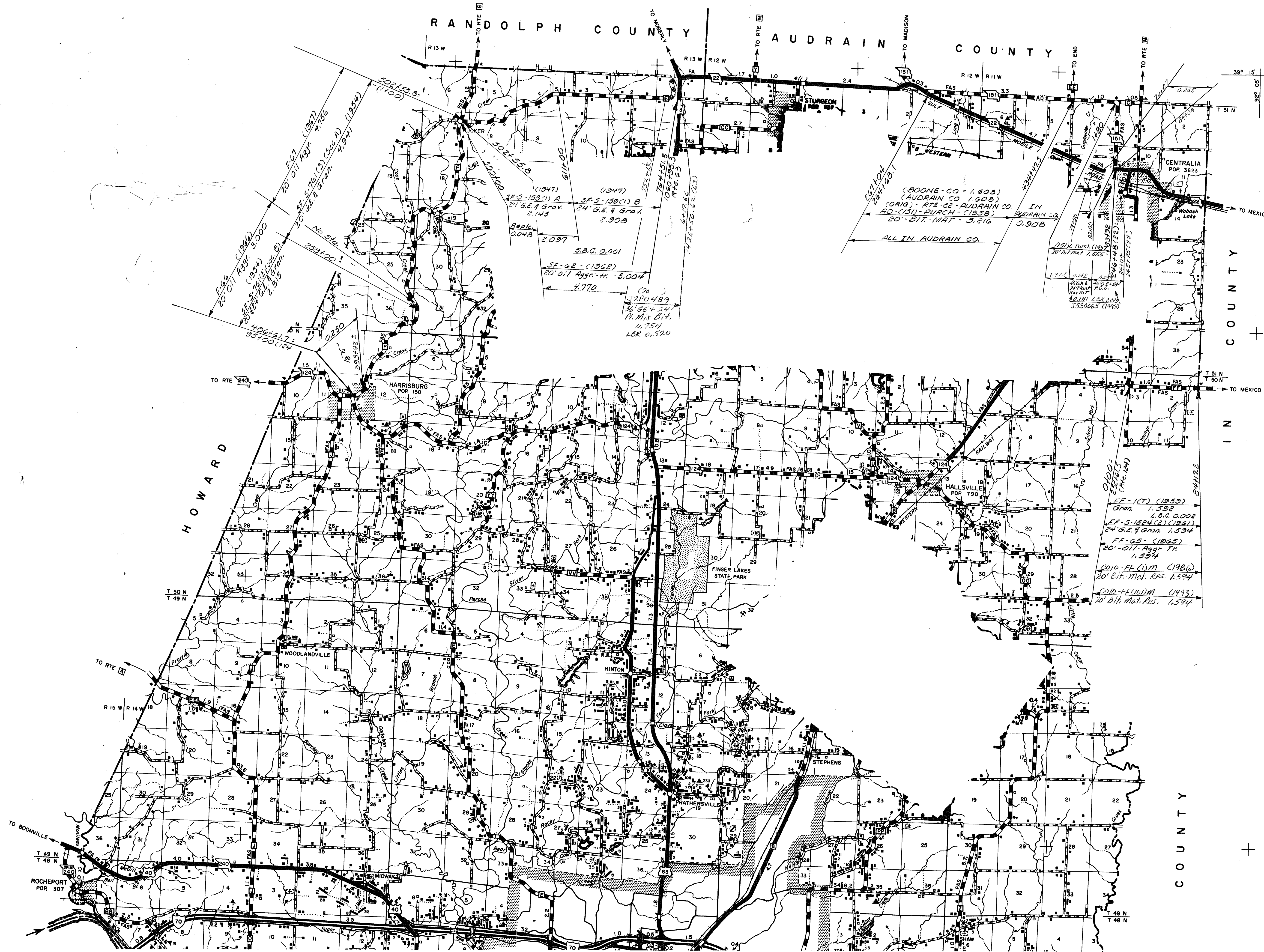

39° 15'

82° 05'

COUNTY

+

COUNTY

+

COUNTY

+

COUNTY

+

COUNTY

+

COUNTY

+

COUNTY

+

COUNTY

+

COUNTY

+

COUNTY

+

COUNTY

+

COUNTY

ROUTES
FF
151 (C-AD)
F

010
BOONE CO.

AUDRAIN

HOWARD

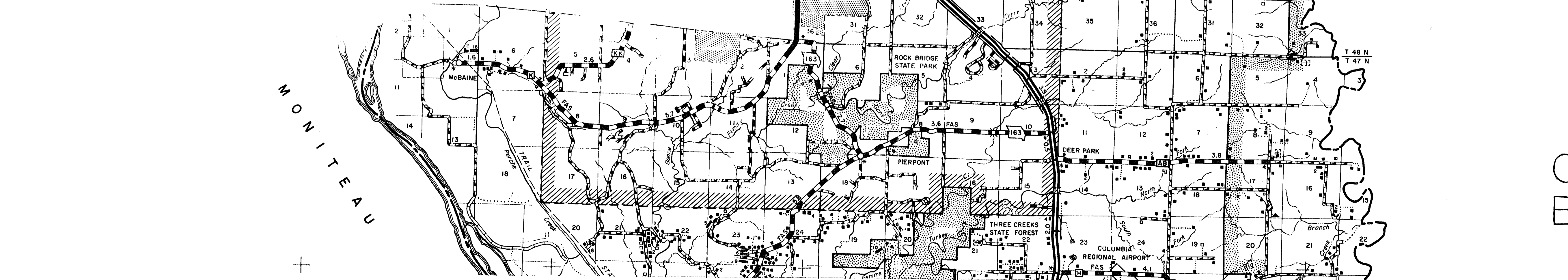
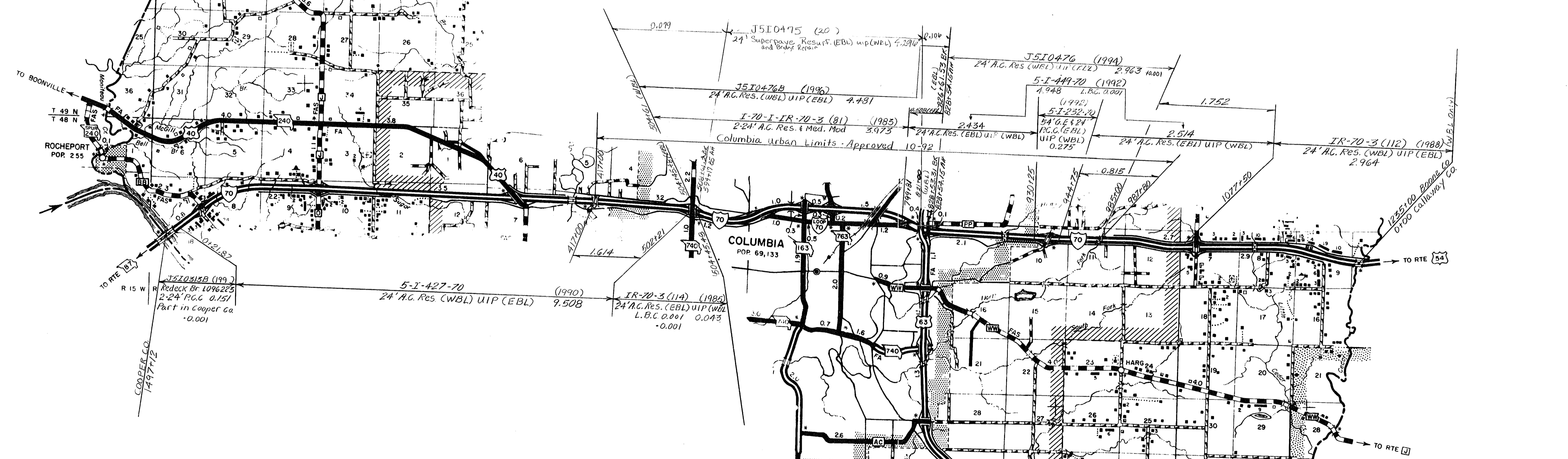
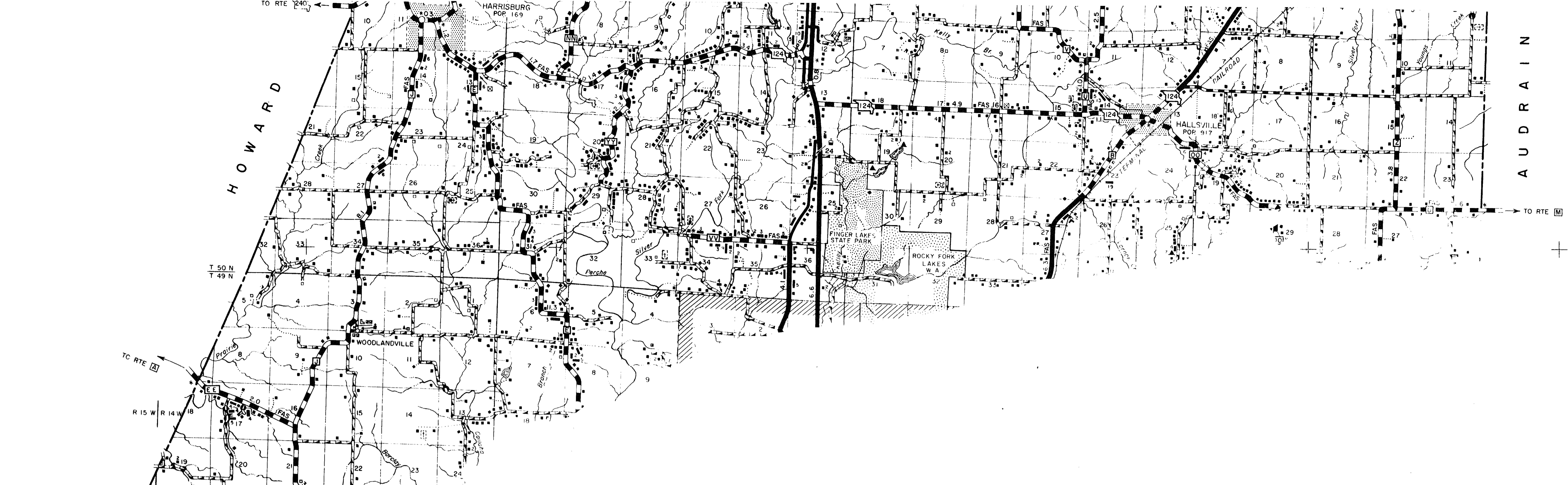

ROUTES 70 (PART)