

O F

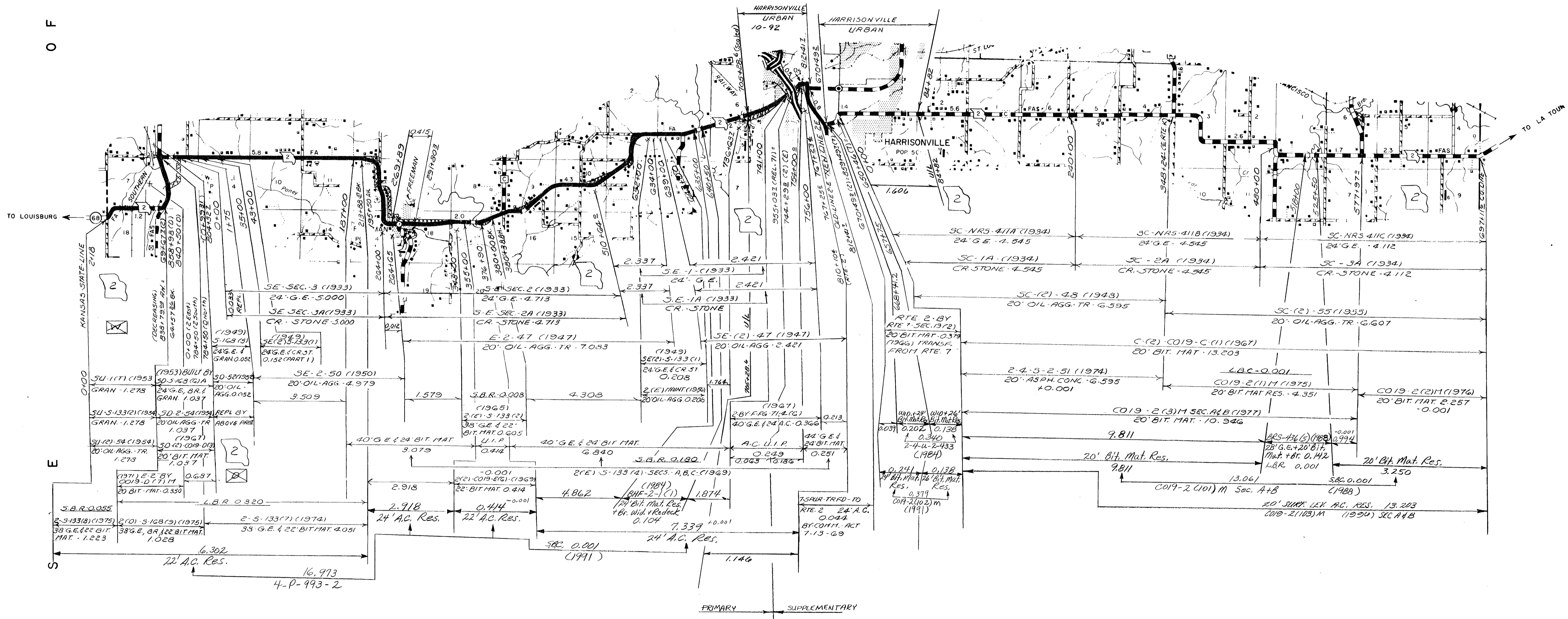

ROUTES:
2(U-D-E-11)

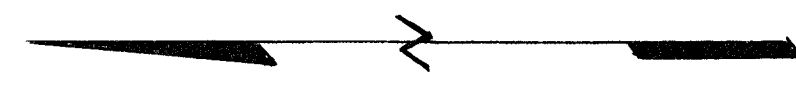
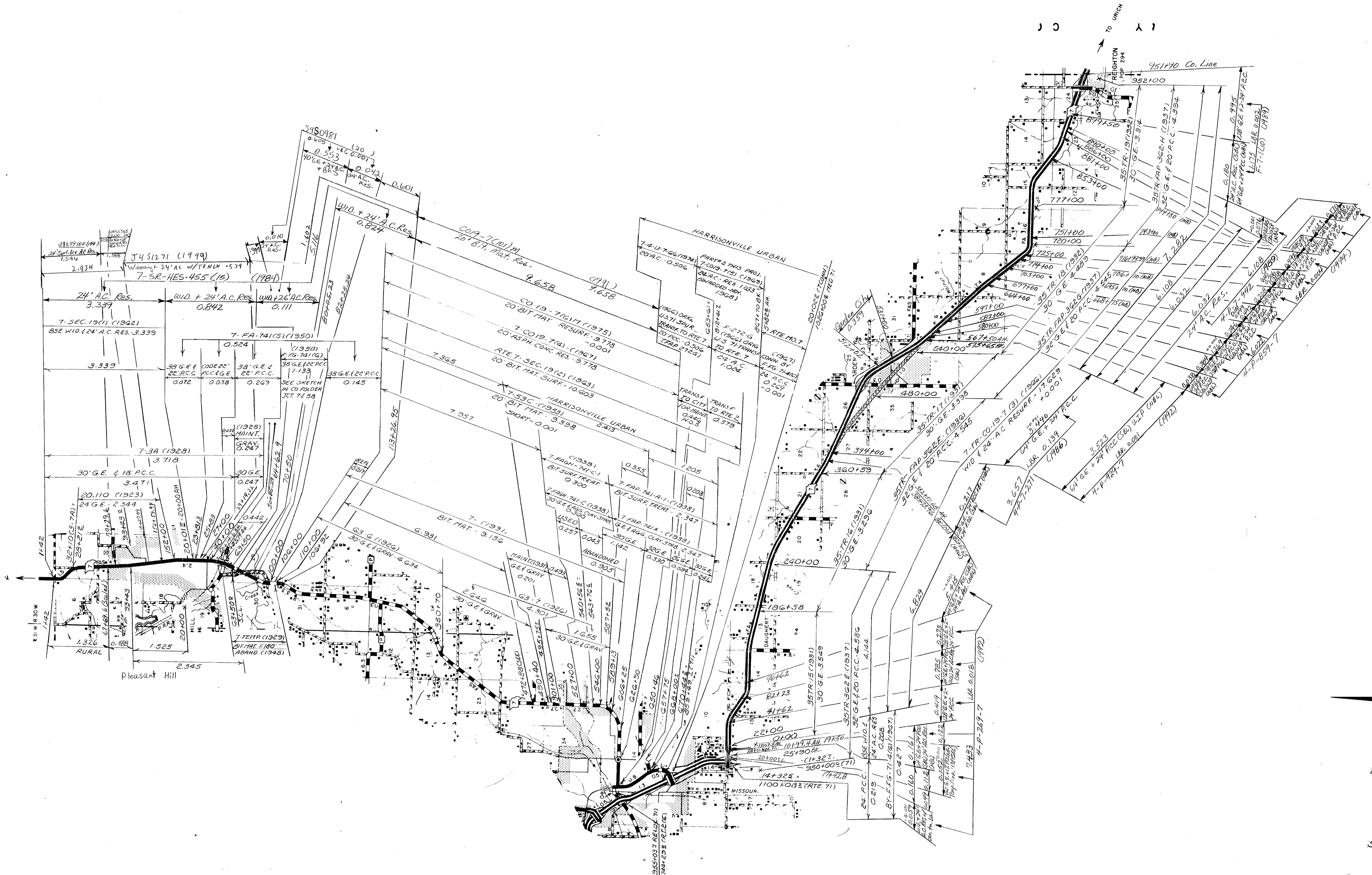

ROUTES:
7

SHEET 2 OF 13

④ 019
CASS

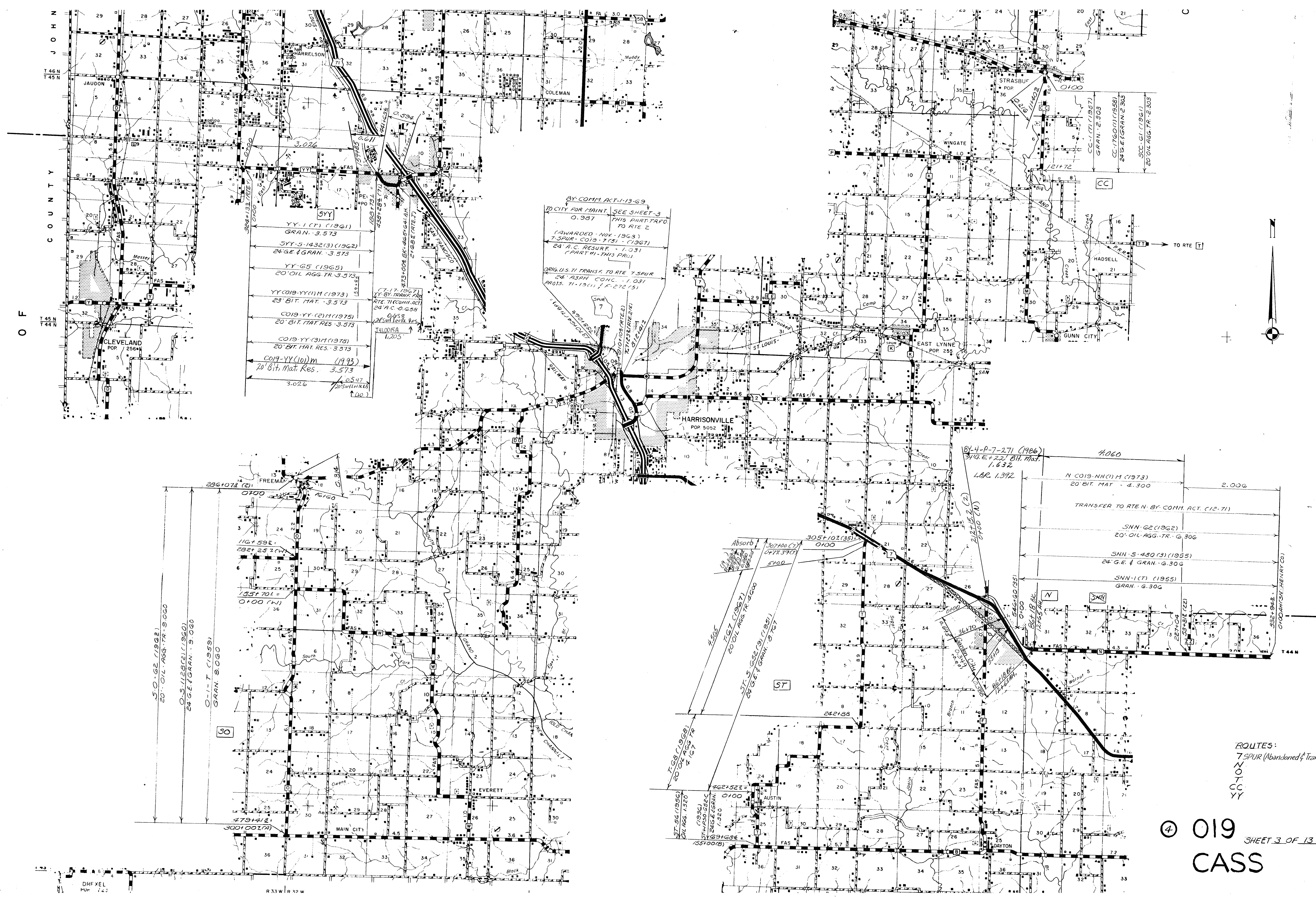

COUNTY OF JOHN

T. 46 N
T. 45 N
T. 45 N
T. 44 N

ROUTES:
7 SPUR (Abandoned & Transferred)
NOT
CASS

019 SHEET 3 OF 13
CASS

BY COMM. ACT. 1-13-69
TO CITY FOR MAINT. SEE SHEET 3
0.367 THIS PART TRFD.
TO RTE 2
(AWARDED - NOV. 1963)
7 SPUR - CO19-7 (5) - (1967)
24' A.C. RESURF. - 1.031
(PART 4 - THIS PROJ.)
ORIG. U.S. TRANS. TO RTE 7 SPUR
24' ASPH. CONC. - 1.031
PROJ. 11-19 (1) & F-272 (1)

YY-1 (1) (1961)
GRAN. 3.573
YY-5-1432 (3) (1962)
24' G.E. & GRAN. 3.573
YY-65 (1965)
20' OIL AGG. TR. 3.573
YY CO19-YY (1) (1973)
23' BIT. MAT. 3.573
CO19-YY (2) (1975)
20' BIT. MAT. RES. 3.573
CO19-YY (3) (1978)
20' BIT. MAT. RES. 3.573
CO19-YY (10) (1993)
20' Bit. Mat. Res. 3.573
3.026

BY 4-P-7-271 (1966)
SNG. E. 2.22' BIT. MAT.
1.632
L&R. 1.392
4.060
N CO19-NN (1) (1973)
20' BIT. MAT. - 4.300
TRANSFER TO RTE. N. BY COMM. ACT. (12-71)
SNN-62 (1962)
20' OIL AGG. TR. 6.306
SNN-5-480 (3) (1955)
24' G.E. & GRAN. 6.306
SNN-1 (1) (1955)
GRAN. 6.306

50-62 (1962)
20' OIL AGG. TR. 9.060
0-5-1-28 (2) (1960)
24' G.E. & GRAN. 9.060
0-1-T (1959)
GRAN. 9.060

Absorb
307,400 (1)
0.477,390 (1)
5400
F-67 (1967)
20' OIL AGG. TR. 5400
ST-S (2) (1961)
24' G.E. & GRAN. 8.767
462+523
0100
469+684
0100 (B)

DRFXEL
POP. 722

R. 33 W R. 32 W

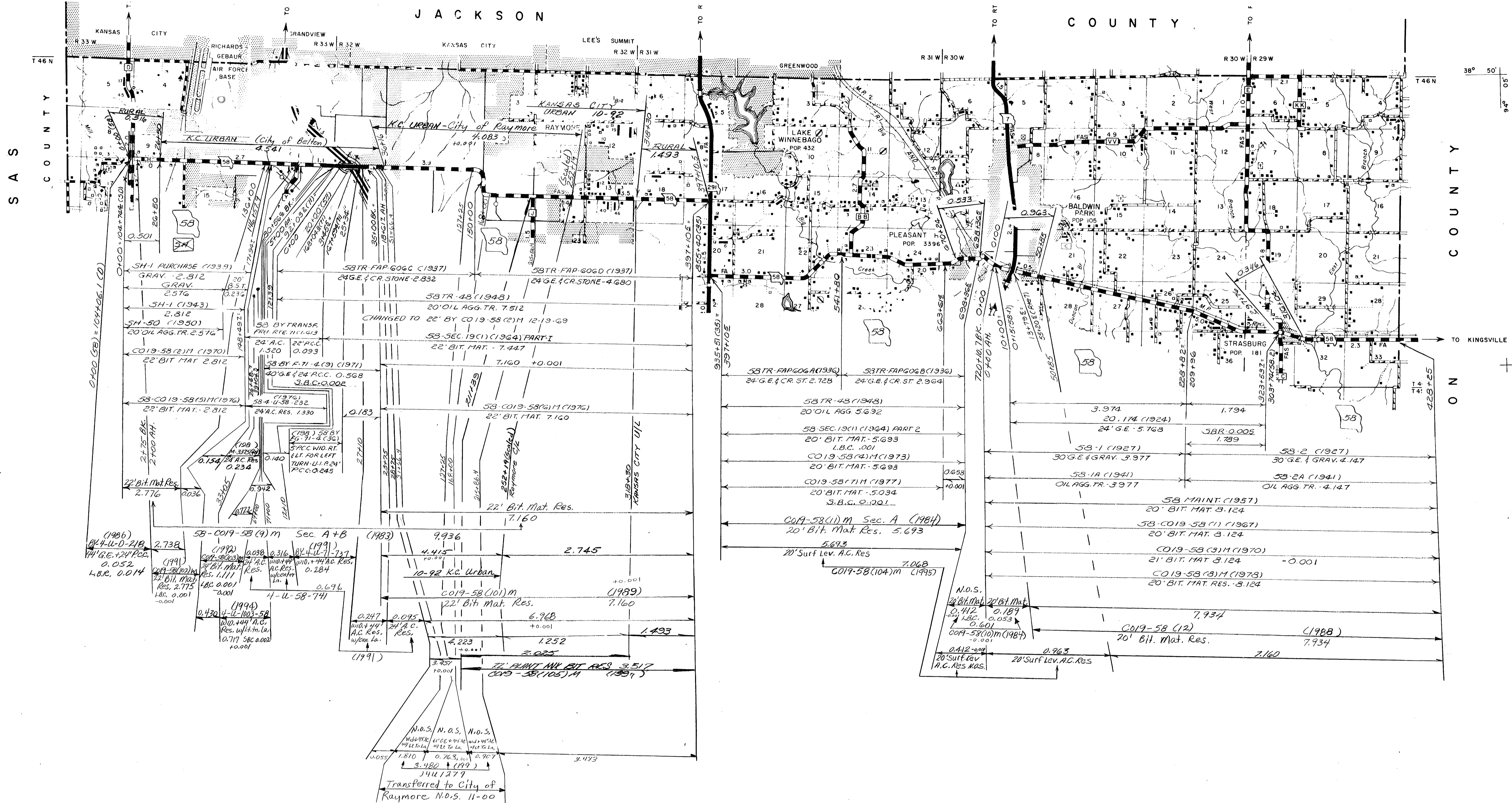

38° 50'
94° 05'

ROUTE:
58 (H)

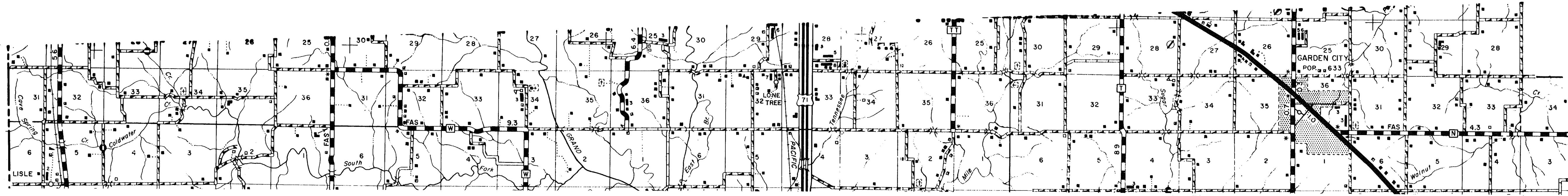

④ 019 SHEET 4 OF 13
CASS

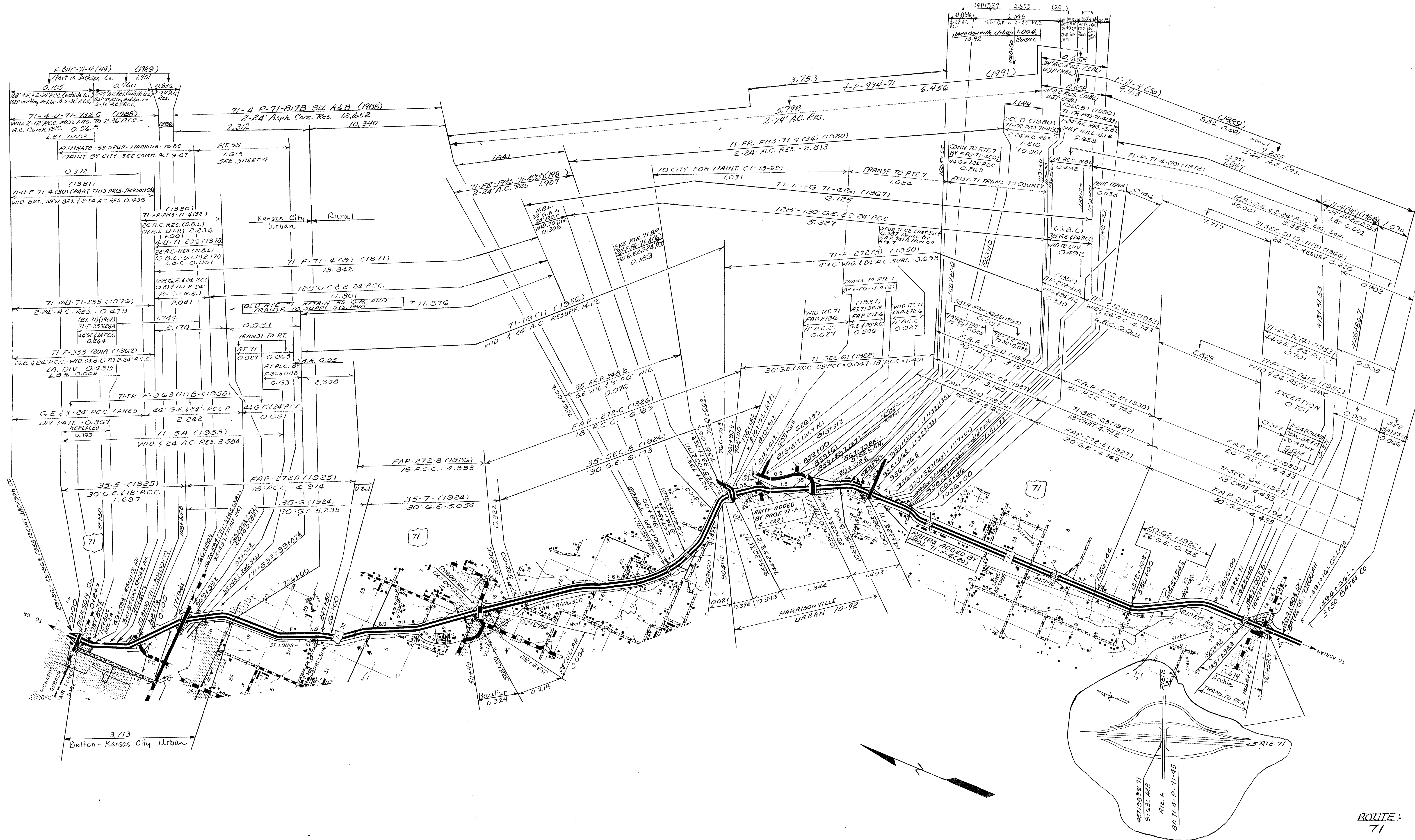

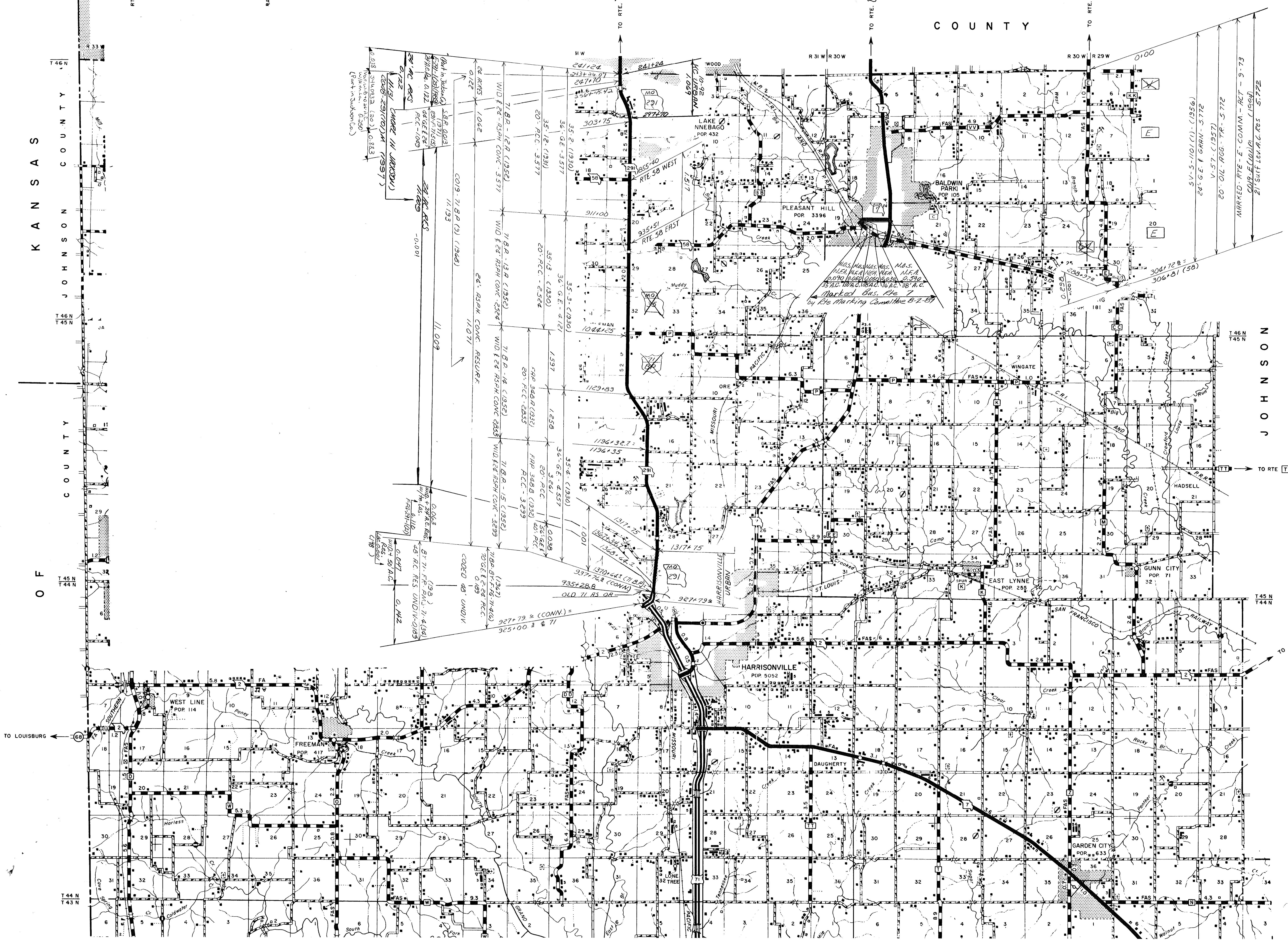

ROUTES:
291
E
Bus. 7

④ 019
CASS

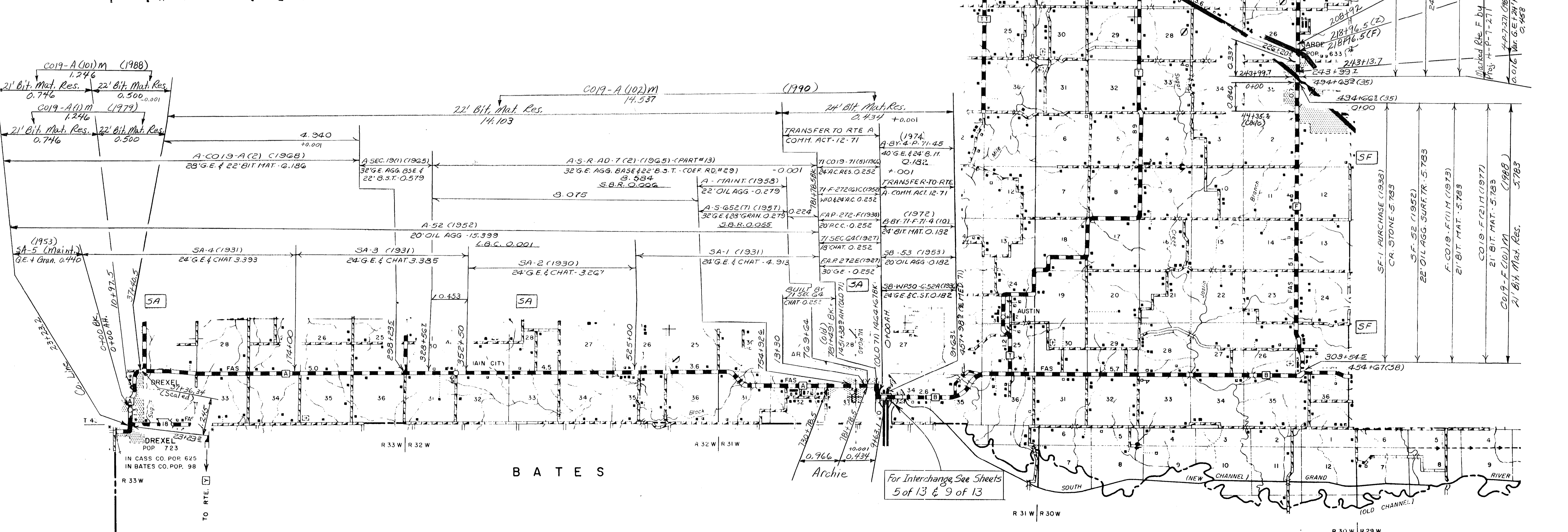
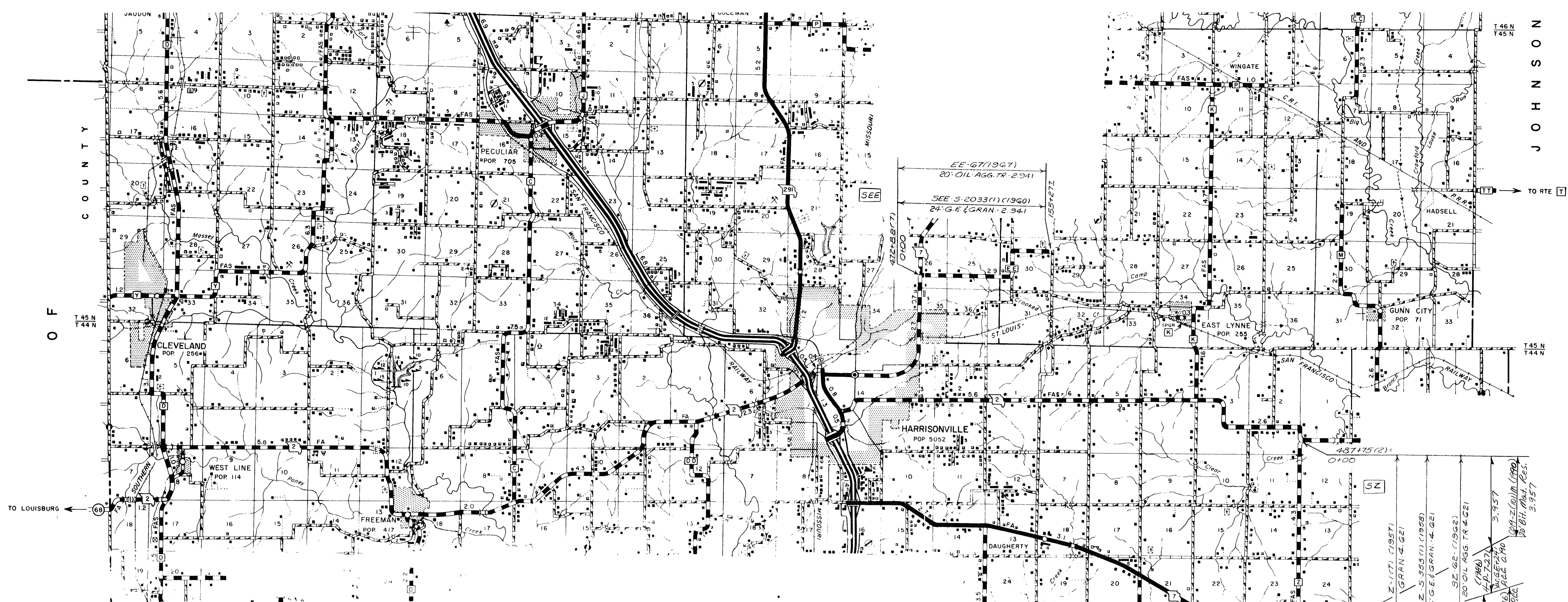

ROUTES:
 A
 Z
 EE

④
019
CASS
 SHEET 7 OF 13

For Interchange See Sheets
5 of 13 & 9 of 13

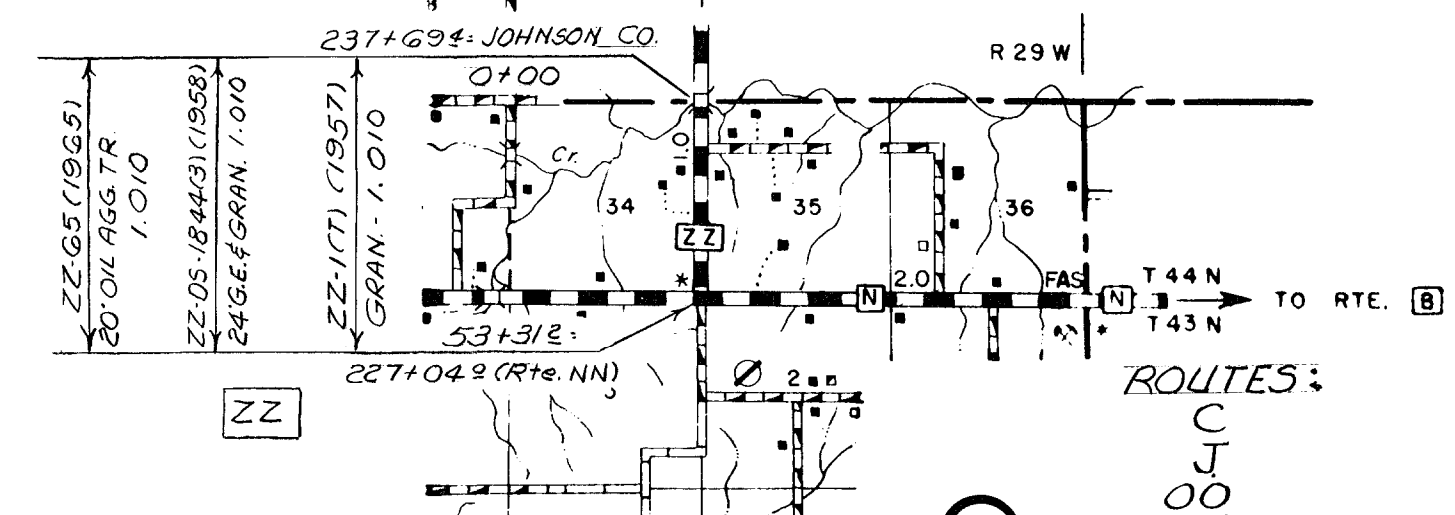
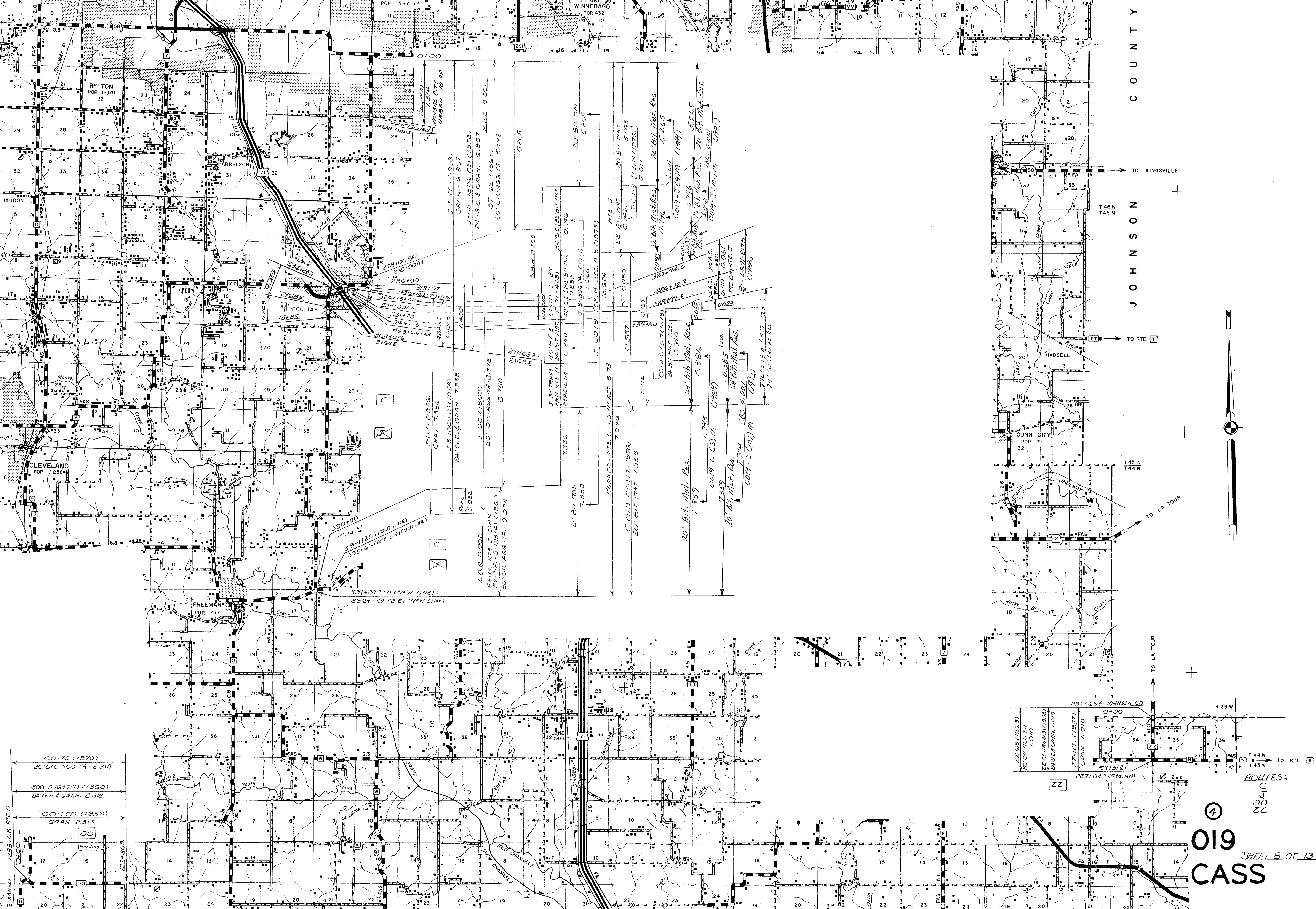
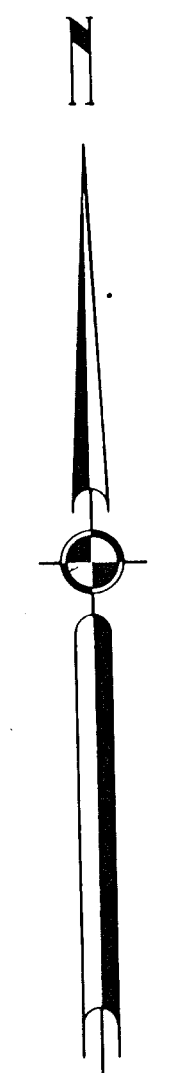

ROUTES:
C
J
00
ZZ

④

019
CASS

SHEET 8 OF 13

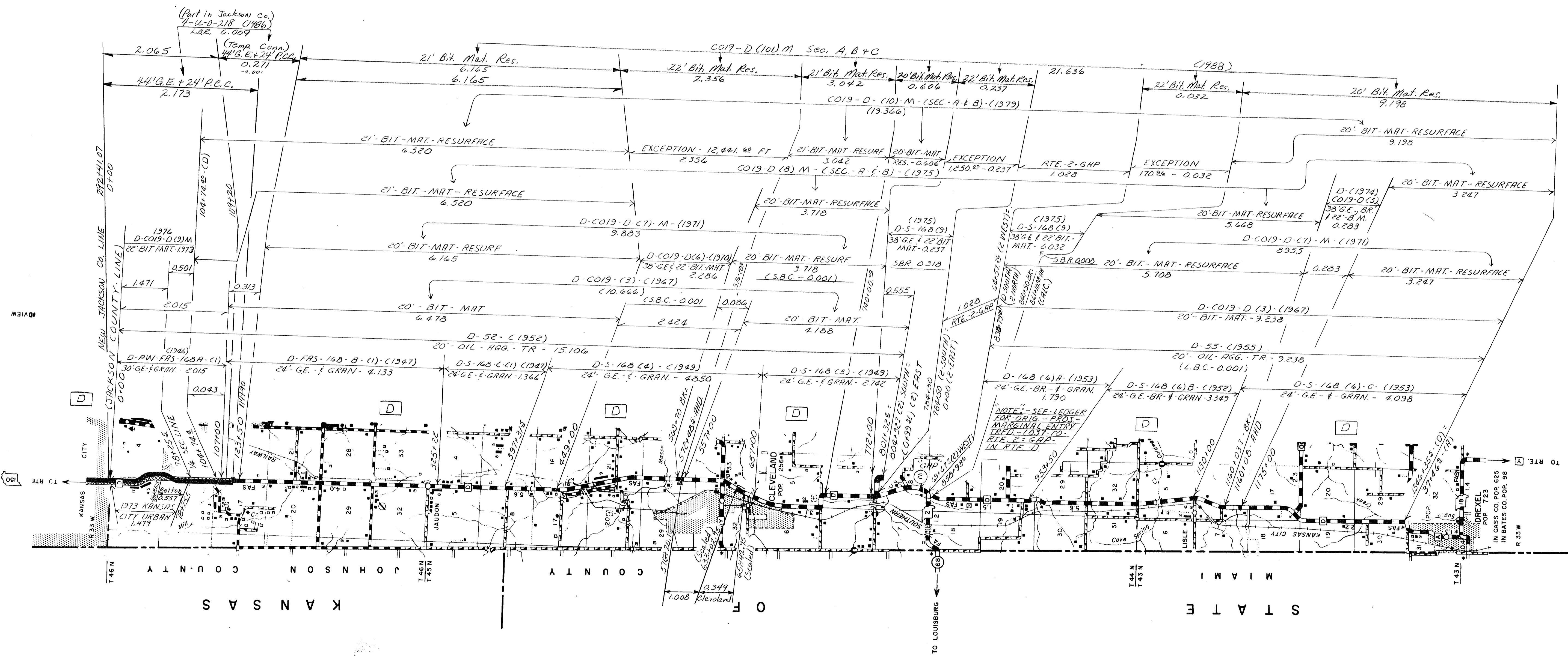
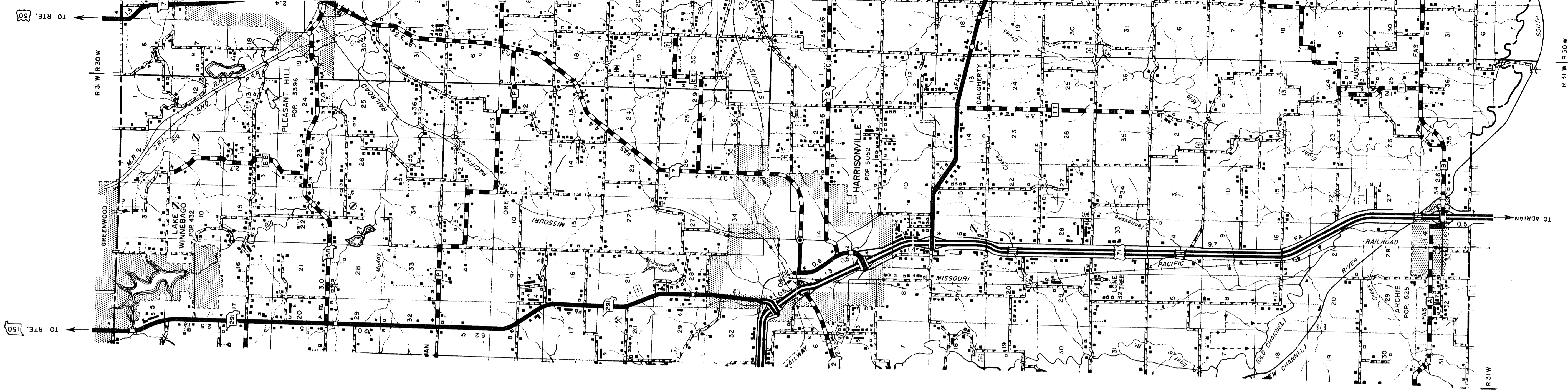

ROUTE D
 610
 CASS

JACKSON

KANSAS COUNTY

JOHNSON COUNTY

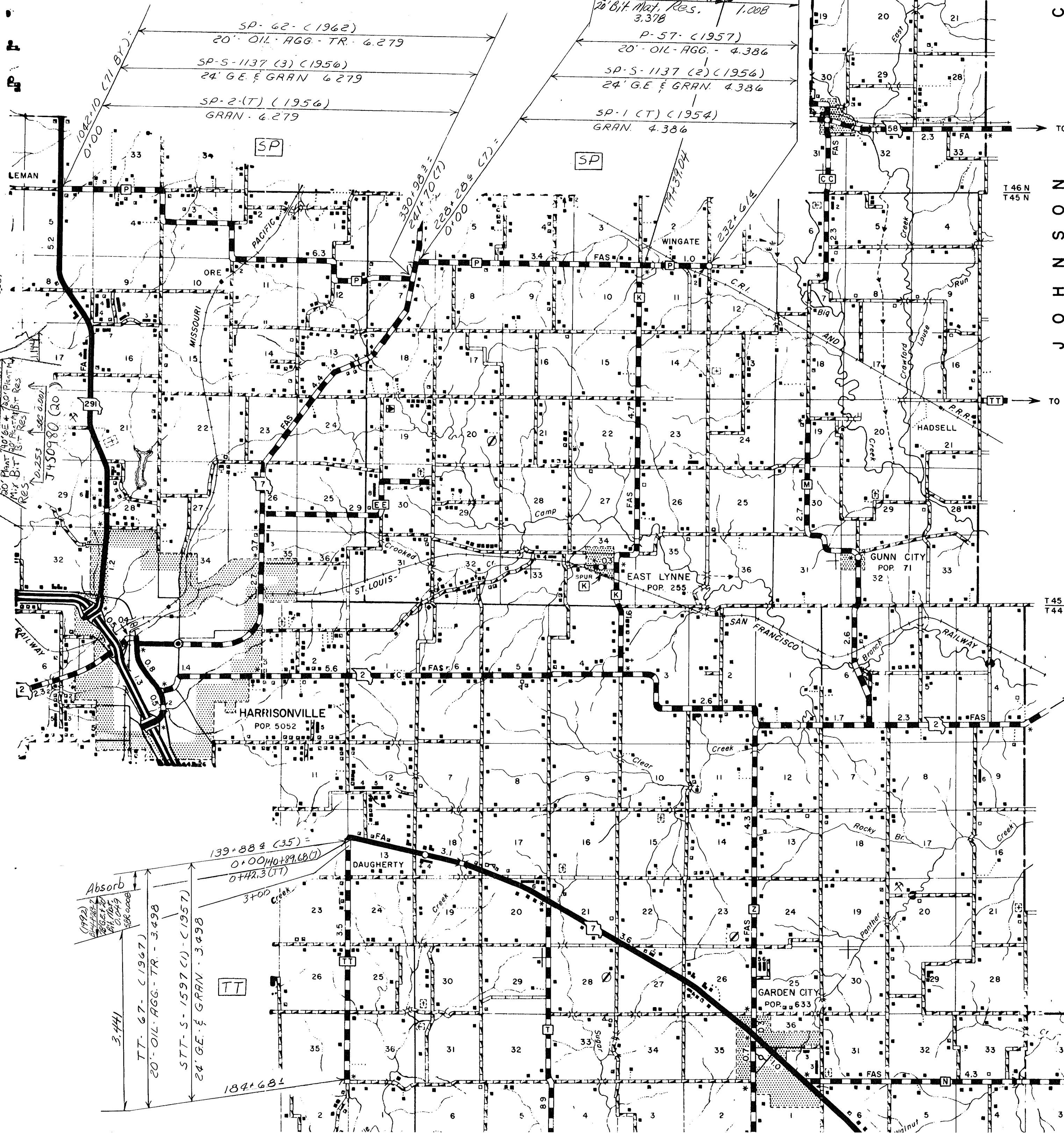
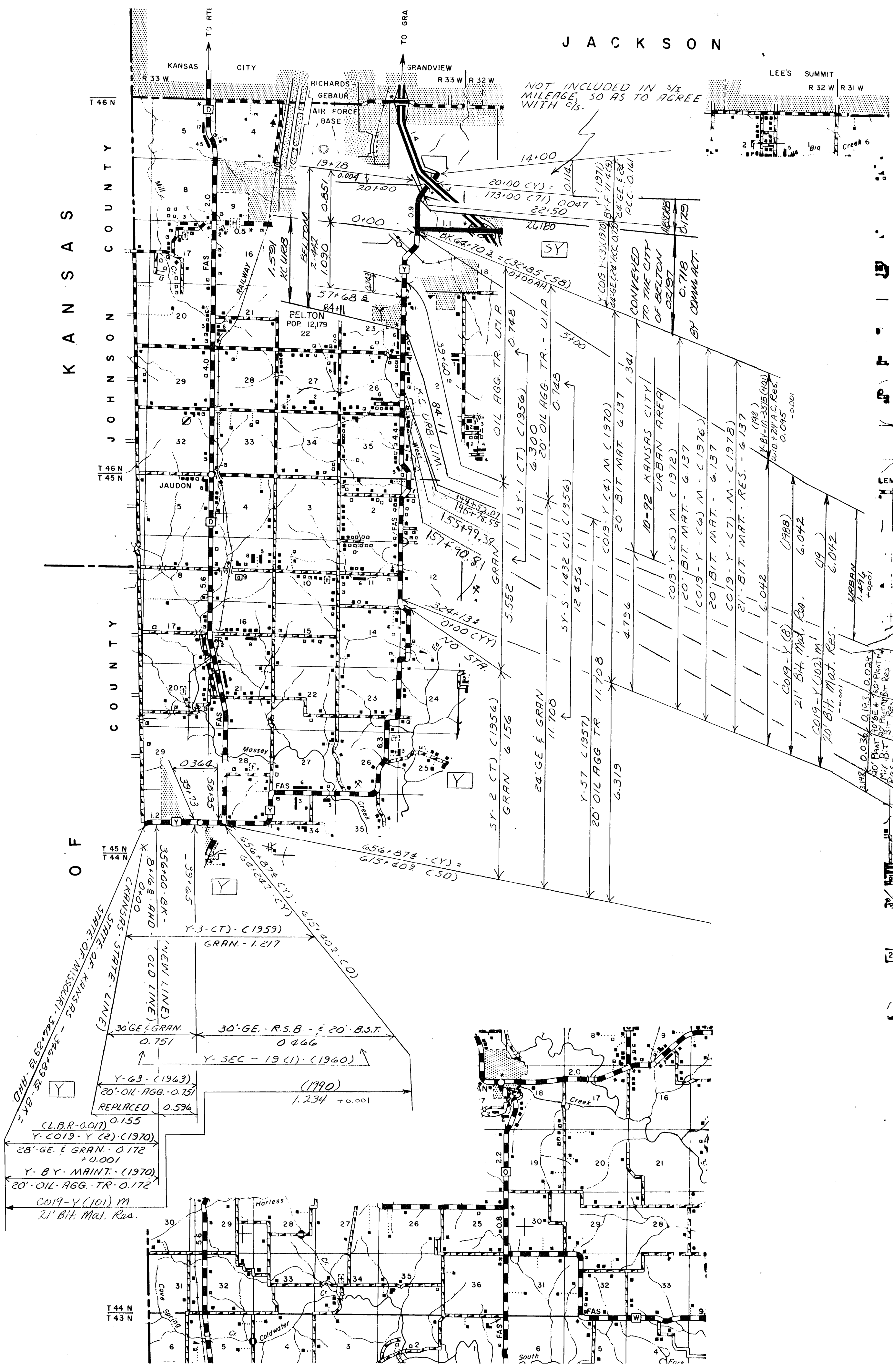

38° 50' 9"

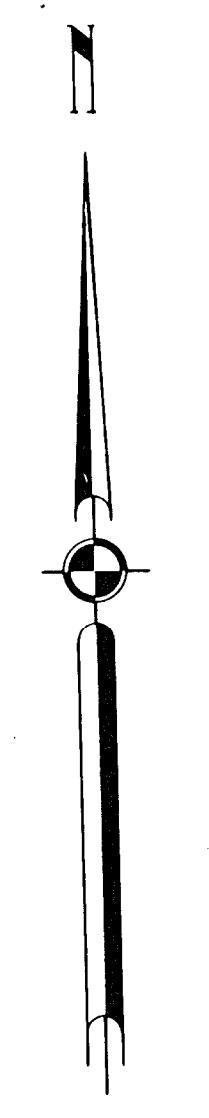

ROUTES
 Y
 P
 TT

SHEET 10 OF 13

④
 019
 CASS

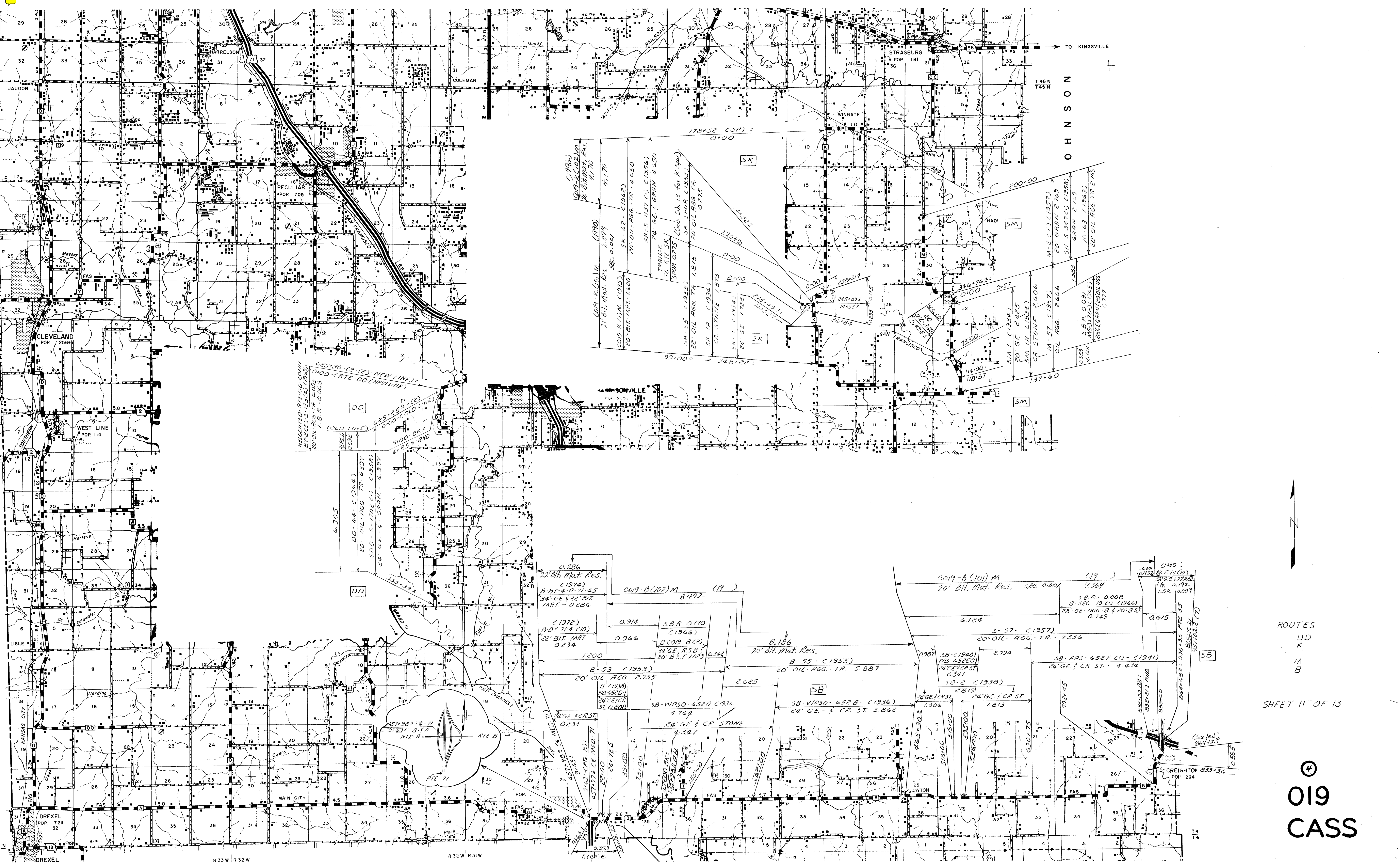

OHNSON

TO KINGSVILLE

ROUTES
DD
K
M
B

SHEET 11 OF 13

019
CASS

625+30 - (2) (C) - NEW LINE
0+00 - CRTE DD (NEW LINE)
REPORTED - RTE DD, CONN
BY E.C.E.S. 1231 (L) (1963)
20' OIL AGG TR 0.035
L.B.R. 0.003

DD
6.305
DD
DD

0.286
22' Bit. Mat. Res.
(1974)
B-BY-4-P-71-45
34' GE & 22' BIT-
MART - 0.286

0.914
0.966
1.200
0.342
2.025

0.615
0.749
0.615
0.749

2.794
4.434
1.813

SB

(Scaled)
864125

T4
T4

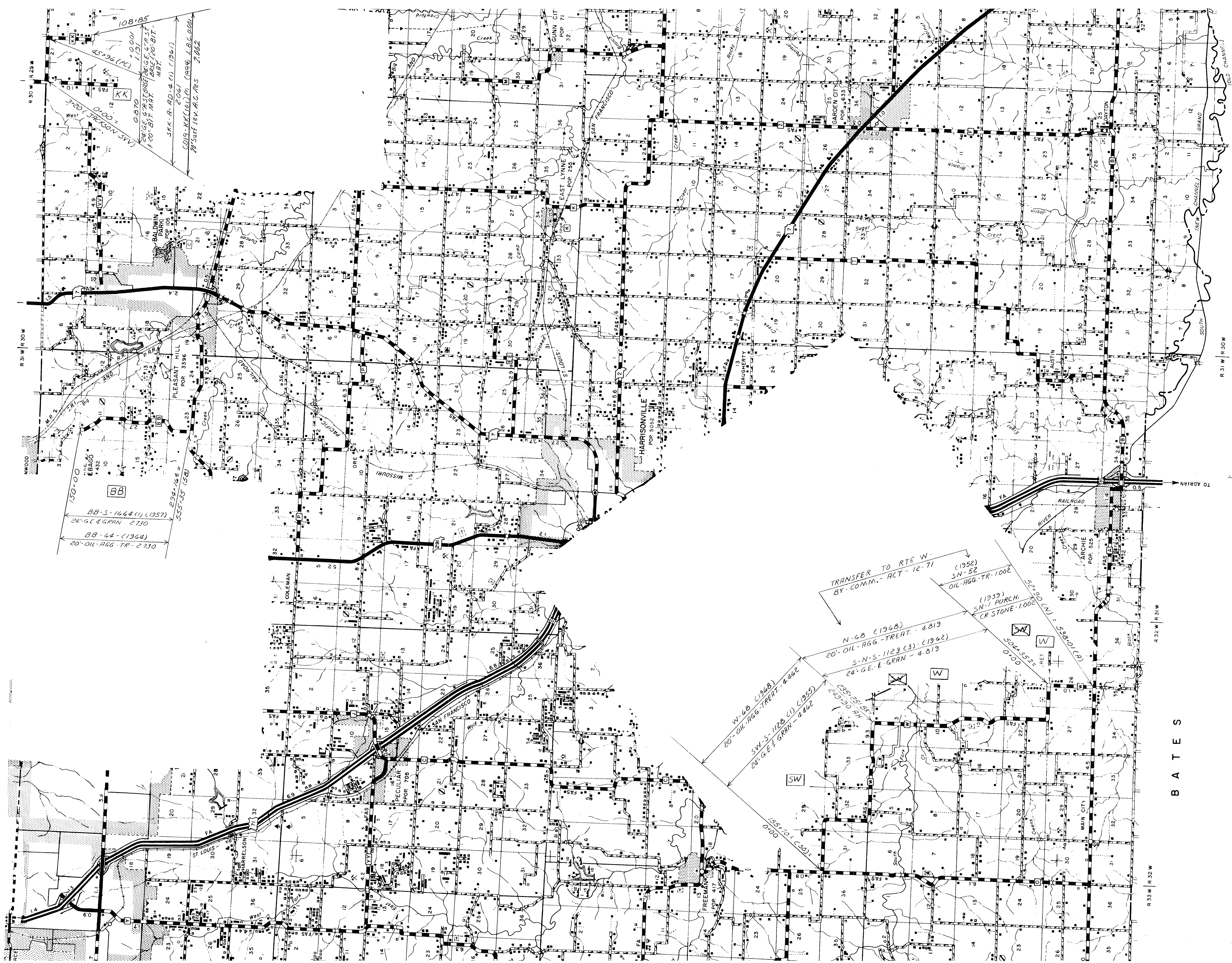

COUNTY

ROUTES:
 KK
 BB
 W (PART)

SHEET 12 OF 13

④
 019
 CASS

JACKSON

COUNTY

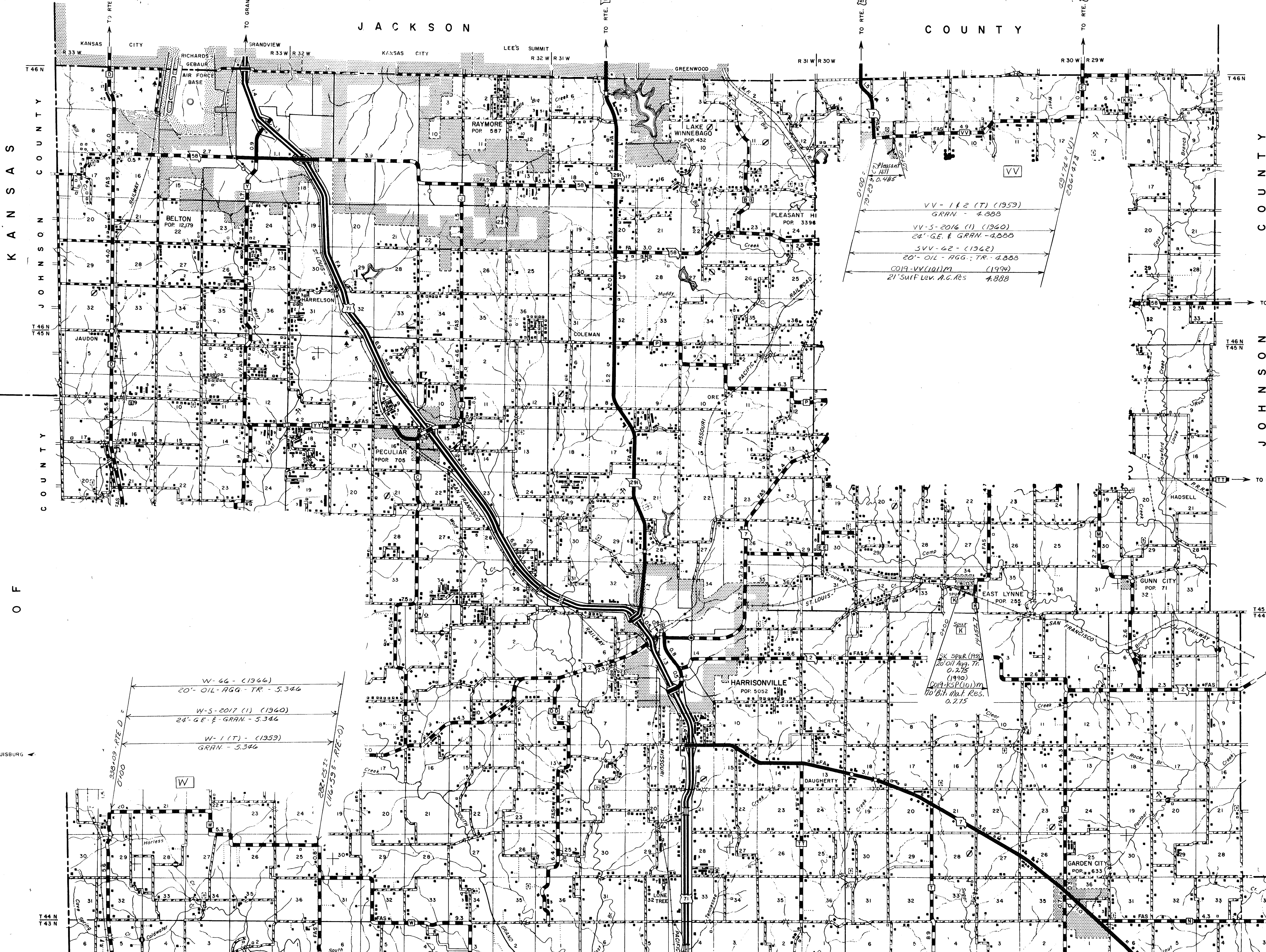

VV-142 (T) (1959)
 GRAN - 4,888

VV-5-2016 (1) (1940)
 24'-GE. & GRAN - 4,888

SVV-62 - (1942)
 20'-OIL - AGG.; TR. - 4,888

CO19-VV(10)M (1994)
 21'Surf Lev. A.G. Res. 4,888

W-66 - (1944)
 20'-OIL - AGG - TR - 5,346

W-5-2017 (1) (1940)
 24'-GE. & GRAN - 5,346

W-1 (T) - (1959)
 GRAN - 5,346

SK Spur (1990)
 20' Oil Agg. Tr.
 0.275
 (1990)
 CO19-KSP(10)M
 70' Bit. Mat. Res.
 0.275

ROUTE :
 VV
 W (PART)
 K Spur
 SHEET 13 OF 13

④
 019
 CASS

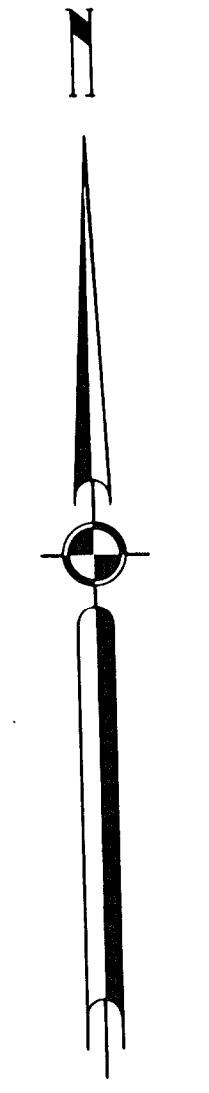

38° 50'
 94° 05'

TO LOUISBURG

TO KINGSVILLE

TO RTE 1

TO LA TOUR

T 46 N
T 45 N
T 44 N

R 33 W R 32 W R 31 W R 30 W R 29 W

KANSAS COUNTY
JOHNSON COUNTY
OF

JOHNSON COUNTY