

MILLERY COUNTY

026
COLE CO.

ROUTES 50 History
50BUS.
63SPUR

SHEET 1 OF 9

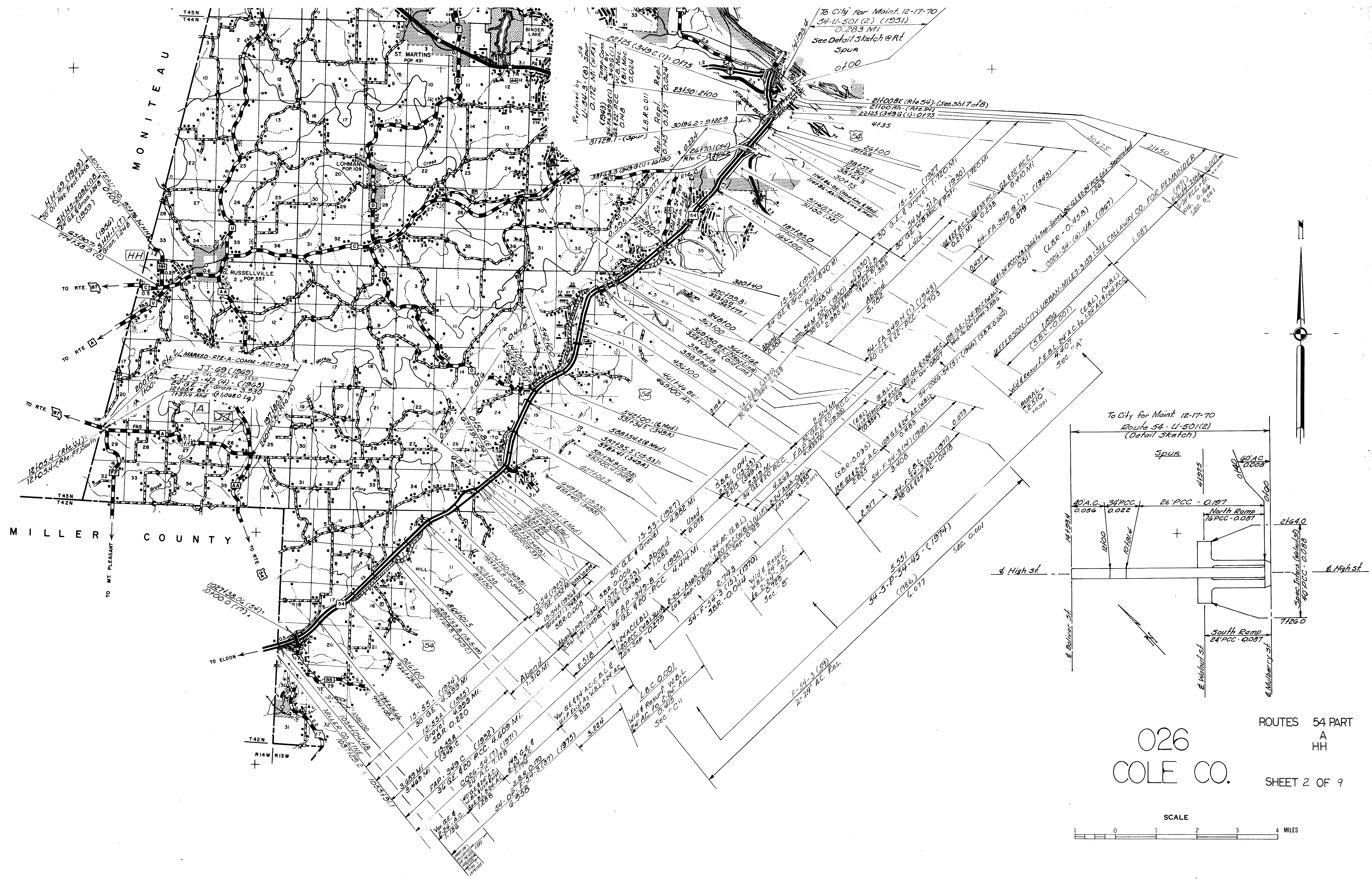

026
COLE CO.

ROUTES 54 PART
A
HH

SHEET 2 OF 9

SCALE

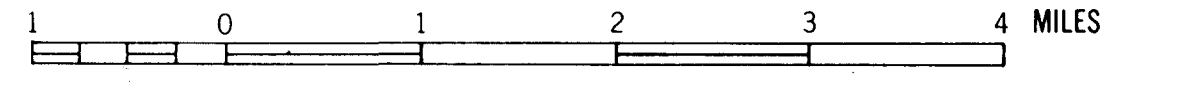

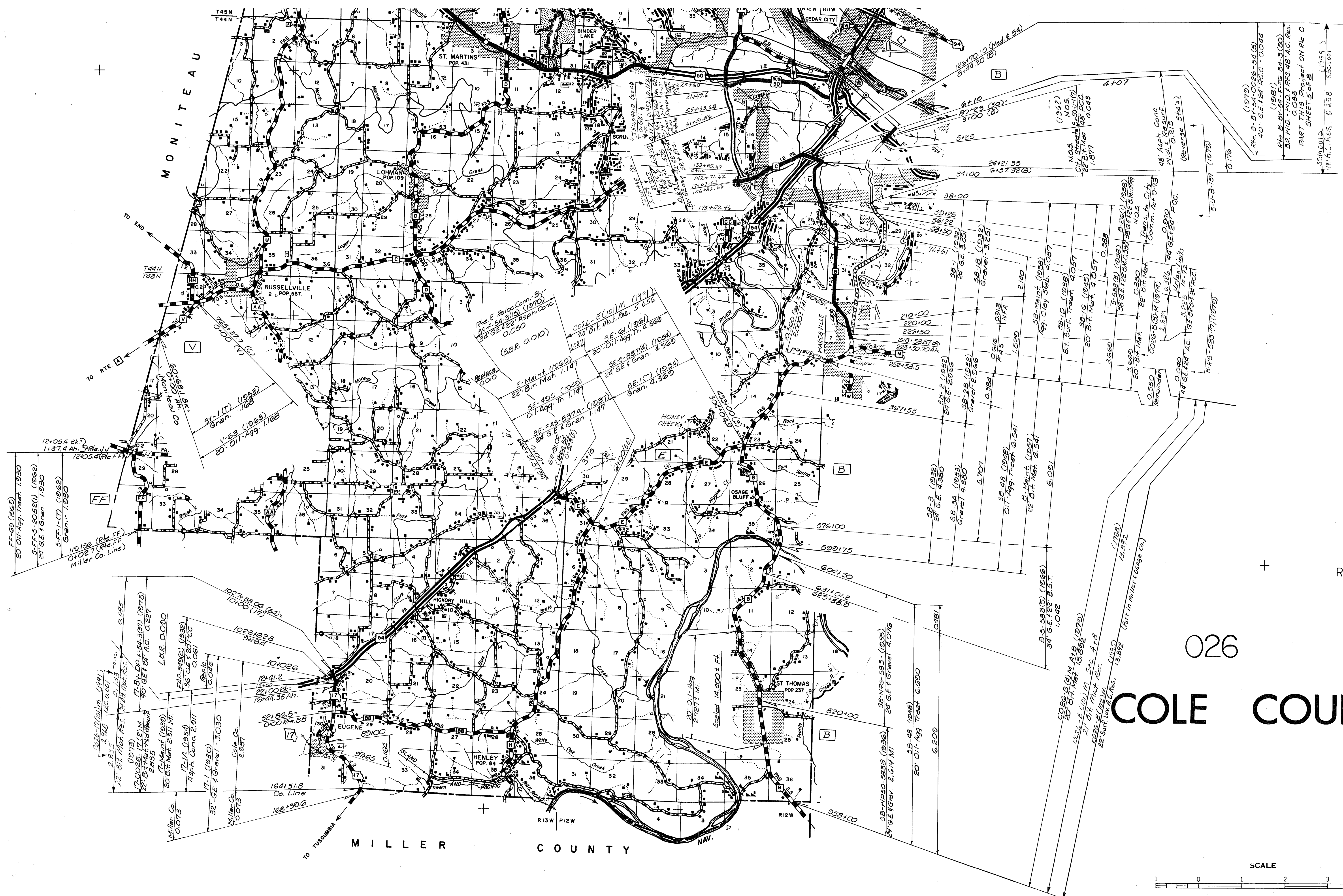

026
COLE COUNTY

ROUTES
 B
 17
 V
 F
 F
 E
 179 (Part)

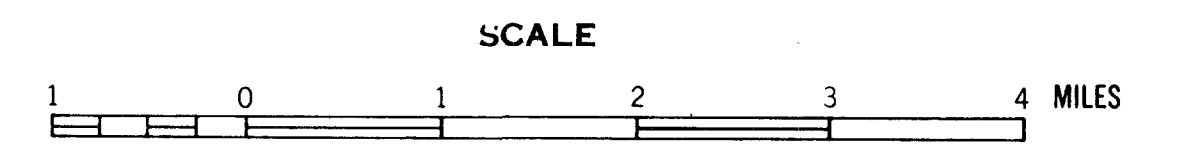

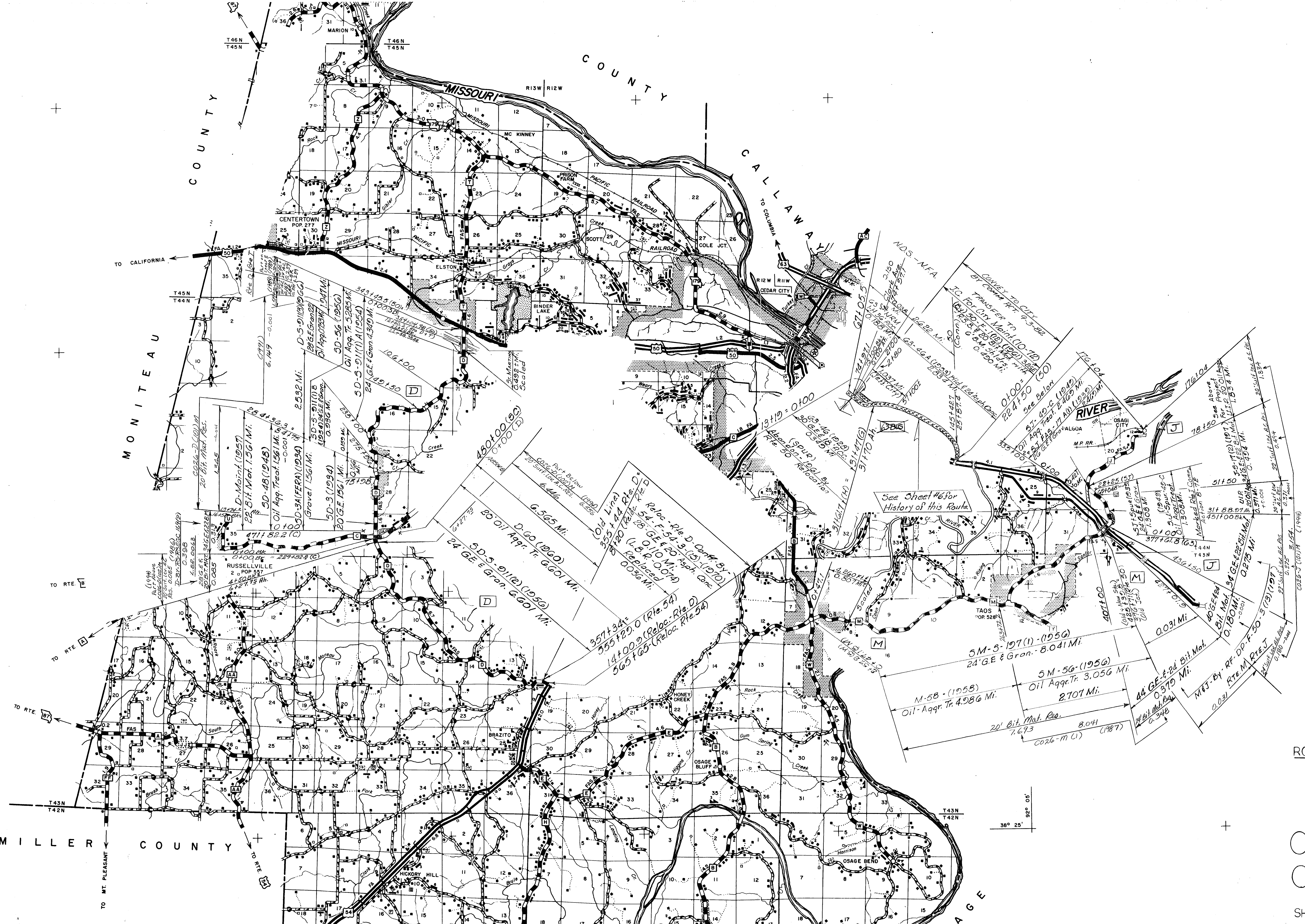

ROUTES: - BUS. 63 (ABAND)
 D
 J
 M
 T Part
 026
 COLE
 SHEET 4 OF 9

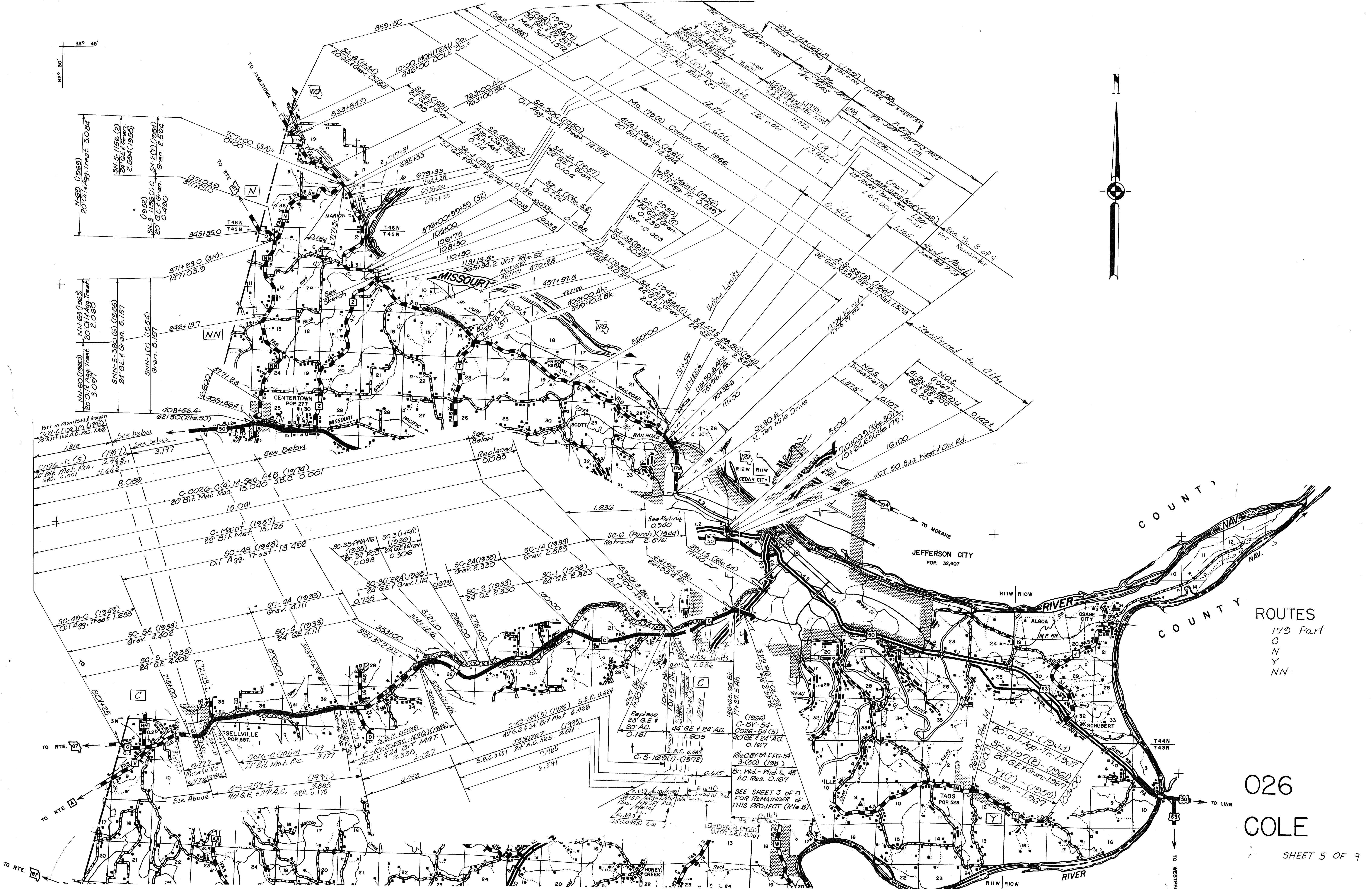

ROUTES
 179 Part
 C
 N
 Y
 NN

026
 COLE

SHEET 5 OF 9

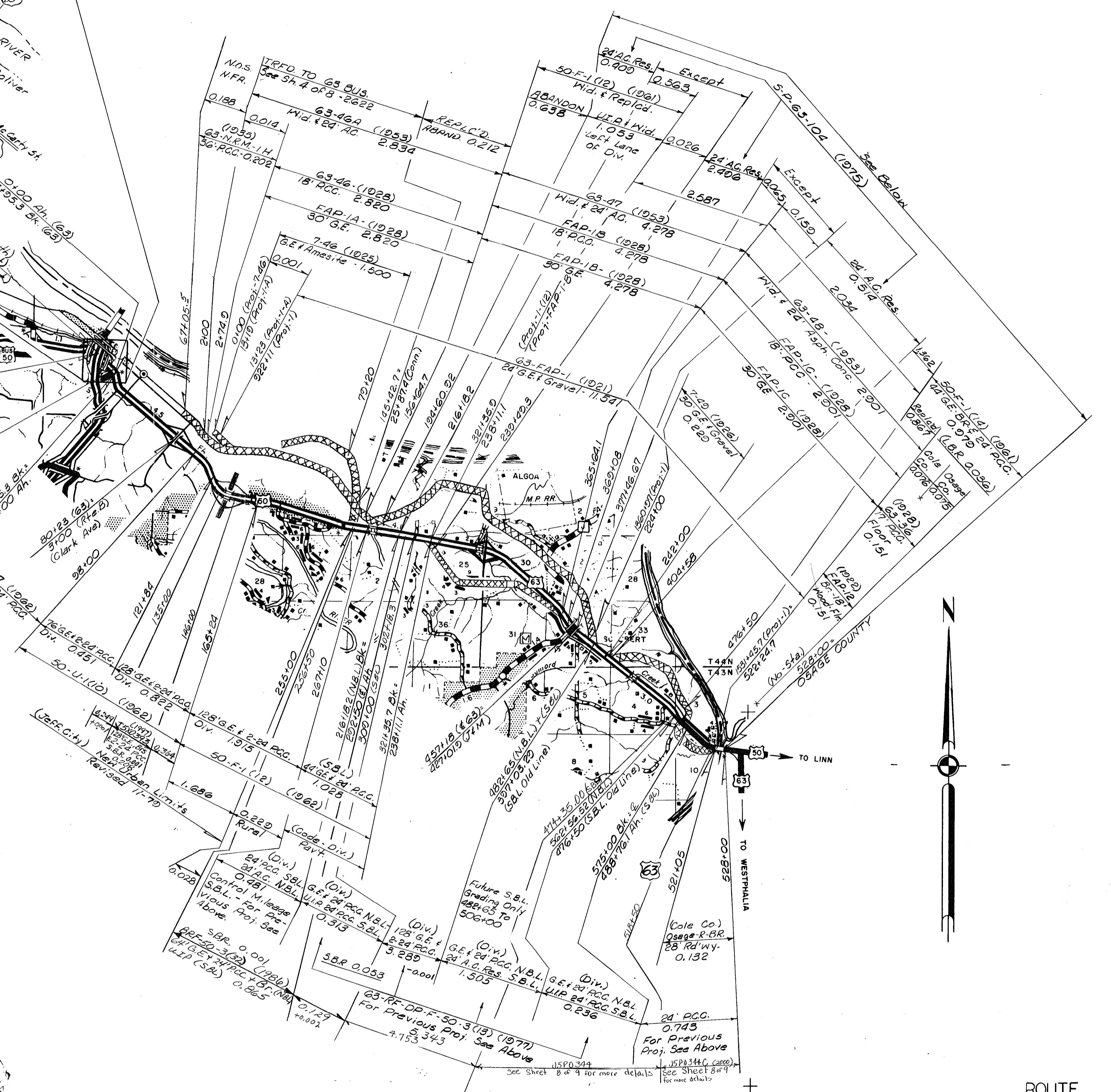
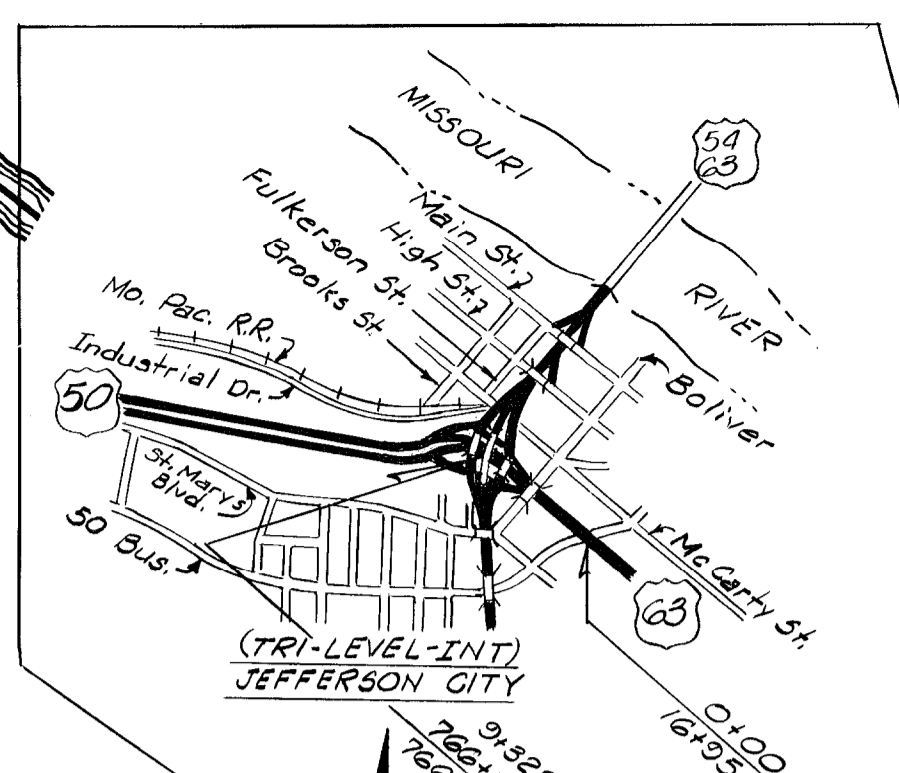
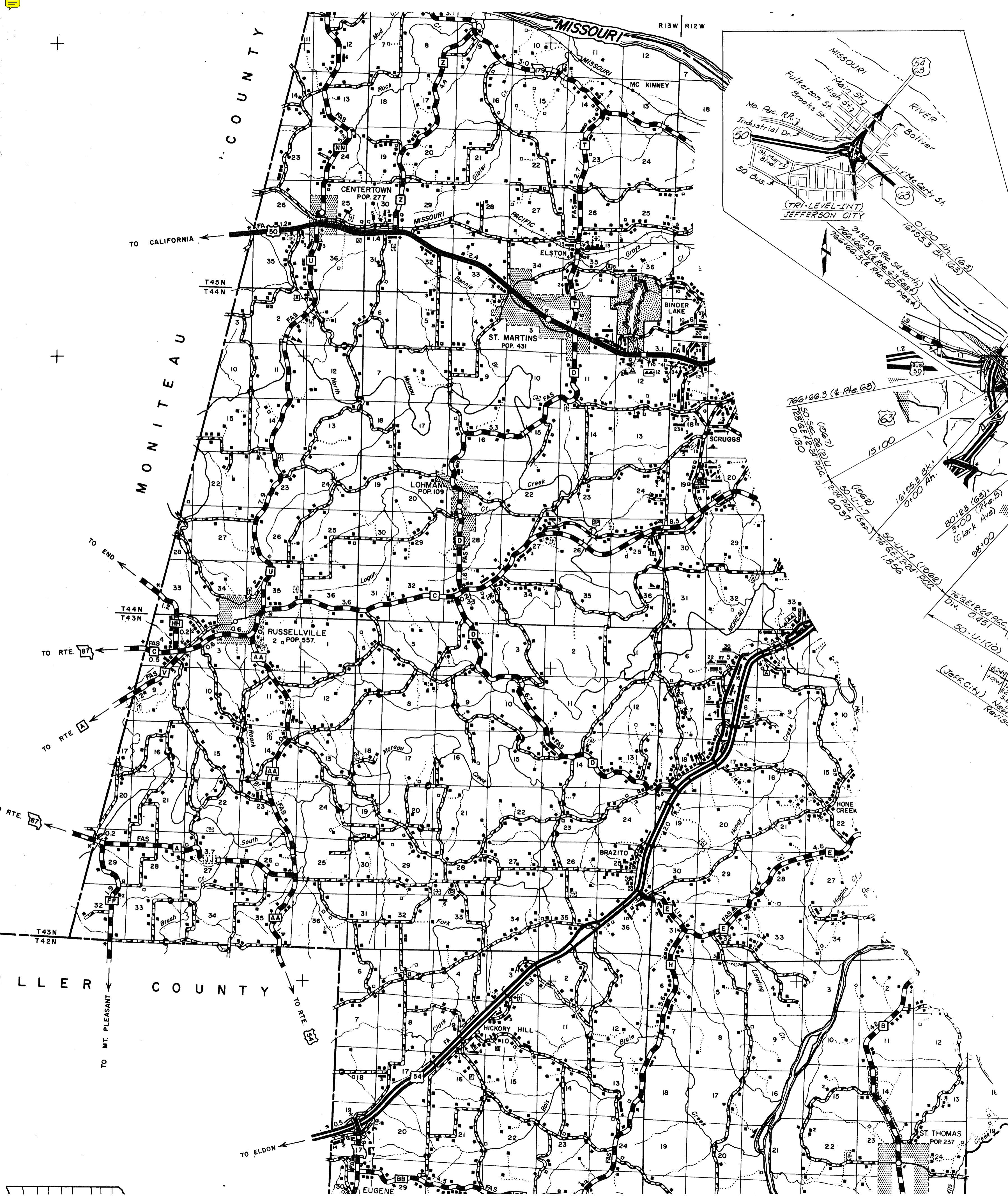

ROUTE
63 Part

026
COLE COUNTY

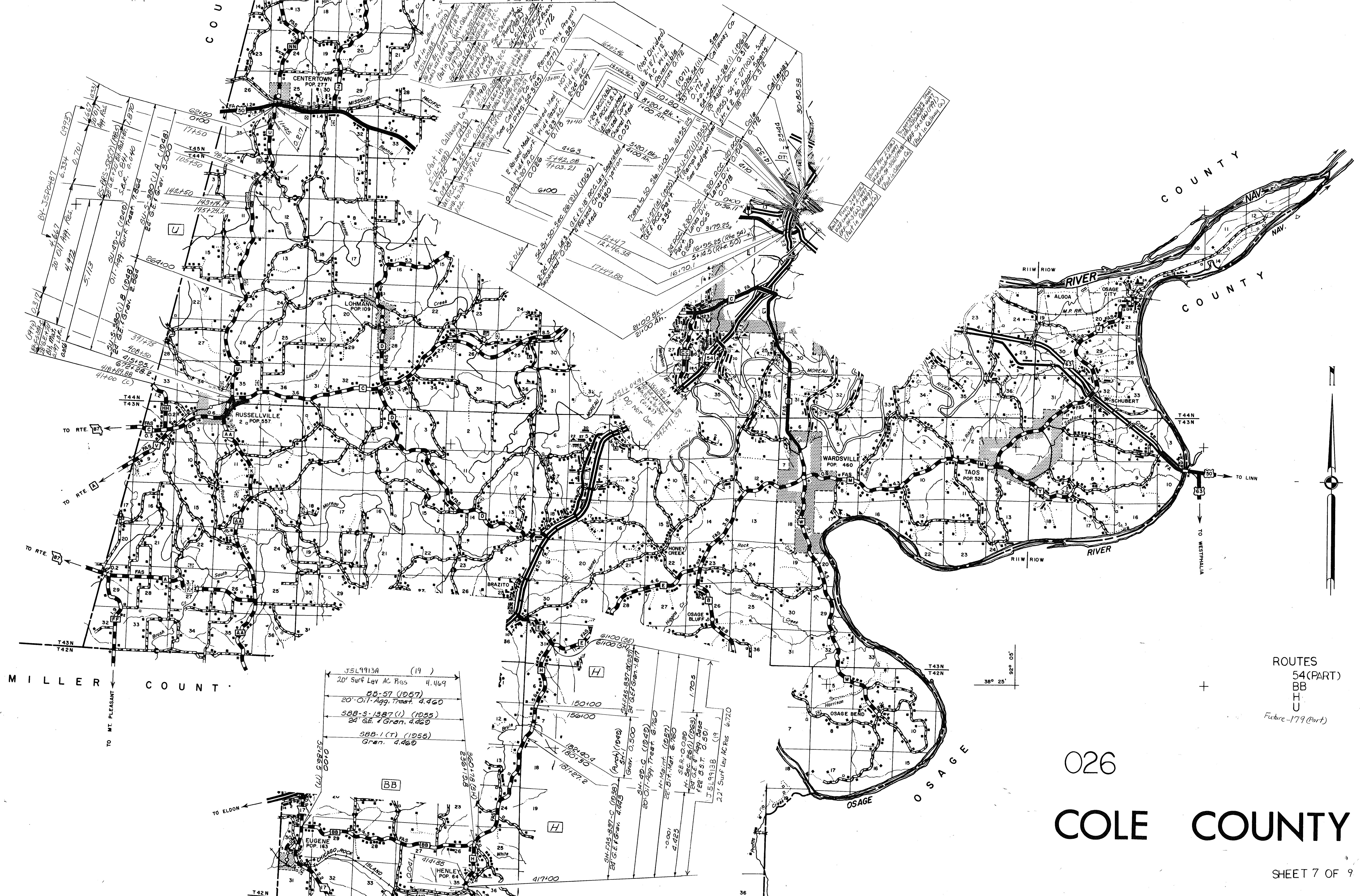

MILLER COUNTY

OSAGE COUNTY

ROUTES
54(PART)
BB
H
U
Future -179 (part)

026
COLE COUNTY

J5L9913A (19)
20' Surf Lev AC Res 4,469
BB-57 (1957)
20' Oil Agg. Treat. 4,460
58B-5-1387(1) (1955)
24' GE. 7 Gran. 4,460
58B-1(T) (1955)
Gran. 4,460

150+00
156+00
182+40.4
180+50
181+27.2

34-29-C (1949)
20' Oil Agg. Treat. 6,720
Hr. Maint. (1957)
22' B.H. Mat. 6,720
S.R. 0.030
H. 24' 56(1) (1945)
24' GE. 7 Agg. Base
Feb. 5.1. 0.50
J5L9913B (19)
22' Surf Lev AC Res 6,720

34-29-C (1949)
20' Oil Agg. Treat. 6,720
Hr. Maint. (1957)
22' B.H. Mat. 6,720
S.R. 0.030
H. 24' 56(1) (1945)
24' GE. 7 Agg. Base
Feb. 5.1. 0.50
J5L9913B (19)
22' Surf Lev AC Res 6,720

34-29-C (1949)
20' Oil Agg. Treat. 6,720
Hr. Maint. (1957)
22' B.H. Mat. 6,720
S.R. 0.030
H. 24' 56(1) (1945)
24' GE. 7 Agg. Base
Feb. 5.1. 0.50
J5L9913B (19)
22' Surf Lev AC Res 6,720

36° 25' 32" 05'

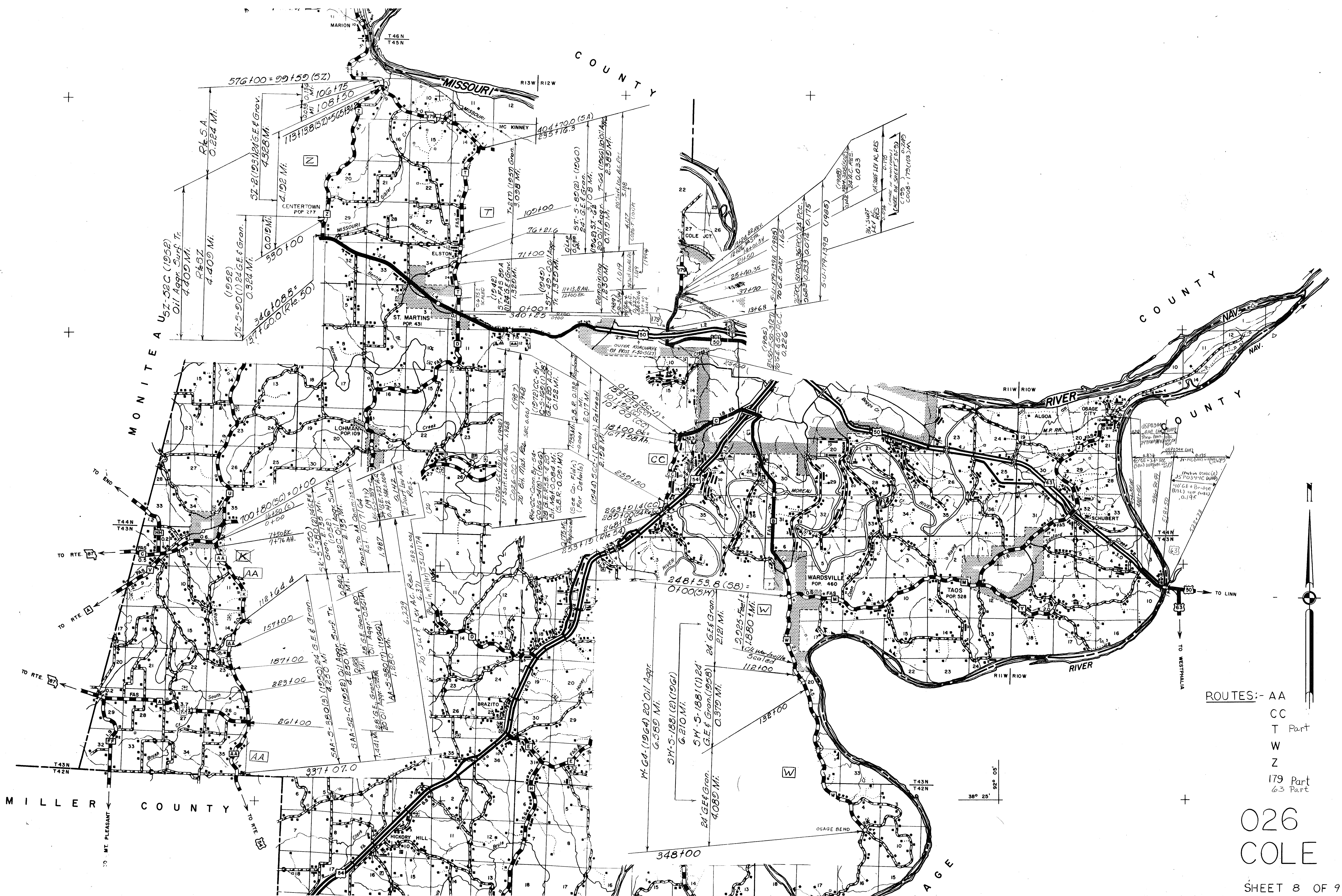

ROUTES:- AA
 CC
 T Part
 W
 Z
 179 Part
 63 Part

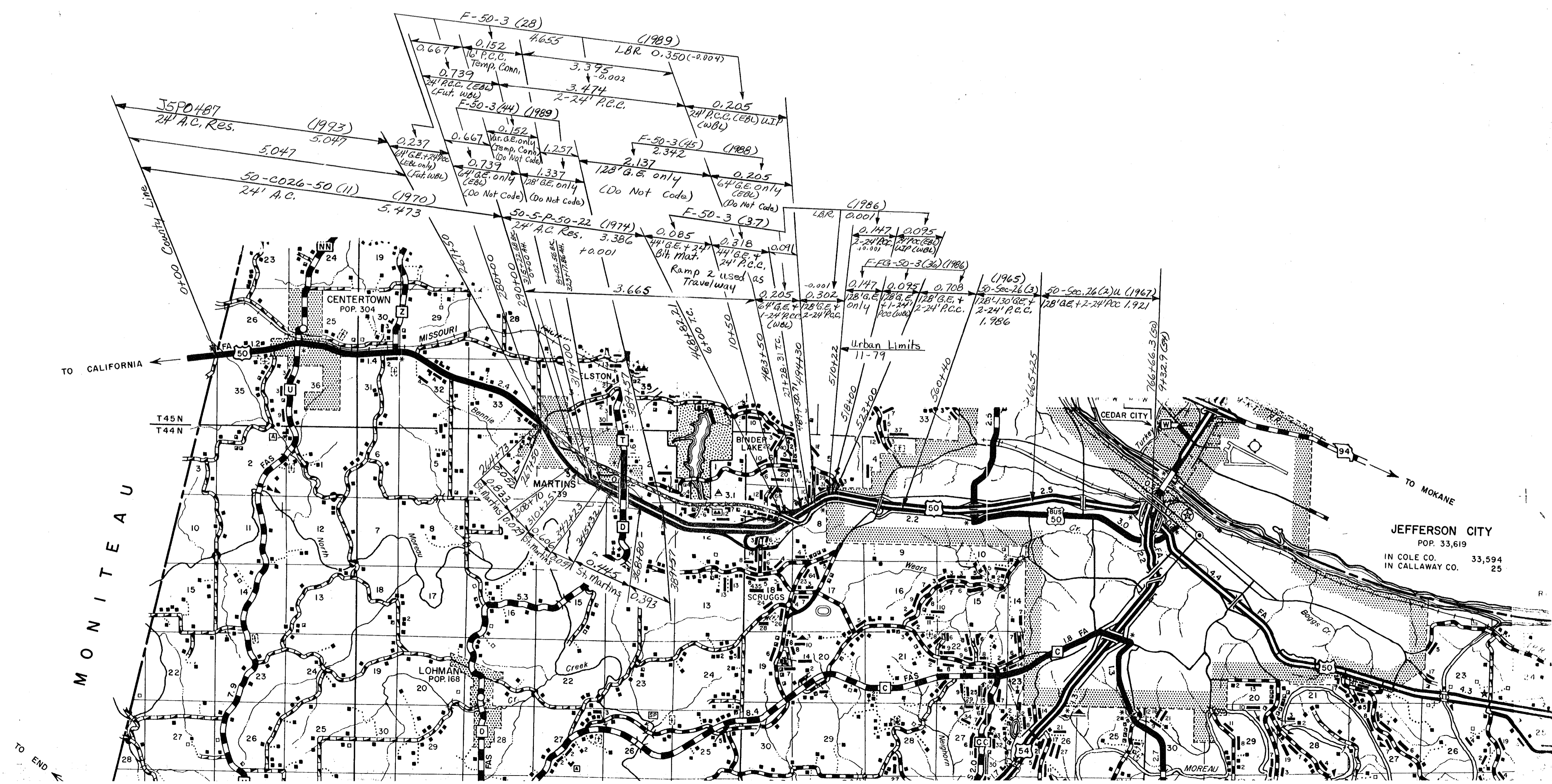

MONITEAU



ROUTES
50

SHEET 9 OF 9

026
COLE CO.

5

JEFFERSON CITY
POP. 33,619
IN COLE CO. 33,594
IN CALLAWAY CO. 25