

ROUTE  
5

⑤ 027  
COOPER

SHEET 1 OF 12

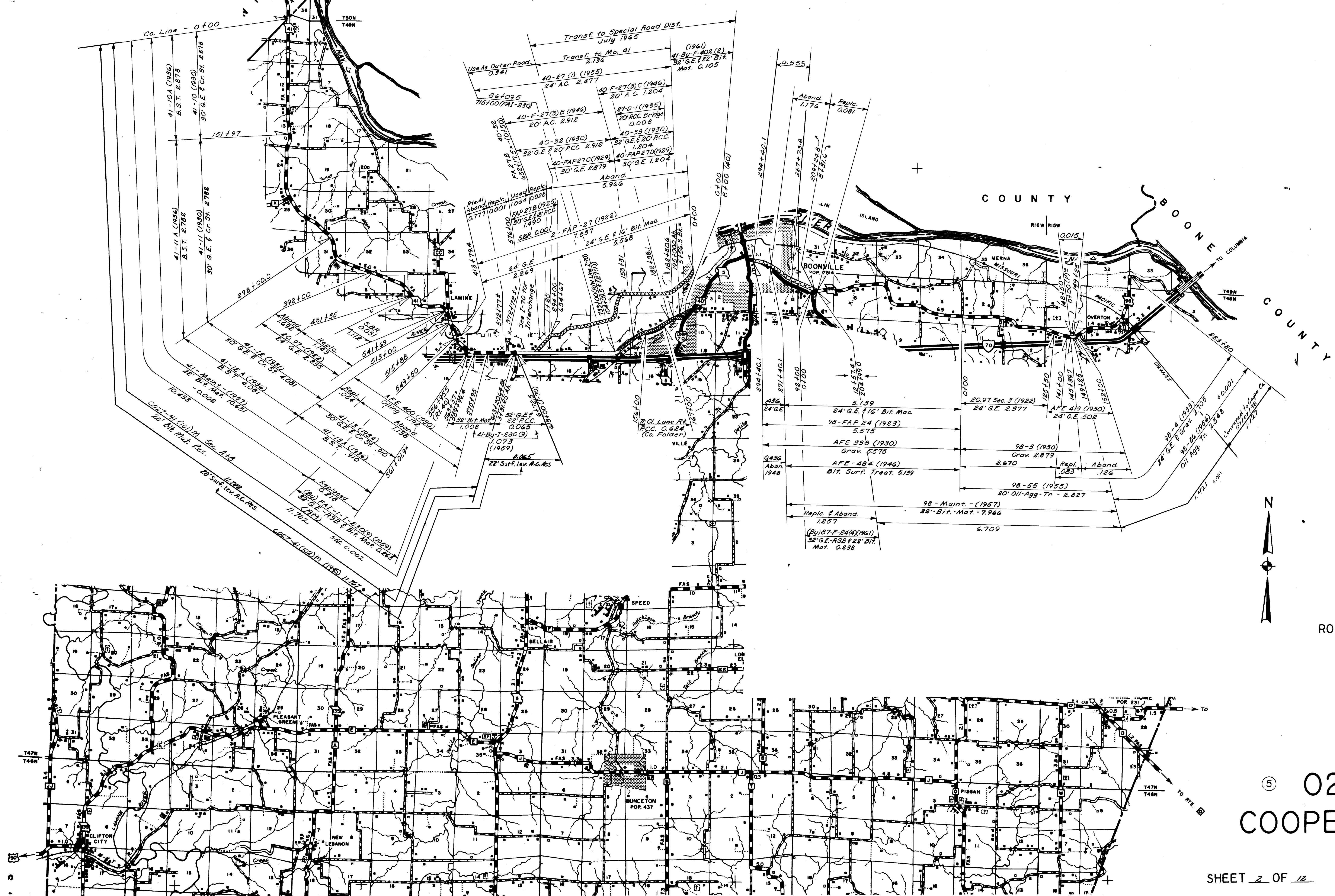

COUNTY

BOONE COUNTY

TO COLUMBIA



ROUTES  
41  
98

⑤ 027  
COOPER

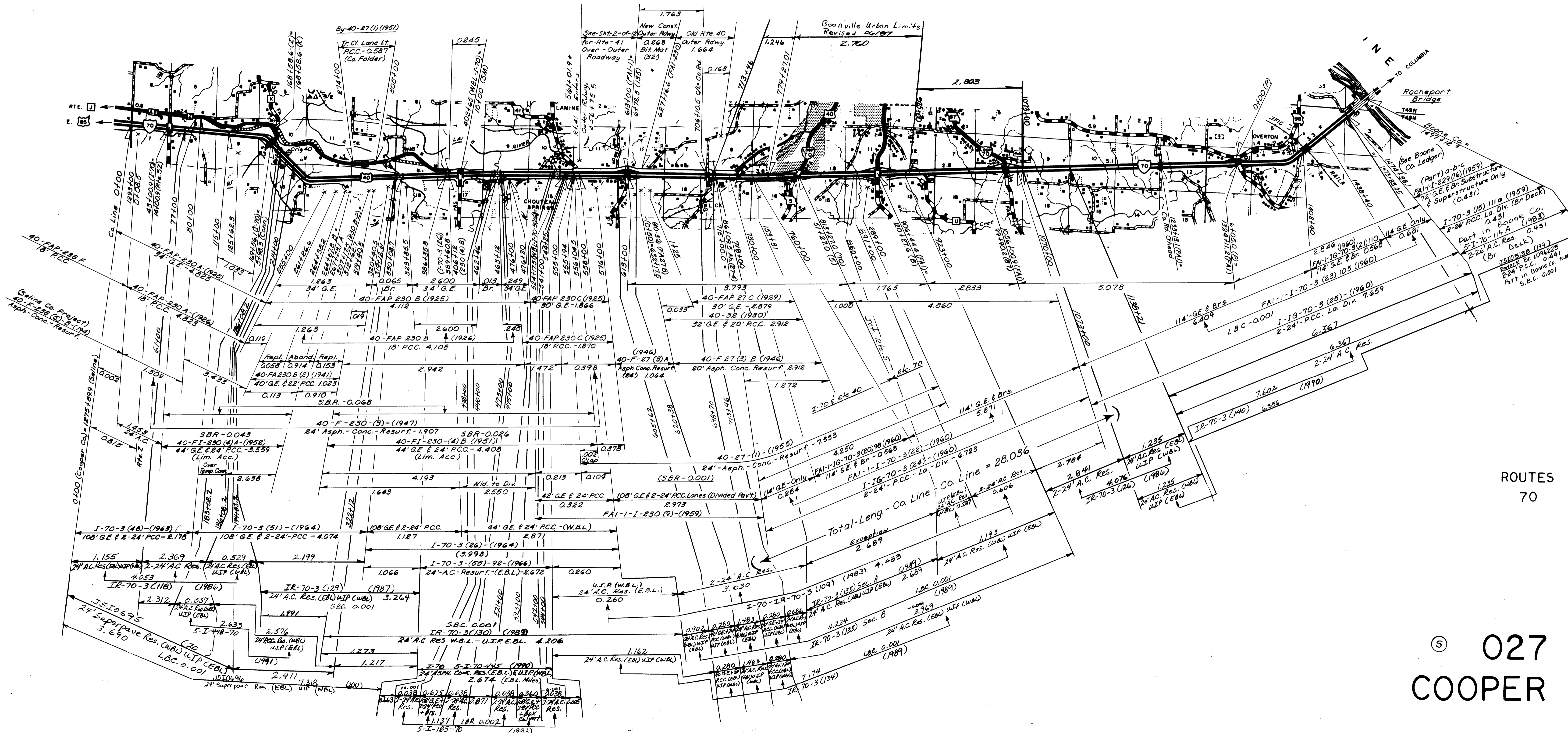
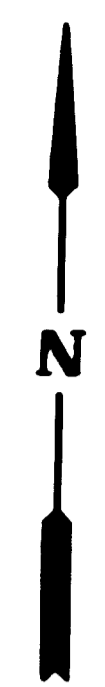

ROUTES  
70

027  
COOPER

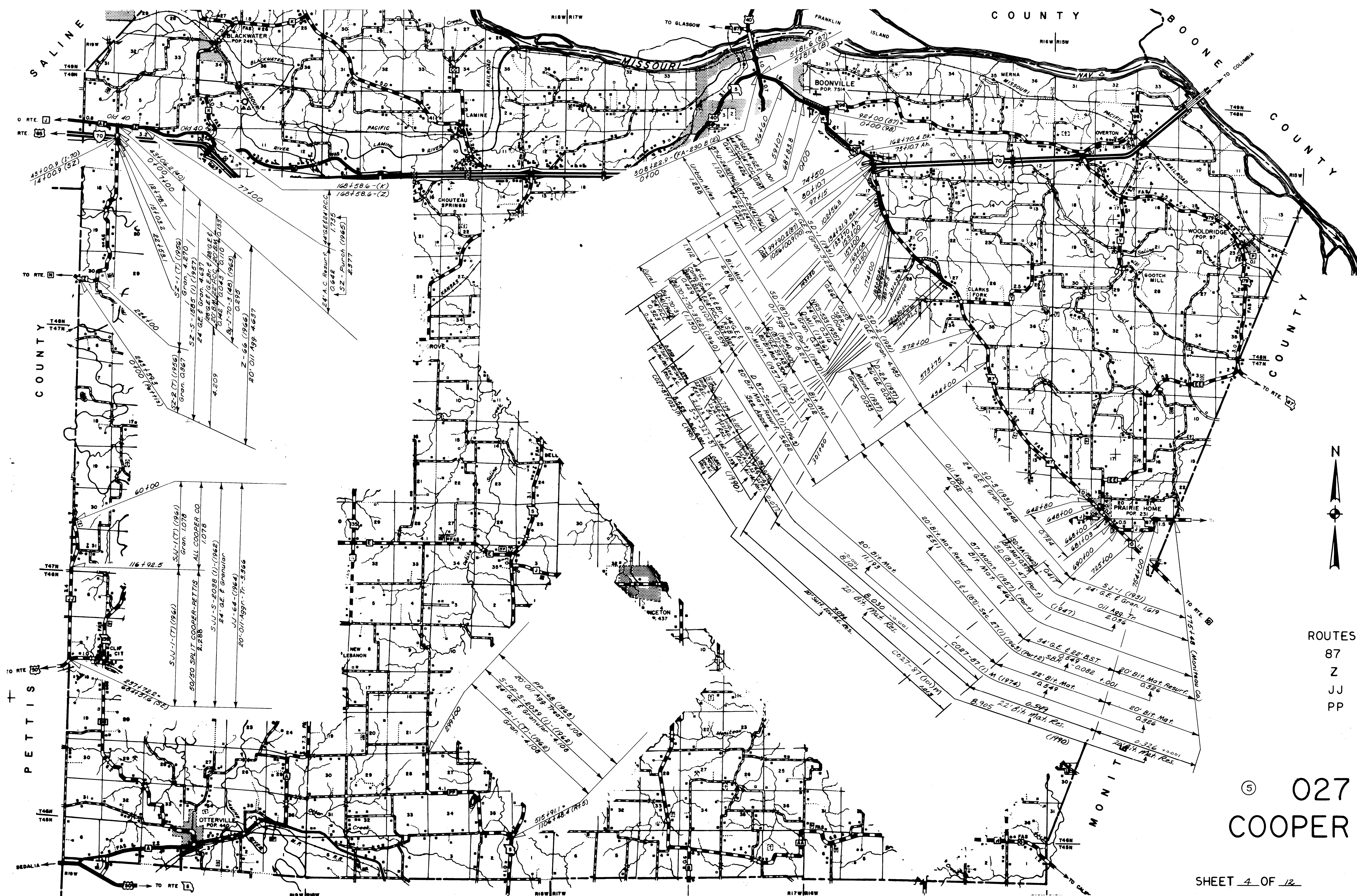

- ROUTES
- 87
  - Z
  - JJ
  - PP

⑤ 027  
COOPER

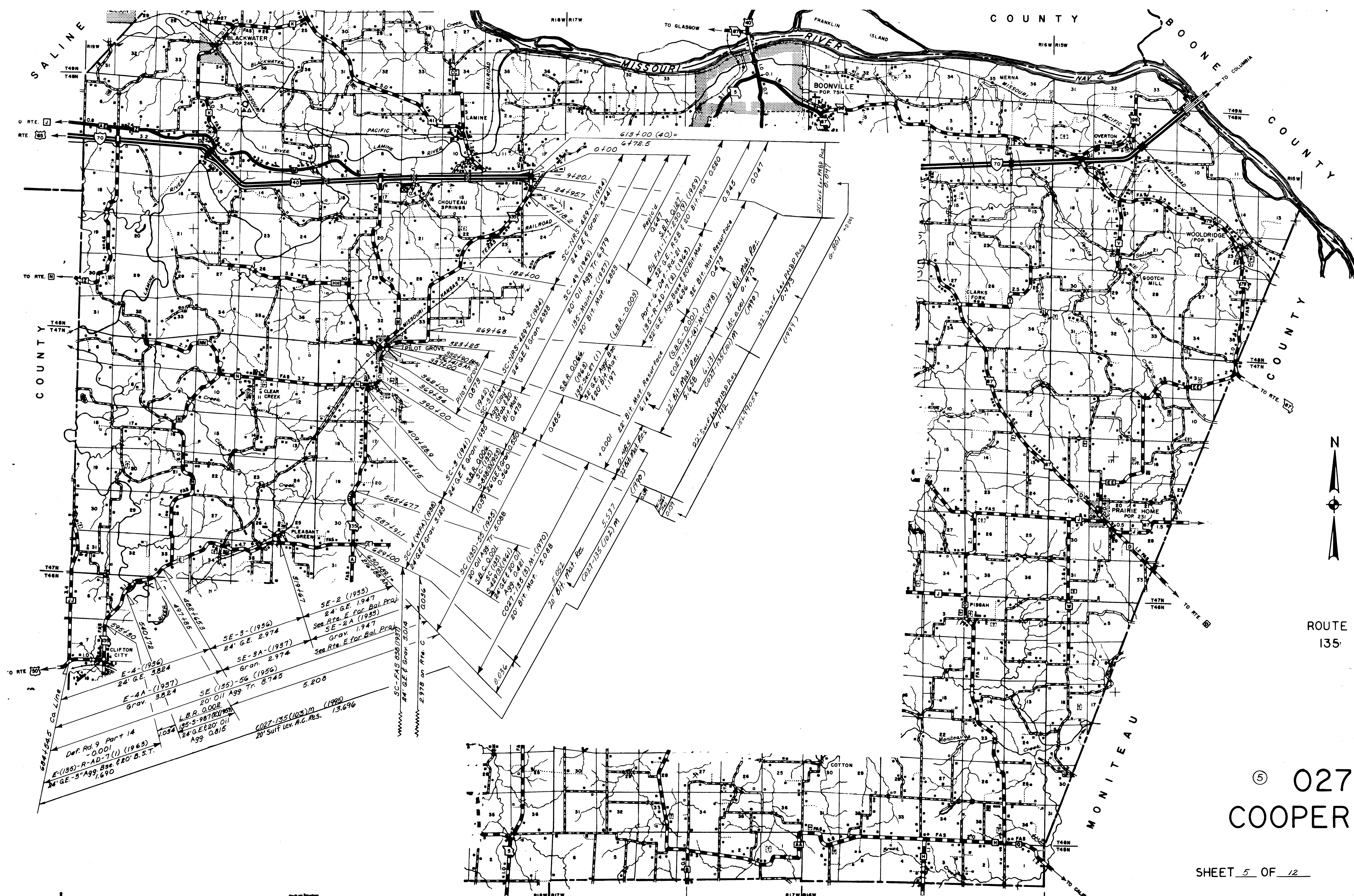

ROUTE 135

⑤ 027  
COOPER

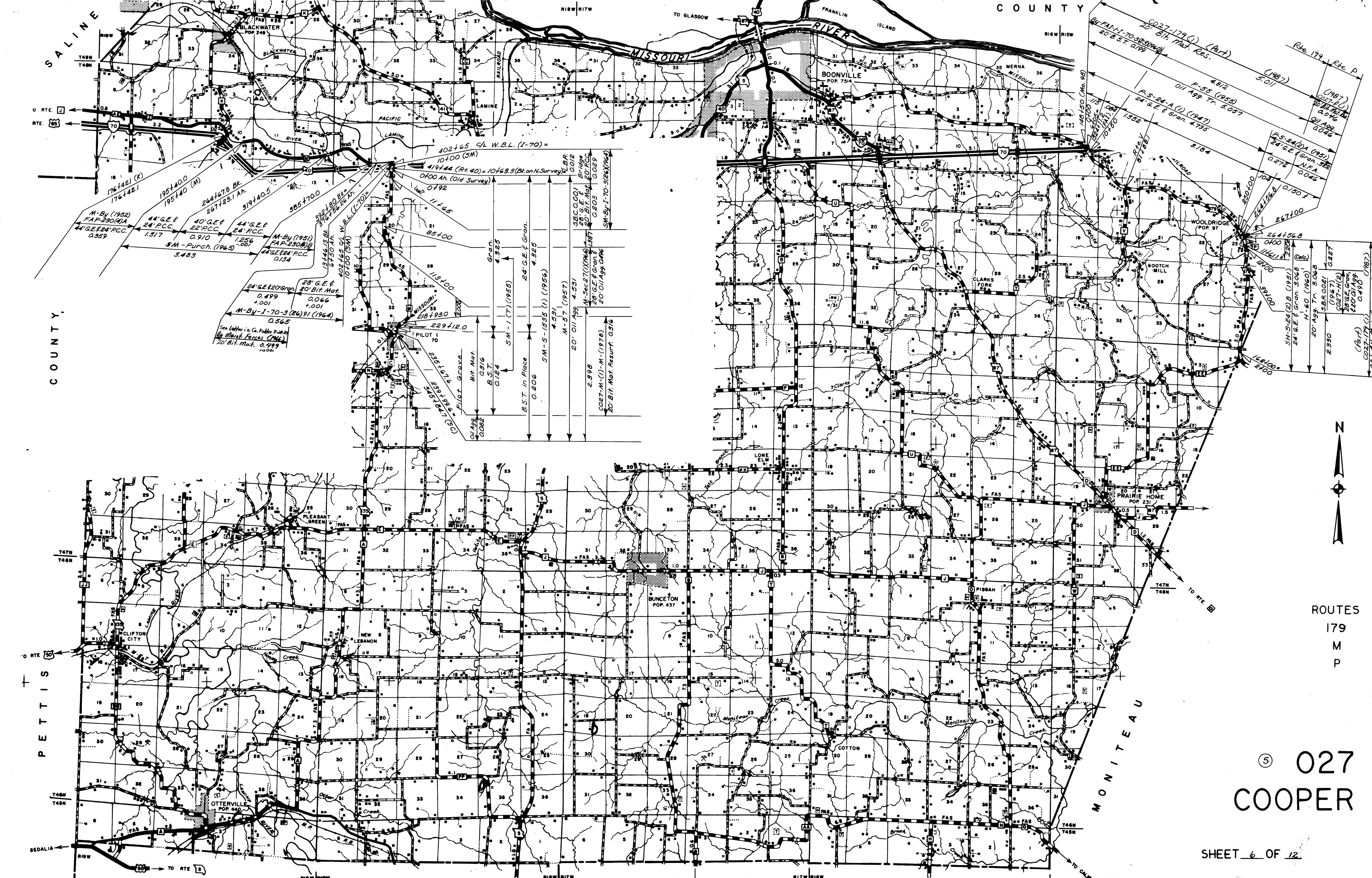

COUNTY,

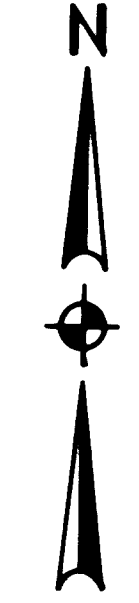

ROUTES  
179  
M  
P

⑤ 027  
COOPER

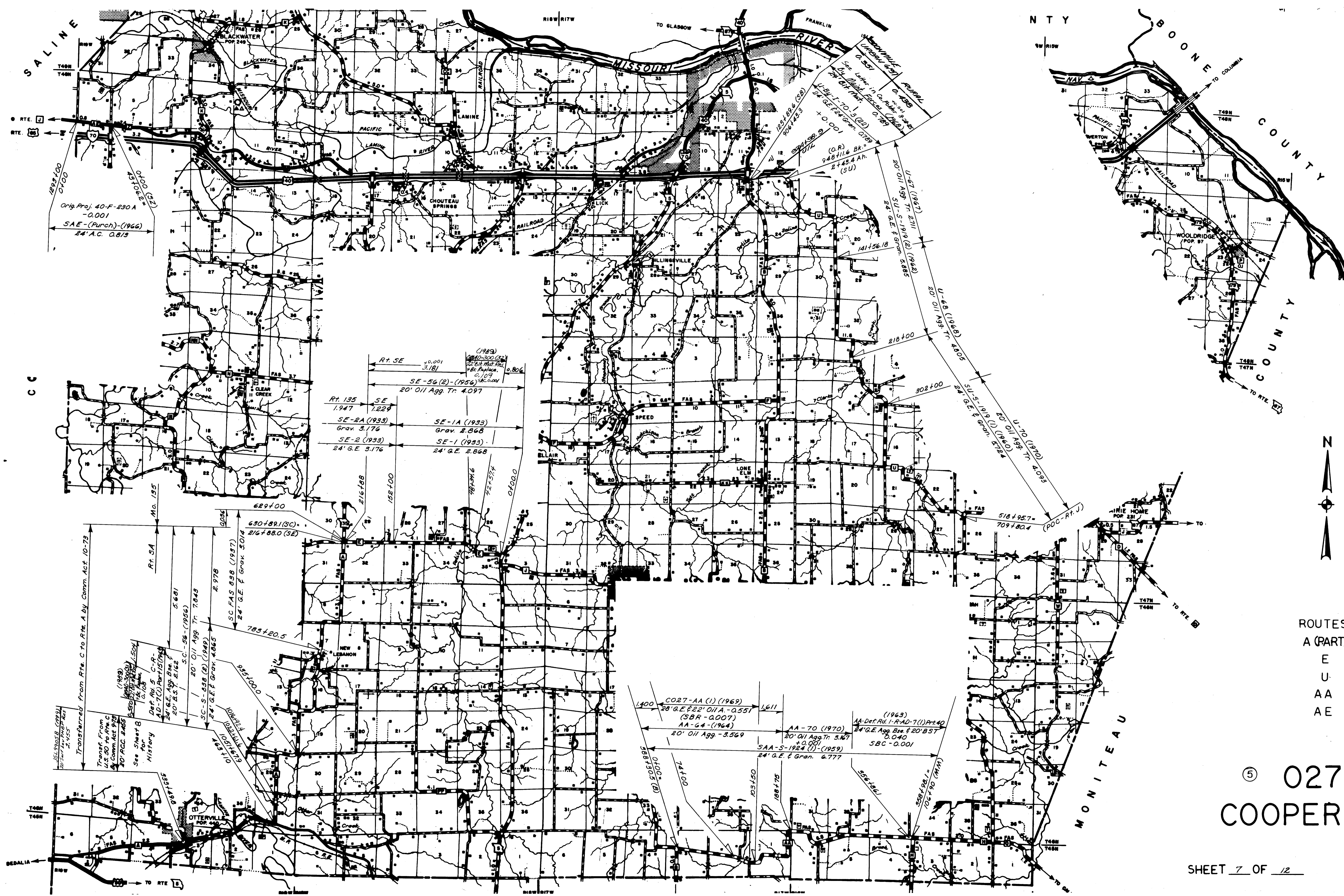

Orig. Proj. 40-F-230A  
-0.001  
SAE-(Purch)-(1966)  
24' A.C. 0.813

(1989)  
Rt. SE  
1.947  
SE  
1.228  
SE-2A (1993)  
Grav. 3.176  
SE-2 (1993)  
24' G.E. 3.176  
SE-1A (1993)  
Grav. 2.868  
SE-1 (1993)  
24' G.E. 2.868  
20' O/I Agg. Tr. 4.097

Transf. From  
U.S. 30 to Rte. C  
by Comm. Act. 973  
20' R.C.C. 2.445  
See Sheet B  
for  
History

(1989)  
U.S. 30  
20' R.C.C. 2.445  
Dep. Rd. 5 C-P  
AD-7(U) Part 15 (1989)  
24' G.E. Agg. Base F  
20' A.S. 2.162  
S.C. -56- (1956)  
20' O/I Agg. Tr. 7.843  
S.C. -S-228 (2) (1949)  
24' G.E. Grav. 4.865

1400  
C027-AA (1) (1969)  
28' G.E. & 22' O/I A-0.551  
(SBR-0.007)  
AA-64-(1964)  
20' O/I Agg.-3.569  
1611  
AA-70 (1970)  
20' O/I Agg. Tr. 5.167  
+0.001  
SAA-S-1924 (1) (1959)  
24' G.E. & Gran. 6.777  
555100.0  
74100  
103150  
108175  
356192.1  
20' O/I Agg. Tr. 7.0730 (MM)

(1969)  
AA-Def. Rd. 1-R-AD-7 (1) Part 40  
24' G.E. Agg. Base & 20' B5T  
0.040  
SBC-0.001

⑤ 027  
COOPER

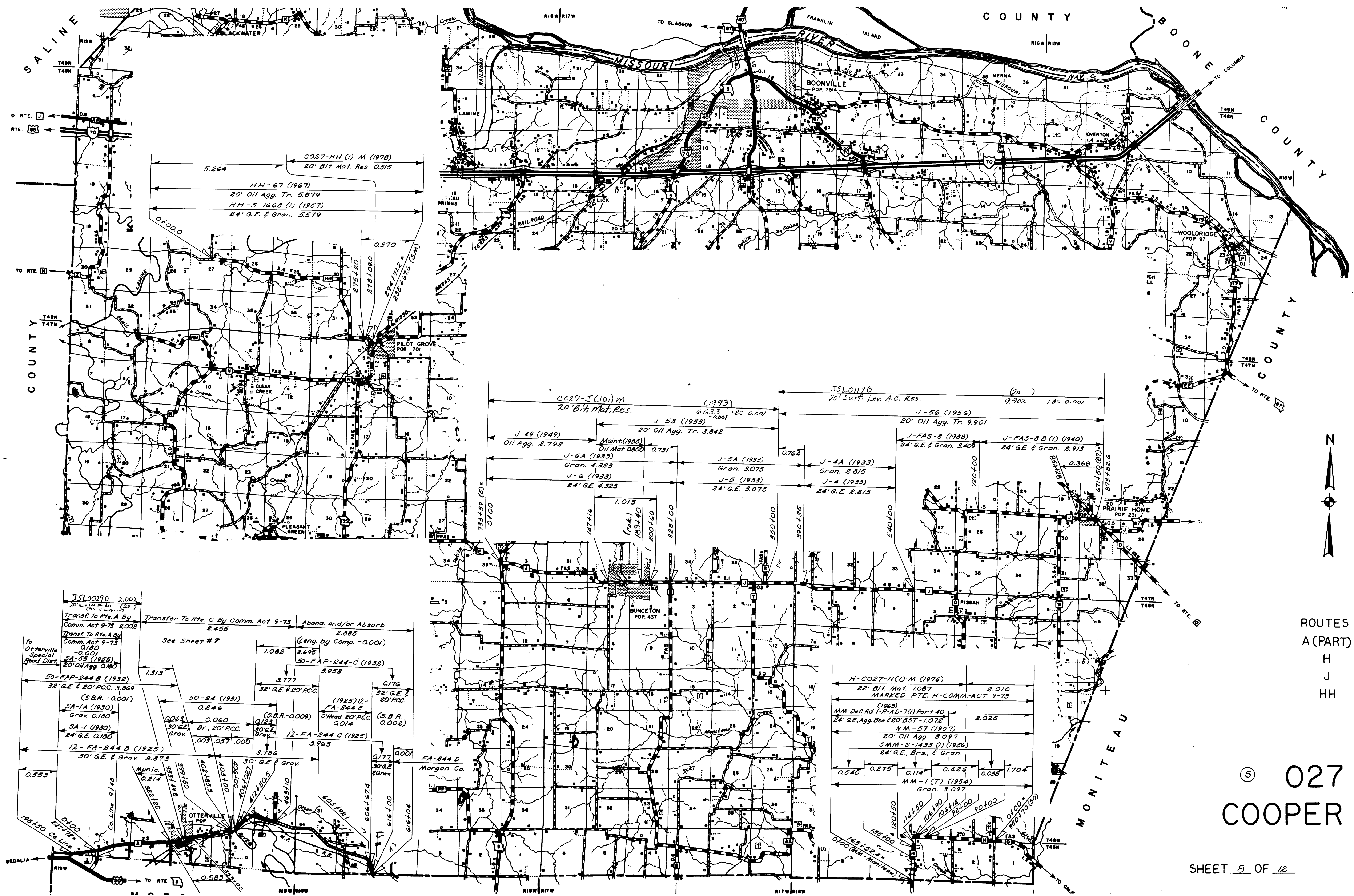

ROUTES  
A (PART)  
H  
J  
HH

⑤ 027  
COOPER







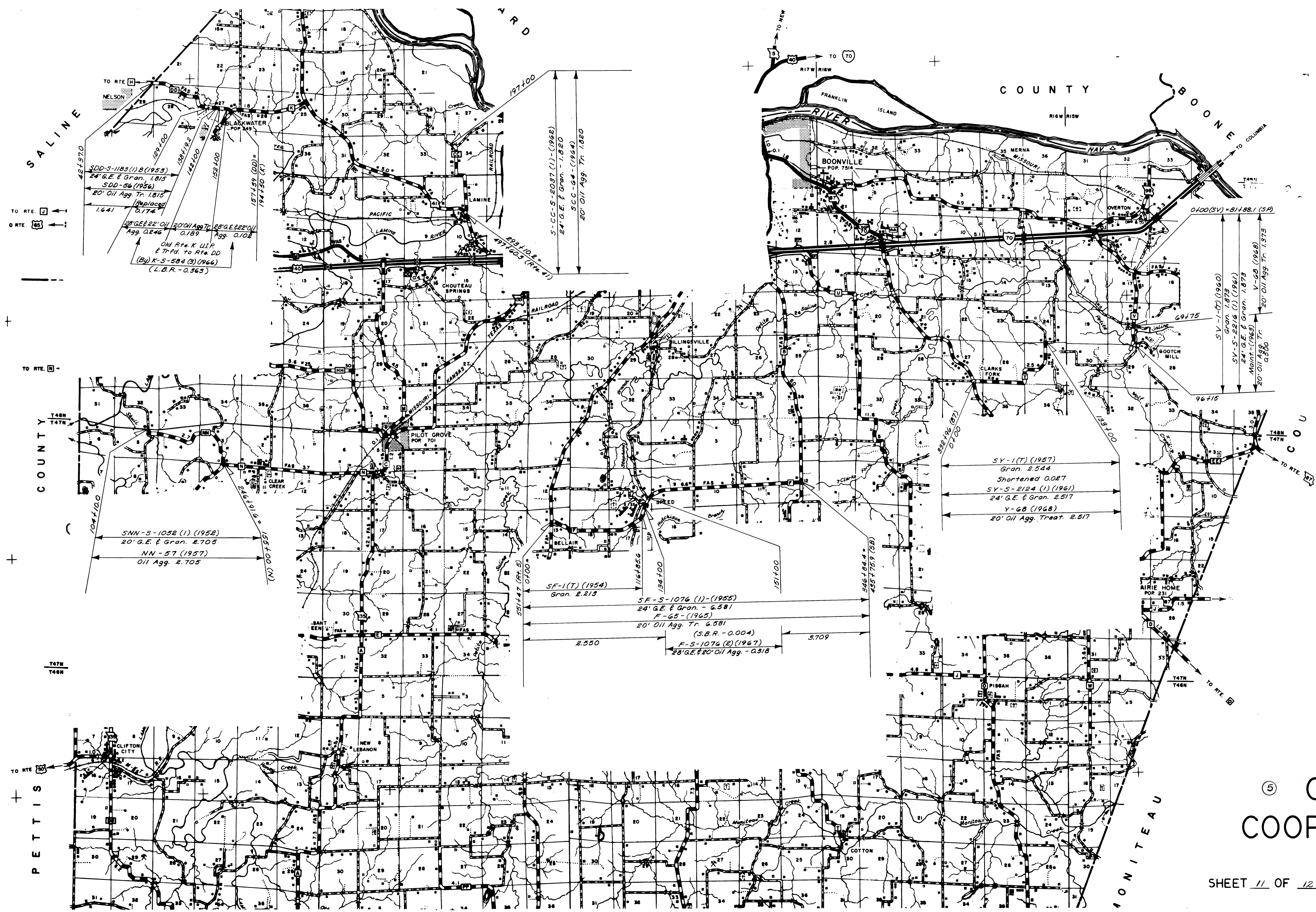

SY-1 (T) (1957)  
 Gran. 2.544  
 Shortened 0.027  
 SY-5-2124 (1) (1961)  
 24' G.E. & Gran. 2.517  
 Y-6B (1968)  
 20' Oil Agg. Treat. 2.517

SDD-5-1183 (1) B (1959)  
 24' G.E. & Gran. 1.815  
 SDD-56 (1956)  
 20' Oil Agg. Tr. 1.815  
 Replaced 0.174  
 28' G.E. & 22' Oil Agg. 0.246  
 20' Oil Agg. Tr. 0.189  
 28' G.E. & 22' Oil Agg. 0.102  
 Old Rte. K U.I.P.  
 & Trfd. to Rte. DD  
 (By) K-S-584 (3) (1966)  
 (L.B.R. - 0.363)

S-CC-S-2037 (1) - (1962)  
 24' G.E. & Gran. - 1.820  
 SCC-64 - (1964)  
 20' Oil Agg. Tr. 1.820

SF-1 (T) (1954)  
 Gran. 2.213  
 SF-S-1076 (1) - (1955)  
 24' G.E. & Gran. - 6.581  
 F-65 - (1965)  
 20' Oil Agg. Tr. 6.581  
 (S.B.R. - 0.004)  
 F-S-1076 (2) (1967)  
 28' G.E. & 20' Oil Agg. - 0.518

SV-1 (T) (1960)  
 Gran. 1.873  
 SV-S-2216 (1) (1961)  
 24' G.E. & Gran. 1.873  
 Maint. - (1969)  
 V-6B (1968)  
 20' Oil Agg. Tr. 1.873

ROUTES  
 F  
 V  
 Y  
 CC  
 DD  
 NN

⑤ 027  
 COOPER

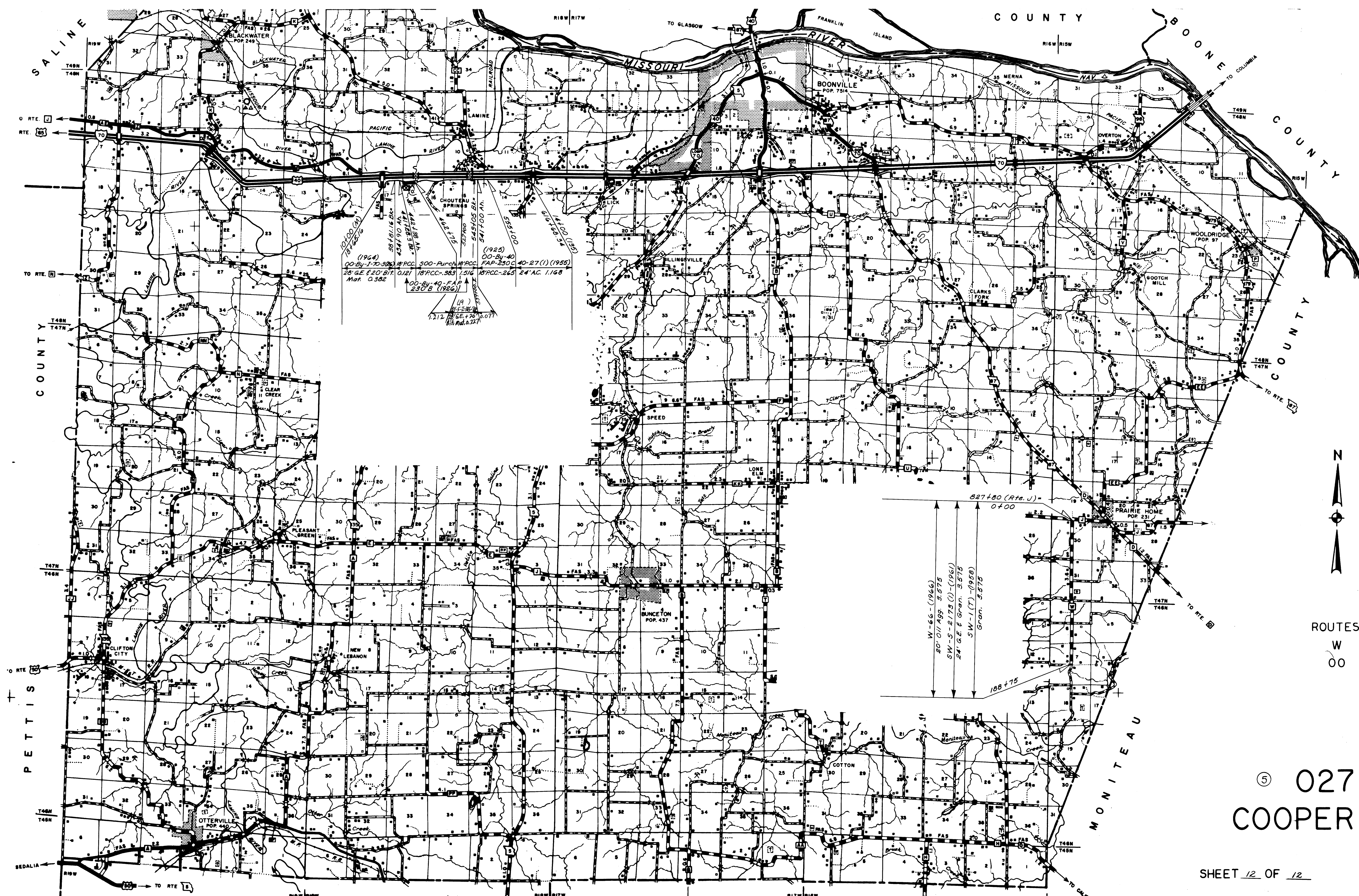

(1964)  
 00-By-1-70-300 18' PCC 500-Purch 18' PCC  
 25' GE F 20' BIT. 0.12 18' PCC-383 1.516 18' PCC-265 24' AC. 1.168  
 Mat. 0.382  
 00-By-40-FAP  
 23C'B (1962)

(1925)  
 00-By-40  
 FAP-230C 40-27(1) (1955)

10.00 (W)  
 18' PCC  
 88' 18 1/2' Bk.  
 434' 90' 41/2' Bk.  
 442' 38' 41/2' Bk.  
 545' 105' Bk.  
 541' 700' 41/2' Bk.  
 00101555  
 0.9175 0.55 0.00 0.00 0.161555  
 12.12 12' 6E + 70' 0.071  
 bit. Mat. 0.727

827+80 (Rte. J) =  
 0700

W-66-(1966)  
 20' 011 Agg. 3,575  
 SW-S-2175 (1)-(1961)  
 24' GE F Gran. 3,575  
 SW-1(T)-(1958)  
 Gran. 3,575

188+75

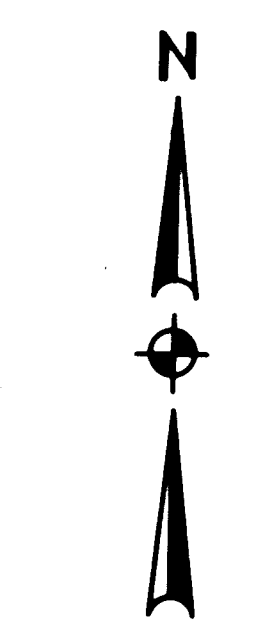

ROUTES  
 W  
 00

⑤ 027  
 COOPER