

ROUTES  
3  
W  
5 (Part)

② O45 SHEET 1 OF 12  
HOWARD

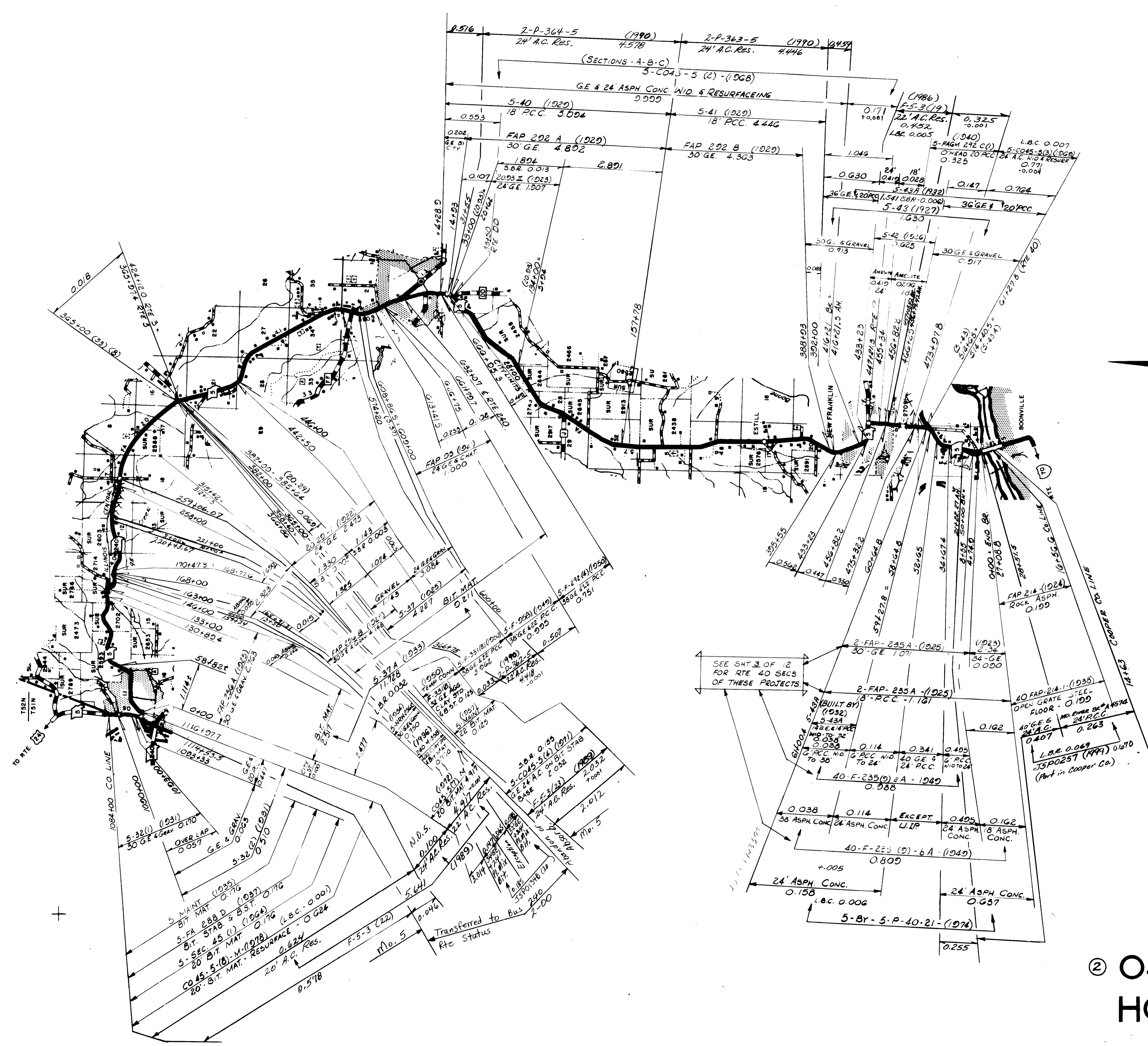

ROUTE  
5 (Part)  
BUS 240

SEE SHT. 3 OF 12  
FOR RTE 40 SECS  
OF THESE PROJECTS

Transferred to Bus  
Rte Status

- 5 MAINT (1995) 0.176
- BIT MAT (1997) 0.176
- 5-FA 288 D (1997) 0.176
- 5-FA 578 B (1996) 0.176
- 5-SEC 45 (1) (1996) 0.176
- 20 BIT MAT (1997) 0.624
- CO 45.5 (10) (1978) 0.624
- 20 BIT MAT (1978) 0.624
- 20' ASPH CONC (1978) 0.624



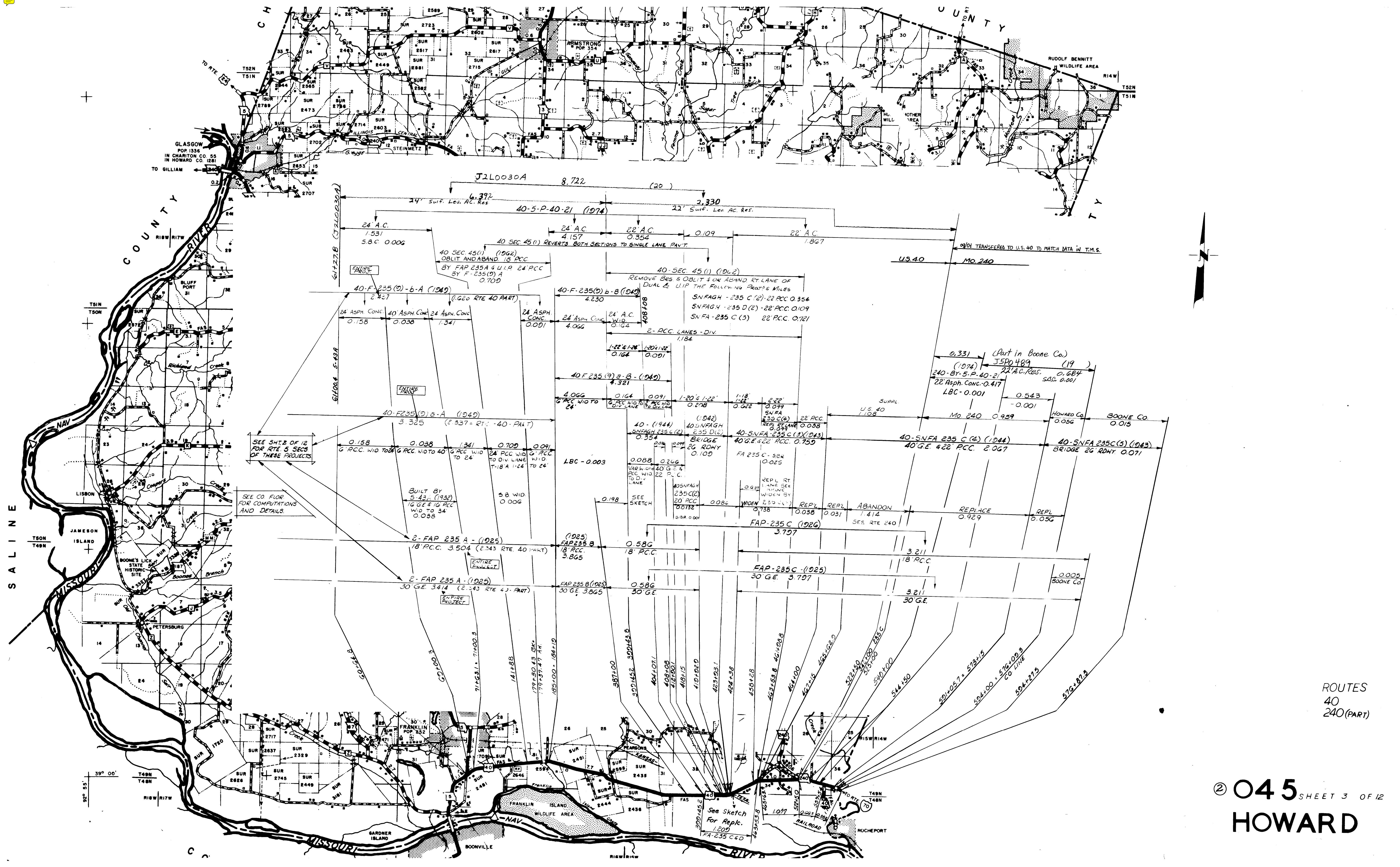

ROUTES  
40  
240(PART)

② O45 SHEET 3 OF 12  
HOWARD

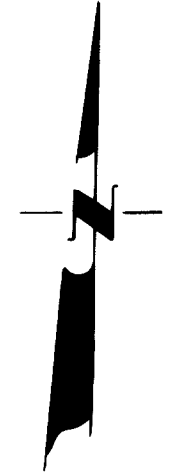
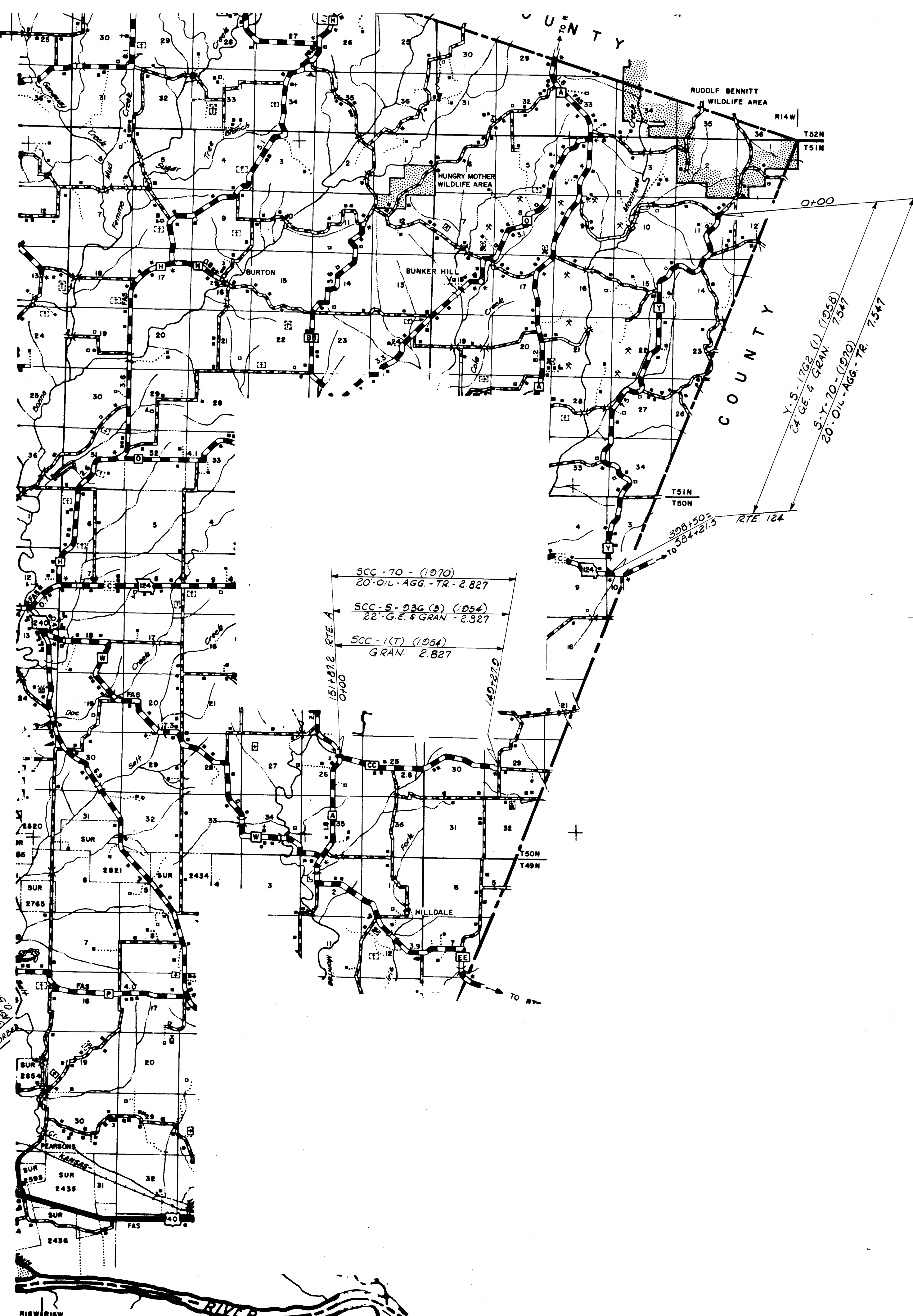
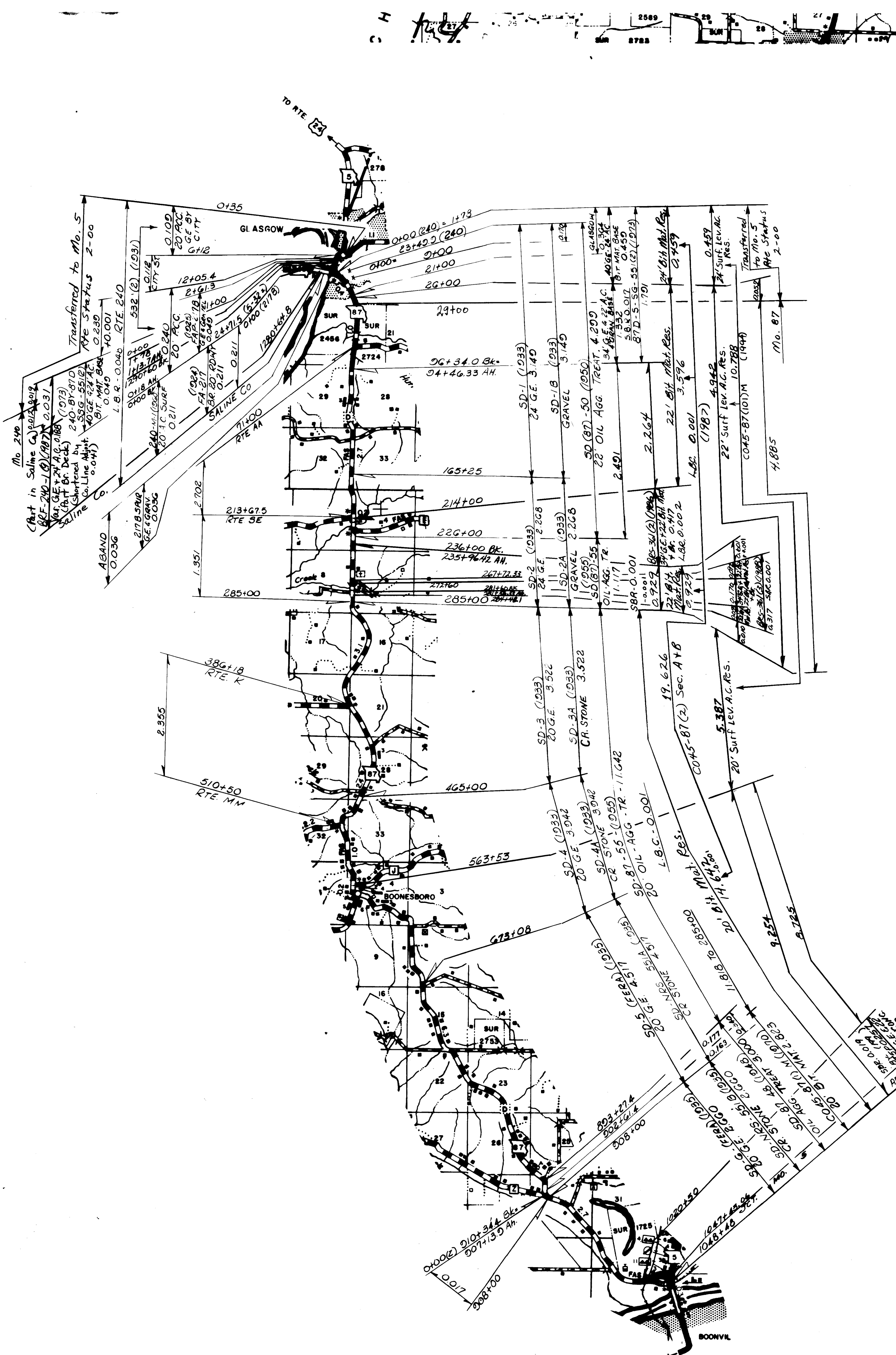

ROUTES  
 87  
 Y  
 CC  
 240 (PART)  
 5 (PART)

② O45 SHEET 4 OF 12  
 HOWARD

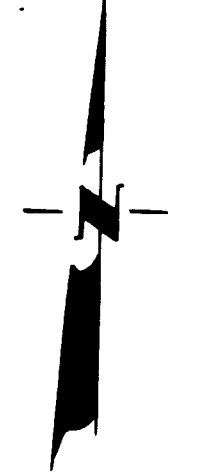
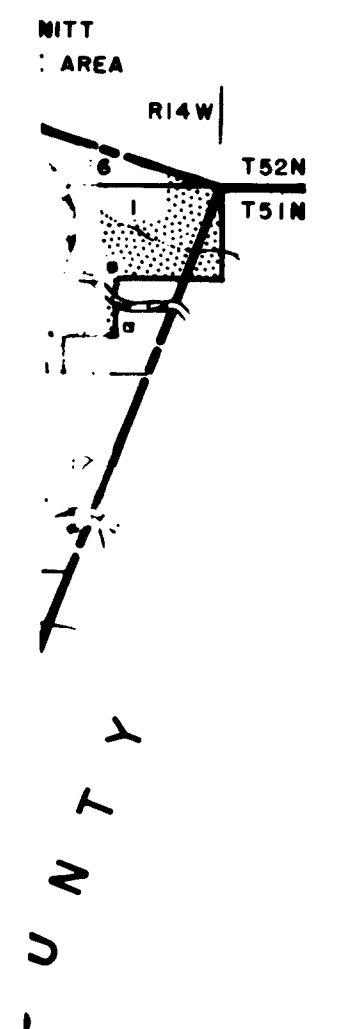
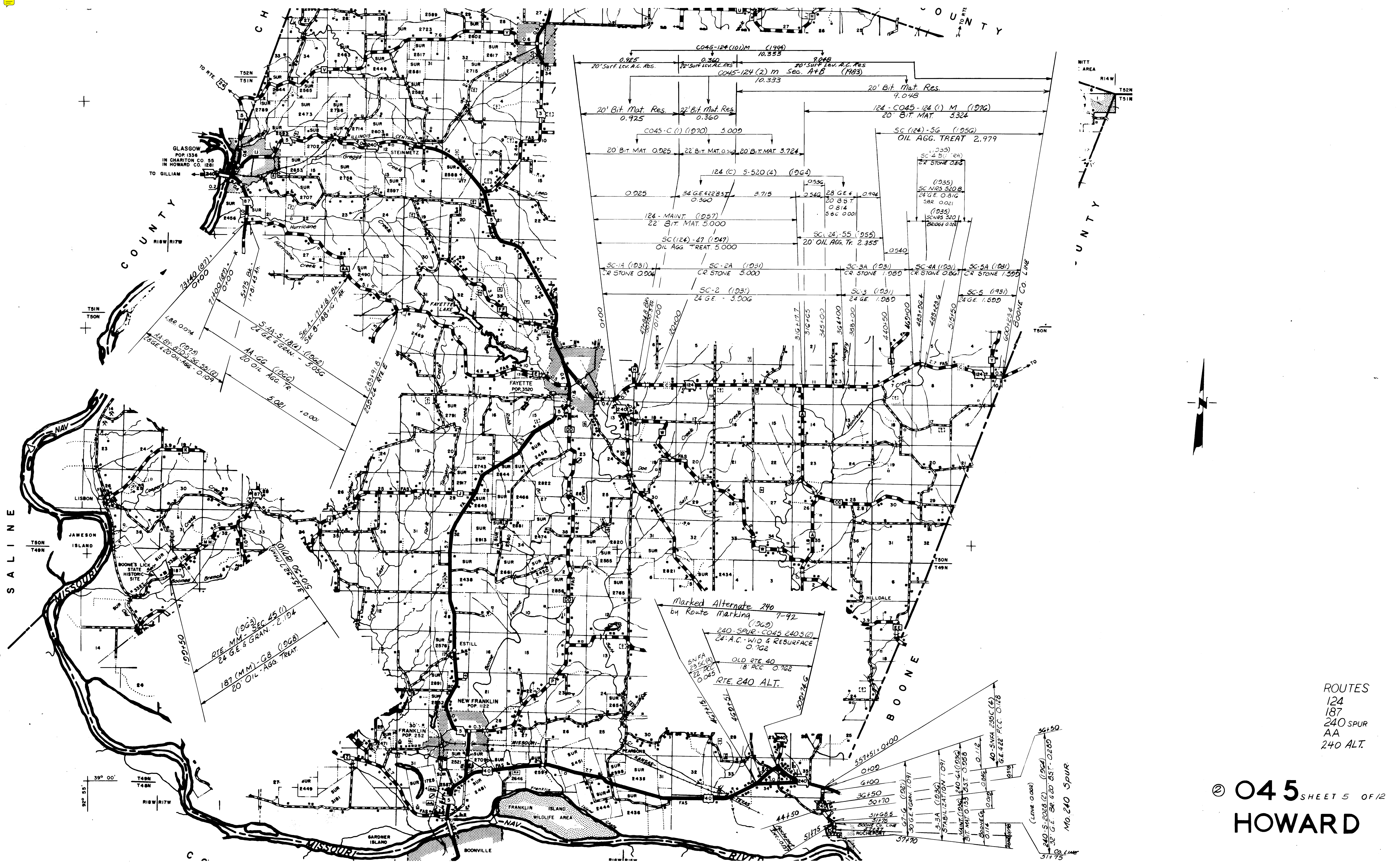

Marked Alternate 240  
 by Route Marking 7-92  
 (1969)  
 240-SPUR-CO45 240S(2)  
 24'-A.C. WID & RESURFACE  
 0.762  
 S.N.F.A.  
 23' S.C.(A)  
 22' P.C.  
 0.045  
 OLD RTE 40  
 18' P.C. 0.762  
 RTE. 240 ALT.

- ROUTES  
 124  
 187  
 240 SPUR  
 AA  
 240 ALT.

© O45 SHEET 5 OF 12  
 HOWARD

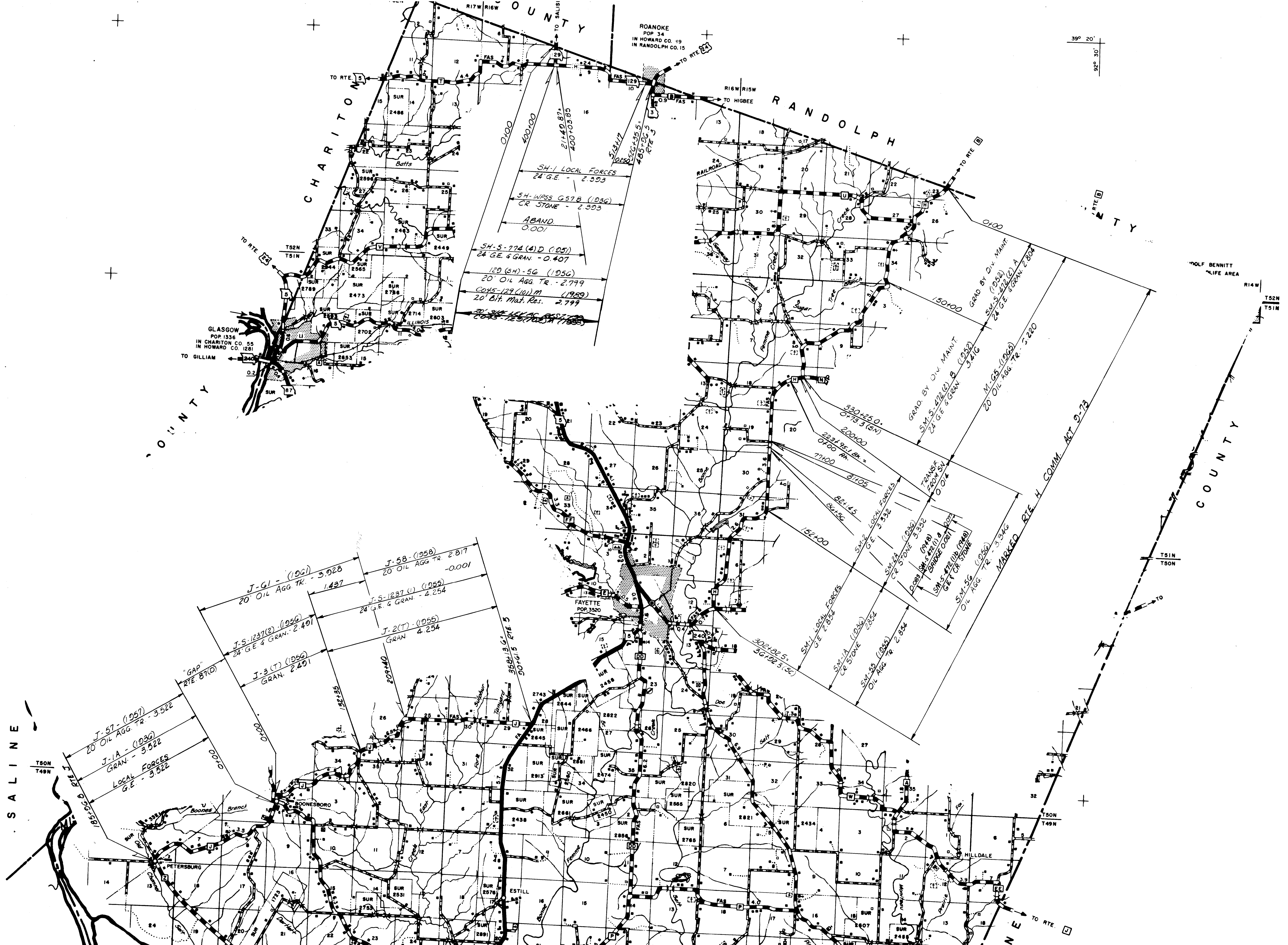

ROANOKE  
POP. 34  
IN HOWARD CO. 19  
IN RANDOLPH CO. 15

GLASGOW  
POP. 1336  
IN CHARITON CO. 55  
IN HOWARD CO. 1261

FAYETTE  
POP. 3500

39° 20'  
92° 30'

ROUTES  
129  
H  
J

② O45 SHEET 6 OF 12  
HOWARD

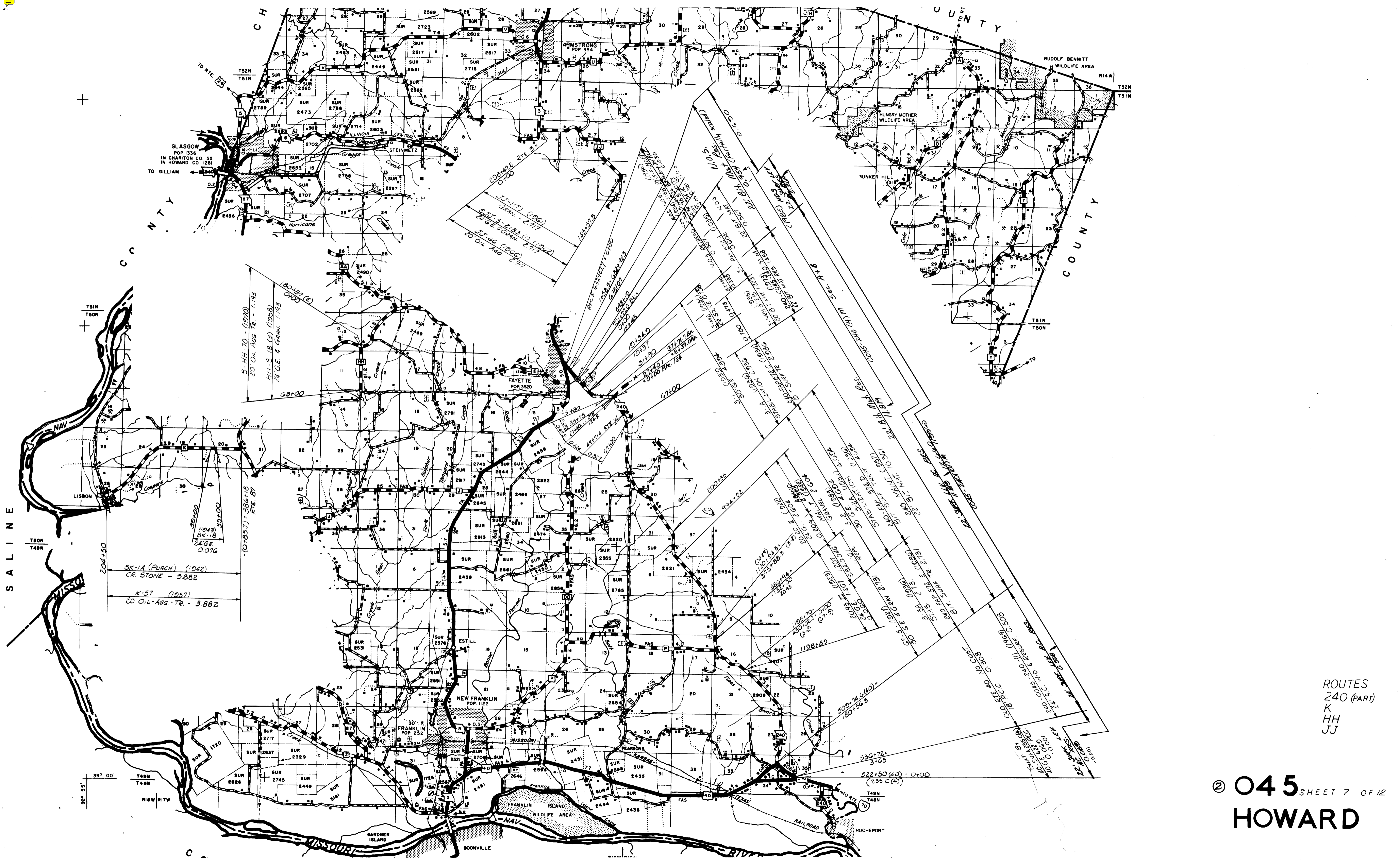

GLASGOW  
POP. 1336  
IN CHARITON CO. 55  
IN HOWARD CO. 1281

TO GILLIAM

LISBON

BOONVILLE

FAYETTE  
POP. 3520

NEW FRANKLIN  
POP. 122

FRANKLIN  
POP. 252

FRANKLIN ISLAND  
WILDLIFE AREA

ARMSTRONG  
POP. 354

HUNGRY MOTHER  
WILDLIFE AREA

TUNKER HILL

RUDDOLF BENNETT  
WILDLIFE AREA

ROCHEPORT

CH

UNTY

COUNTY

SALINE

C

ROUTES  
240 (PART)  
K  
HH  
JJ

© 045 SHEET 7 OF 12  
HOWARD

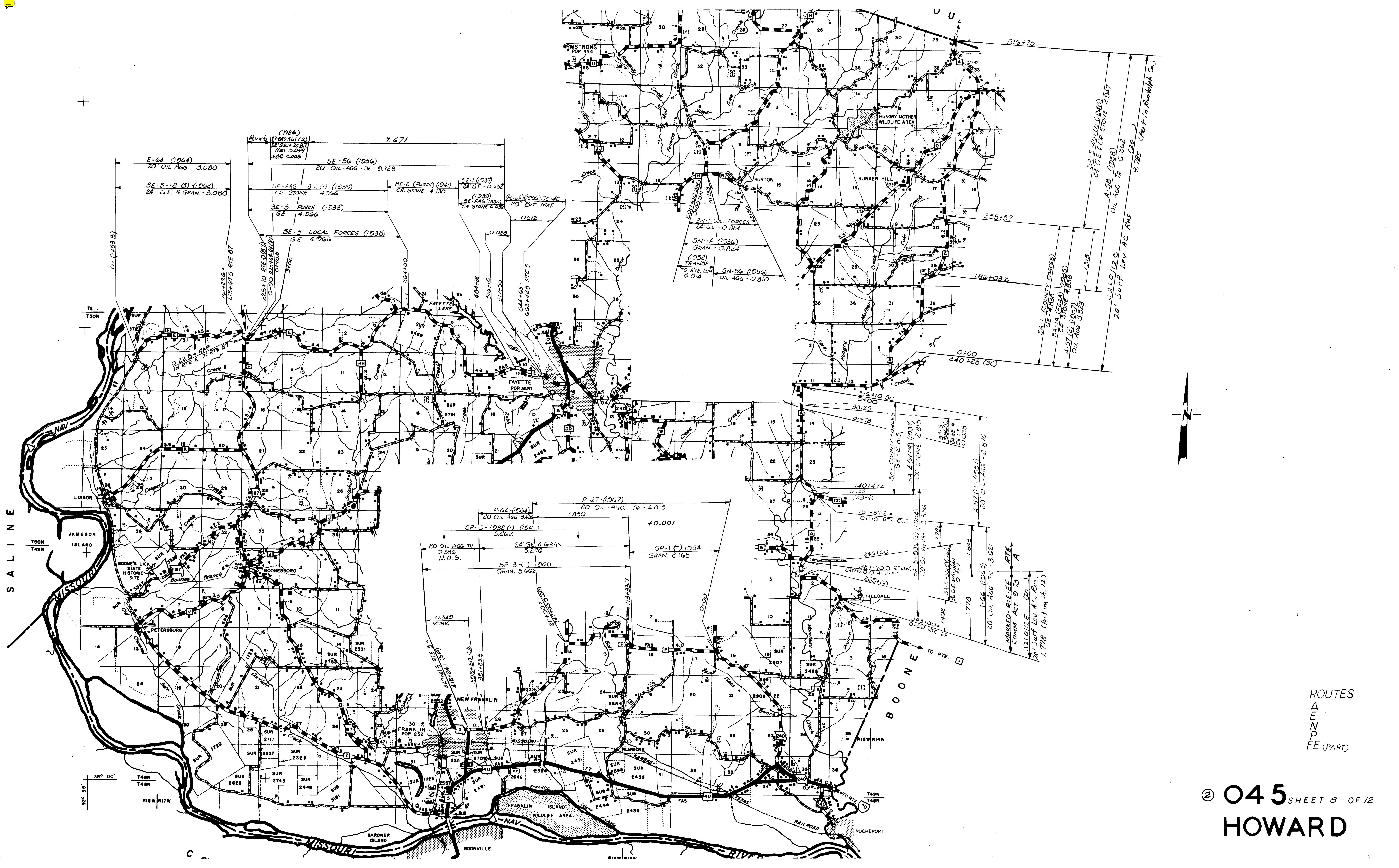

E-64 (1964)  
 20' OIL AGG 3.080  
 SE-5-18 (5) (1962)  
 24' G.E. & GRAN - 3.080

(1964)  
 24' G.E. & GRAN - 3.080  
 SE-56 (1956)  
 20' OIL AGG - TR - 0.728  
 SE-FAS 18 A (1) (1937)  
 CR STONE 4.966  
 SE-2 (Purch) (24)  
 CR STONE 4.130  
 SE-1 (1937)  
 24' G.E. - 0.632  
 (1930)  
 SE-FAS (1881)  
 CR STONE 0.638  
 (Purch) (256) SE-4  
 20' BIT MAT  
 0.512

SN-1 LOC FORCES  
 24' G.E. - 0.824  
 SN-1A (1936)  
 GRAN - 0.824  
 (1952)  
 TRANSF  
 TO RTE 3M  
 0.014  
 SN-56 (1956)  
 OIL AGG - 0.810

SA-1 (COUNTY FORCES)  
 GE - 4.838  
 SA-1A (FERRA) (1935)  
 CR STONE 4.838  
 A-57 (2) (1957)  
 OIL AGG 3.523  
 SA-S-401 (1) (1946)  
 24' G.E. & CR STONE 4.047  
 A-58 (1958)  
 OIL AGG TR 6.262  
 20' Surf Lev AC Res  
 9.785 (Part in Randolph Co.)

P-64 (1964)  
 20' OIL AGG 3.424  
 SP-3 (1932 (1) (196)  
 3.662  
 SP-3 (T) 1960  
 GRAN 5.662  
 P-67 (1967)  
 20' OIL AGG TR - 4.015  
 1.850  
 #0.001  
 SP-1 (T) 1954  
 GRAN 2.165

SA-COUNTY FORCES  
 GE - 2.815  
 SA-4 (MFA) (1937)  
 CR STONE 2.815  
 SA-5 (1936)  
 24' G.E. & CR STONE 2.815  
 SA-S-2036 (2) (1954)  
 20' OIL AGG TR - 3.536  
 A-57 (1) (1957)  
 20' OIL AGG - 2.816  
 1.666 (1962)  
 20' OIL AGG TR - 3.661  
 1.778  
 1.843  
 3.493+0.00  
 0.000 RTE EE  
 MARKED - RTE EE  
 COMM. ACT - 0.73  
 J2L0112E (20)  
 20' Surf Lev AC. Res.  
 1.778 (Part on Sh. 12)

20' OIL AGG TR 0.386  
 N.O.S.  
 24' G.E. & GRAN 5.276  
 SP-1 (T) 1954  
 GRAN 2.165  
 SA-S-2036 (2) (1954)  
 20' OIL AGG TR - 3.536  
 A-57 (1) (1957)  
 20' OIL AGG - 2.816  
 1.666 (1962)  
 20' OIL AGG TR - 3.661  
 1.778  
 1.843  
 3.493+0.00  
 0.000 RTE EE  
 MARKED - RTE EE  
 COMM. ACT - 0.73  
 J2L0112E (20)  
 20' Surf Lev AC. Res.  
 1.778 (Part on Sh. 12)

ROUTES  
 A  
 E  
 N  
 P  
 EE (PART)



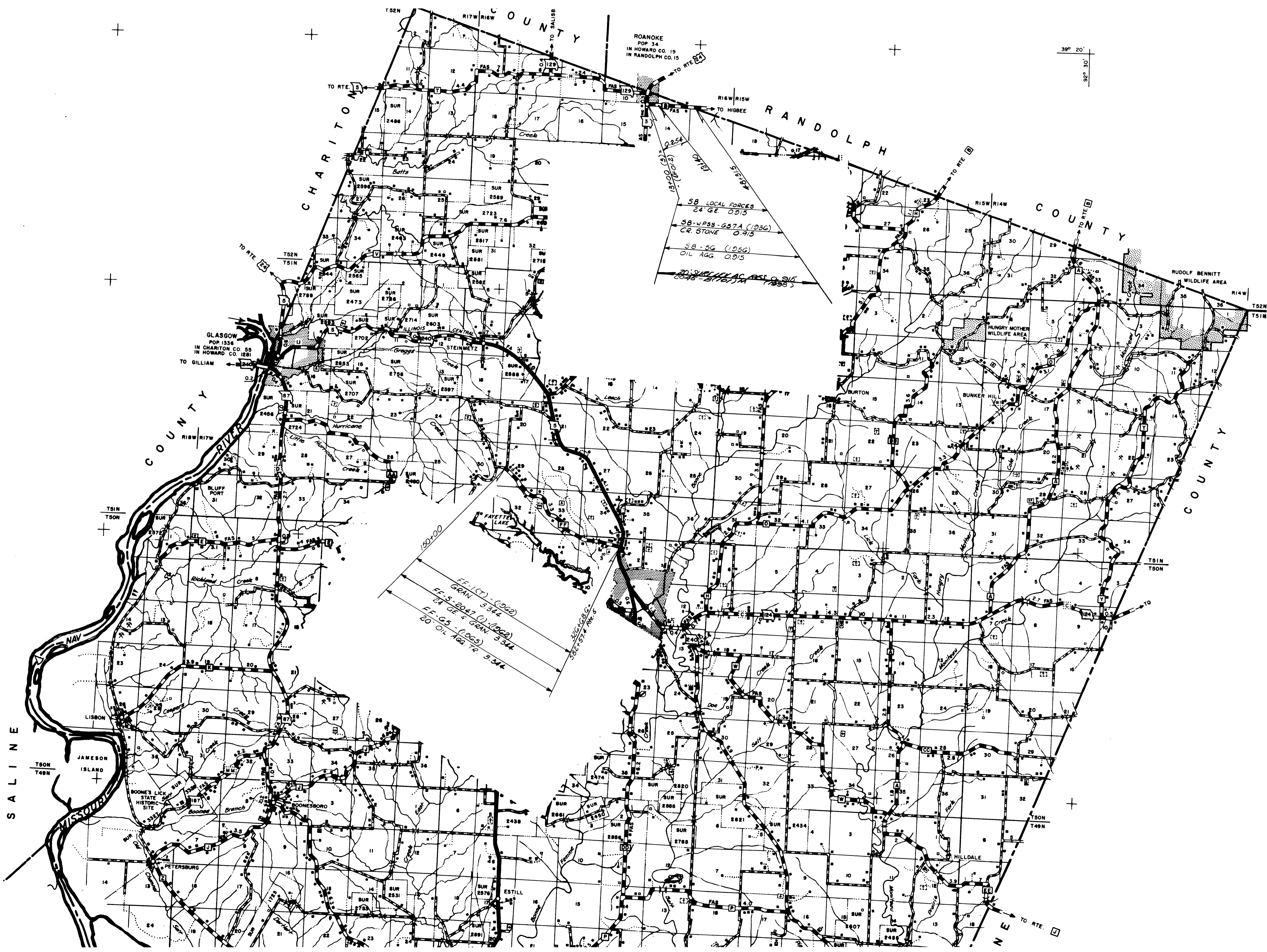

ROANOKE  
POP 34  
IN HOWARD CO. 19  
IN RANDOLPH CO. 15

GLASGOW  
POP 1336  
IN CHARITON CO. 55  
IN HOWARD CO. 1281

MISSOURI RIVER

SALINE

FF-1(C) - (1962)  
GRAN 3344  
FF-2 - 2047 (1) - (1962)  
24 GE 4 GRAN 3344  
FF-25 - (1965)  
20 OIL AGG TR 3344

SB LOCAL FORCES  
24 GE 0915  
SB WPSS - 657A (1936)  
CR. STONE 0915  
SB - 56 (1950)  
OIL AGG 0915  
20 SURVEY ACRES 0915  
2036 - 21767A (1958)

ROUTES  
B  
FF

② O45 SHEET 9 OF 12  
HOWARD

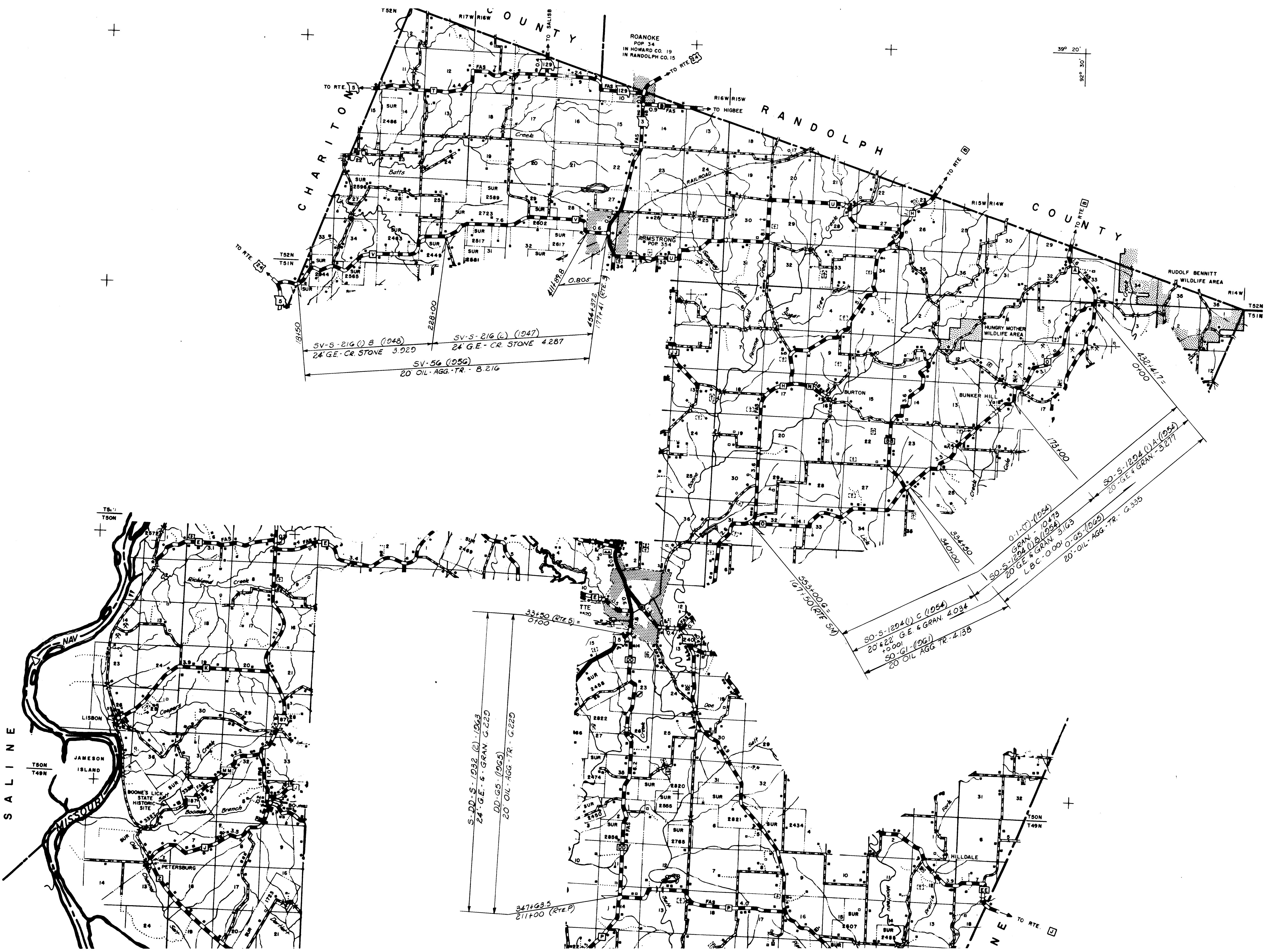

ROUTES  
 O  
 V  
 DD

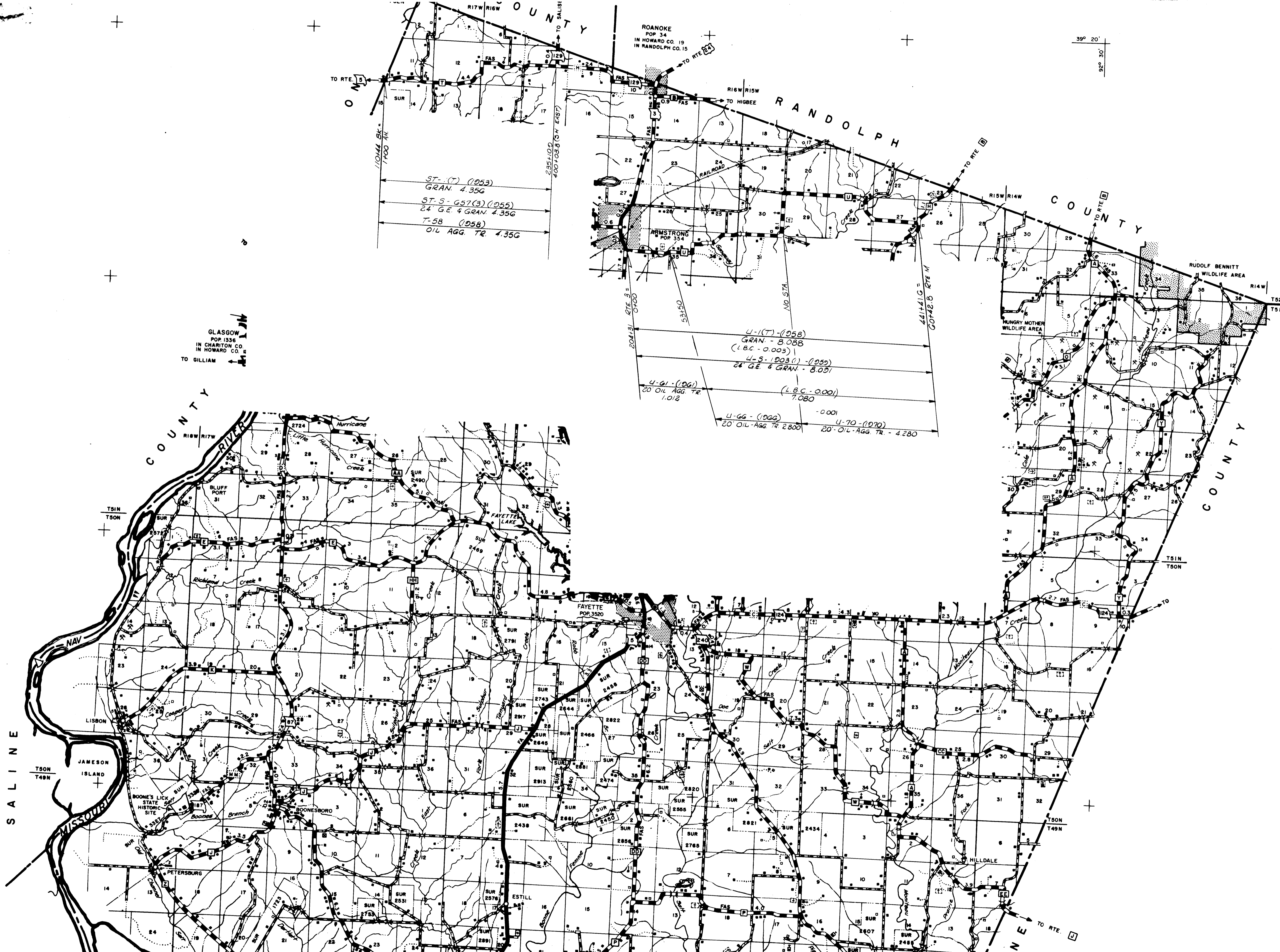

ST-7 (1953)  
GRAN. 4.35G

ST-5-657(3) (1955)  
24 G.E. 9 GRAN. 4.35G

T-58 (1958)  
OIL AGG. TR. 4.35G

U-1(7) (1958)  
GRAN. - 8.088  
(L.B.C. - 0.003)

U-5-1903(1) (1959)  
24 G.E. 6 GRAN. - 8.031  
(L.B.C. - 0.001)

U-61 (1961)  
20 OIL AGG. TR. 1.012

U-66 (1966)  
20 OIL AGG. TR. 2.800

U-70 (1970)  
20 OIL AGG. TR. - 4.280

GLASGOW  
POP 1336  
IN CHARITON CO.  
IN HOWARD CO.  
TO GILLIAM

ROUTES  
T  
U

② O45 SHEET 11 OF 12  
HOWARD

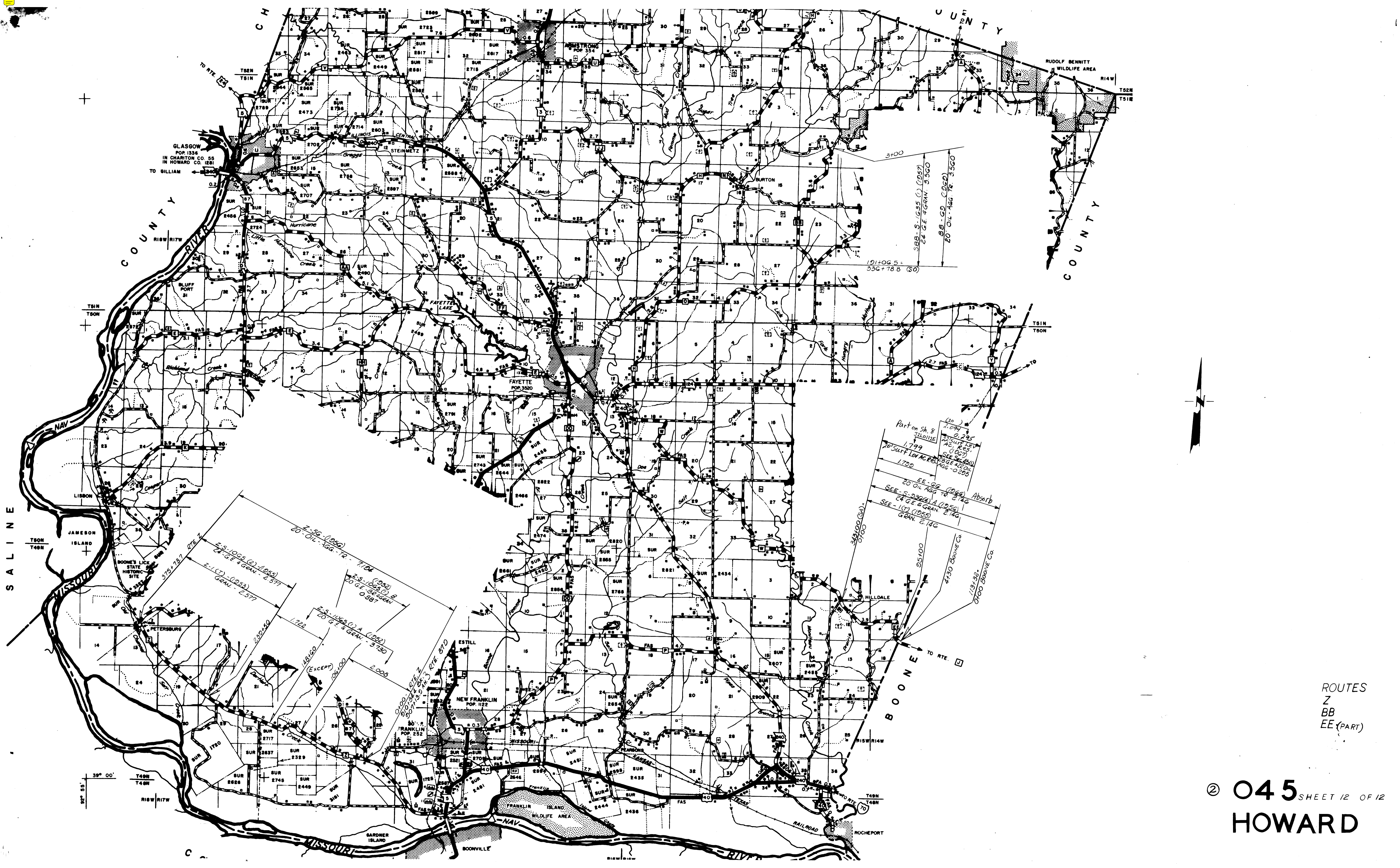

GLASGOW  
POP. 1336  
IN CHARITON CO. 55  
IN HOWARD CO. 1281

FAYETTE  
POP. 3220

NEW FRANKLIN  
POP. 112

RUDOLF BENNITT  
WILDLIFE AREA

1917 AG. 5 -  
33C + 78.8 (50)  
888-5-1635 (1) (1957)  
24 GE. GRAN. 3560  
888-5-1635 (1) (1957)  
24 GE. GRAN. 3560  
20' OIL AGG. 76-3560

Part on Sh. 8  
21013E  
1.799  
20' SURF LEV. AC. RES.  
1.700  
SEE - 9-236(A) (1936)  
24 GE. GRAN. 2.140  
SEE - 1(7) (1955)  
GRAN. 2.140  
4430 Boone Co.  
113.32  
0700 Boone Co.

ROUTES  
Z  
BB  
EE (PART)

② 045 SHEET 12 OF 12  
HOWARD