

ROUTES 47

SEE SHEET 9 OF 14  
FOR ALL OF RTE. J

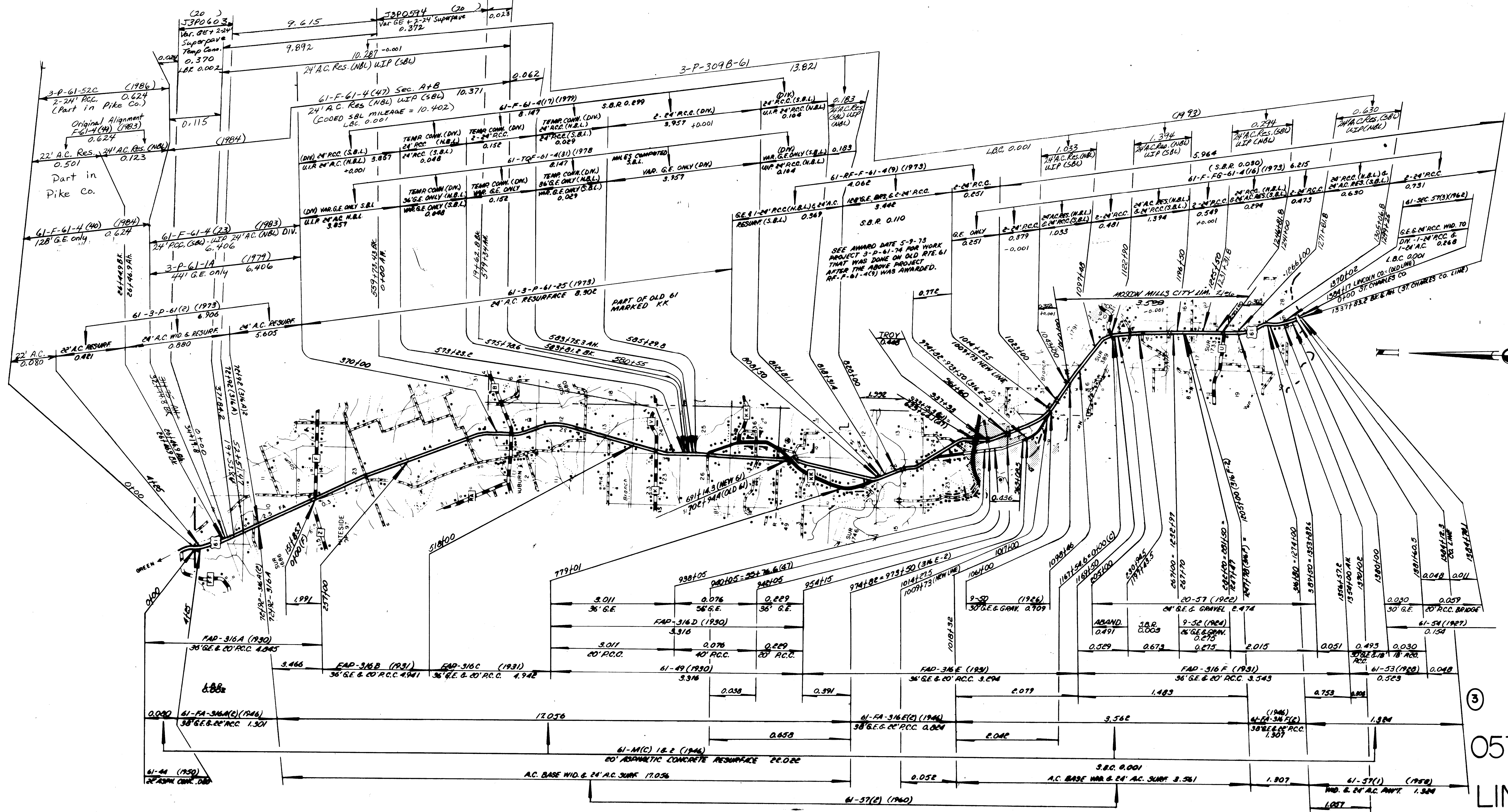

ROUTES 61

3

057 SHEET 2 OF 4

LINCOLN











ROUTES D  
V  
EE  
FF  
NN

③  
057  
LINCOLN

SHEET 7 OF 4

SV-1(7)-1960  
GRAN. 6.027  
SV-2-1963(2)(1962)  
24.0 E. FORAN. 6.027  
V-64-(1964)  
20 OIL ABS. TR. 6.027  
CO57-V(10)DM (1994)  
20 Surf Lev. A.C. Res. 6.027

326+30(CE)-  
0100  
76150  
171450  
1078400  
30-N. N. 30. 65.50 (1966)  
24 OIL ABS. TR. 6.027  
0-57 (1957)  
20 OIL ABS. TR. 6.027  
188+40.5  
0-30.6  
(1987)  
0-614  
CO57-D(2)  
20 Bk Mt. Res.  
20 Surf Lev. Res.  
20 OIL ABS. TR. 6.027  
0-023  
CO57-V(10)DM (1994)  
20 OIL ABS. TR. 6.027  
0-023  
CO57-D(2)  
20 Bk Mt. Res.  
20 Surf Lev. Res.  
20 OIL ABS. TR. 6.027

333100  
33716.3 (OWN) - 250141.3 (OIL)  
33714.0 (OWN) - 250175 (OIL)  
LAD. OIL  
20 OIL ABS. TR. 6.027

CO57-E(1)DM (1992)  
20 OIL ABS. TR. 6.027  
CO57-E(2)DM (1992)  
20 OIL ABS. TR. 6.027  
CO57-E(3)DM (1992)  
20 OIL ABS. TR. 6.027  
CO57-E(4)DM (1992)  
20 OIL ABS. TR. 6.027  
CO57-E(5)DM (1992)  
20 OIL ABS. TR. 6.027

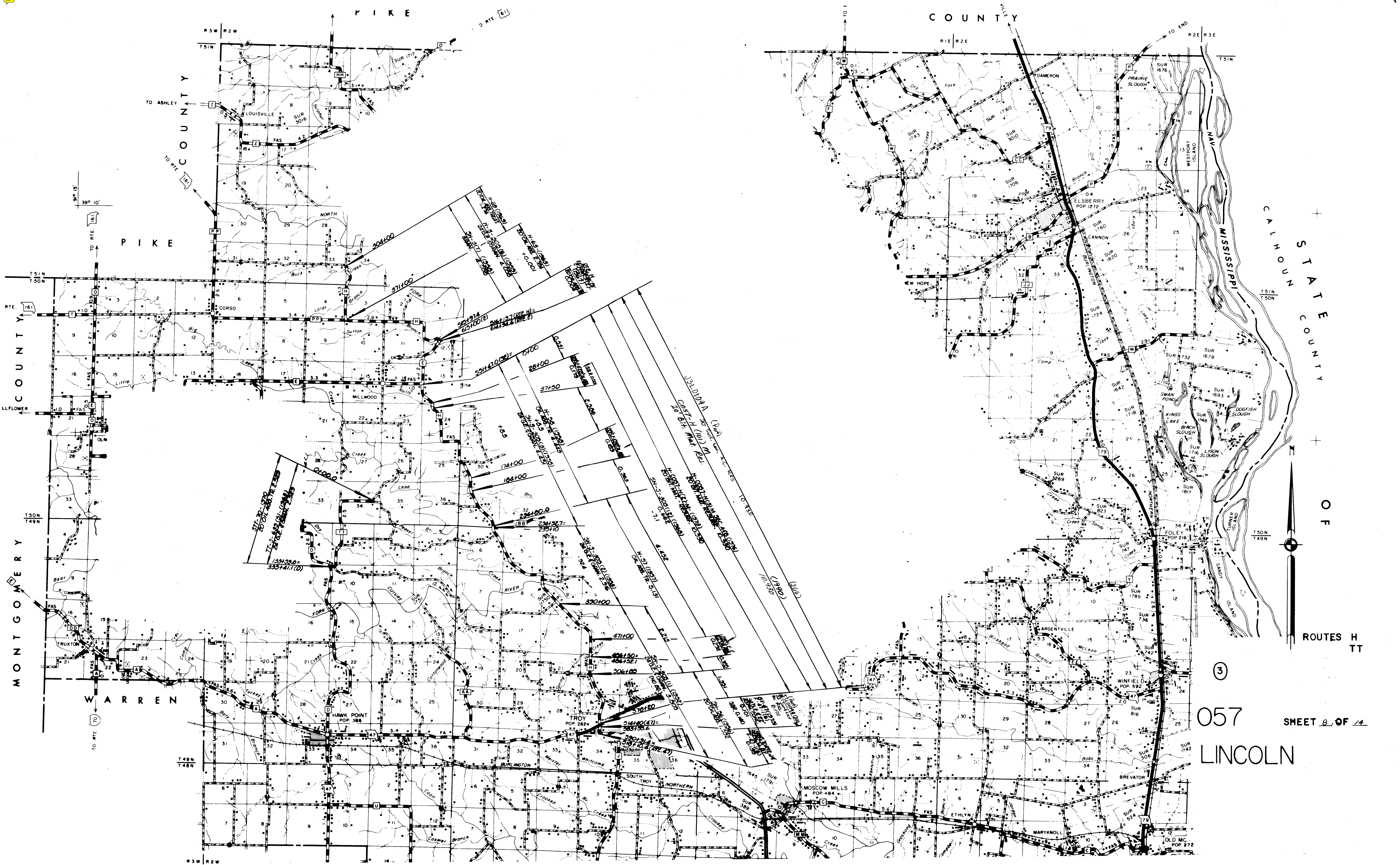

STATE COUNTY OF CALHOUN

ROUTES H TT

③  
057  
LINCOLN

SHEET 8 OF 14





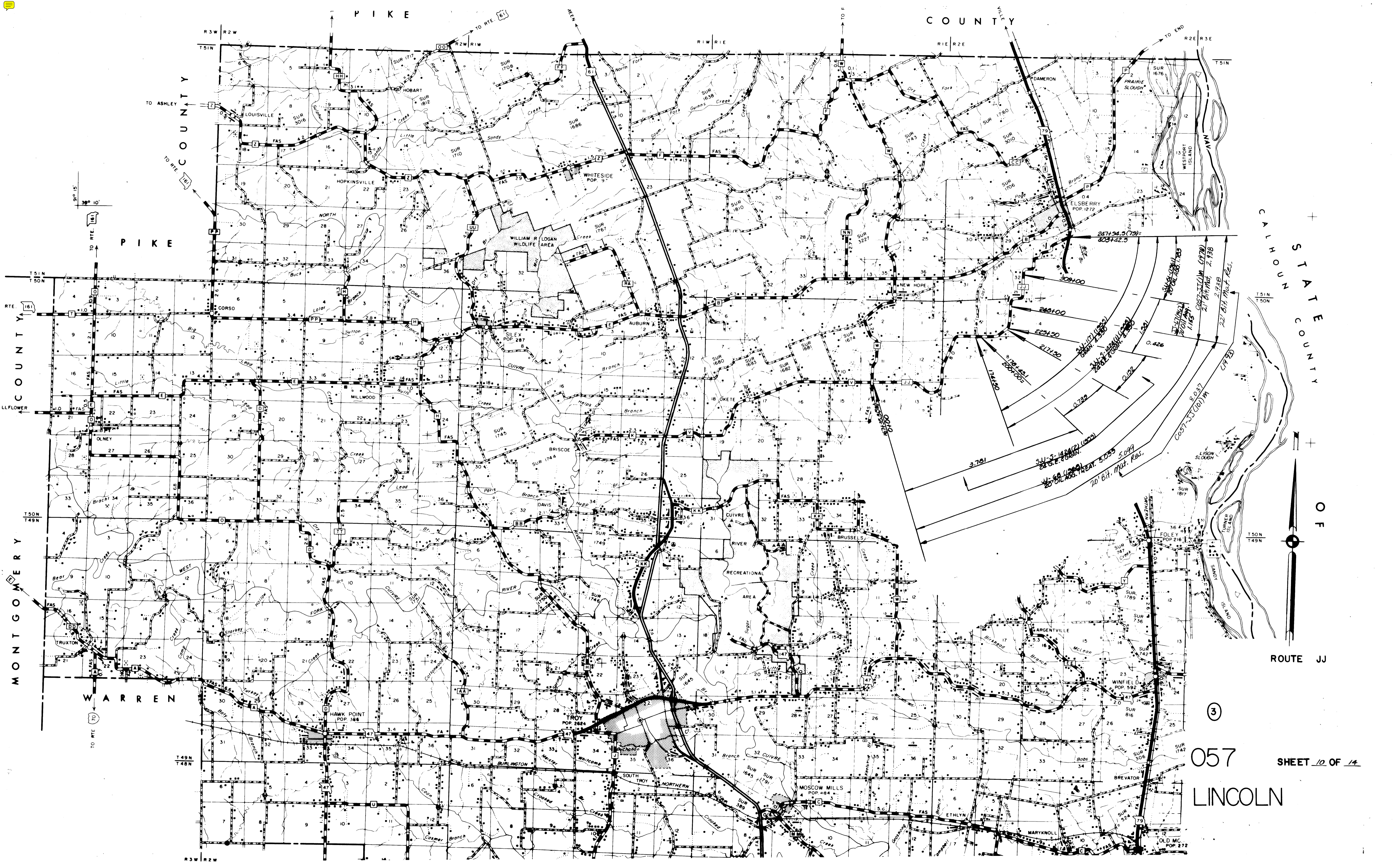

③  
057  
LINCOLN  
SHEET 10 OF 14

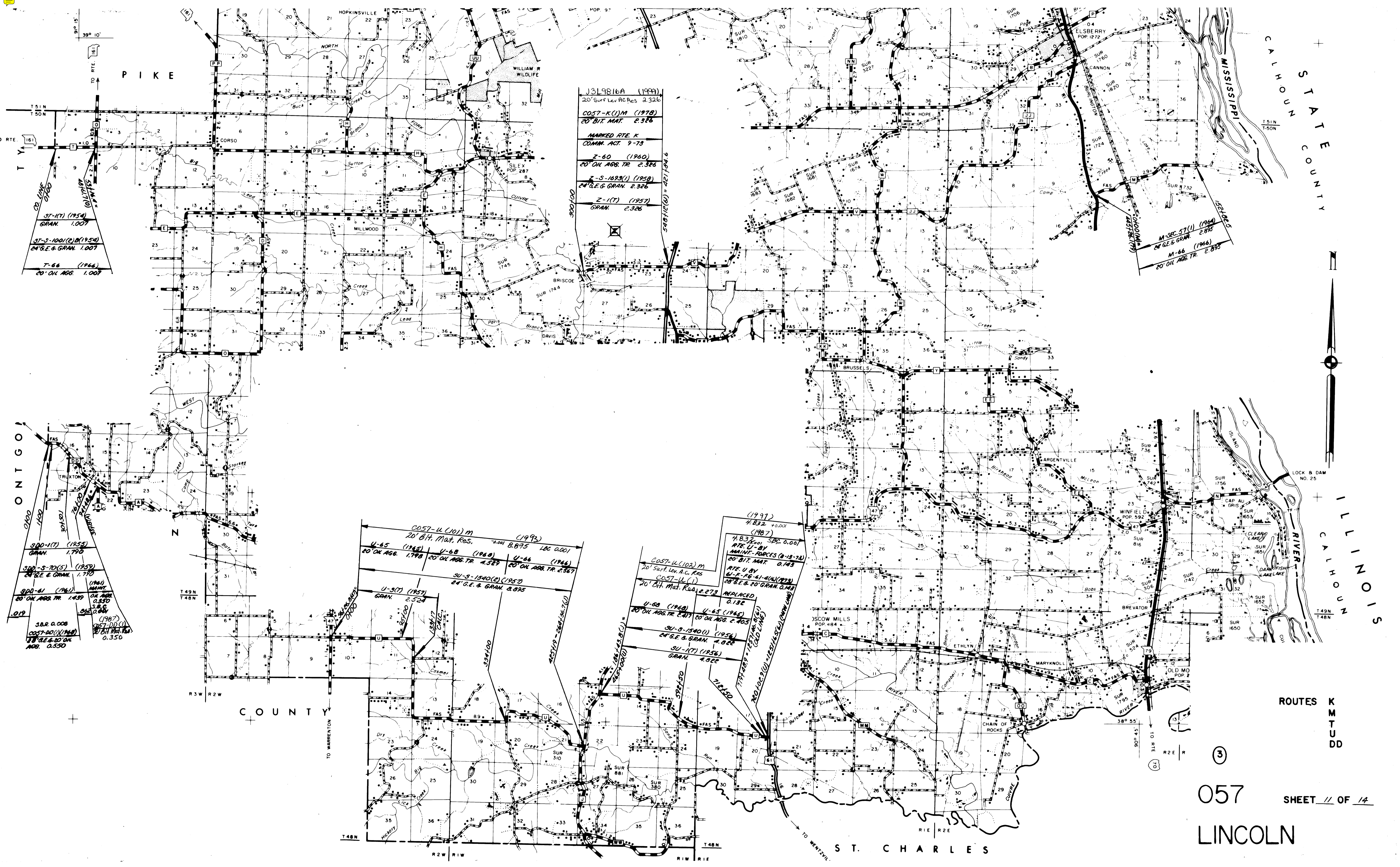

J319816A (1999)  
 20' Surf Lev AC Res 2.326  
 COST-K(1)M (1978)  
 20' BIT. MAT. 2.326  
 MARKED RTE. K  
 COMM. ACT. 9-73  
 Z-60 (1960)  
 20' OIL AGG. TR. 2.326  
 Z-S-1693(1) (1958)  
 24' G.E. & GRAN. 2.326  
 Z-1(T) (1957)  
 GRAN. 2.326

M-SEC-57(1) (1960)  
 24' G.E. & GRAN. 2.835  
 M-66 (1966)  
 20' OIL AGG. TR. 2.835

ST-1(T) (1954)  
 GRAN. 1.007  
 ST-S-1001(2)B(1954)  
 24' G.E. & GRAN. 1.007  
 T-66 (1966)  
 20' OIL AGG. 1.007

900-1(7) (1953)  
 GRAN. 1.790  
 900-S-70(5) (1959)  
 24' G.E. & GRAN. 1.790  
 900-61 (1961)  
 20' OIL AGG. TR. 1.439  
 3&R 0.008  
 COST-20(1)M(1960)  
 24' G.E. & 20' OIL AGG. TR. 0.350  
 (1967)  
 COST-20(1)M(1967)  
 24' G.E. & 20' OIL AGG. TR. 0.350

COST-U(101)M (1993)  
 20' Bit. Mat. Res. 8.895 L&C 0.001  
 U-65 (1945) U-68 (1968) U-66 (1946)  
 20' OIL AGG. 1.798 20' OIL AGG. TR. 4.329 20' OIL AGG. TR. 2.367  
 SU-S-1540(2) (1950)  
 24' G.E. & GRAN. 2.895

(1997)  
 4.832 +0.001 SPC. 0.001  
 (1987)  
 4.832 +0.001 SPC. 0.001  
 RTE. U BY  
 MAIN. FORCES (8-13-72)  
 20' BIT. MAT. 0.143  
 RTE. U BY  
 61'-E-16-41-40W(1973)  
 28' G.E. & 20' GRAN. 0.143  
 COST-U(102)M  
 20' Surf. Lev. A.C. Res  
 COST-U(1)  
 20' Bit. Mat. R.O.A. 2.273 REPLACED  
 0.132  
 U-68 (1948) U-65 (1945)  
 20' OIL AGG. TR. 2.417 20' OIL AGG. TR. 2.405  
 SU-S-1540(1) (1956)  
 24' G.E. & GRAN. 4.822  
 SU-1(7) (1956)  
 GRAN. 4.322





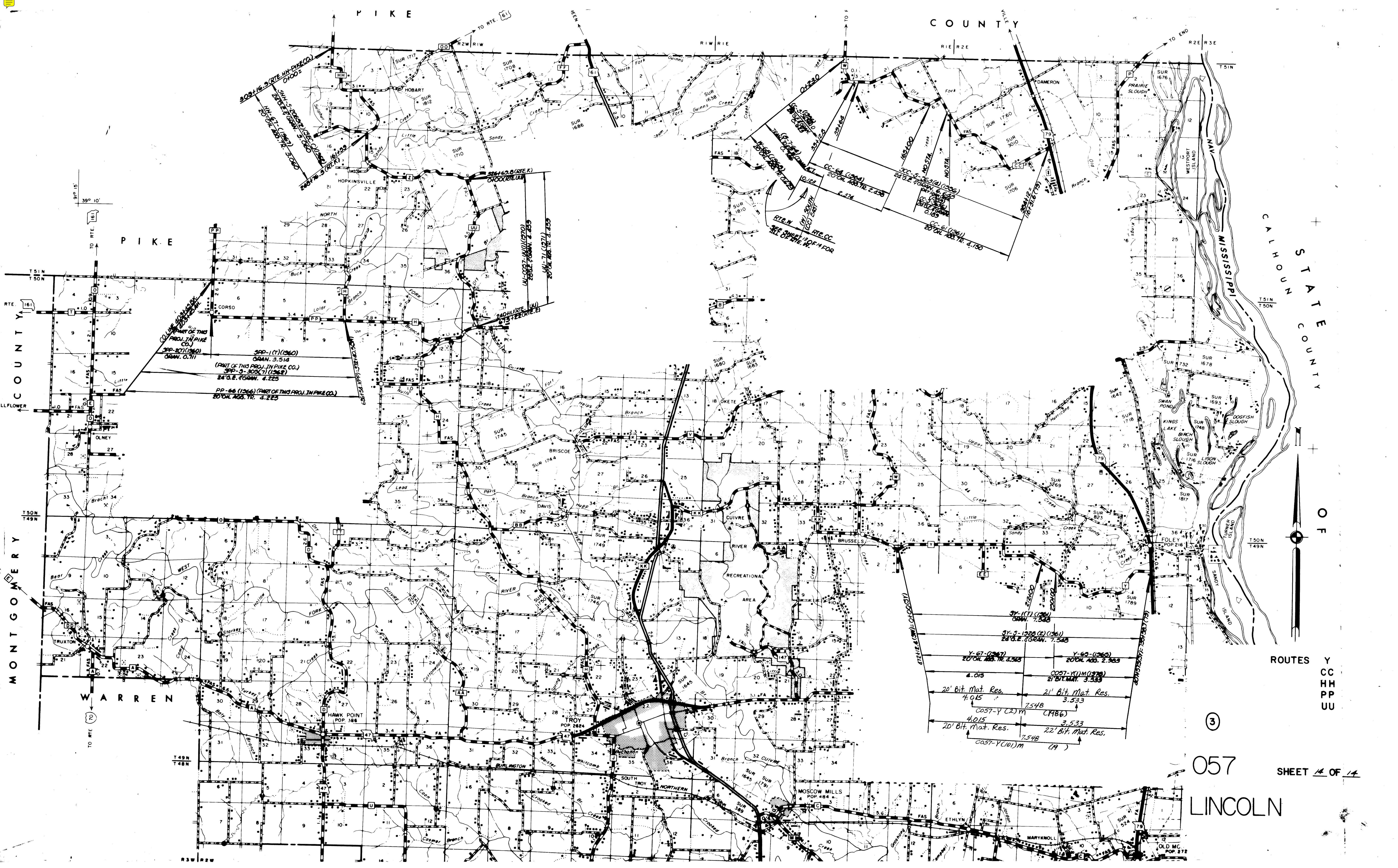

COUNTY

PIKE

WARREN

CALHOUN STATE COUNTY

OF

ROUTES Y  
CC  
HH  
PP  
UU

PP-66 (1966) (PART OF THIS PROJ. IN PIKE CO.)  
20' OR. AGG. TR. 3.225

SP-3-305 (7) (1962)  
24' G.E. 7.666 4.225

SP-1 (7) (1960)  
ORAN. 3.514

SP-87 (1960)  
ORAN. 0.711

Y-67 (1967)  
20' OR. AGG. TR. 2.583

4.015

20' Bit. Mat. Res.  
4.015

20' Bit. Mat. Res.  
4.015

CO57-Y (2) M  
7.548

CO57-Y (1) M  
7.548

Y-66 (1966)  
20' OR. AGG. TR. 2.583

CO57-Y (1) M (1986)  
3.533

22' Bit. Mat. Res.  
3.533

CO57-Y (1) M  
7.548

057 SHEET 14 OF 14

LINCOLN

3