

Note: Old Eas. of 1281 B is reloc. and shifted to 1214 Bk with a net diff. of 3.8 feet.

COUNTY

ROUTES
36
WW

② 061 SHEET 2 OF 11
MACON

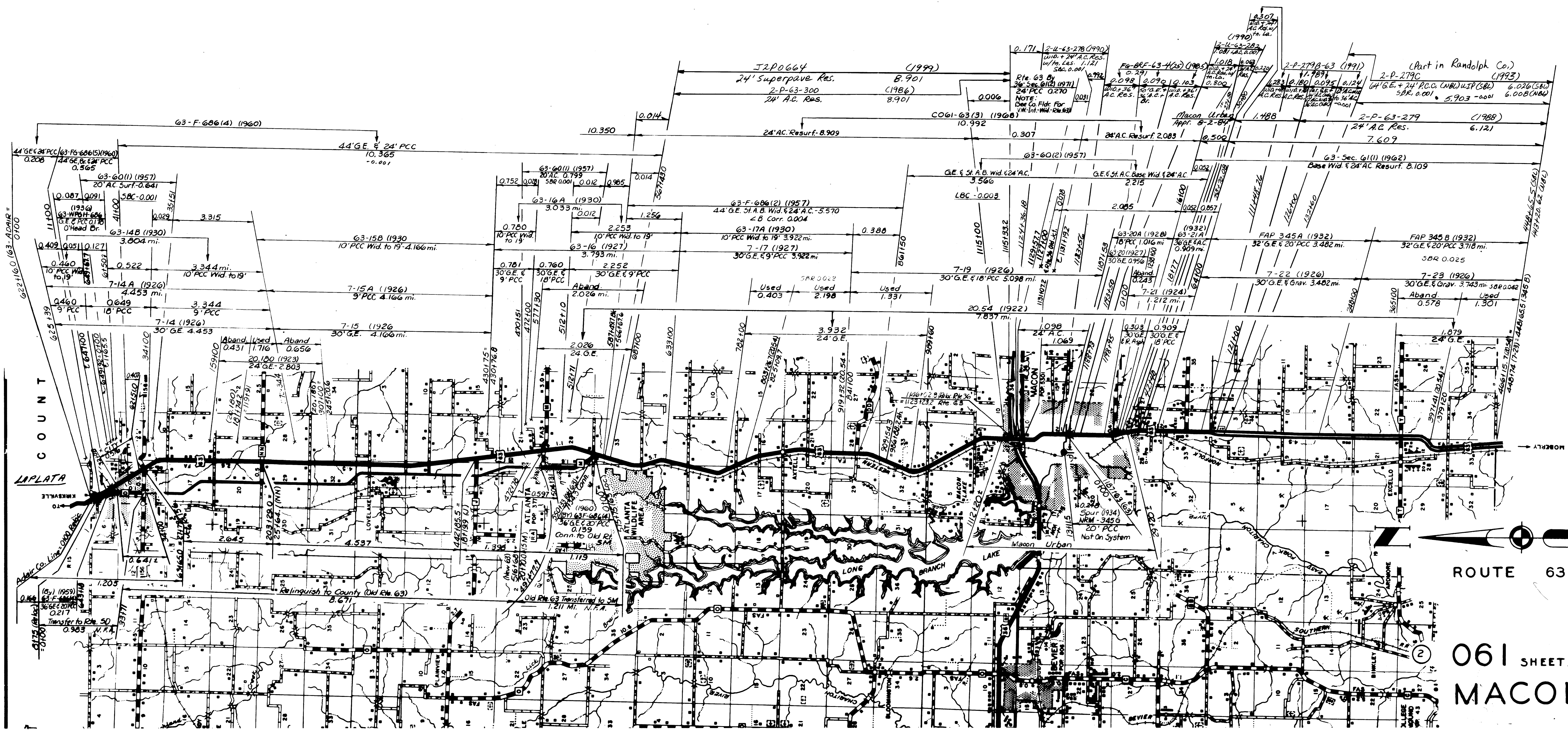

COUNT

LAPLATA

ROUTE 63

061 SHEET 4 OF 11
MACON

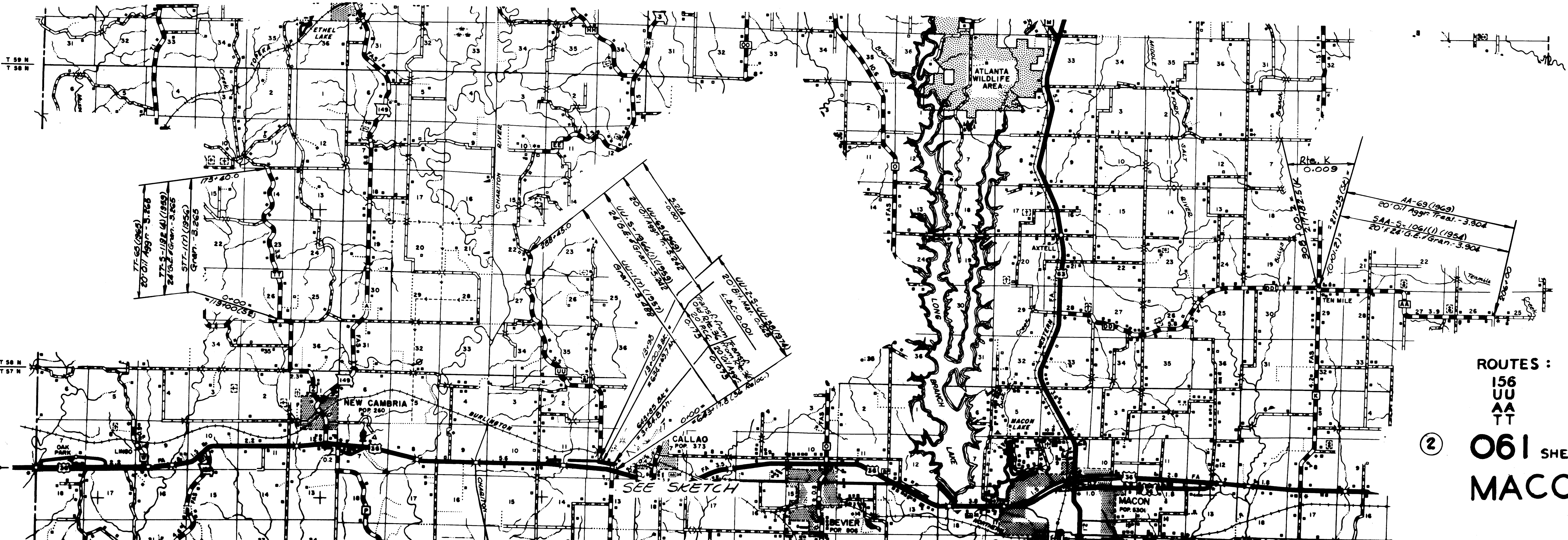
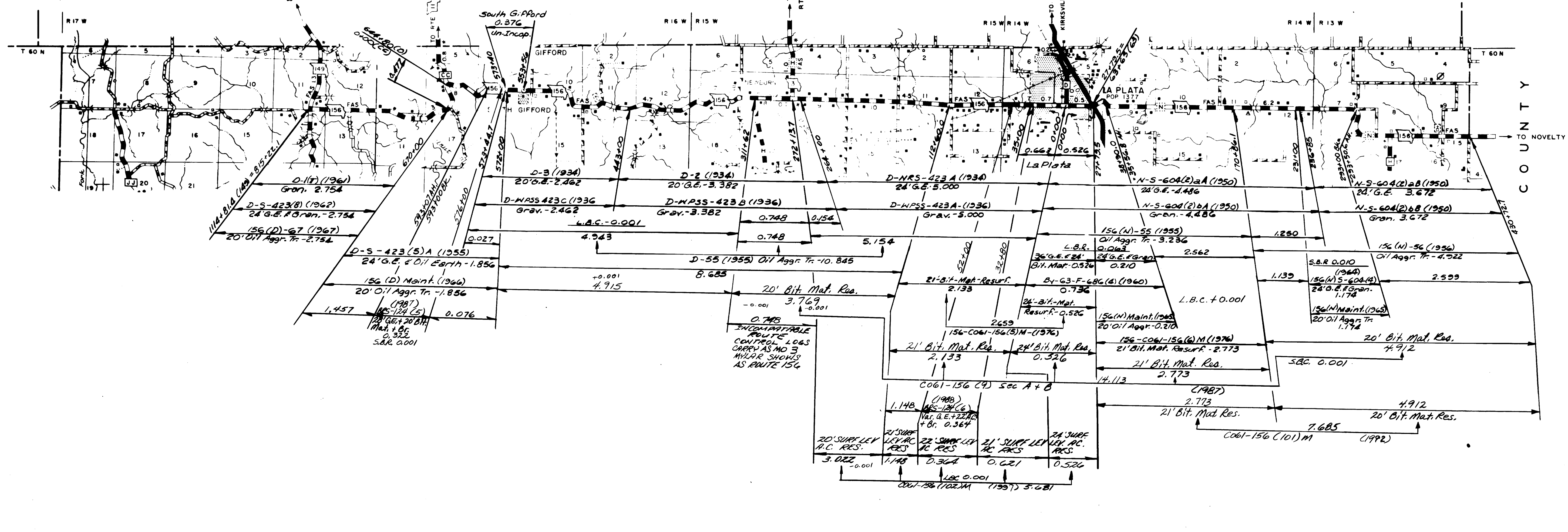

ROUTES :
 156
 UU
 AA
 TT
 ② 061 SHEET 6 OF 11
 MACON

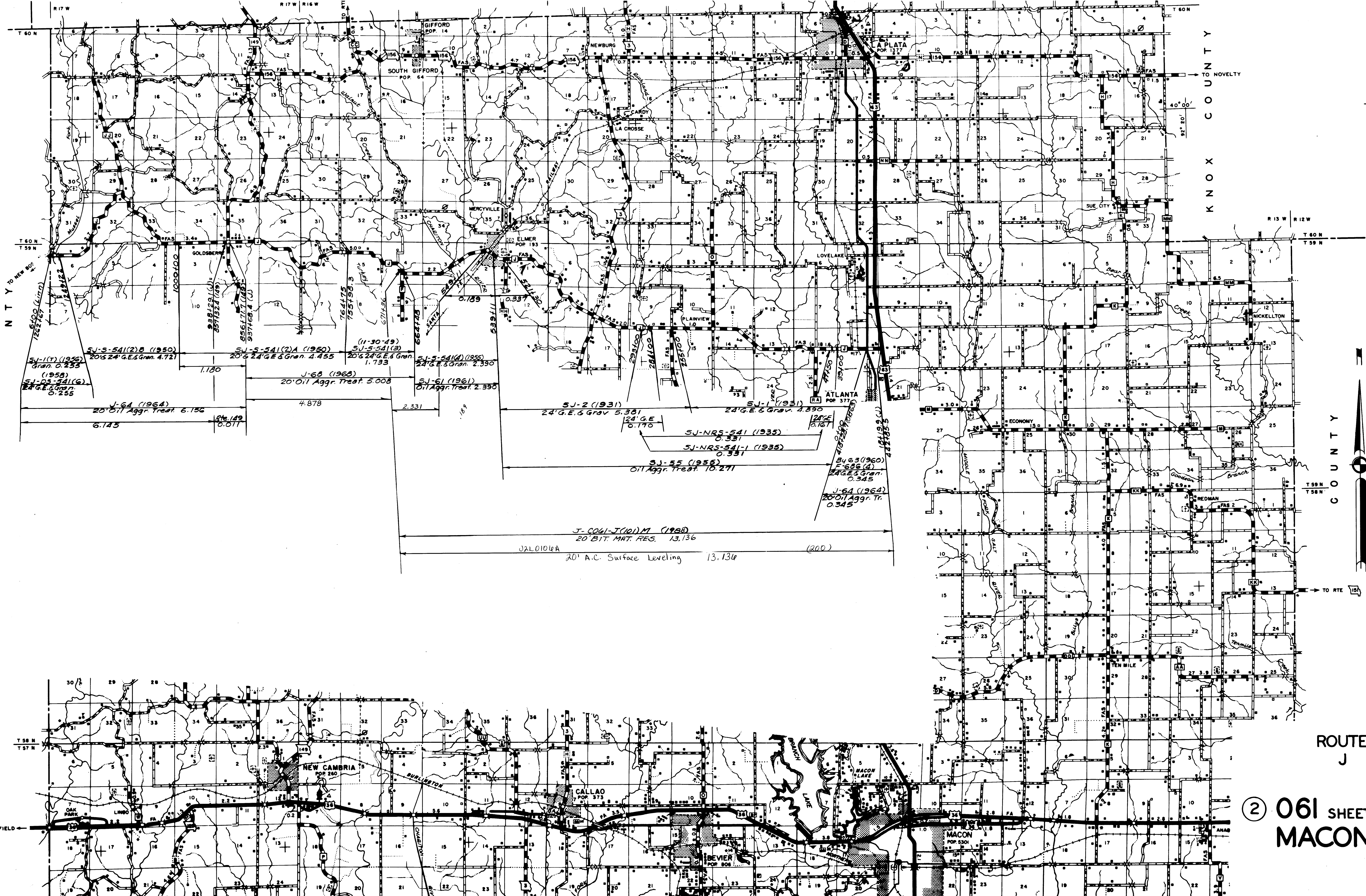

KNOX COUNTY

COUNTY

ROUTE J

② 061 SHEET 8 OF 11
MACON

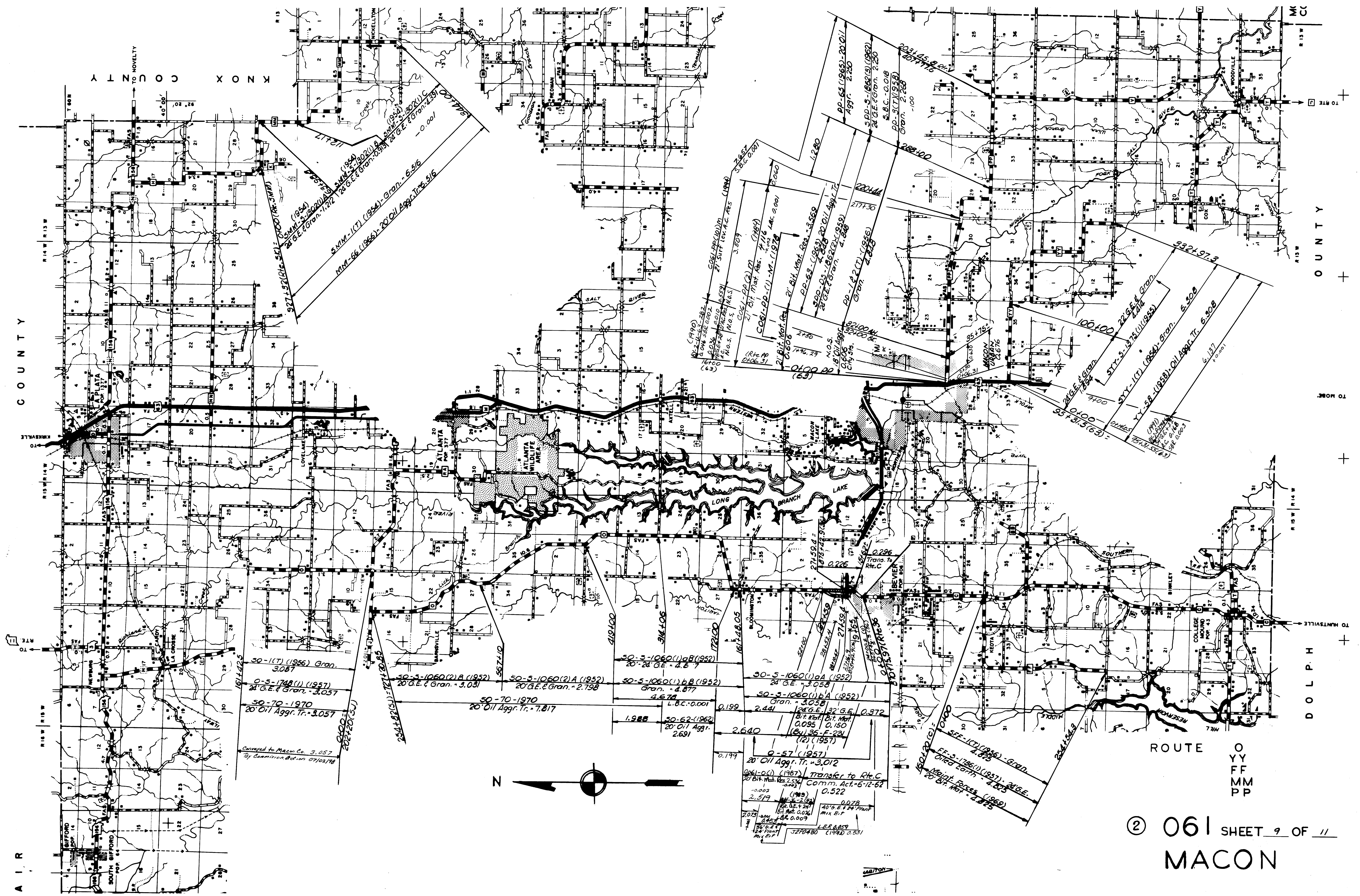

30-1(T) (1956) Gran. 3.087
 0-5-1748(1) (1957) 21' G.E. & Gran. 3.057
 50-70-1970 20' Oil Aggr. Tr. 3.057
 Conveyed to Macon Co. 3.057 By Commission Act on 07/10/1968

50-5-1060(2)A (1952) 20' G.E. & Gran. 2.798
 50-5-1060(1)A (1952) 20' G.E. & Gran. 4.877
 50-5-1060(1)B (1952) 20' G.E. & Gran. 4.674
 50-70-1970 20' Oil Aggr. Tr. 7.817
 50-62-(1962) 20' Oil Aggr. 2.691

30-5-1060(1)A (1952) 24' G.E. 3.058
 50-5-1060(1)B (1952) 24' G.E. 3.058
 50-57-(1957) 20' Oil Aggr. Tr. 3.012
 0661-0(1) (1957) transfer to Rte.C
 20' Bit. Mat. R. 2.534 Comm. Act. 6-12-62
 0.522
 2.579
 0.078
 40' G.E. & 24' Plant
 Mix B.F.
 0.009
 0.009
 5270480 (1964) 0.851

50-5-1786(1) (1957) 24' G.E. Maint. Forces (1959) 20' Oil Mat. 4.825

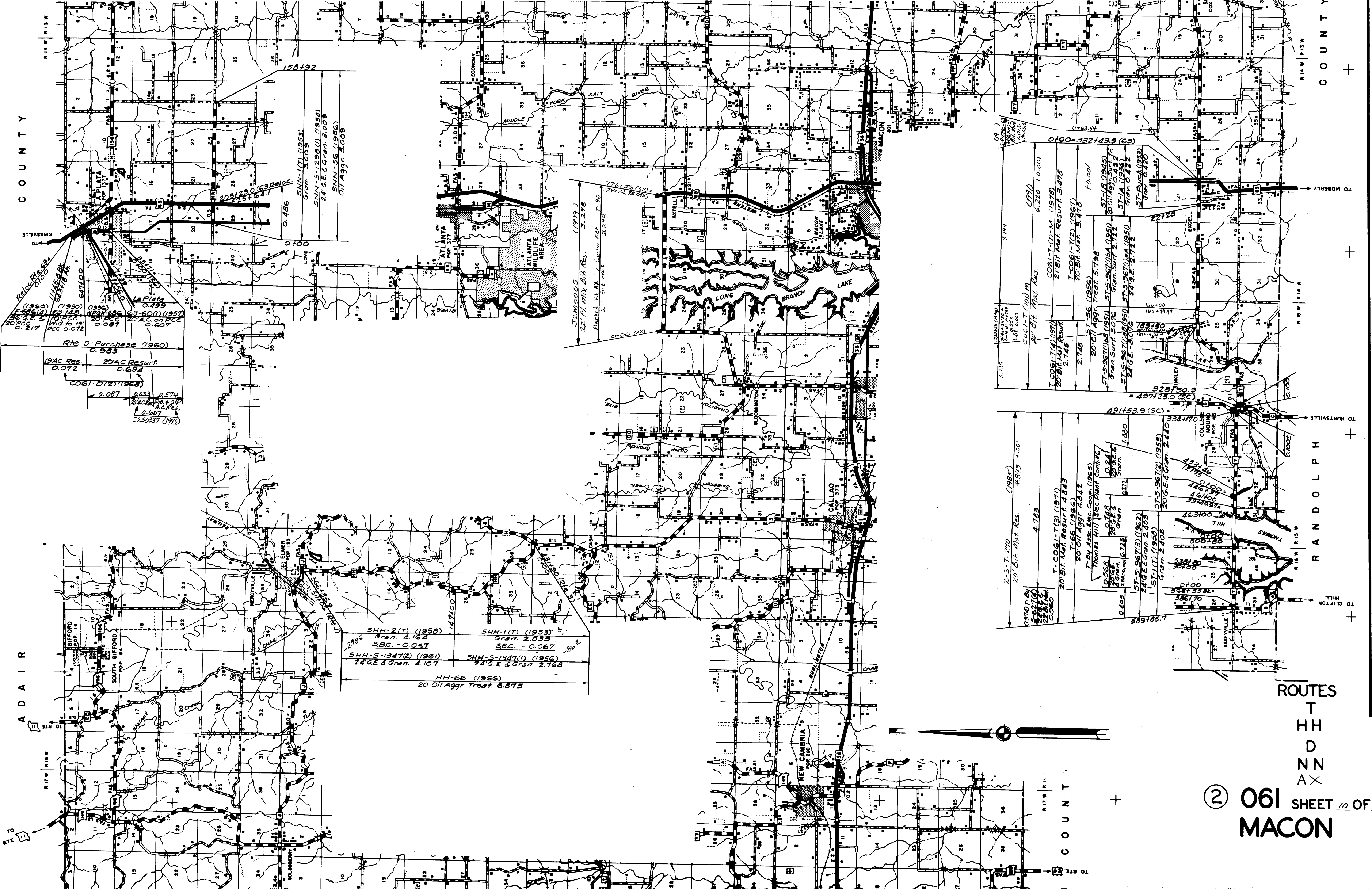

COUNTY

ADAIR

COUNTY

COUNTY

RANDOLPH

ROUTES
T
HH
D
NN
AX

② 061 SHEET 10 OF 11
MACON

