

GASCONADE CO.

COUNTY

CRAWFORD

37° 45'

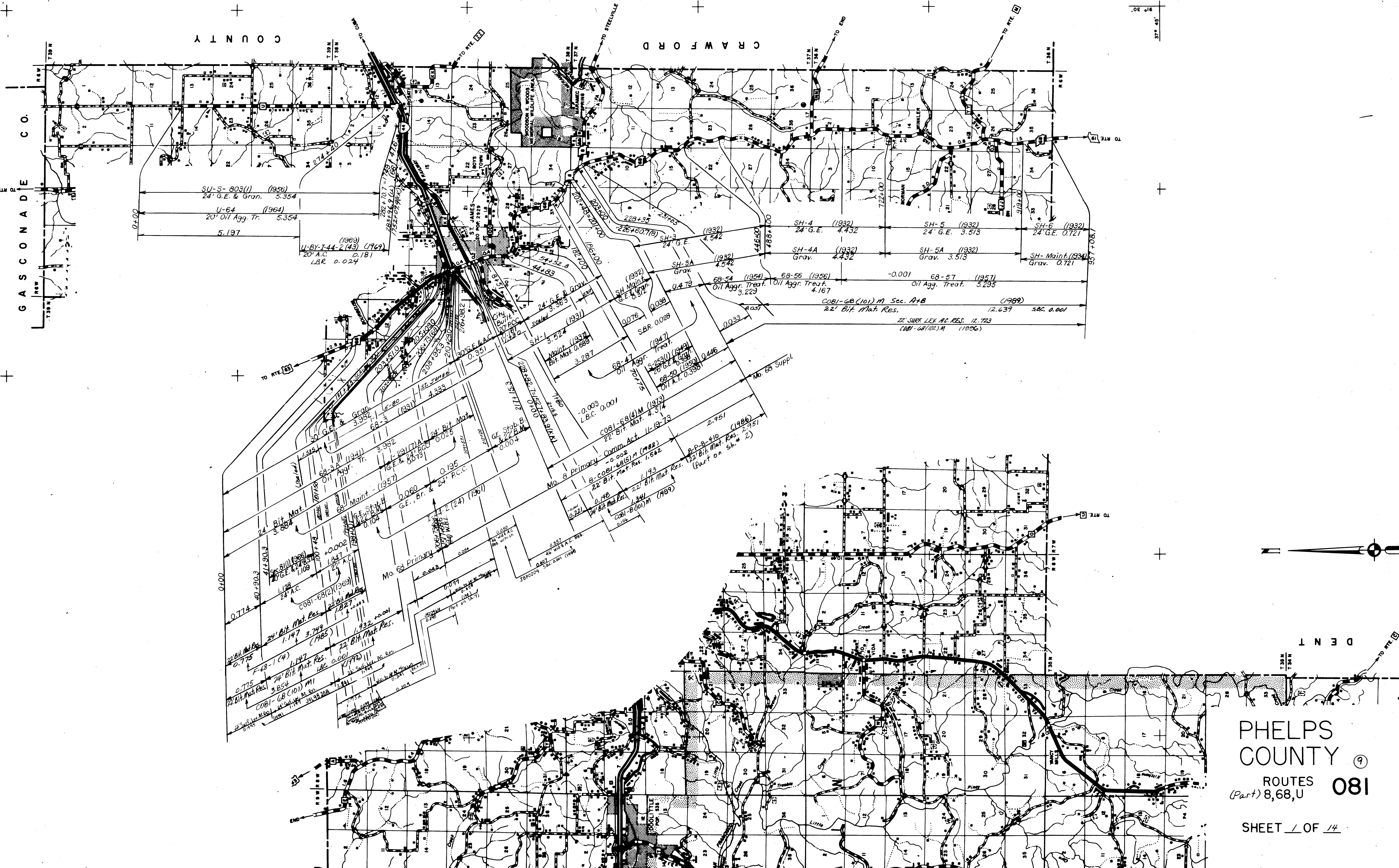

PHELPS COUNTY 9
 ROUTES (Part) 8, 68, U 081
 SHEET 1 OF 14

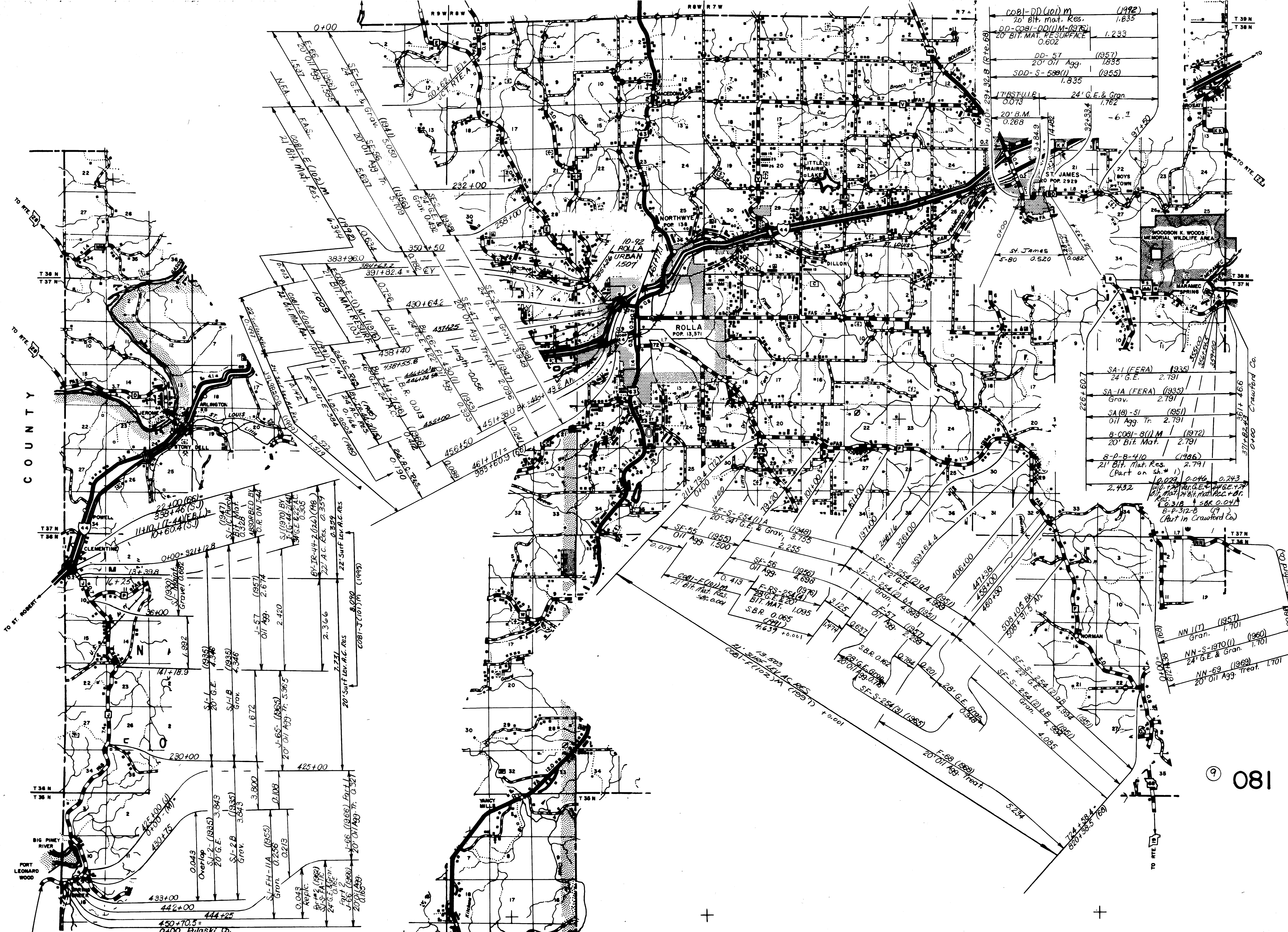

081-DD (101) M (1992)
20' Bit. Mat. Res. 1.835

DD-COBI-DD (11) M (1976)
20' BIT. MAT. RESURFACE 0.602

DD-57 (1957)
20' Oil Agg. 1.835

SDD-S-588(1) (1955)
1.835

TRFSTULP
0.073

24' G.E. & Gran 1.762

20' B.M. 0.268

0+00-29+32.8 (Rte. 68)

SA-1 (FERA) (1935)
24' G.E. 2.791

SA-1A (FERA) (1935)
Grav. 2.791

SA (B)-51 (1951)
Oil Agg. Tr. 2.791

B-COBI-B (11) M (1972)
20' Bit. Mat. 2.791

B-P-B-410 (1986)
21' Bit. Mat. Res. 2.791
(Part on sh. # 1)

2.432

0.073 0.046 0.243
10' + 20' Var. G.E. + 1/2" G.E. + 2"
Bit. Mat. + 20' Bit. Mat. Res. + 0.1
Res. 3/8" + SBR 0.041
B-P-312-B (19)
(Part in Crawford Co.)

NN-1(T) (1957)
Gran. 1.701

NN-S-1970(1) (1960)
24' G.E. & Gran. 1.701

NN-69 (1969)
20' Oil Agg. Treat. 1.701

081

PHELPS COUNTY

ROUTES
(Part) 8, E, NN,
J(PART), F, DD,
SHEET 2 OF 14

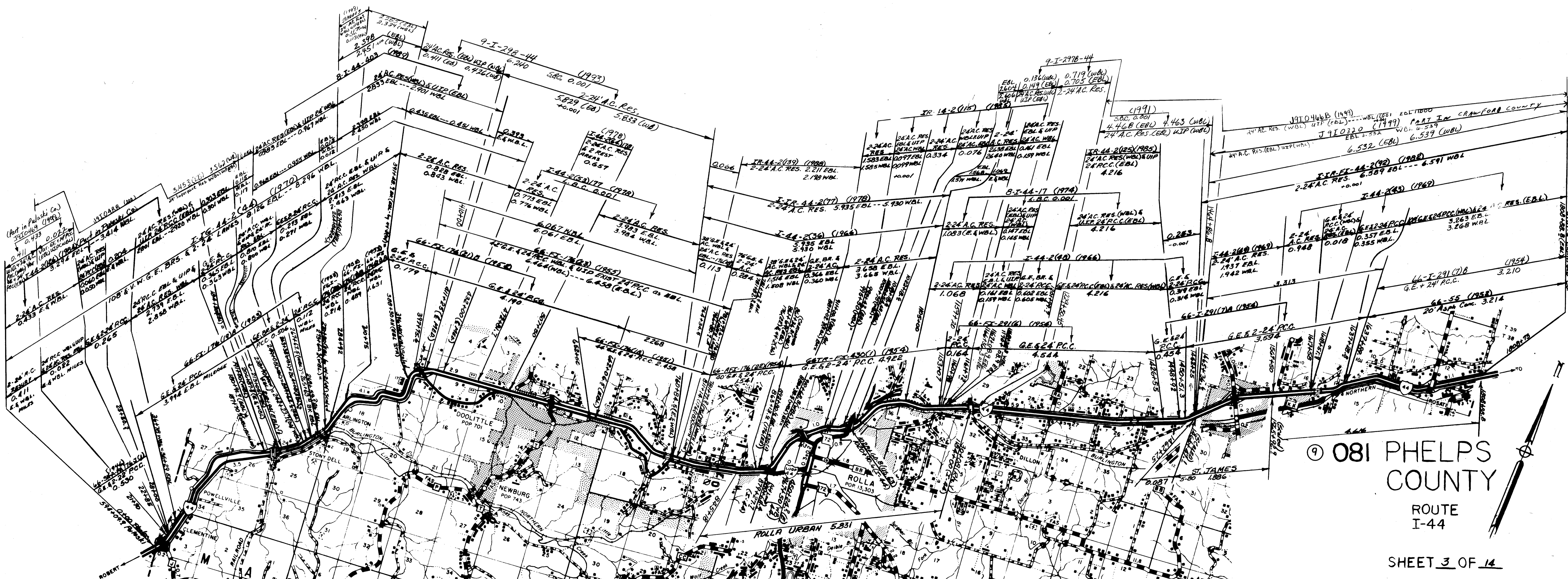

⑨ 081 PHELPS COUNTY

ROUTE I-44

Spur. Trans. from Rte. 66
by F.I. 430(1) 20' P.C.C.
0.072 (See Sheet #5)

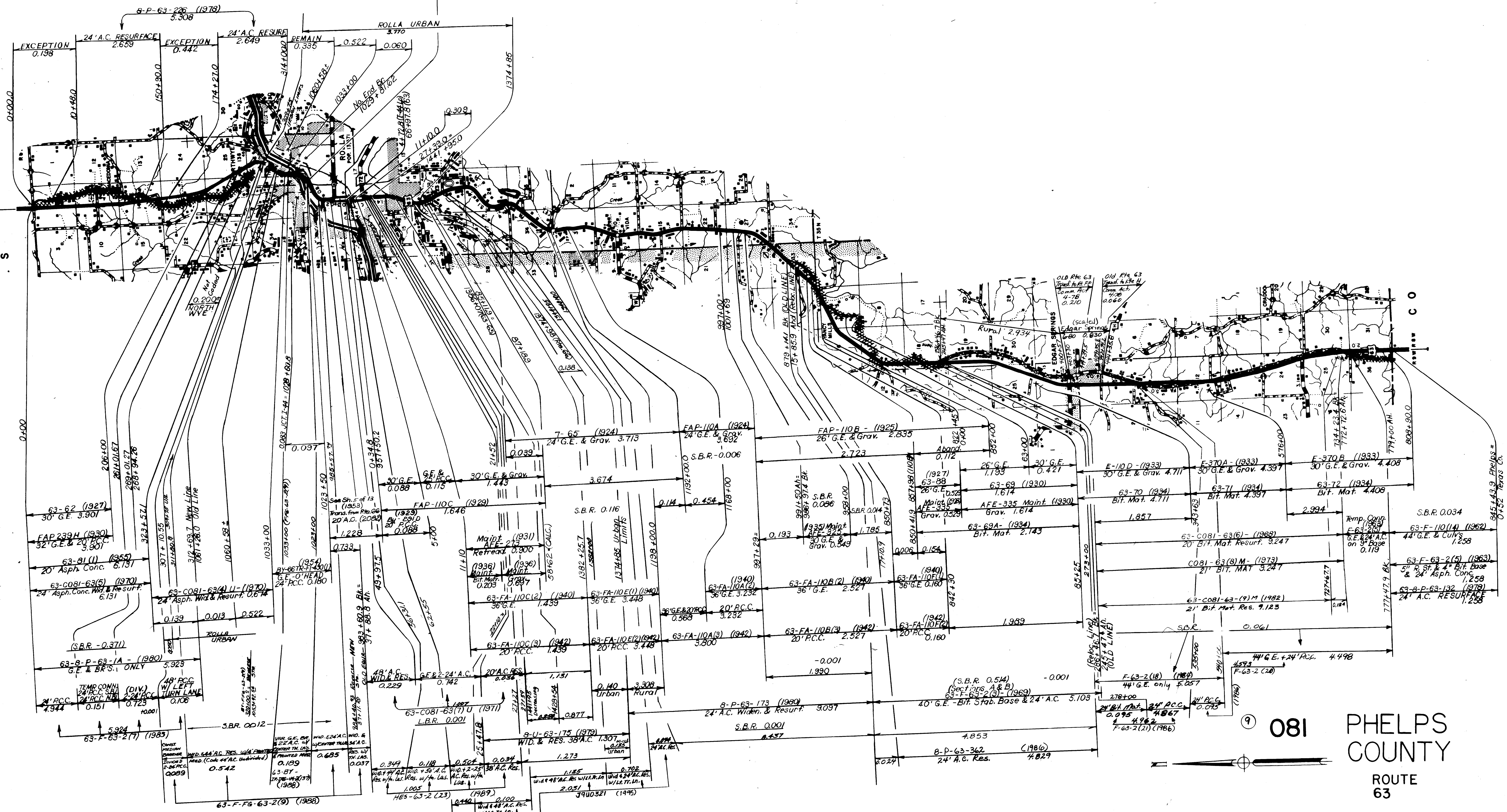

081 PHELPS COUNTY
ROUTE 63

Note: Sta. 0+00 to Sta. 662+06.5
S.B.R. = 0.504

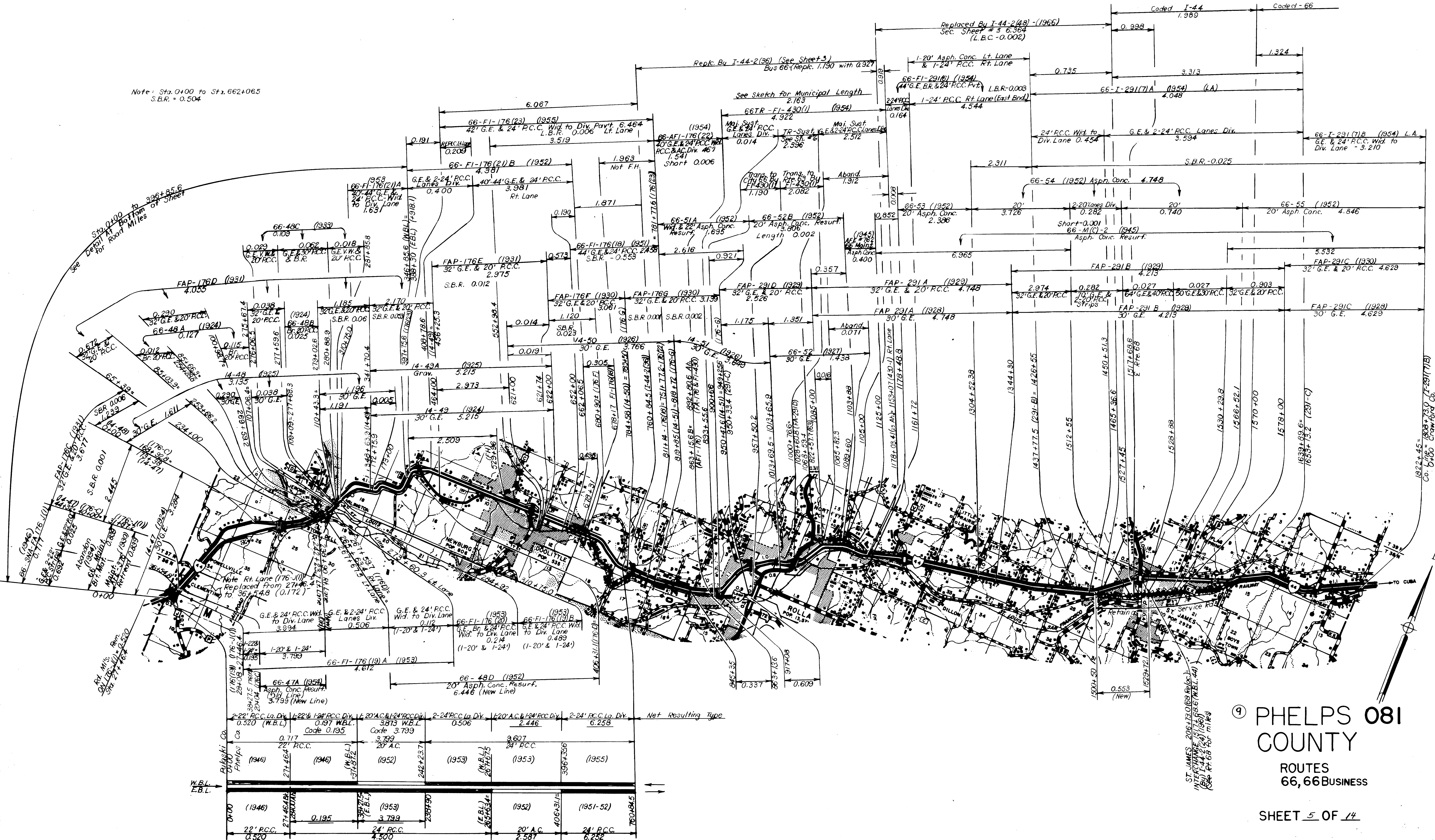

Note: Use underlined #1 image for Corr. Rdwy. Length

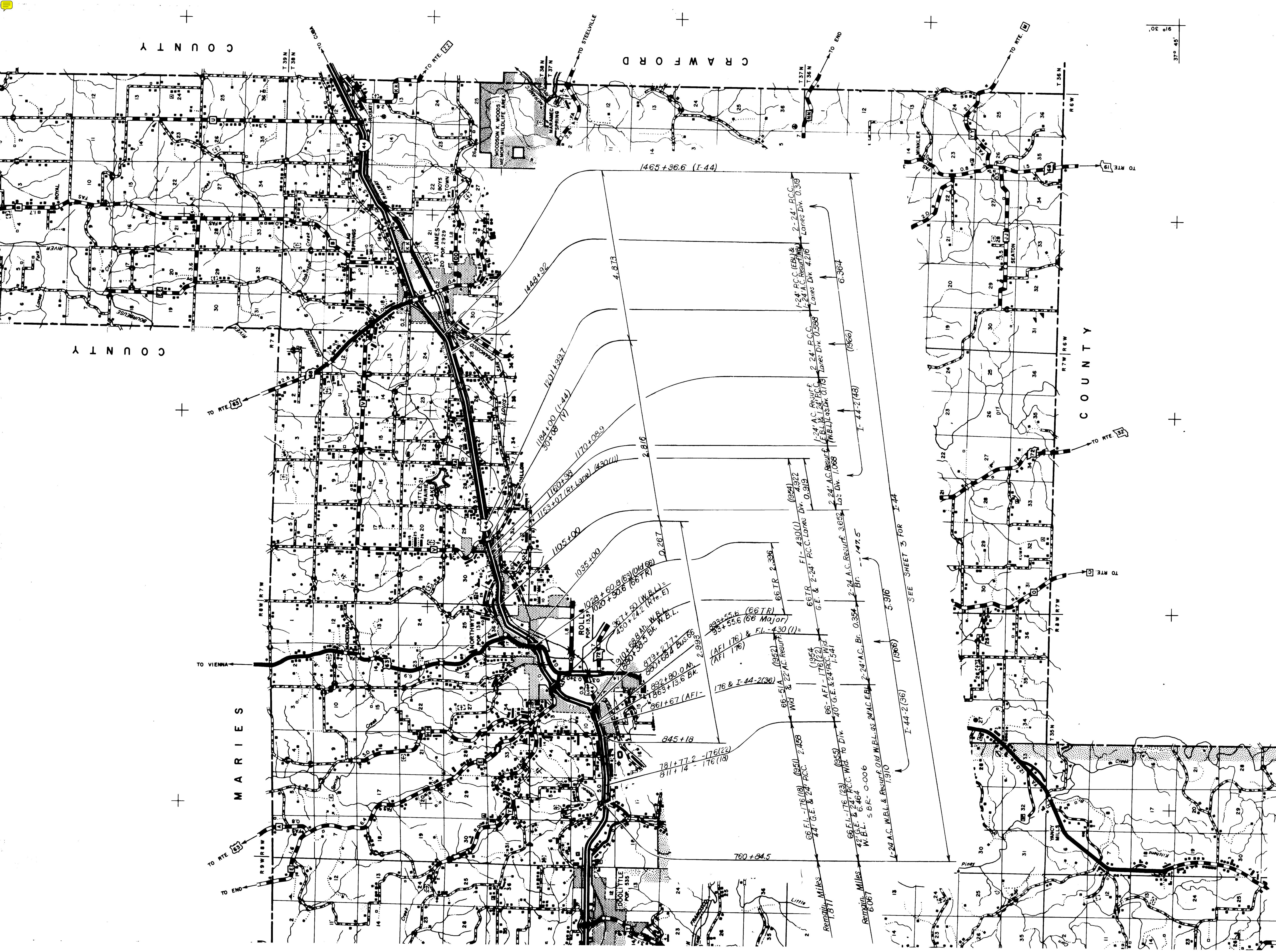

⑨
081 PHELPS COUNTY
 ROUTE
 66TR History
 SHEET 6 OF 14

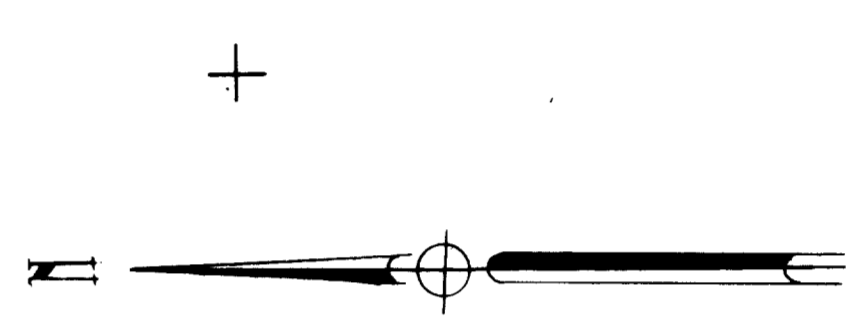
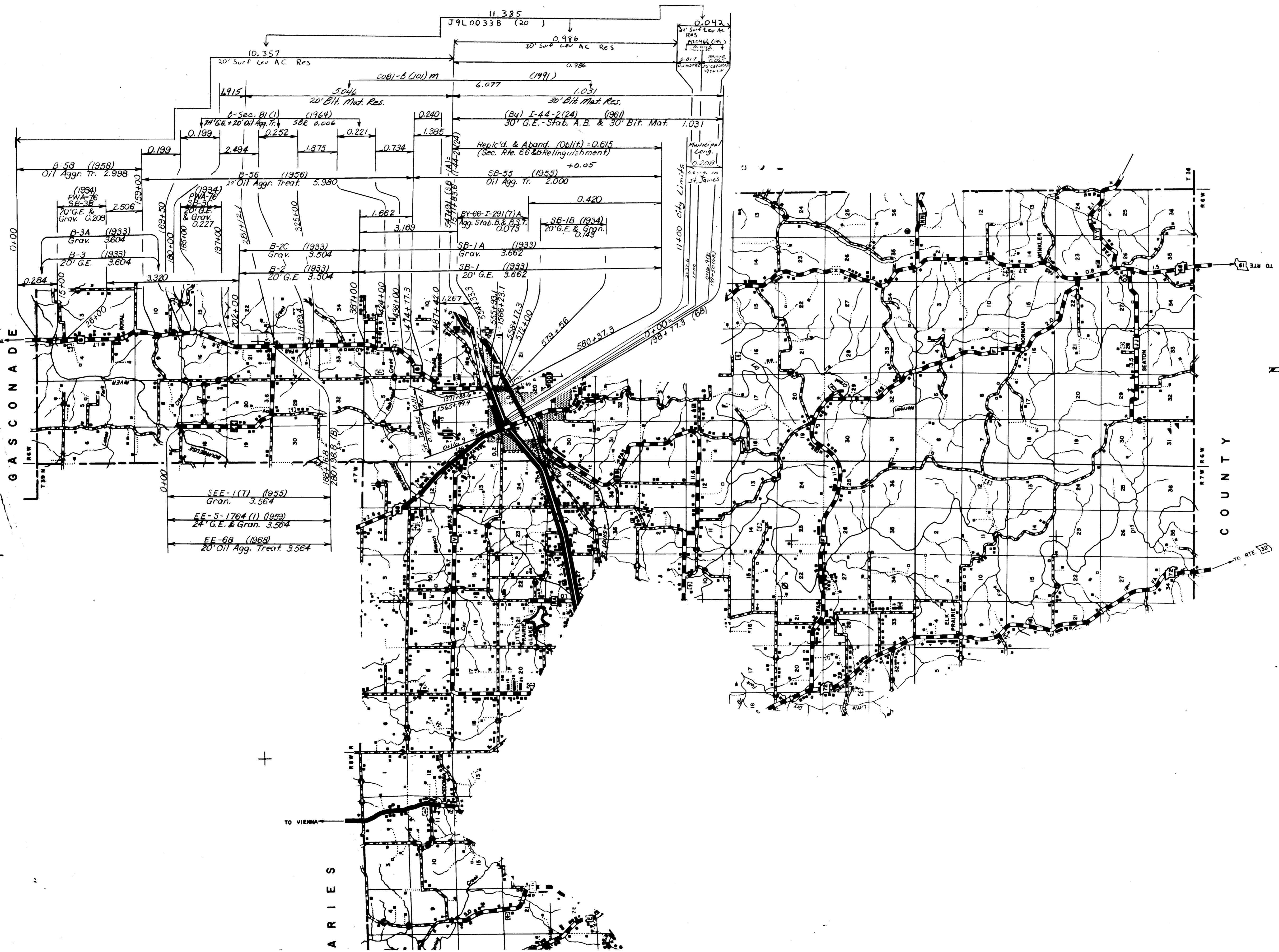

PHELPS
COUNTY
ROUTES
EE, B

⑨
081

SHEET 7 OF 14

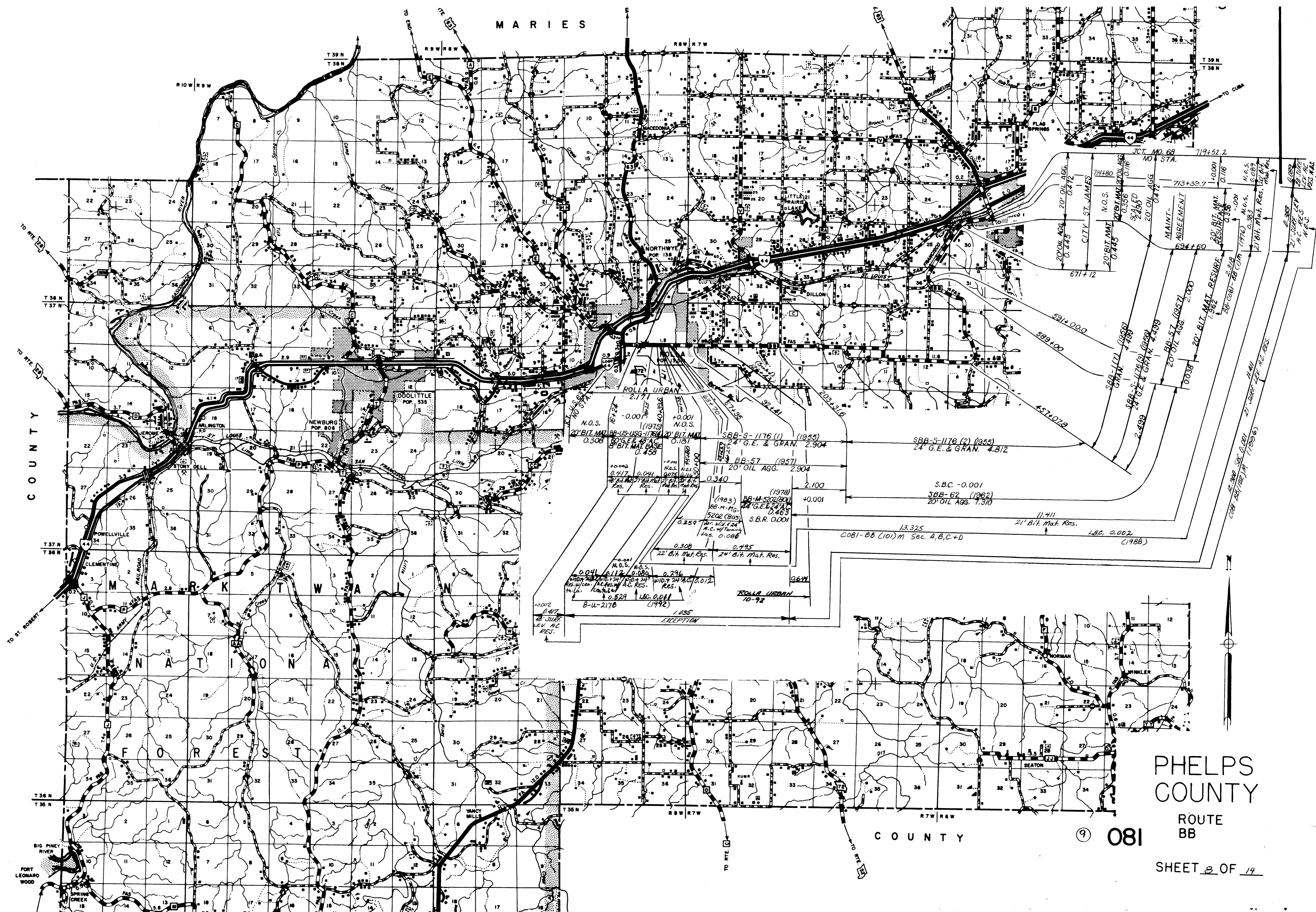

PHELPS COUNTY

ROUTE BB

9 081

SHEET 8 OF 14

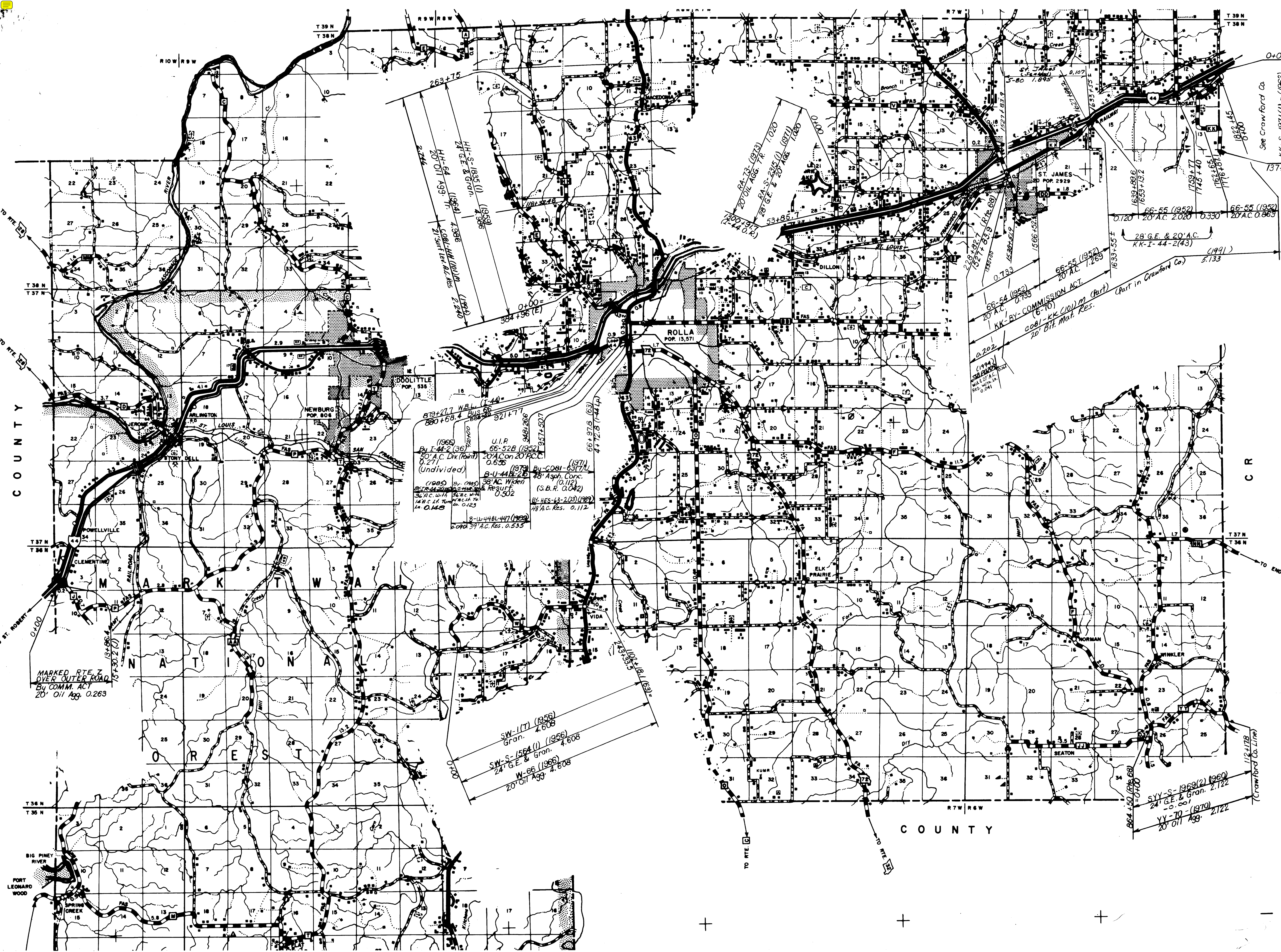

⑨
081

PHELPS COUNTY

ROUTES
KK, RA, HH, YY,
W, Z, Loop I-44

SHEET 9 OF 14

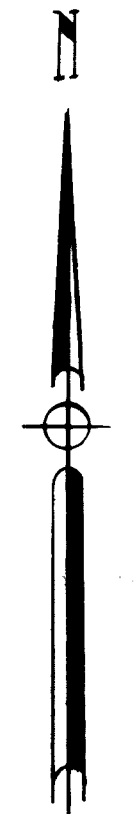

See Crawford Co.
KK-S-1971(I) - (1962)
24' G.E. & GRAN. 2.591
KK-GT-(1967)
20' OIL AGG. TR. 2.391
2281-KE(11)(1967)(1/4)
20' Bit. Mat. Res. 2.591
Chart in Crawford Co.

U.I.P.
By I-44-2 (36) 66-52B (1952)
20' A.C. Div. (part) 20' A.C. on 20' P.C.C.
0.271 0.638
(Undivided)
By (195) 38' AC Widen & Resurf.
14' AC. 14' TR. 0.123
14' O.M.B.
By IES-63-2(2) (1969)
48' A.C. Res. 0.112
By G-681-63 (74) (1971)
89' Asp. Conc. (S.B.R. 0.042)
By IES-63-2(2) (1969)
48' A.C. Res. 0.112

MARKED RTE. Z
OVER OUTER ROAD
By COMM. ACT
20' Oil Agg. 0.263

TO RTE. 24

TO RTE. 24

TO END

CRAWFORD COUNTY

BOONE COUNTY

BOONE COUNTY

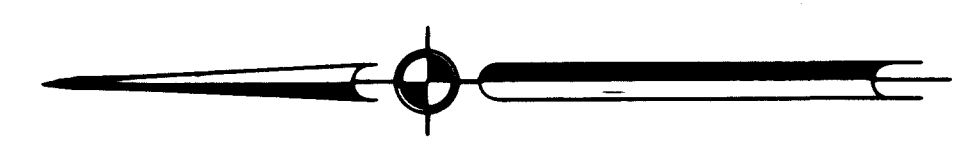
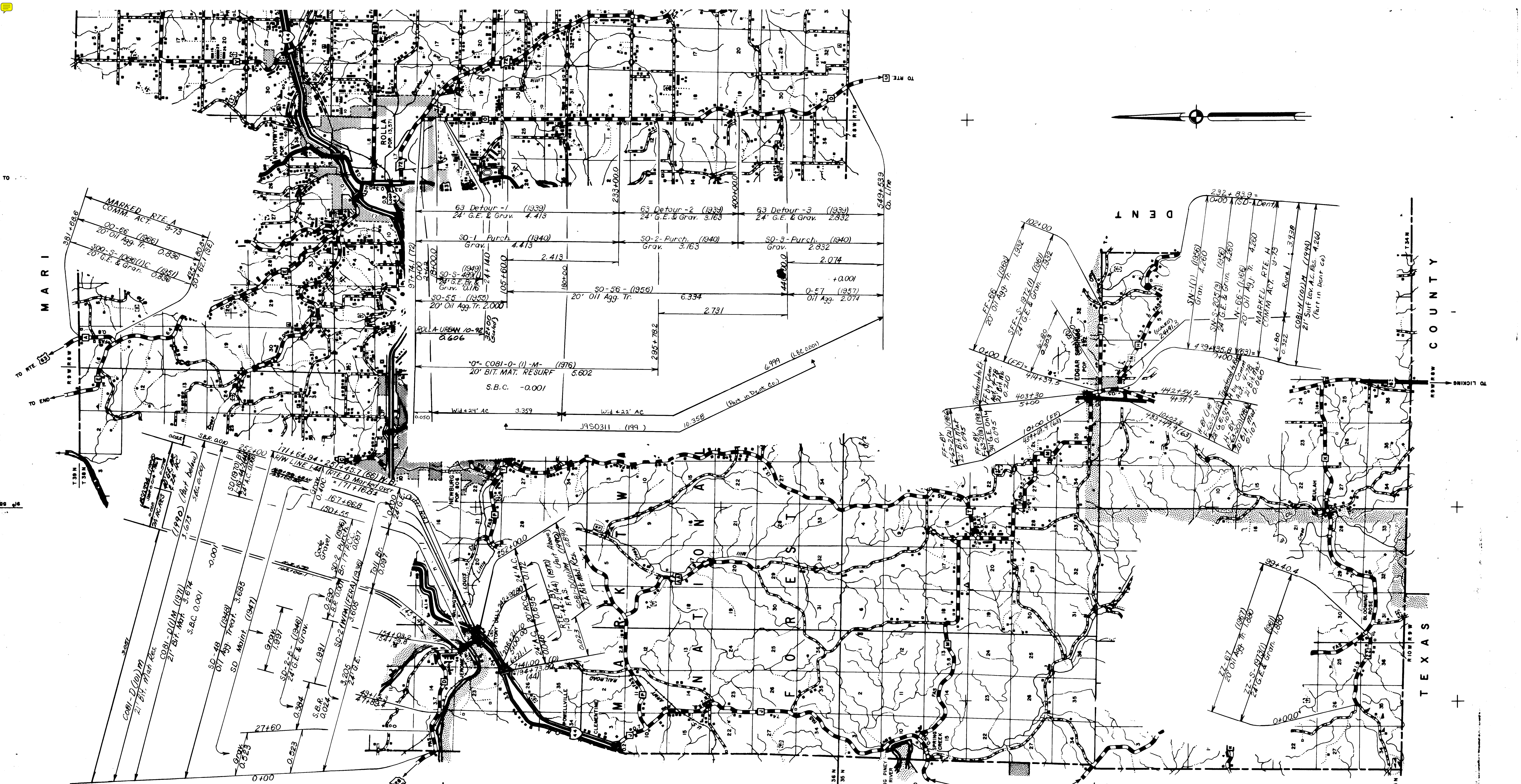

⑨ 180 PHELPS COUNTY
 ROUTES
 O,H,ZZ,A,D,FF
 SHEET 11 OF 14

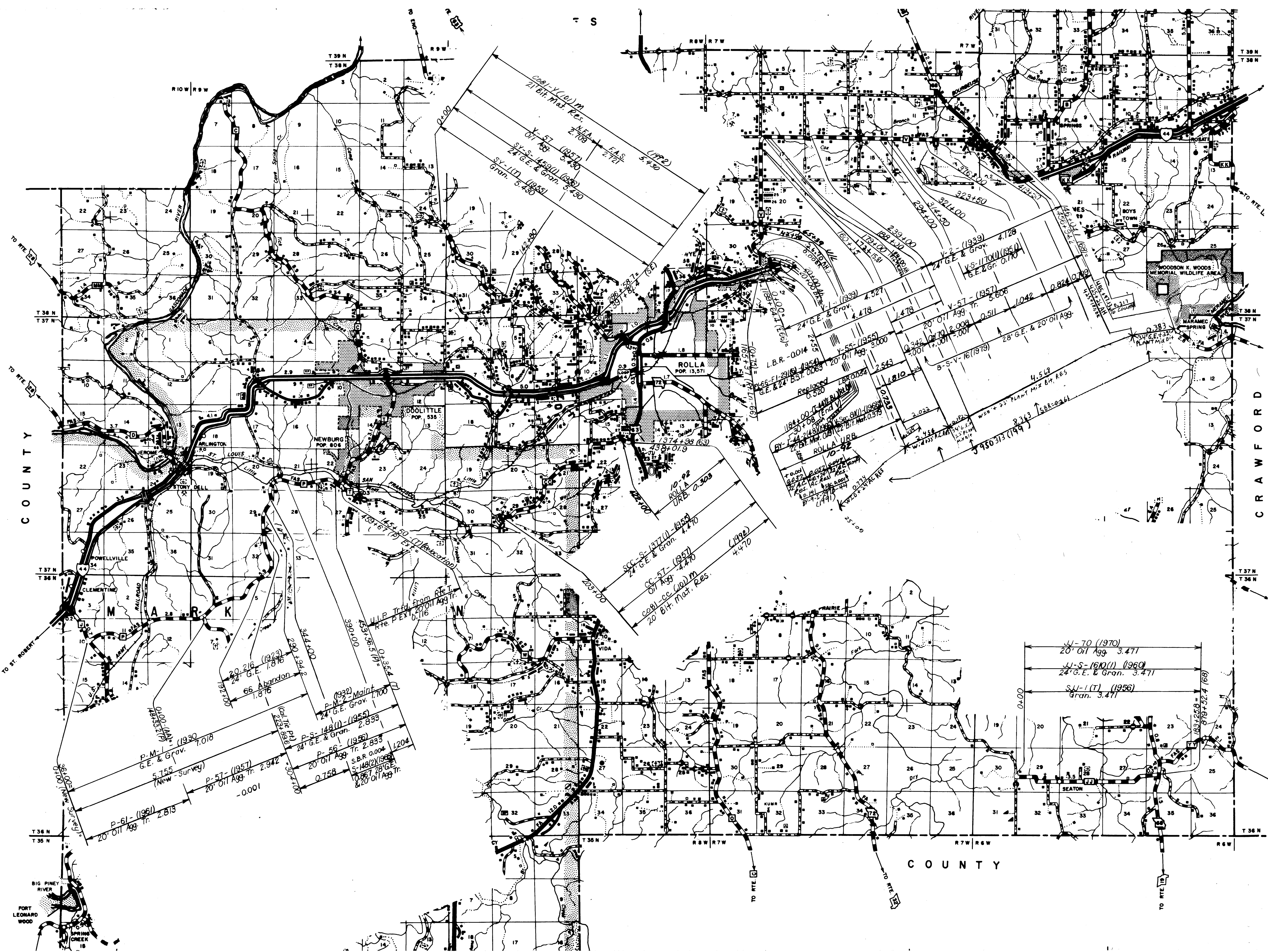

⑨ PHELPS 081
 COUNTY
 ROUTES
 P, JJ, CC, Y, V
 SHEET 12 OF 14

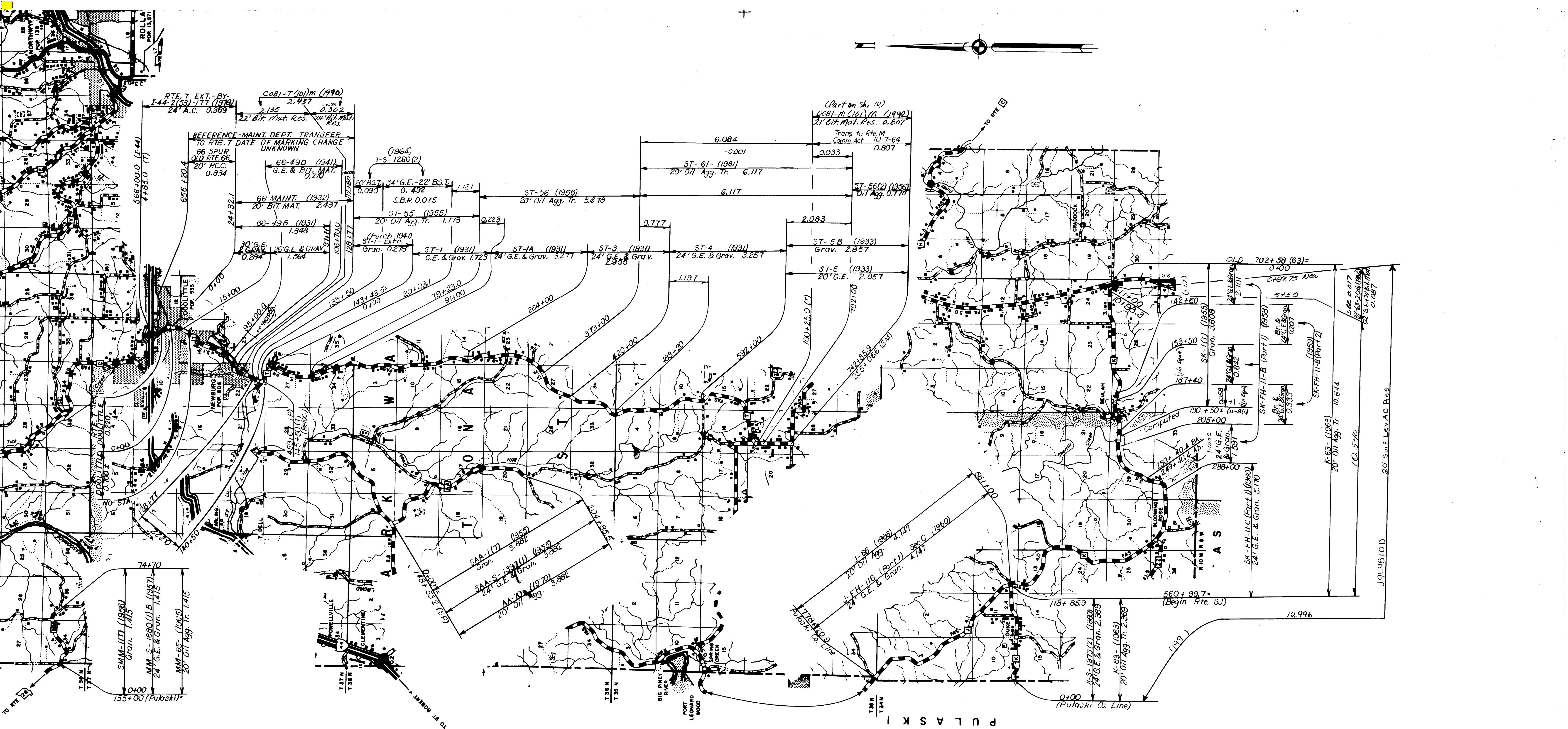

⑨ 081 PHELPS COUNTY
 ROUTES
 T, J(Part),
 AA, K, MM, M (Part)
 SHEET 13 OF 14

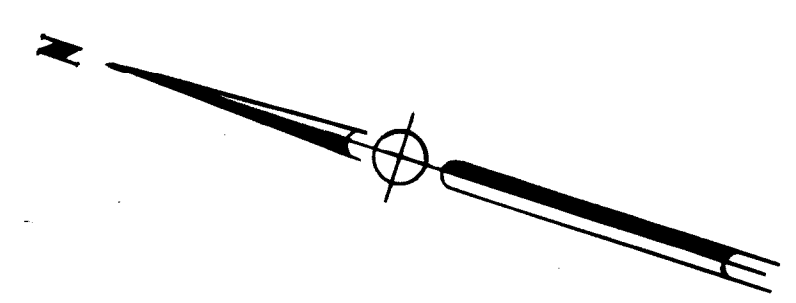
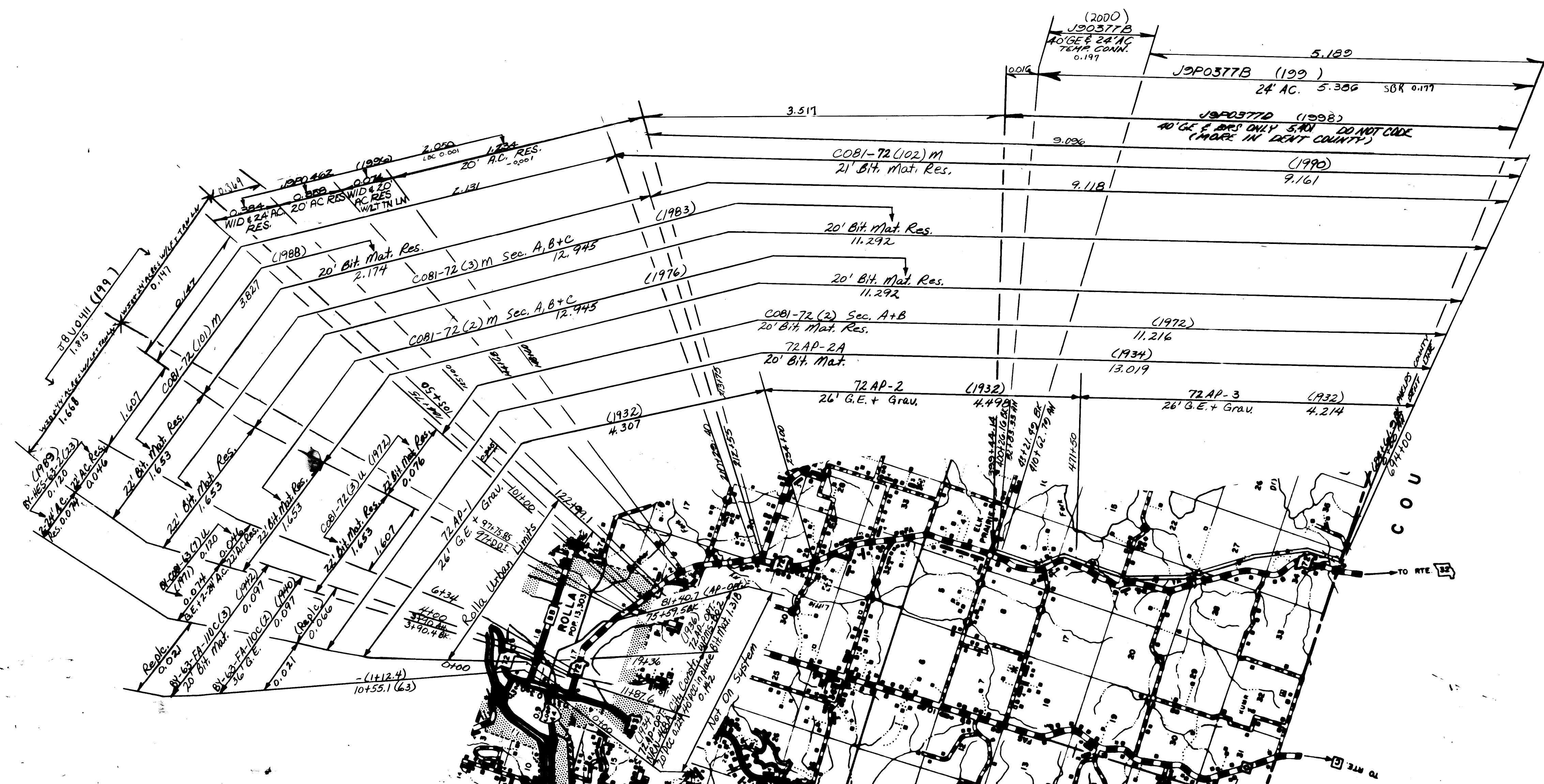

PHELPS COUNTY

ROUTES 72

081

SHEET 14 OF 14