

# REYNOLDS O90 ©

ROUTES  
21-W

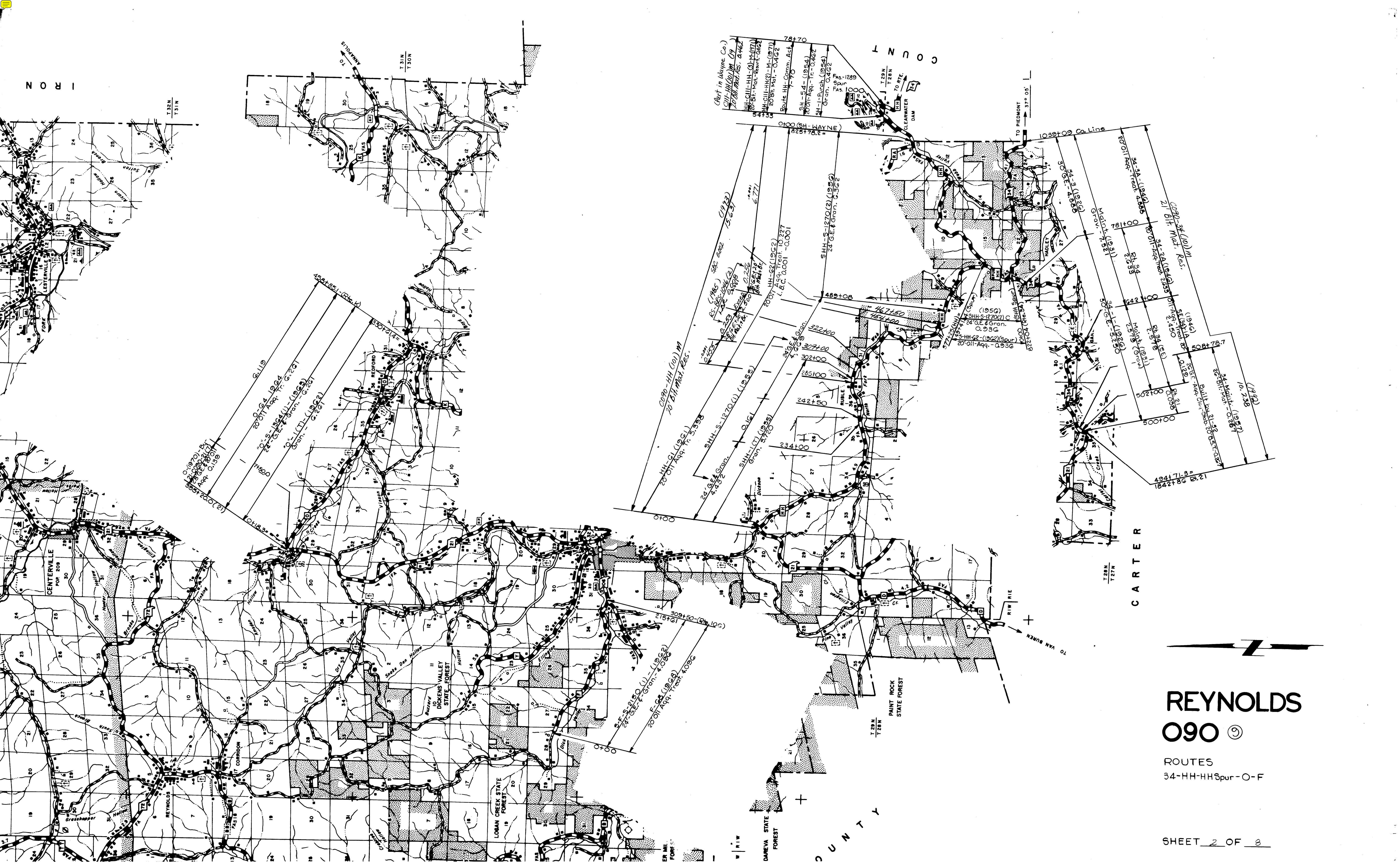

**REYNOLDS**  
**O90** ⑨

ROUTES  
34-HH-HH Spur-O-F

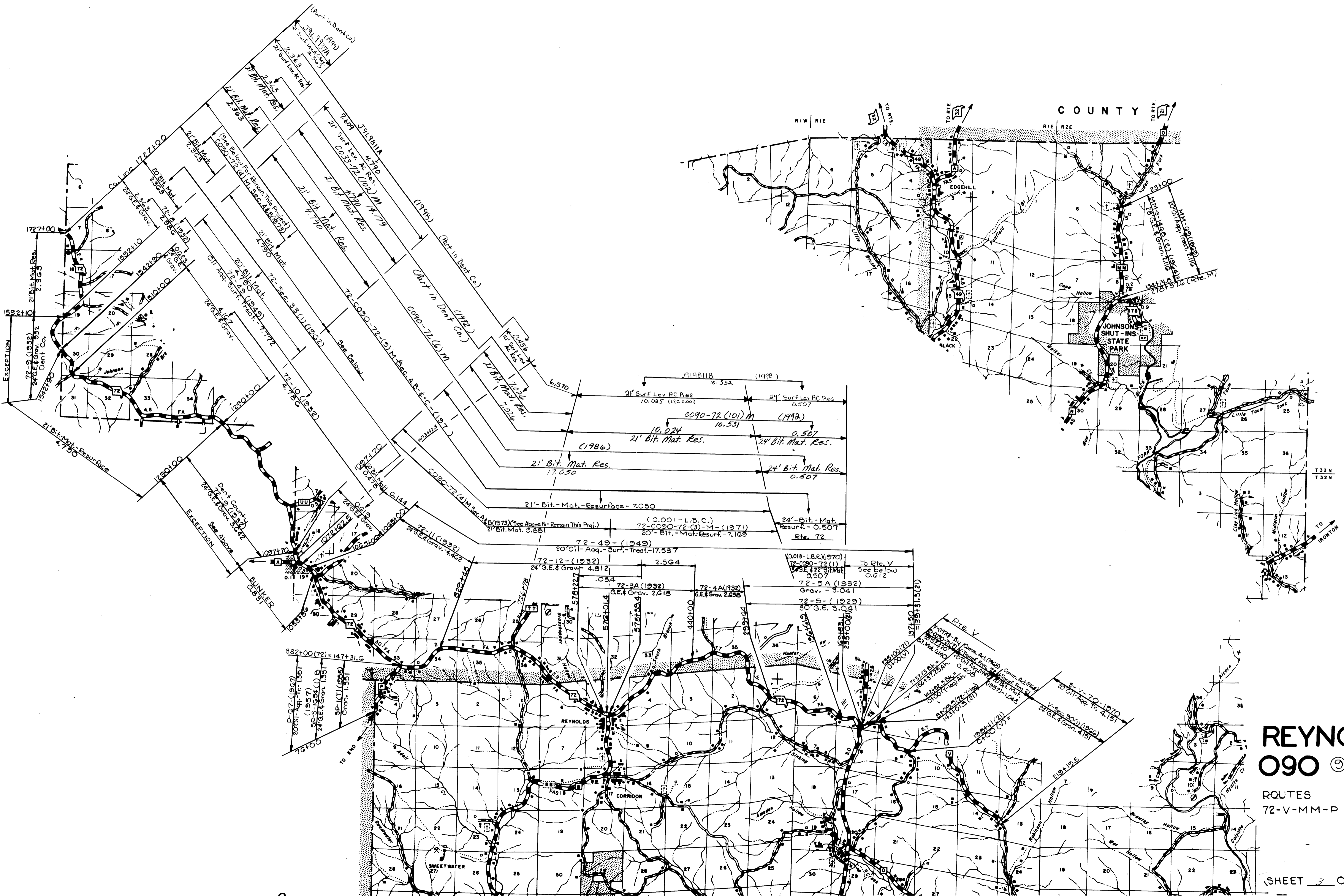

**REYNOLDS**  
**090** ⑨  
 ROUTES  
 72-V-MM-P

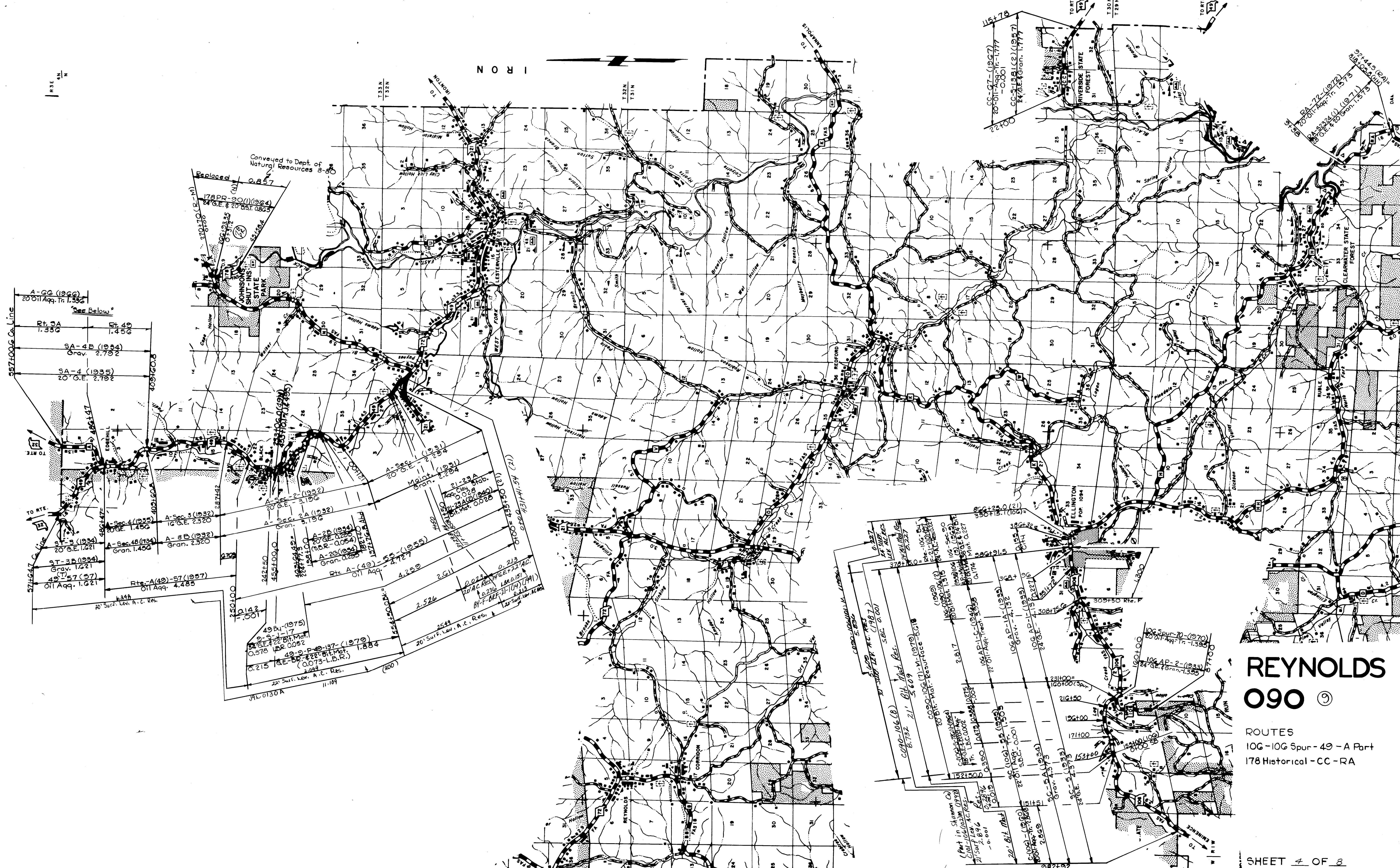

# REYNOLDS 090 ⑨

ROUTES  
10G-10G Spur-49 - A Part  
178 Historical - CC - RA

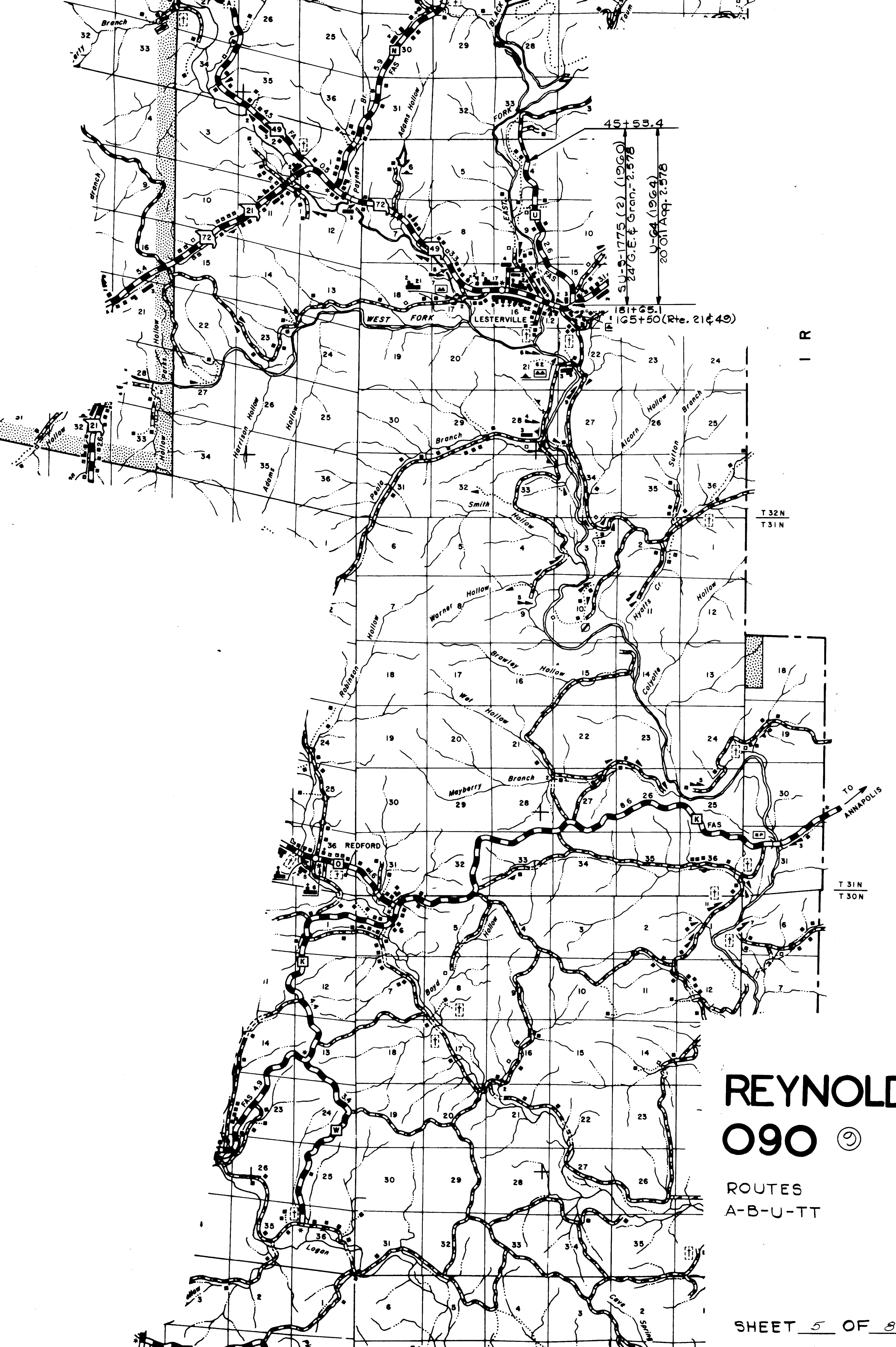
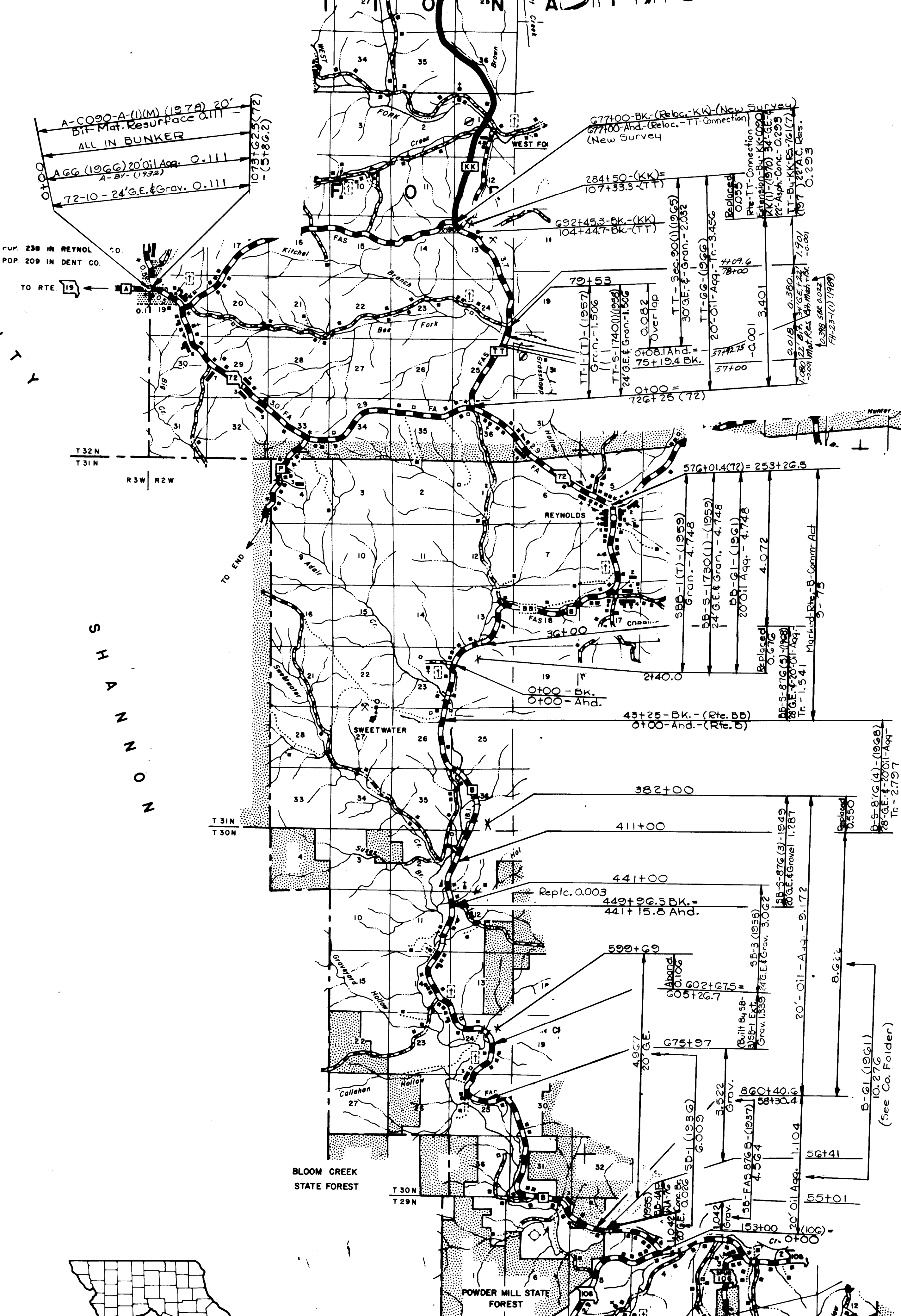
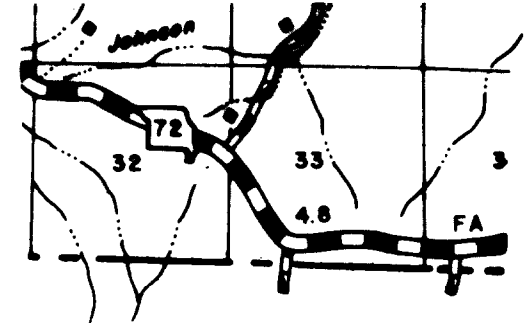

POP. 238 IN REYNOL. CO.  
POP. 209 IN DENT. CO.

DENT  
COUNTY

SHANNON

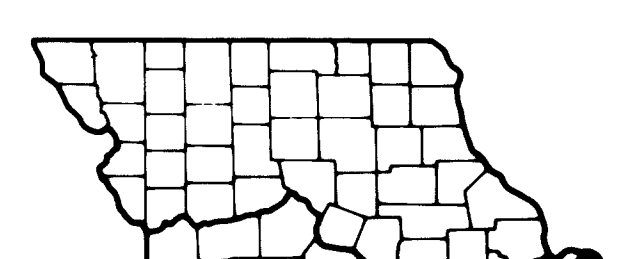
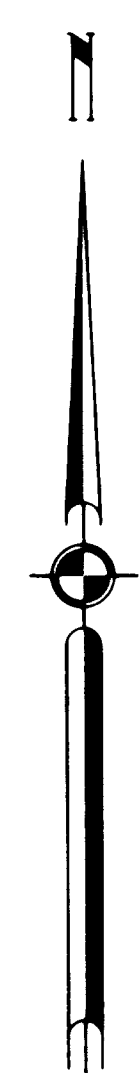

# REYNOLDS

## O90

ROUTES  
A-B-U-TT

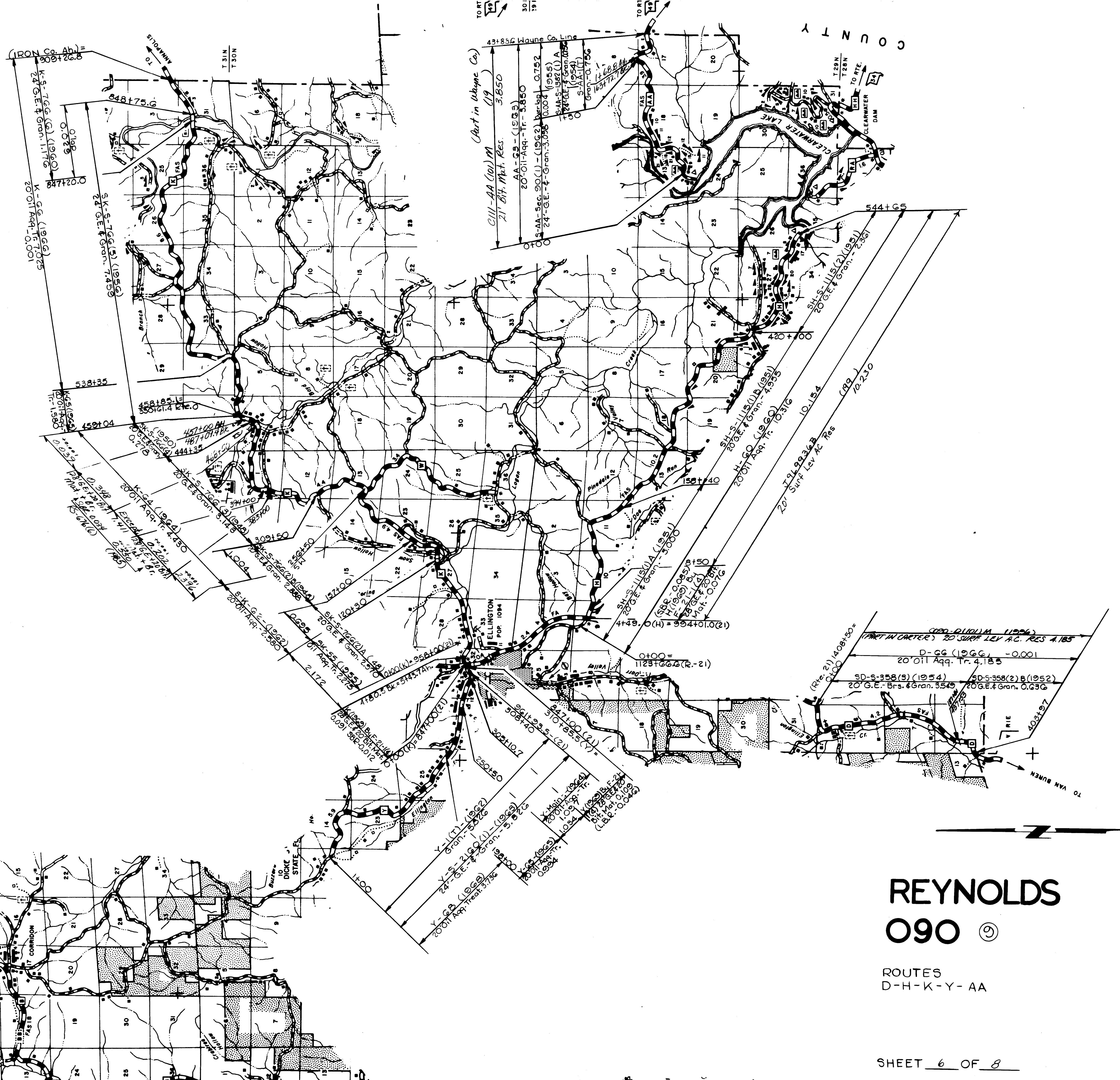
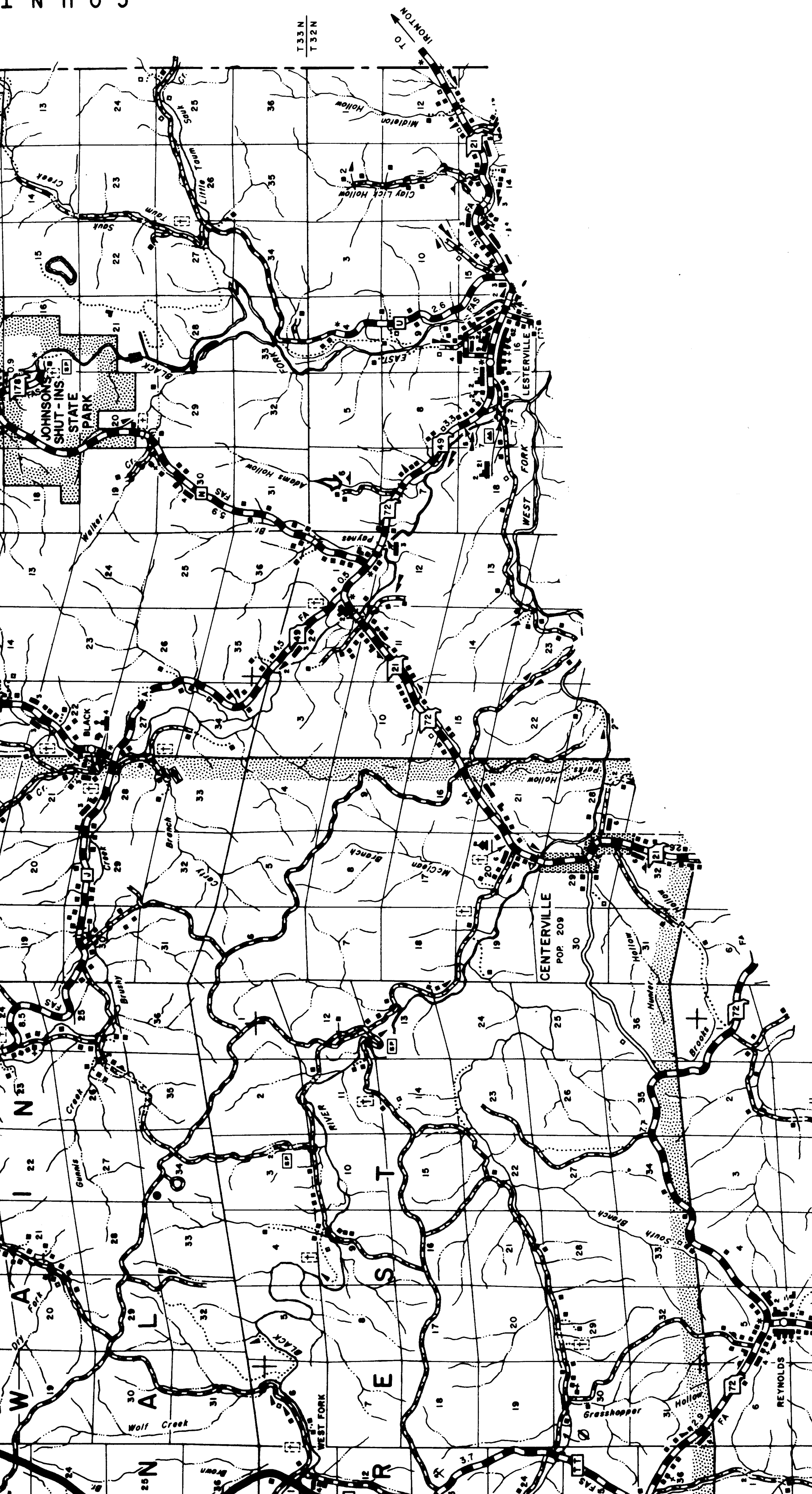

**REYNOLDS**  
**090** ⑨

ROUTES  
D-H-K-Y-AA

Note -  
 In Agreement With Supple. Roads Rte. Marking &  
 Transfer If Any On To Be Made When Project  
 Is Accepted (O-10-G7-Supl. B. By R.J.W.)

Changed to AC  
 Comm. Act. 11-67

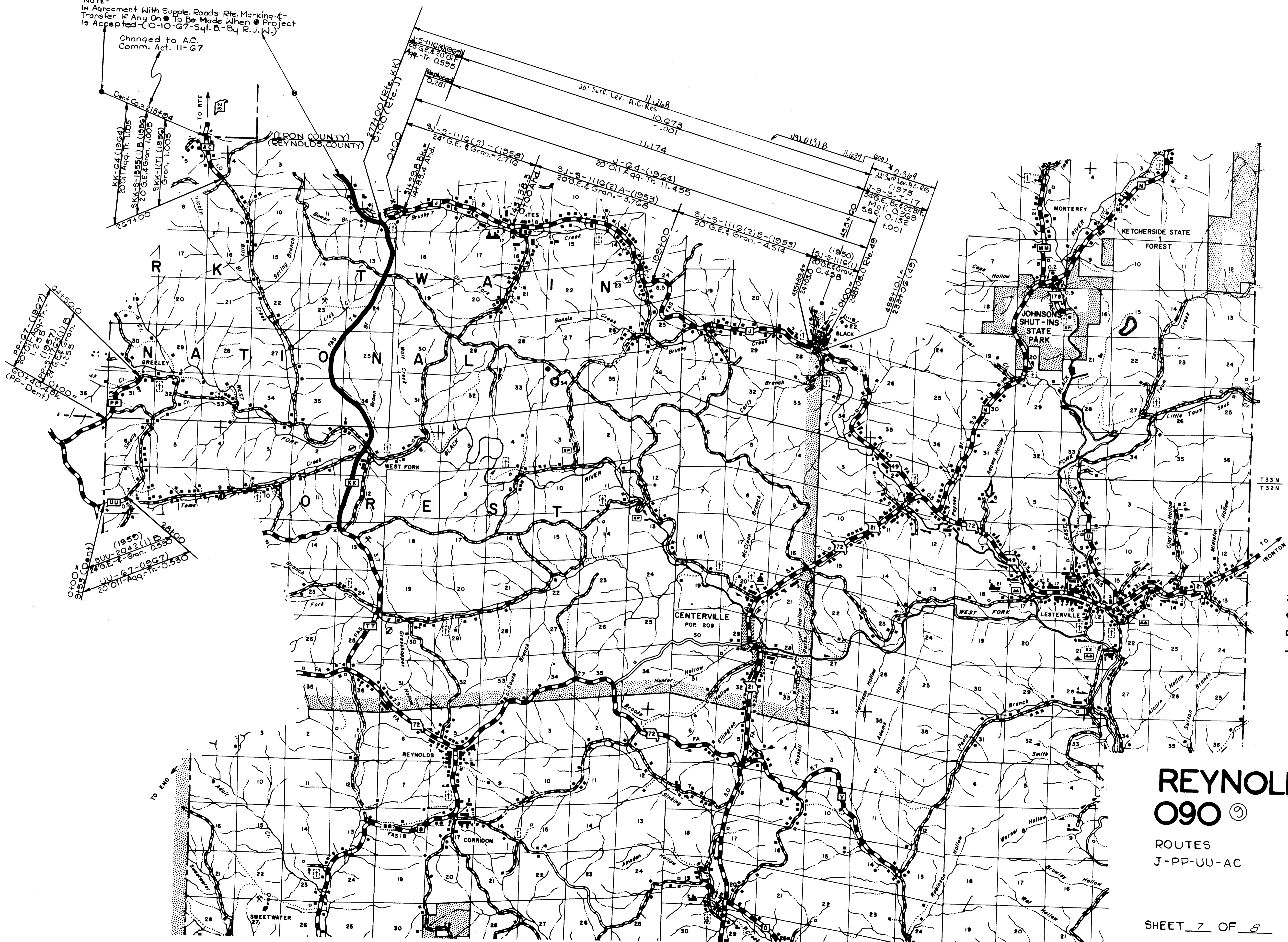

# REYNOLDS O90

ROUTES  
 J-PP-UU-AC

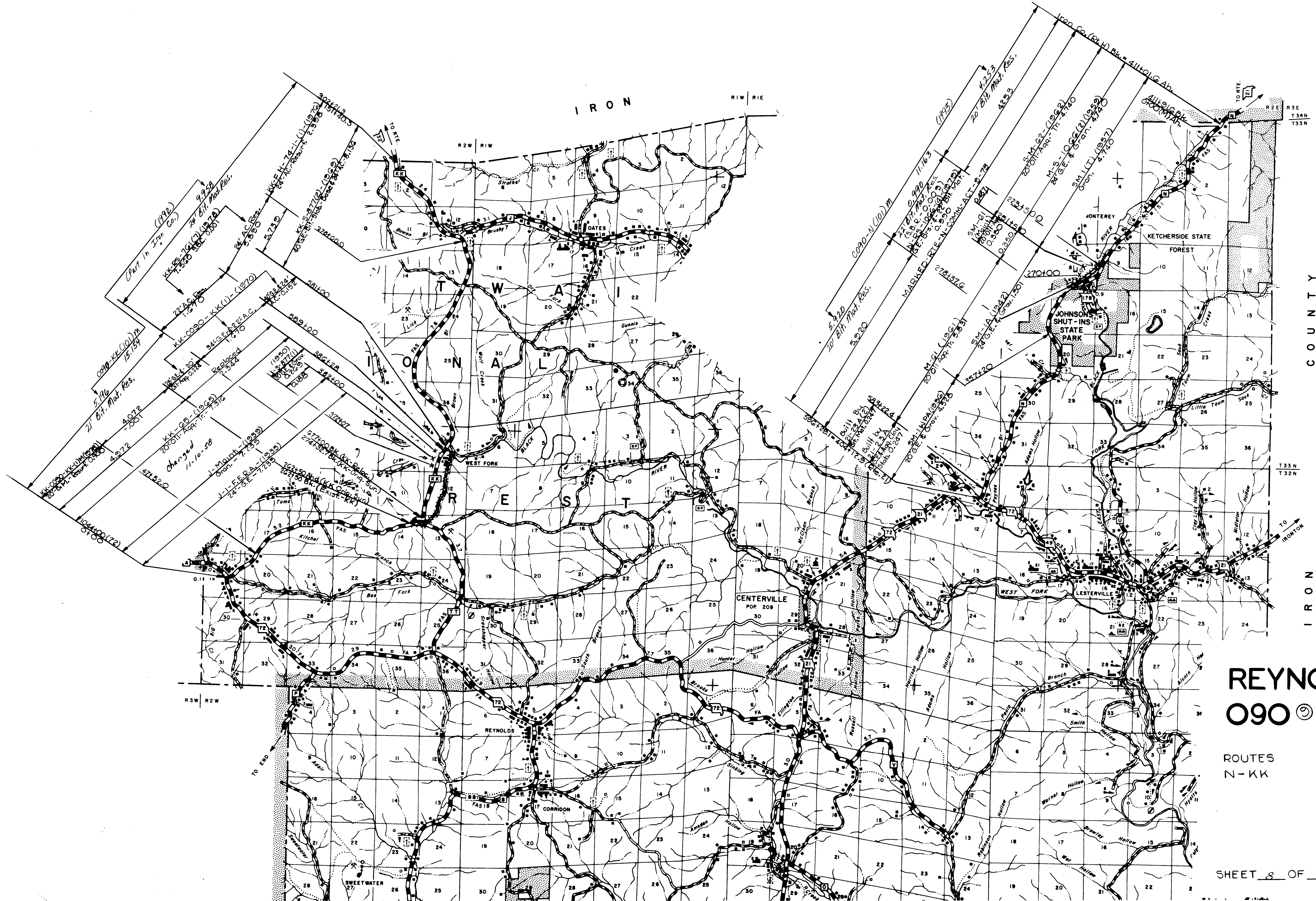

**REYNOLDS  
090**

ROUTES  
N-KK

Reynolds  
N-  
KK