

TEXAS  
107 ©

ROUTES  
17 (Part)  
137 (Part)

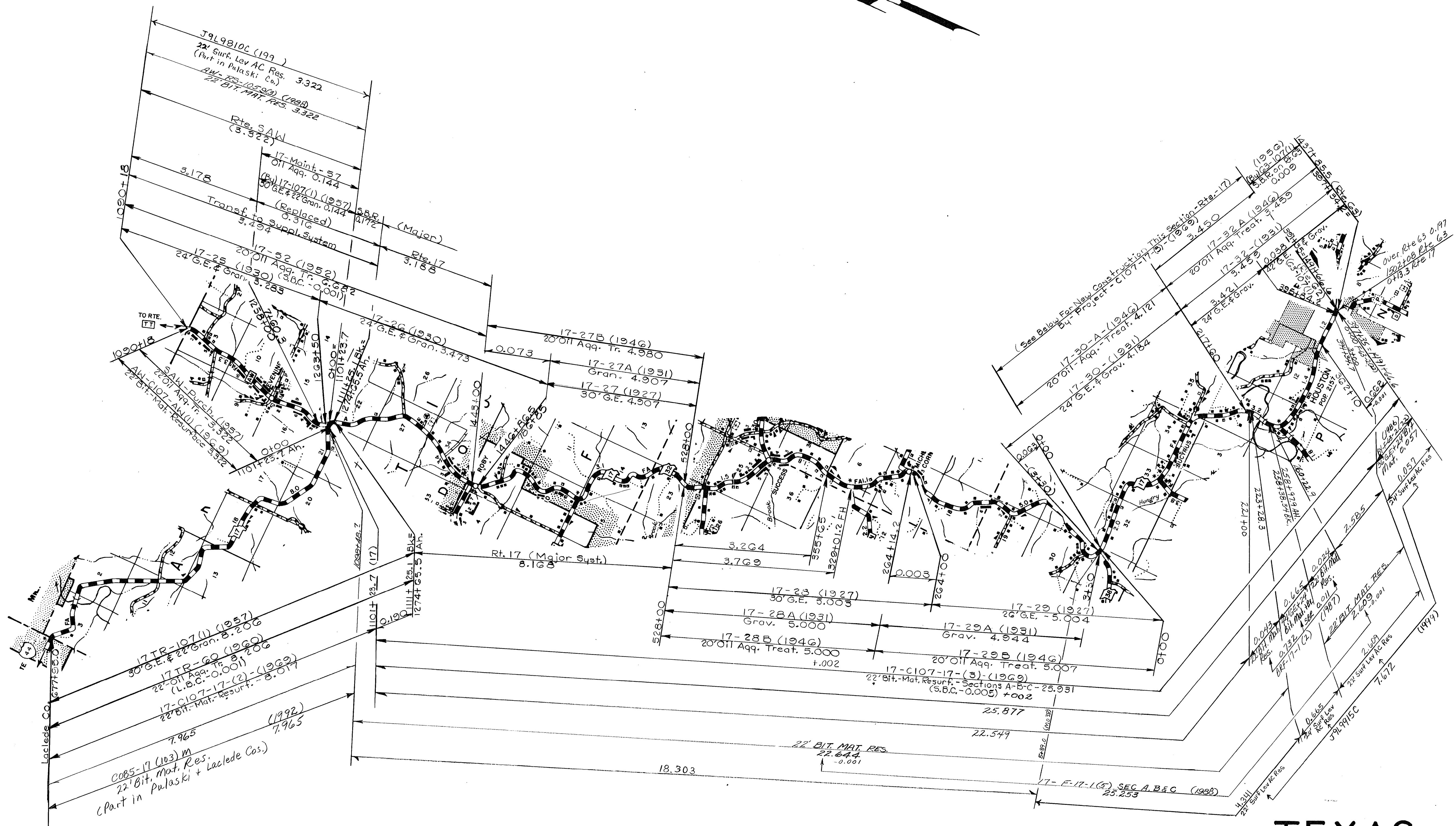

# TEXAS 107

ROUTES  
17 (Part) - AW

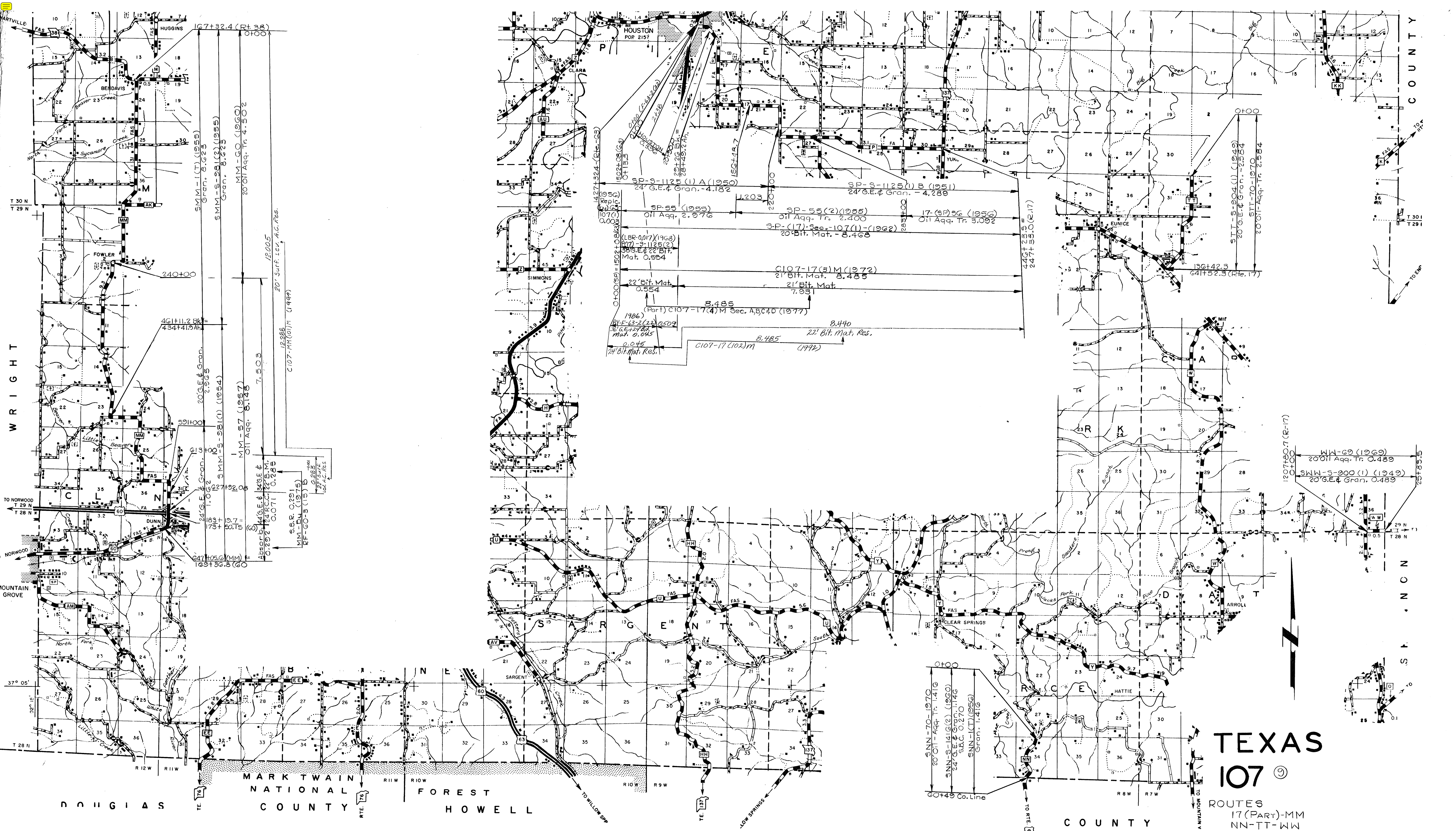

TEXAS  
107

ROUTES  
9, 17 (PART)-MM  
NN-TT-WW

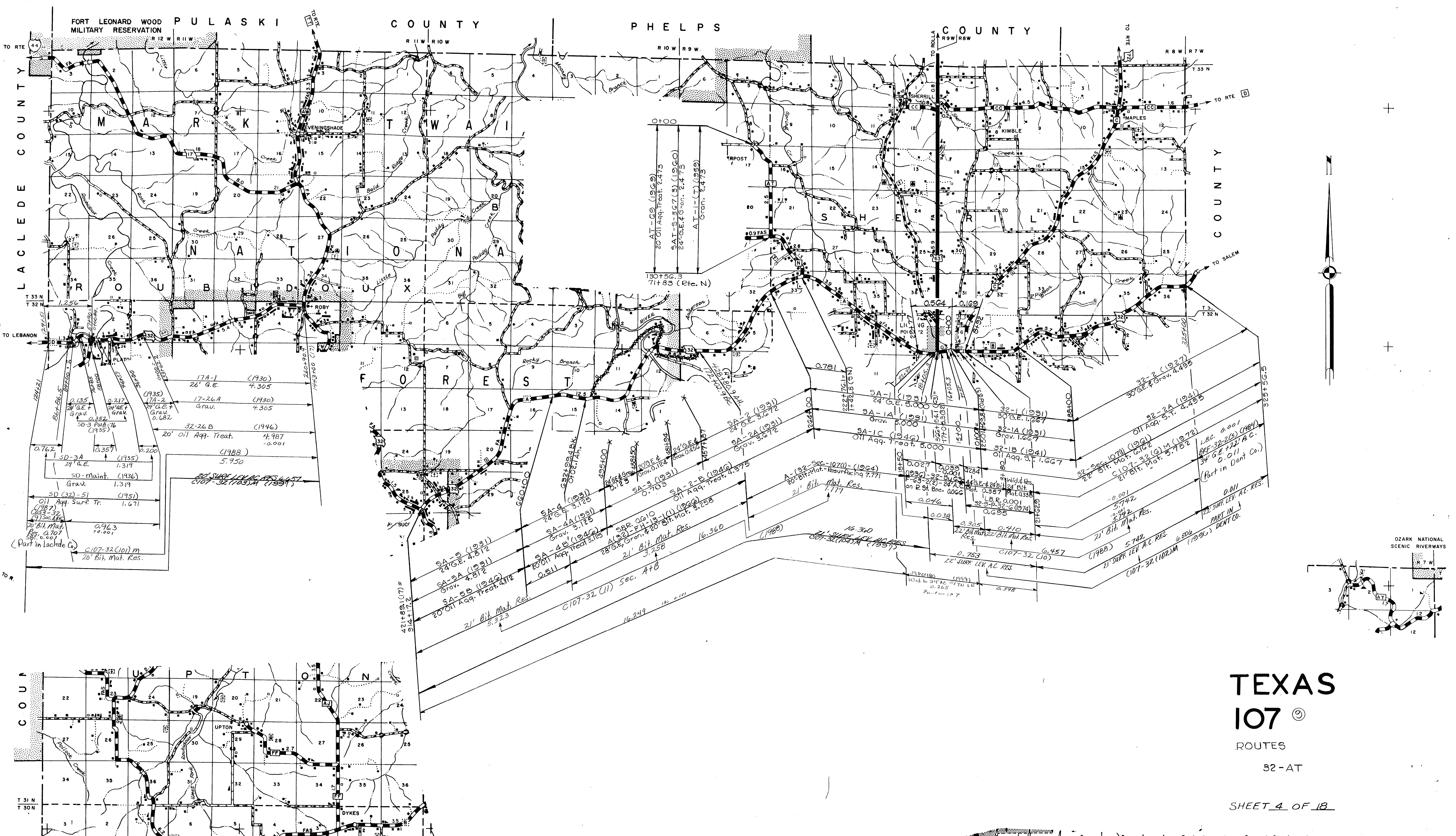

**TEXAS**  
**107** ©  
 ROUTES  
 32-AT  
 SHEET 4 OF 18

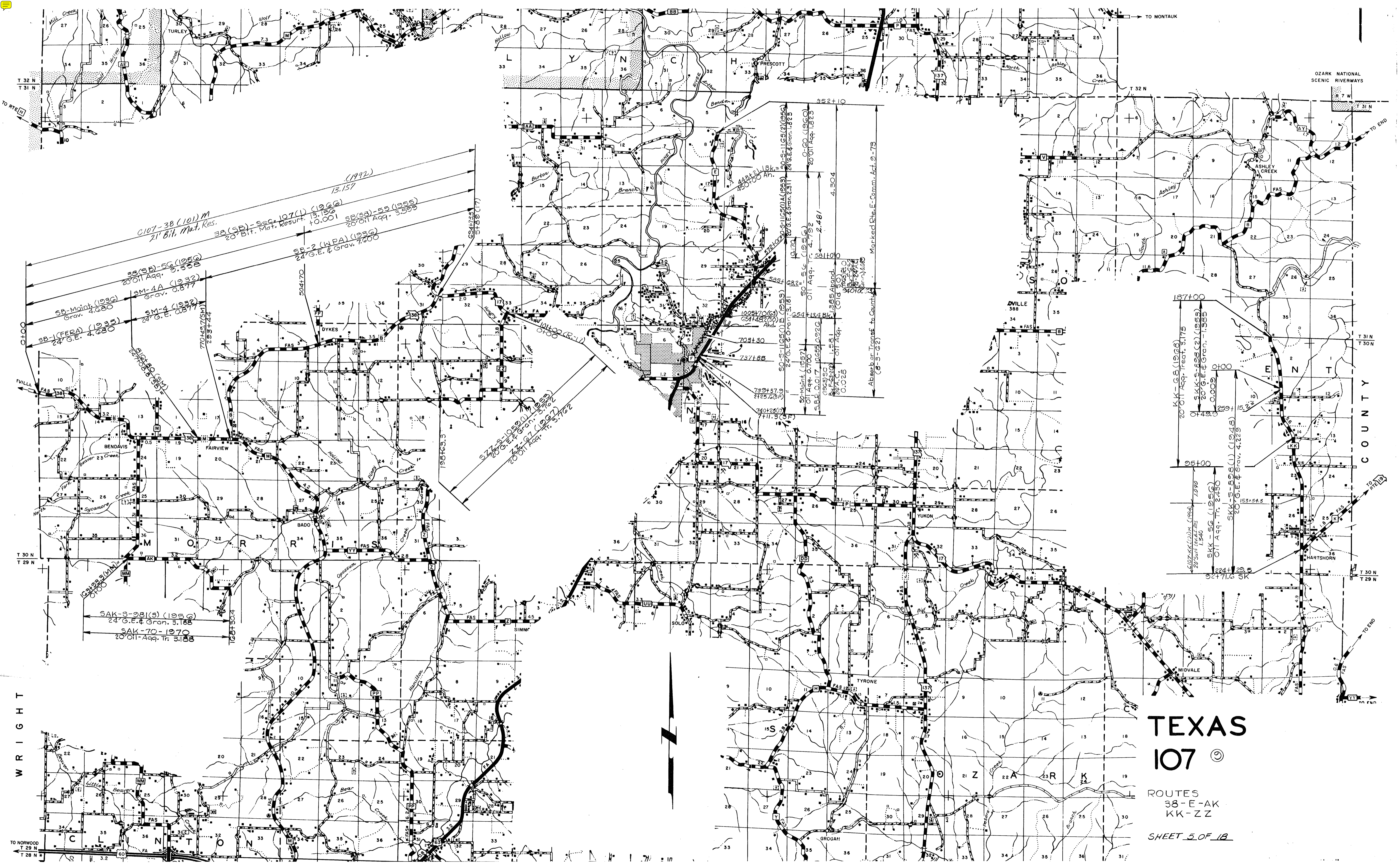

C107-38 (101) M  
 21' Bt. Mat. Res. (1992)  
 13.157

33 (SB) - 5G (1956)  
 20' Oil Acq. Tr. 3.358  
 3M-4A (1932)  
 Grav. 0.877  
 3M-4 (1932)  
 24' G.E. 0.877  
 SB-1 (FERA) (1935)  
 24' G.E. 4.680  
 58-Maint. (1936)  
 Grav. 4.680

38 (SB) - Sec. 107 (1) (1966)  
 20' Bt. Mat. Res. 13.156  
 +0.001  
 58 (SB) - 55 (1955)  
 20' Oil Acq. Tr. 3.599

5244.70  
 20' Oil Acq. Tr. 3.107

SZZ-9-10929 (1) (1993)  
 20' G.E. & Crn. 3.107  
 SZZ-11-107 (1) (1997)  
 20' Oil Acq. Tr. 3.162

352+10  
 352+10  
 4.304  
 2.461  
 58+100  
 799+57.9  
 2125.2(5P)  
 740+25.17  
 711.5(5P)  
 SO Maint. (1957)  
 Oil Acq. Tr. 4.792  
 SO 5G (1955)  
 Oil Acq. Tr. 3.181  
 SO S-11 (S-1) (1953)  
 SO S-11 (S-1) (1953)  
 24' G.E. & Crn. 2.311  
 SO S-11 (S-1) (1953)  
 24' G.E. & Crn. 2.311  
 SO S-11 (S-1) (1953)  
 24' G.E. & Crn. 2.311  
 SO S-11 (S-1) (1953)  
 24' G.E. & Crn. 2.311  
 SO S-11 (S-1) (1953)  
 24' G.E. & Crn. 2.311  
 SO S-11 (S-1) (1953)  
 24' G.E. & Crn. 2.311  
 SO S-11 (S-1) (1953)  
 24' G.E. & Crn. 2.311

Marked Elev. Comm. Act. 9-75  
 Absorbent Transp. to County  
 (8-9-62)

SAK-9-98 (5) (1956)  
 24' G.E. & Crn. 3.188  
 SAK-70-1970  
 20' Oil Acq. Tr. 3.188

187+00  
 KK-GS (1926)  
 20' Oil Acq. Tr. 3.175  
 SKK-5-998 (2) (1959)  
 20' G.E. & Crn. 1.595  
 01 49.9  
 0.000  
 95+00  
 1290  
 107+00  
 1290  
 SKK-5G (1955)  
 Oil Acq. Tr. 2.400  
 224+29.5  
 SKK-S-996 (1) (1948)  
 20' G.E. & Crn. 4.229

**TEXAS**  
**107**  
 ROUTES  
 38-E-AK  
 KK-ZZ  
 SHEET 5 OF 18

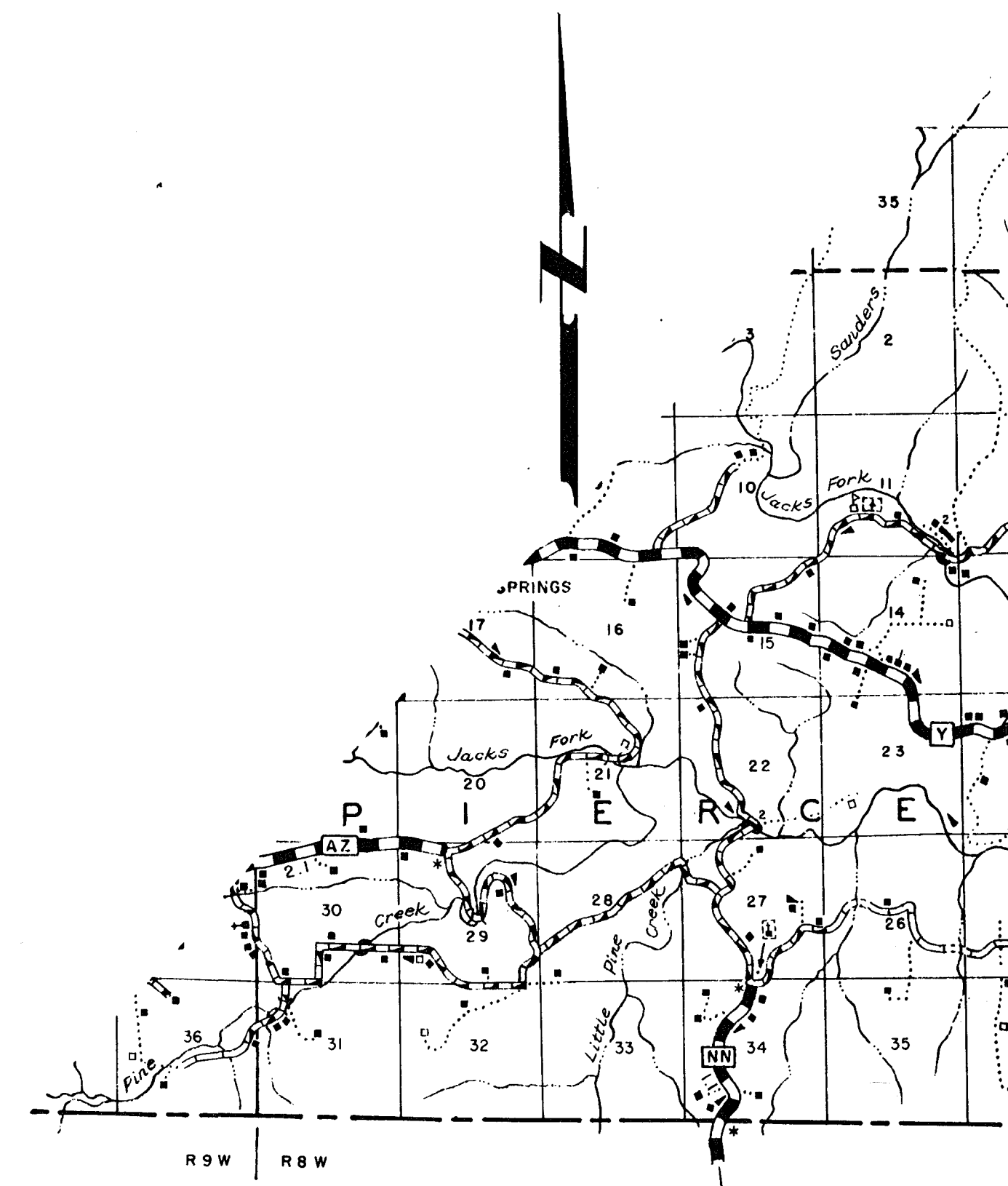
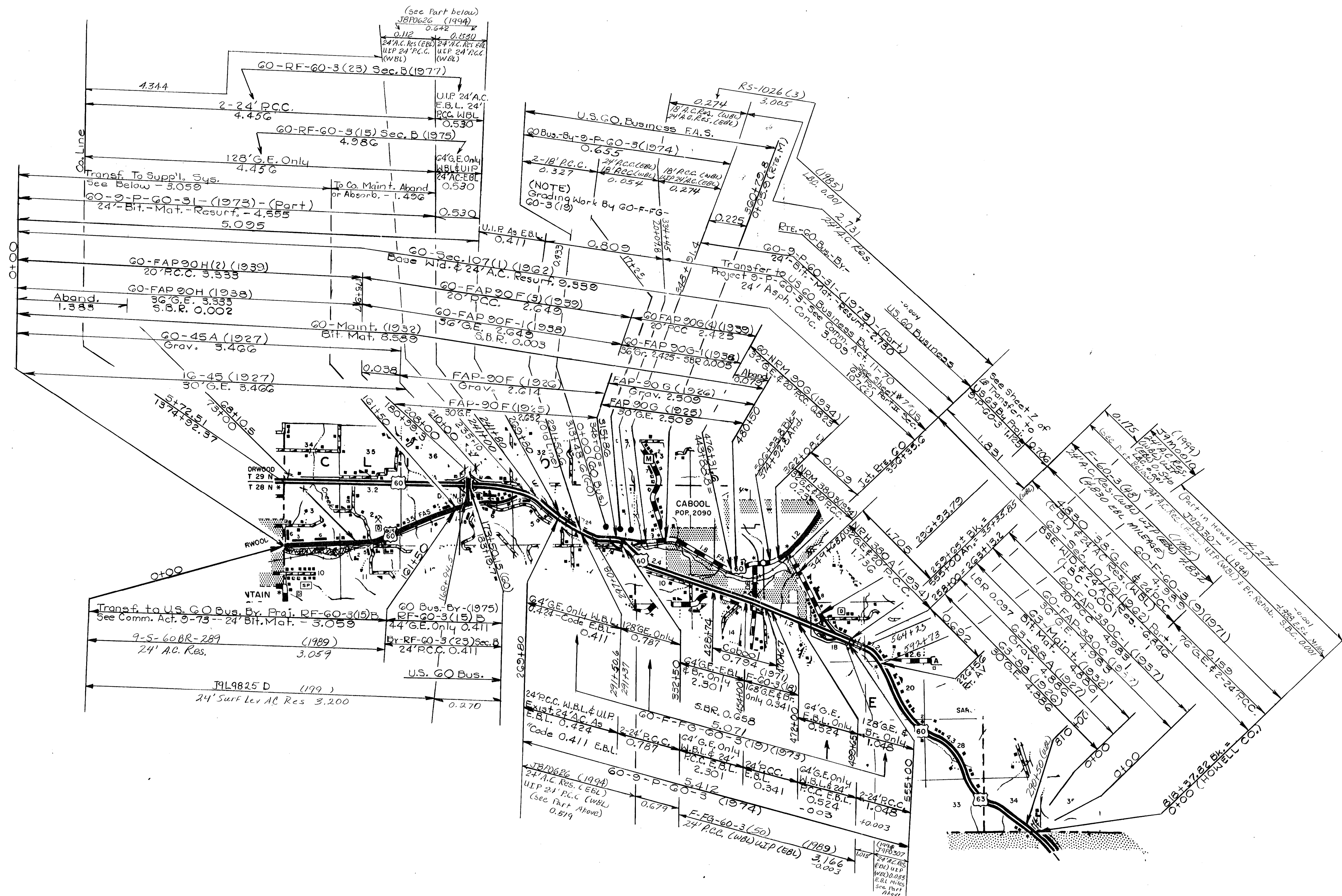

# TEXAS 107

ROUTES  
GO-GO Bus.

PHELPS

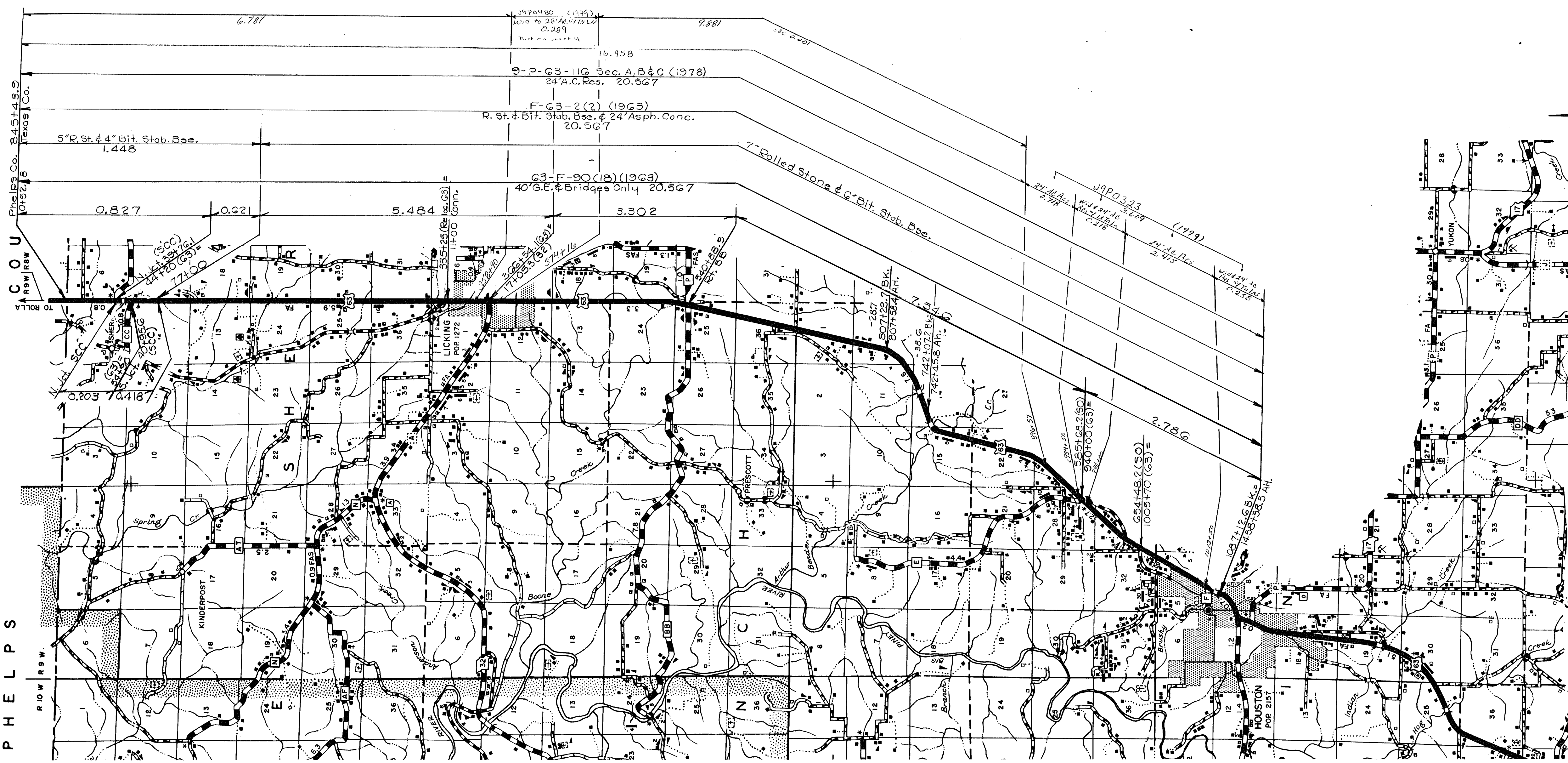

COU  
PHELPS Co. 345+43.9  
TEXAS Co. 0+52.18

5" R. St. & 4" Bit. Stab. Base.  
1.448

9-P-G3-11G Sec. A, B & C (1978)  
24' A.C. Res. 20.567

F-G3-2(2) (1965)  
R. St. & Bit. Stab. Base & 24' Asph. Conc.  
20.567

G3-F-90(18) (1963)  
40' G.E. & Bridges Only 20.567

7" Rolled Stone & 6" Bit. Stab. Base.

654+48.2(SO)  
1005+70(G3)=

HOUSTON  
POP 2157

# TEXAS 107

ROUTES  
G3(Part)-K

SHEET 7 OF 18

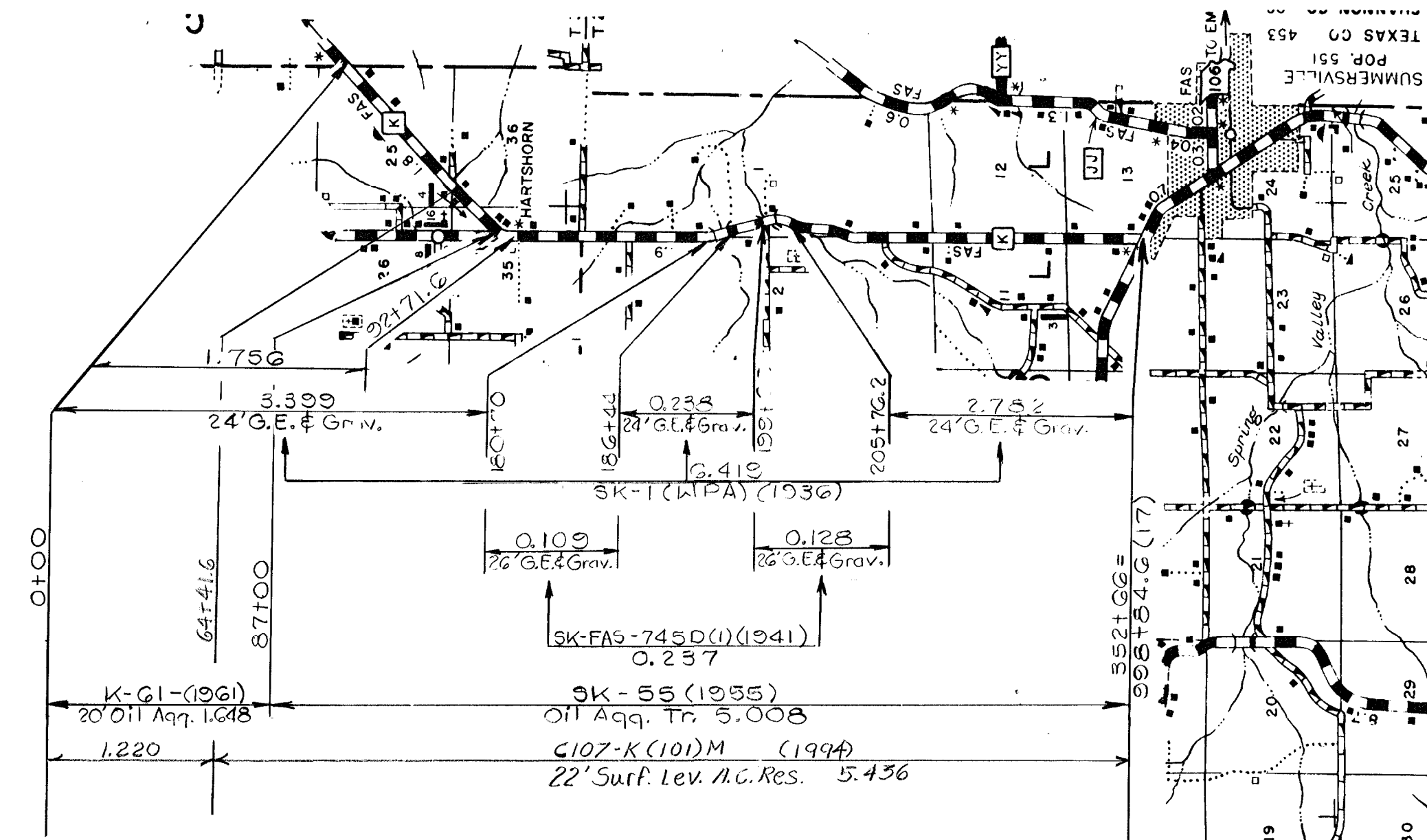

0+100

1.756

3.399  
24' G.E. & Grv.

64+41.6  
87+00

0.109  
7/8" G.E. & Grv.

0.128  
7/8" G.E. & Grv.

0.257

SK-FAS-7450(1) (1941)

SK-55 (1935)  
Oil Aq. Tr. 5.008

G107-K(10)M (1994)  
22' Surf. Lev. A.C. Res. 5.456

552+00  
552+04.6 (17)

23R

21Z

20

20

20

TEXAS CO 453  
SUMMERSVILLE  
POP. 51





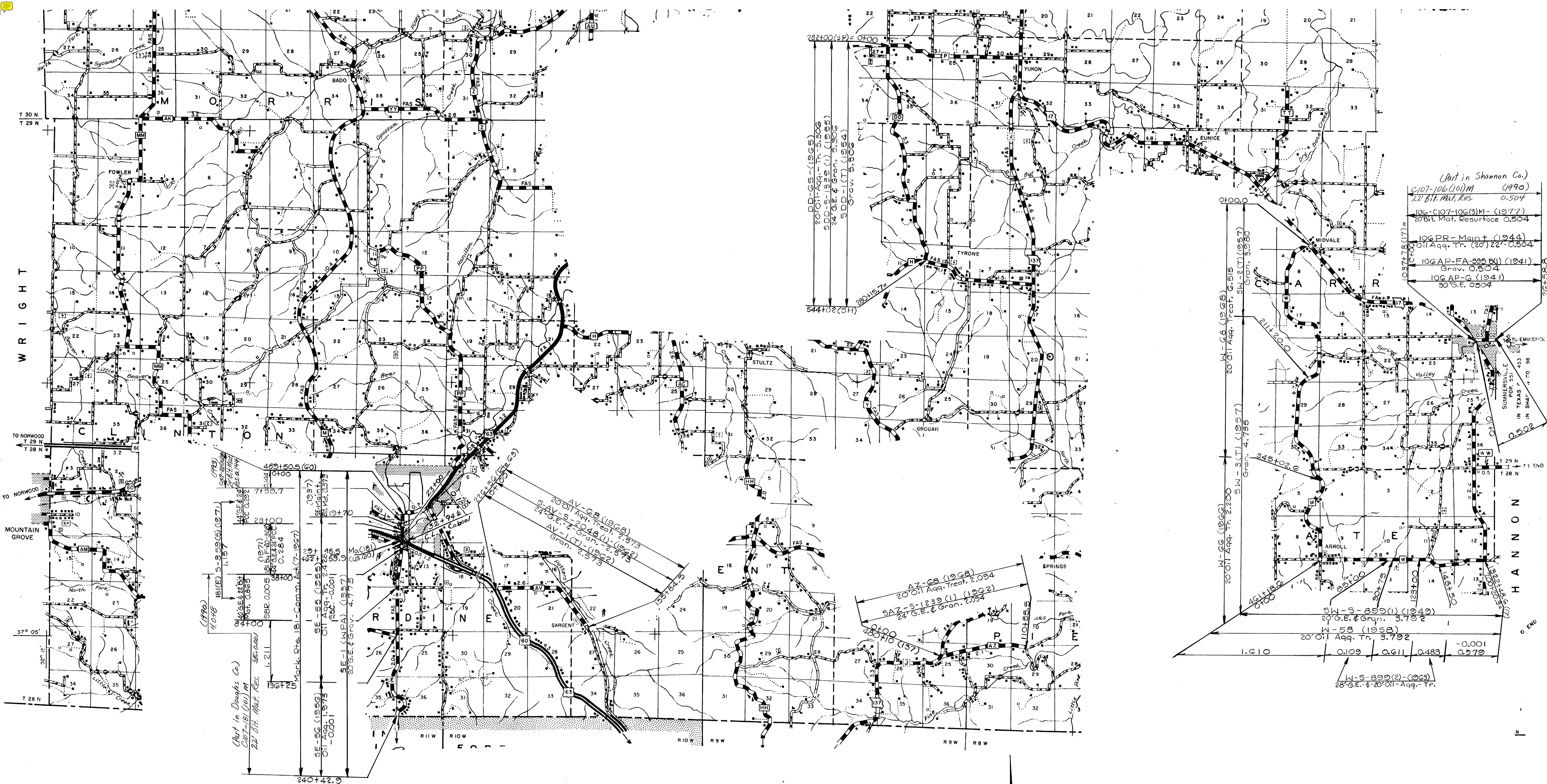

(Part in Shannon Co.)  
 C107-106(101)M (1990)  
 227 Bl. Mat. Res. 0.504  
 106-C107-106(3)M - (1977)  
 20 Bl. Mat. Resurface 0.504  
 106PR - Main + (1944)  
 Oil Aq. Tr. (20) 22'-0.504  
 106AP-FA-395 (1) (1941)  
 Grav. 0.504  
 106AP-C (1941)  
 30' G.E. 0.504

# TEXAS 107

ROUTES  
106-181(E)  
W-AZ-AV-DD

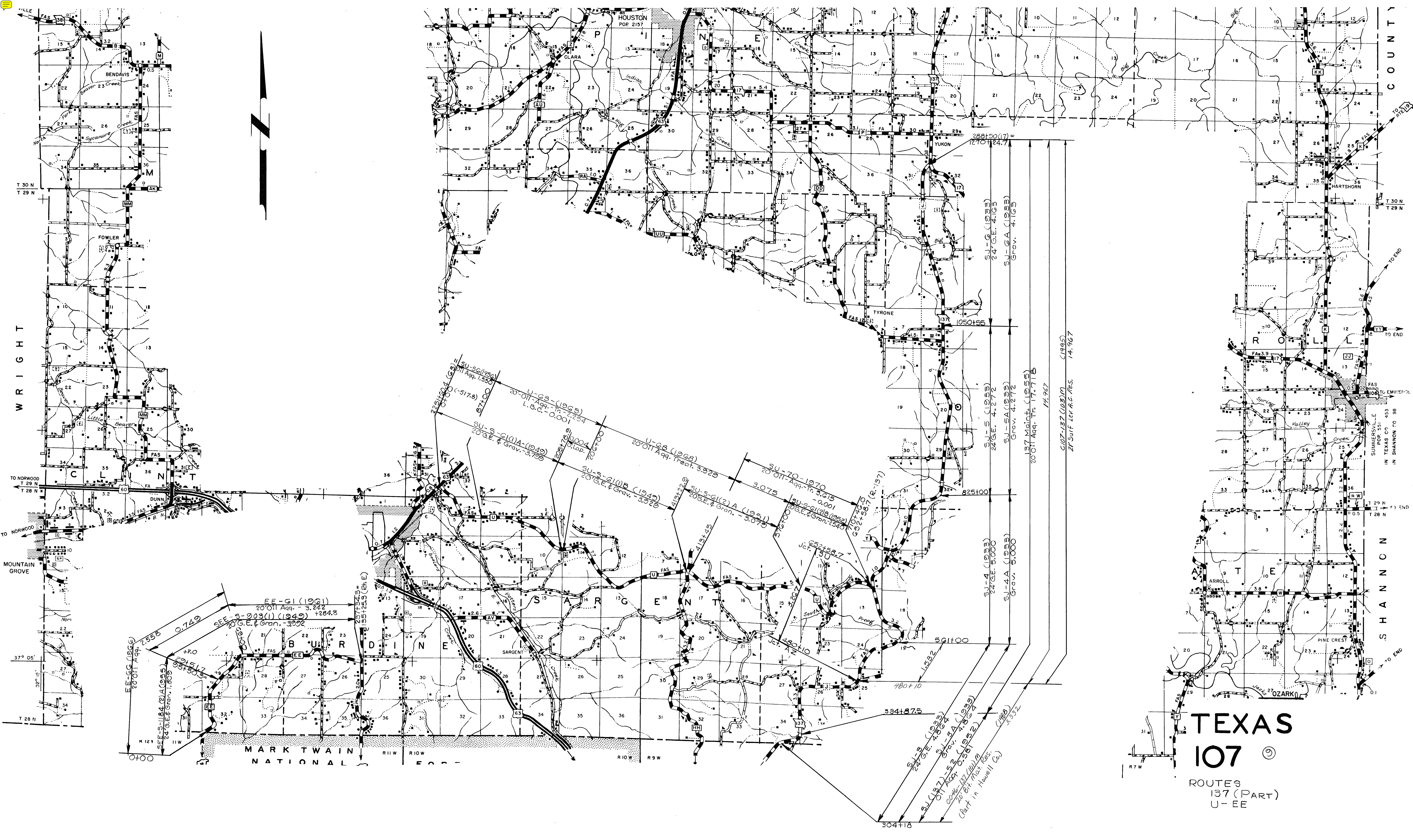

**TEXAS**  
**107** ©  
ROUTES  
137 (PART)  
U-EE

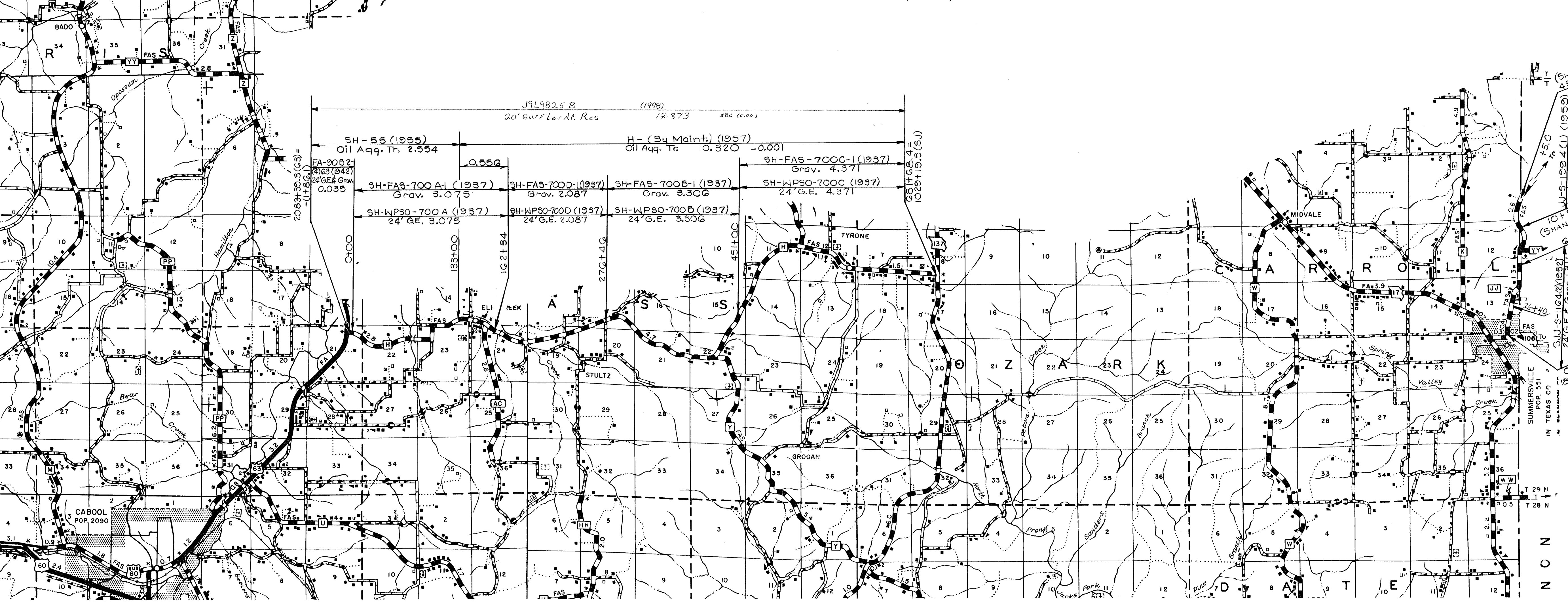
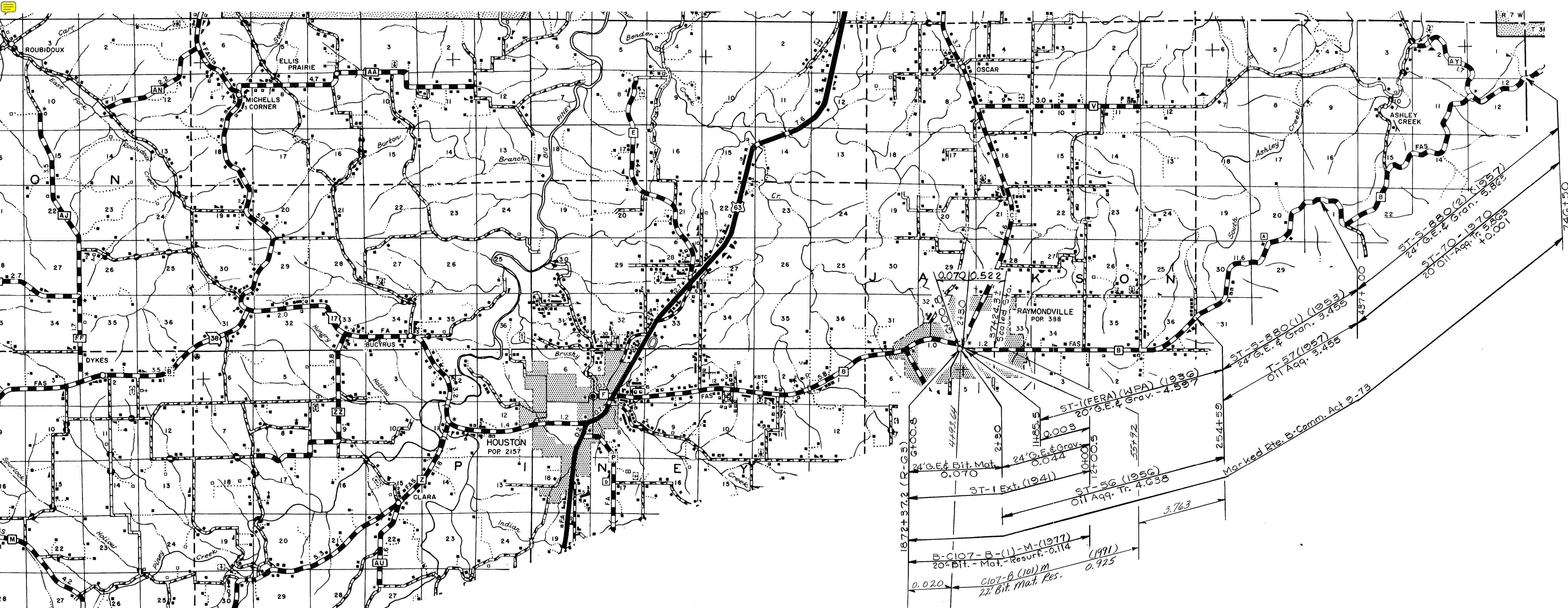

ST-2-380(1) (1953)  
 24' G.E. & Grav. 3.455  
 T-57(1957)  
 Oil Aqq. 3.455  
 ST-5-280(2) (1957)  
 24' G.E. & Grav. 3.455  
 ST-70-1970  
 20' Oil Aqq. Tr. 3.865  
 40.001  
 74G+50  
 ST-1 (FERA) (WPA) (1936)  
 20' G.E. & Grav. 4.587  
 ST-56 (1956)  
 Oil Aqq. Tr. 4.638  
 ST-1 Ext. (1941)  
 24' G.E. Bit. Mat. 0.070  
 24' G.E. & Grav. 0.044  
 1185.5  
 0.003  
 0.0005  
 55+92  
 25.4+50  
 3.763  
 Marked Rte. B. Comm. Act 9-73  
 B-C107-B-(1)-M-(1977)  
 20' Bit. - Mat. - Resurf. 0.114  
 0.020  
 C107-B (101) M  
 22' Bit. Mat. Res. 0.925 (1991)

J719825 B (1998)  
 20' Surf Lev. Al. Res 12.873 584 (0.000)

SH-55 (1955) Oil Aqq. Tr. 2.554	SH-FAS-700C-1 (1937) Grav. 4.371
H-(By Maint.) (1957) Oil Aqq. Tr. 10.320 -0.001	SH-FAS-700C (1937) 24' G.E. 4.371
SH-FAS-700A1 (1937) Grav. 3.075	SH-FAS-700D-1 (1937) Grav. 2.087
SH-FAS-700D (1937) 24' G.E. 2.087	SH-FAS-700B-1 (1937) Grav. 3.306
SH-WP50-700A (1937) 24' G.E. 3.075	SH-WP50-700B (1937) 24' G.E. 3.306

# TEXAS 107

ROUTES  
 B (PART)  
 H-JJ



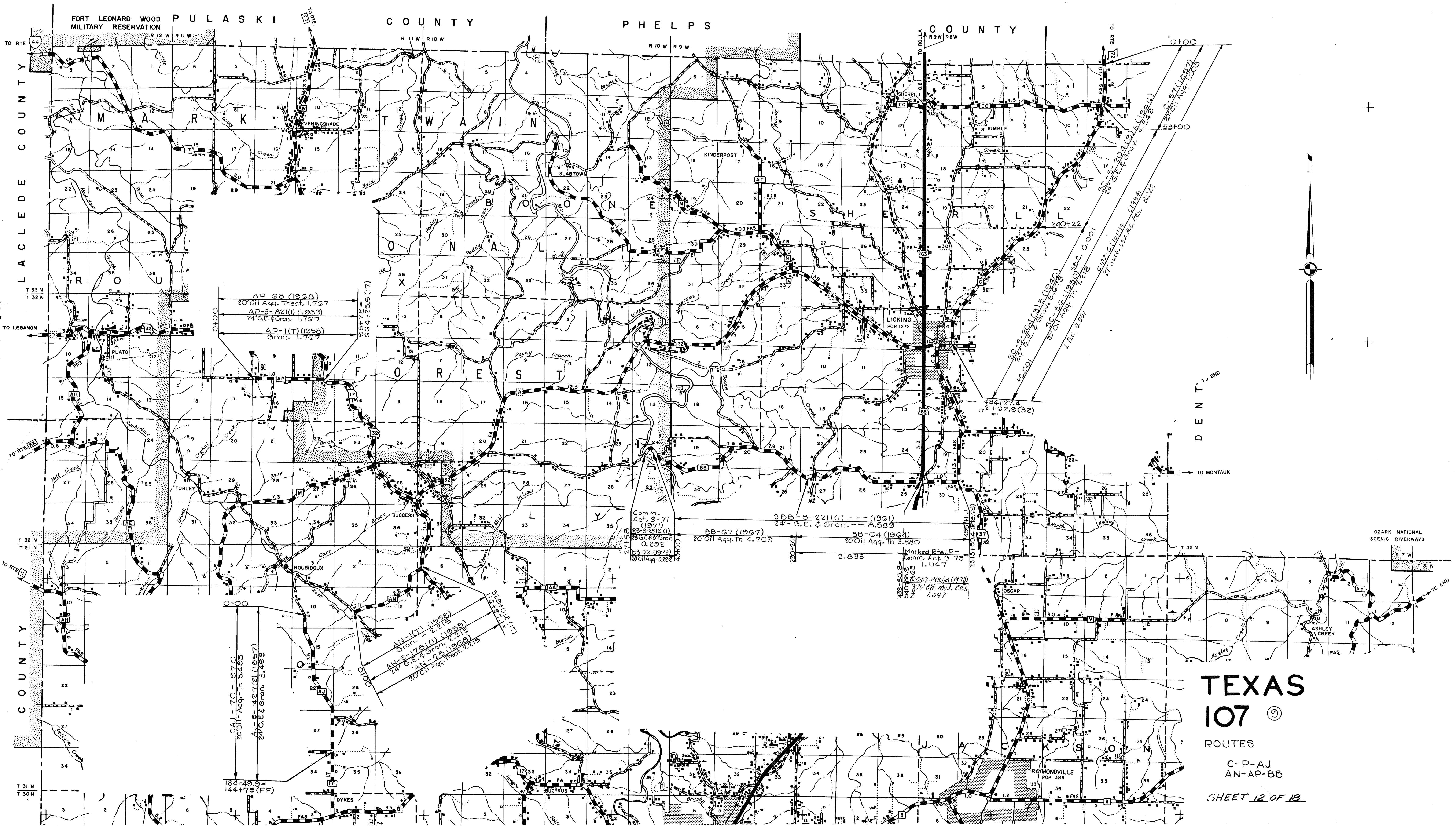

**TEXAS**  
**107** ⑨  
 ROUTES  
 C-P-AJ  
 AN-AP-BB  
 SHEET 12 OF 18

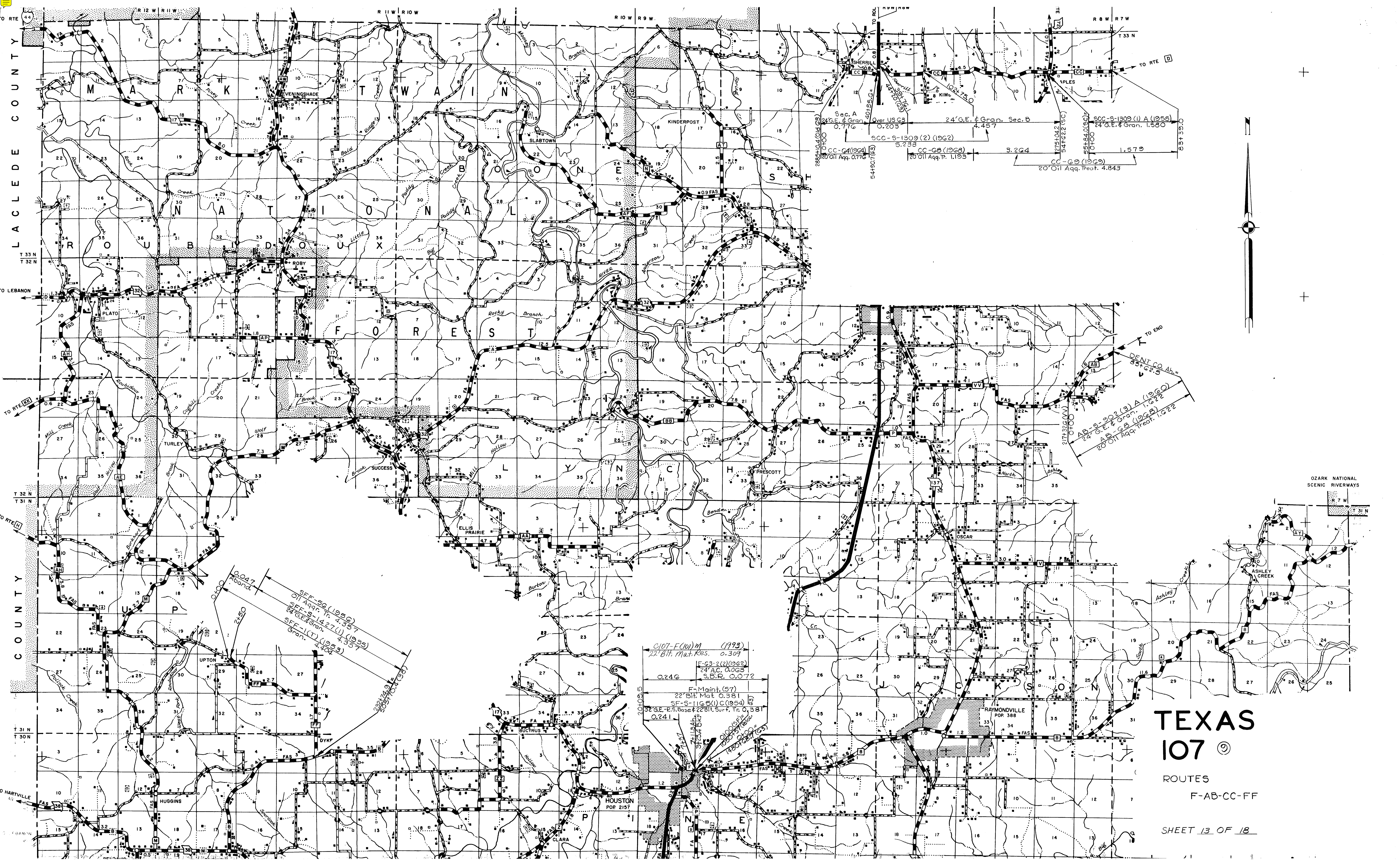

# TEXAS 107

ROUTES  
F-AB-CC-FF

SHEET 13 OF 18

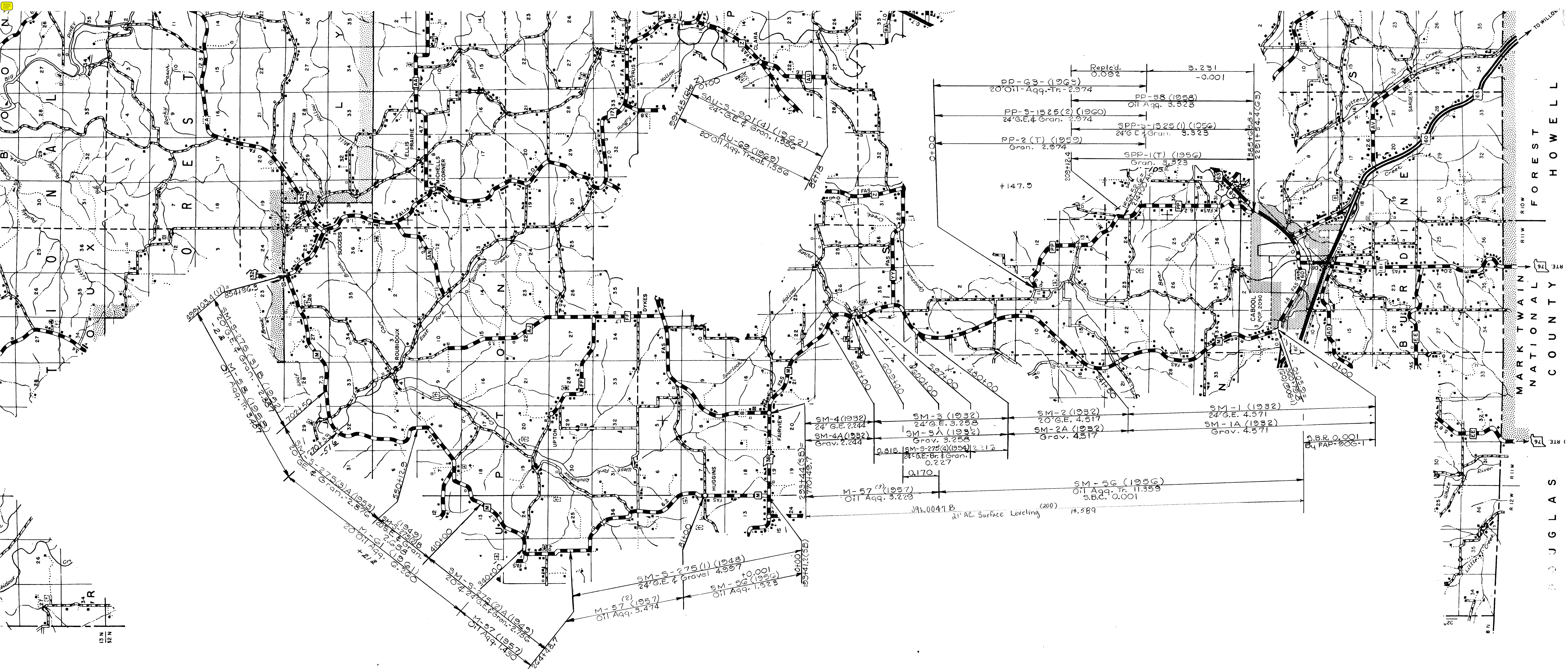

# TEXAS 107 ©

ROUTES  
M-AU-PP

MORTIMER  
 FOREST  
 WELLS  
 COUNTY  
 GLAS  
 WELLS

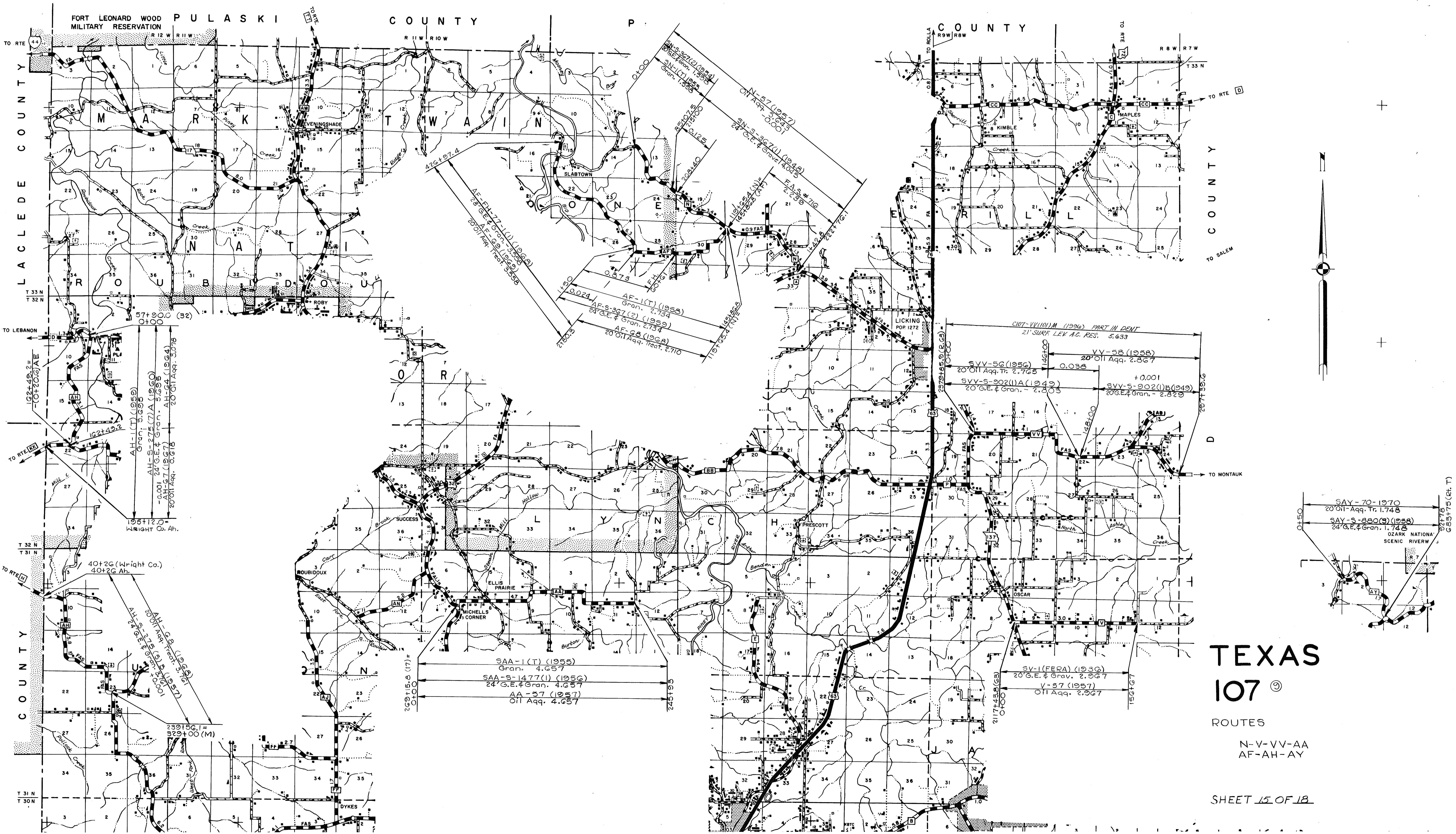

FORT LEONARD WOOD MILITARY RESERVATION

LACLEDGE COUNTY

TO LEBANON

COUNTY

TO RTE [H]

PULASKI COUNTY

P

COUNTY

COUNTY

TO MONTAUK

D

TEXAS  
107

ROUTES

N-V-VV-AA  
AF-AH-AY

SHEET 15 OF 18

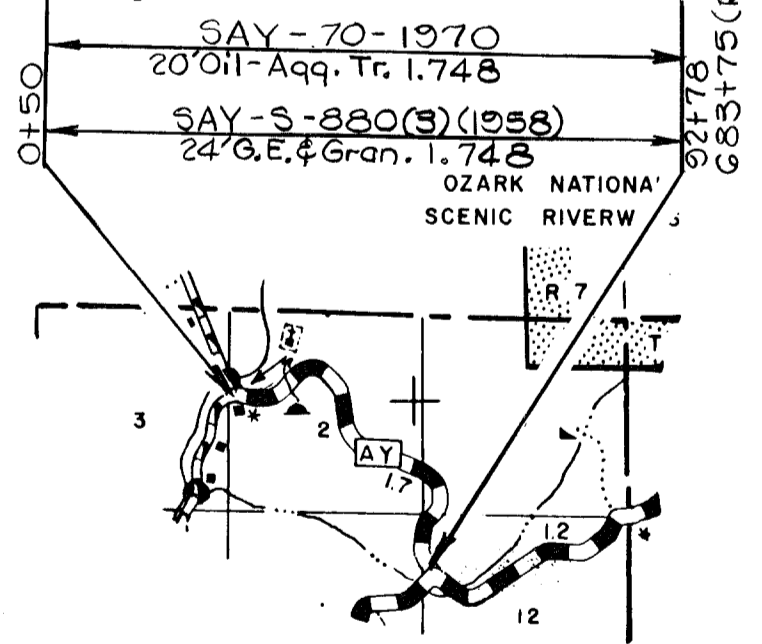

SAA-1(T) (1955)  
Gran. 4.657  
SAA-S-1477(I) (1956)  
24' G.E. & Gran. 4.657  
AA-37 (1957)  
Oil Aq. 4.657

SV-1(FERA) (1936)  
20' G.E. & Grav. 2.967  
V-57 (1957)  
Oil Aq. 2.967

SVV-5G (1956)  
20' Oil Aq. Tr. 2.765  
SVV-S-902(I)A (1949)  
20' G.E. & Gran. - 2.803  
SVV-S-902(I)B (1949)  
20' G.E. & Gran. - 2.829

AH-1(T) (1956)  
Gran. 3.696  
AH-S-275(7)A (1960)  
24' G.E. & Gran. 3.696  
-0.001  
AH-G-7 (1967)  
20' Oil Aq. 3.678

40+2G (Wright Co.)  
40+2G Ah.

AI-S-275(5)B (1957)  
24' G.E. & Gran. 3.601

239+5G.1 =  
329+00 (M)

CURT-VV(10)M (1936) PART IN DENT  
21' SURF. LEV. A.C. RES. 5.633

VV-58 (1958)  
20' Oil Aq. 2.867

+0.001

20' Oil Aq. 2.803

20' Oil Aq. 2.829

20' Oil Aq. 2.803

20' Oil Aq. 2.803

20' Oil Aq. 2.803

20' Oil Aq. 2.803

20' Oil Aq. 2.803

20' Oil Aq. 2.803

20' Oil Aq. 2.803

20' Oil Aq. 2.803

20' Oil Aq. 2.803

20' Oil Aq. 2.803

20' Oil Aq. 2.803

20' Oil Aq. 2.803

20' Oil Aq. 2.803

20' Oil Aq. 2.803

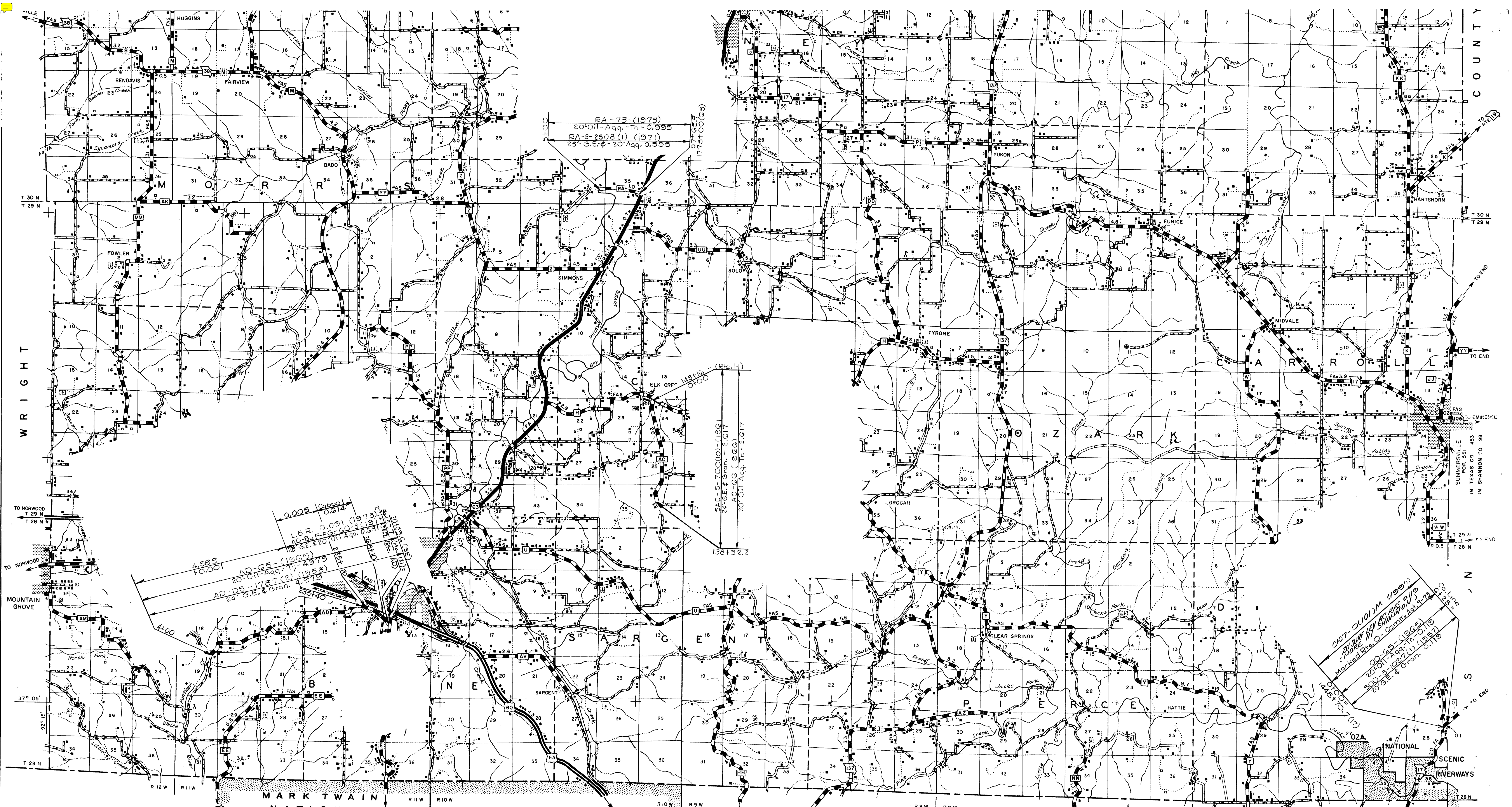

WRIGHT COUNTY

WRIGHT

# TEXAS 107

ROUTES - O-AC-AD-RA  
SHEET 16 OF 18

T 30 N  
T 29 N

TO NORWOOD  
T 28 N

TO NORWOOD  
T 28 N

37° 05'

T 28 N

T 30 N  
T 29 N

TO END

TO END

TO END

TO END

TO END

TO END

T 28 N

R 12 W  
R 11 W

MARK TWAIN  
NATIONAL  
RECREATION  
AREA

R 10 W  
R 9 W

R 8 W  
R 7 W

R 8 W  
R 7 W

R 7 W

SUMMERSVILLE  
POP. 551  
IN TEXAS CO. 453  
IN SHANNON CO. 98

0.0100  
148° 17' 0.7 (17)  
C107-0101 JM (1992)  
Bore by Shimmons  
Marked E.O. Comm. Ac. 378  
00-02- (1965)  
20° Oil-Acq. Tr. - 0.119  
500' S. 1097 (1) (1957)  
20° Oil-Acq. Tr. - 0.119

0.005  
0.014  
L.B.R. 0.091 (1973)  
AD-BU-FG-00-3 (1973)  
20° Oil-Acq. Tr. - 4.379  
AD-D3-1787 (2) (1958)  
24° G.E. & Gran. 4.979  
4.339  
+0.001  
4.00

RA-73 (1973)  
20° Oil-Acq. Tr. - 0.995  
RA-S-2508 (1) (1971)  
28° G.E. & Gran. - 20° Acq. - 0.555  
1778+50 (CS)

148° 16' - (Ele. H)  
138+32.2  
SAC-S-700 (10) (1961)  
24° G.E. & Gran. 2.617  
AC-EG (1966)  
20° Oil-Acq. Tr. - 2.617

TO END

TO END

TO END

TO END

TO END

TO END



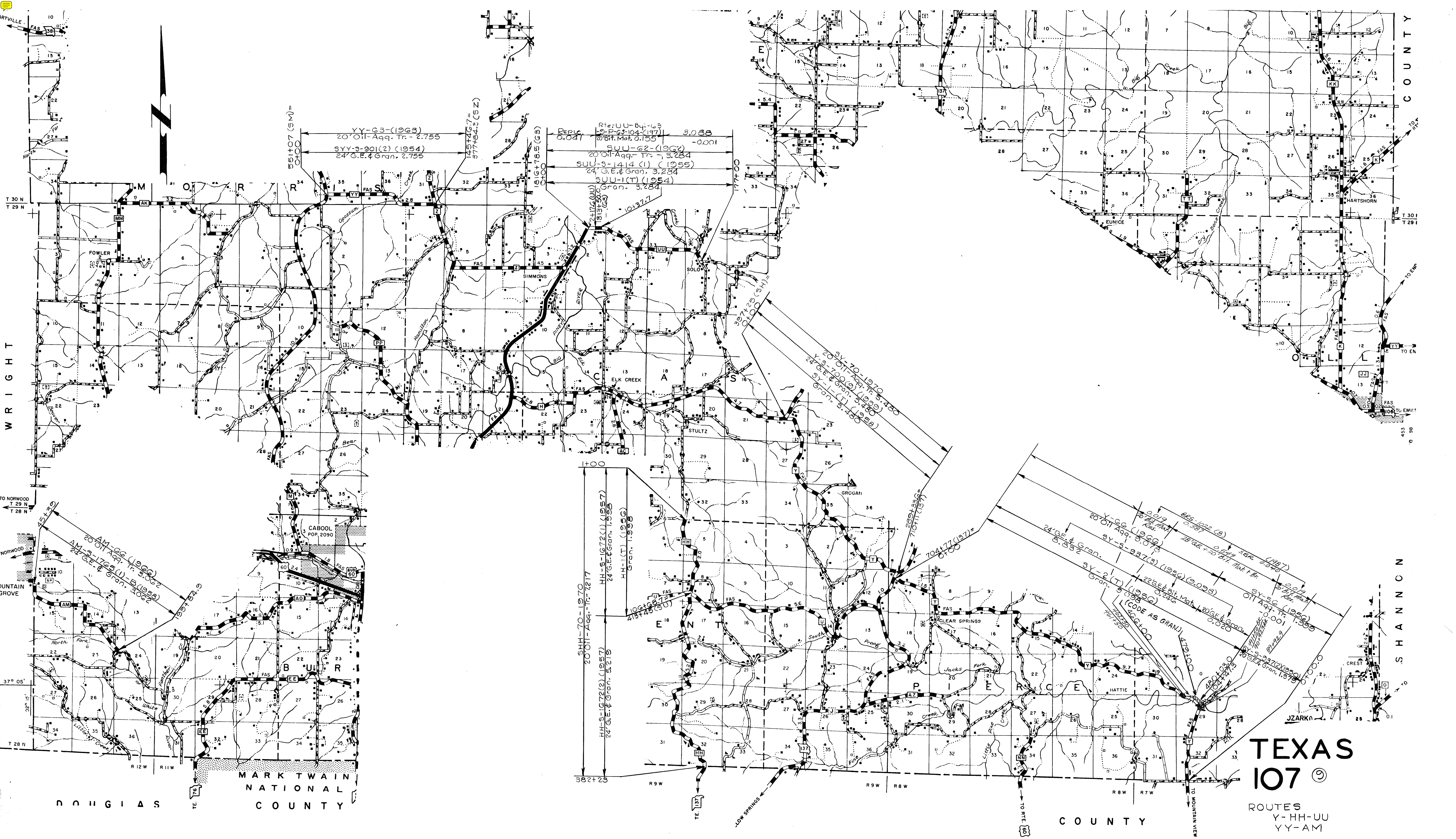

**TEXAS**  
**107** ©

ROUTES  
Y-HH-UU  
YY-AM

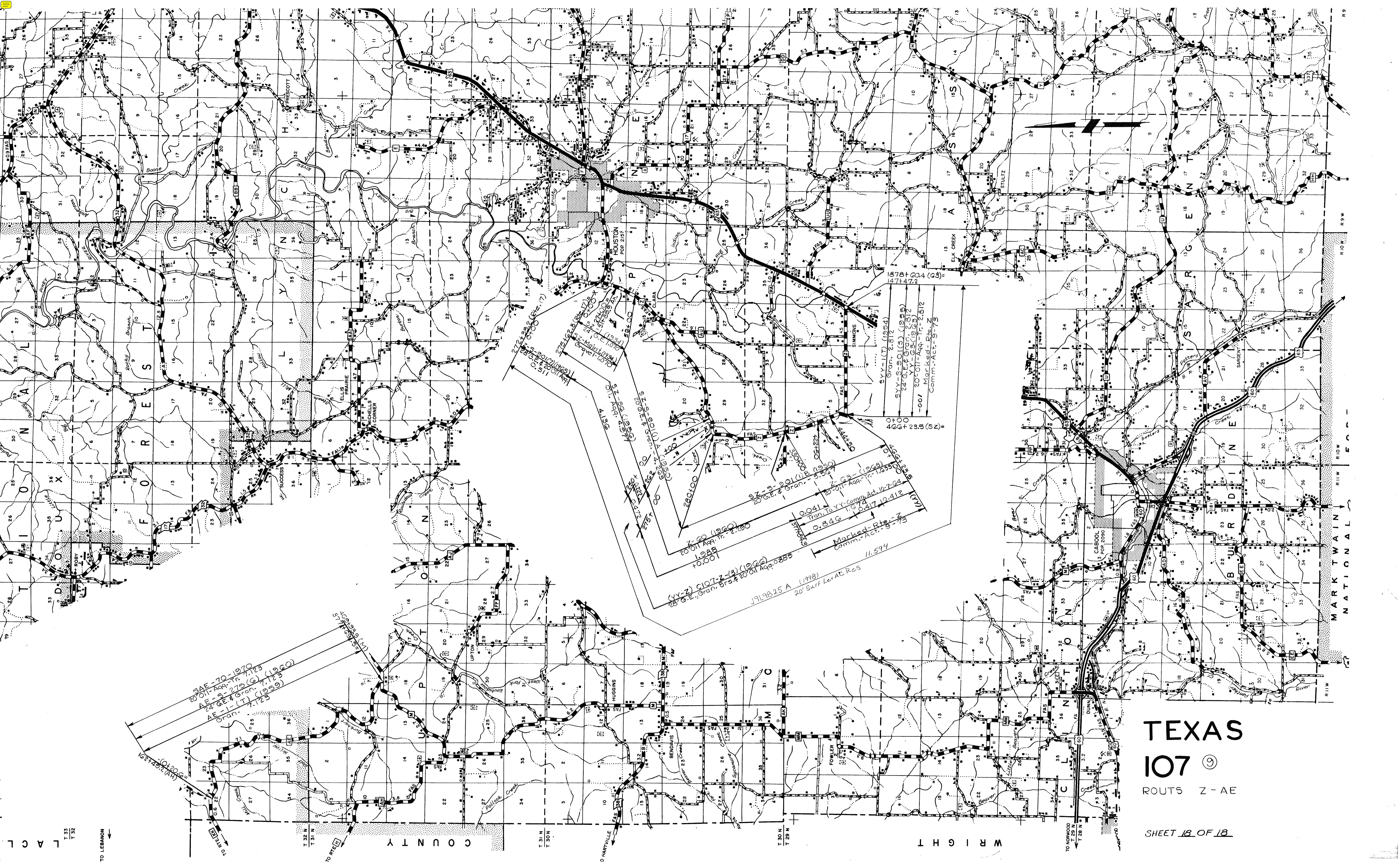

SAE-70-1970  
20-011-Acq. Tr. 7.123  
AE-S-275(G) (1960)  
24-GE. & Gran. 7.123  
AE-1-(T) (1959)  
Gran. 7.123

272-1-252 (Rte. 17)  
28-GE. & 20-011-A  
C. 51

275-1-2-1 (1933)  
22-GE. & 20-011-A  
C. 51  
Houston Pop. 2,147

37-5-6 (1950)  
28-GE. & 20-011-A  
C. 51

37-3-301 (1950)  
20-GE. & Gran. 5.567

2-63-1 (1962)  
20-011-Acq. Tr. 1.230

0041  
Tran. To YY-Comma Act. 10-7-64  
C. 2

0.846  
0.417 10.412  
Marked Rte-Z  
Comm.-Act.-9-73

J919825 A (1998)  
20' Surf Lev. AD. R. 25  
11.594

1878+20.4 (G3)=  
147147.2  
SVY-1(T) (1954)  
Gran. 2.812  
SY-S-901(S) (1955)  
24-GE. & Gran. 2.812  
XY-G-3 (1959)  
-001 20-011-Acq. Tr. 2.812  
Marked Rte-Z  
Comm.-Act.-9-73

TEXAS  
107  
ROUTES Z-AE  
SHEET 18 OF 18

L A C L  
T 33  
T 32

TO LEBANON

C O U N T Y

T 31 N  
T 30 N

TO HARTVILLE

T 30 N  
T 29 N

W R I G H T

TO NORWOOD

N A T I O N A L  
R I V E R